

ROAD TRAFFIC REGULATION ACT 1984
LINCOLNSHIRE COUNTY COUNCIL
(GOSBERTON – RISEGATE ROAD)
(30MPH SPEED LIMIT) ORDER 20

The LINCOLNSHIRE COUNTY COUNCIL in exercise of their powers under Sections 84 (1) and (2) of the Road Traffic Regulation Act 1984, (hereinafter referred to as "the Act") and of all other enabling powers, after consultation with the Chief Officer of Police in accordance with Part III of Schedule 9 to the Act hereby make the following Order:-

1. This Order may be cited as the Lincolnshire County Council (Gosberton – RiseGate Road) (30mph Speed Limit) Order 20 and shall come into operation on 20.
2. No person shall drive any motor vehicle at a speed exceeding 30mph on the length of road specified in the Schedule to this Order.
3. No speed limit imposed by this Order applies to vehicles falling within regulation 3 (4) of the Road Traffic Exemptions (Special Forces) (Variation and Amendment) Regulations 2011 when used in accordance with regulation 3 (5) of those regulations.

THE COMMON SEAL of the LINCOLNSHIRE)
COUNTY COUNCIL was hereunto affixed)
in the presence of:-)

Authorised Officer

SCHEDULE

Risegate Road

From a point 220 metres west of its junction with Beach Lane in an easterly direction for a distance of 1630 metres

DRAFT

DATED

ROAD TRAFFIC REGULATION ACT 1984
LINCOLNSHIRE COUNTY COUNCIL
(GOSBERTON – RISEGATE ROAD)
(30MPH SPEED LIMIT) ORDER 20

DRAFT

Lincolnshire County Council

County Offices

Lincoln

**LINCOLNSHIRE COUNTY COUNCIL
(GOSBERTON – RISEGATE ROAD)
(30MPH SPEED LIMIT) ORDER 20**

STATEMENT OF REASONS

- When comparing the conditions to the current speed limit policy, a 30mph speed limit is recommended.
- Therefore, in accordance with the County Council's Policy, it is proposed to introduce a speed limit as per the schedule in the Order.
- The Chief Constable, Gosberton Parish Council and South Holland District Council have been consulted, along with other local groups/companies.

PUBLIC NOTICE

LINCOLNSHIRE COUNTY COUNCIL (GOSBERTON – RISEGATE ROAD) (30MPH SPEED LIMIT) ORDER 20

NOTICE IS HEREBY GIVEN that the Lincolnshire County Council propose to make an Order under their powers contained in the Road Traffic Regulation Act 1984, the effect of which will be to restrict the speed of vehicles to 30mph along Risegate Road, Gosberton.

A copy of the plan showing the lengths of road concerned along with a Statement of Reasons for proposing to make the Order may be inspected on our website: www.lincolnshire.gov.uk/trafficorders

If you are unable to view our website the documents can be supplied to you by contacting us using the contact details below or calling our Customer Service Centre on 01522 782070 during office hours.

You may also be able to view these documents at the offices of South Holland District Council, during normal office hours.

Objections or representations to the proposals, together with the grounds on which they are made, must be made in writing to Chief Executive - Lincolnshire County Council, Lancaster House, 36 Orchard Street, Lincoln, LN1 1XX or Email: TRO@lincolnshire.gov.uk (For the attention of: Miss K Fraser, Traffic Orders Section) by **Monday 13th January 2025**



Key:

	Proposed 30mph Speed Limit
	Existing 30mph Speed Limit
	Existing 40mph Speed Limit
	Existing National Speed Limit

UGH ROAD

Stone

Drain

Rev.	Description	Drawn	Ch'kd	Auth	Date
Project					
Risegate, Gosberton					
Status					
Project No. 2106					
Drawing Title					
Proposed 30mph Speed Limit					
Scale					
NTS @A3		Drawn	KF	Date	24/09/2024
Drawing No.					
H/KF/2106/004					Rev.
					0

© Crown copyright and database rights 2020
Ordnance Survey 100025370.

Lincolnshire
COUNTY COUNCIL
Highways Alliance

Lancaster House, 36 Orchard Street,
Lincoln, LN1 1XX

Sep 25 2024 - 10:00am \\hpoint\users\usercommon\Traffic Regulation Orders\Schemes 18-19\Kate Fraser\Plan.dwg

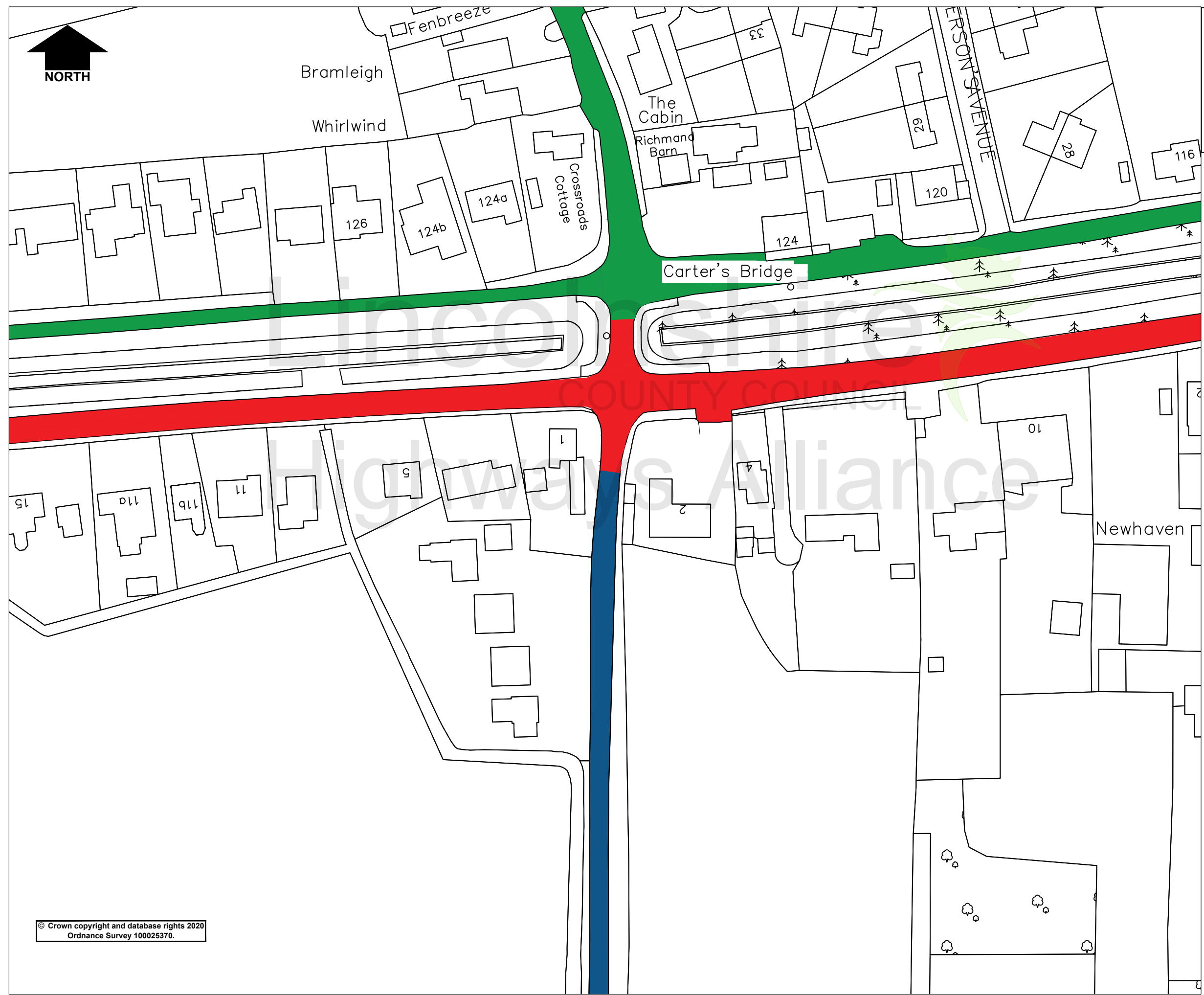

Key:

	Proposed 30mph Speed Limit
	Existing 30mph Speed Limit
	Existing 40mph Speed Limit
	Existing National Speed Limit

Lincolnshire COUNTY COUNCIL
Highways Alliance

Rev.	Description	Drawn	Ch'kd	Auth	Date
Project Risegate, Gosberton					
Status		Project No. 2106			
Drawing Title Proposed 30mph Speed Limit					
Scale	Drawn	Date			
NTS @A3	KF	24/09/2024			
	Ch'kd	Date			
Drawing No.		Rev.			
H/KF/2106/005		0			

© Crown copyright and database rights 2020
Ordnance Survey 100025370.

Lincolnshire
COUNTY COUNCIL
Highways Alliance
Lancaster House, 36 Orchard Street,
Lincoln, LN1 1XX

Sep 25, 2024 - 10:00am \\hpoint\users\usercommon\Traffic_Regulation_Order\Schemes_18-19\Kate_Frazer\Plan.dwg

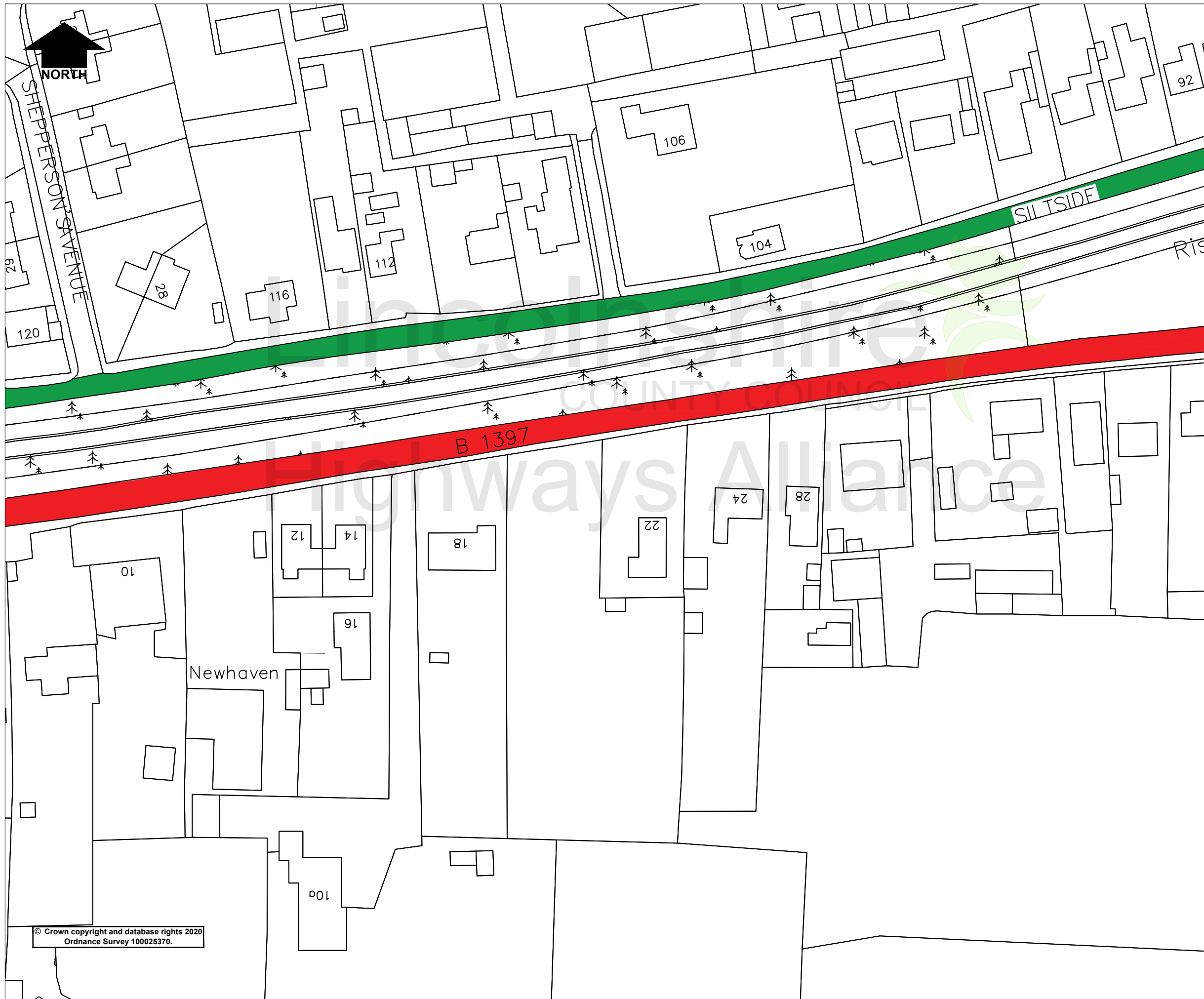

Key:

	Proposed 30mph Speed Limit
	Existing 30mph Speed Limit
	Existing 40mph Speed Limit
	Existing National Speed Limit

Rev.	Description	Drawn	Ch'kd	Auth	Date
Project Risegate, Gosberton					
Status		Project No. 2106			
Drawing Title Proposed 30mph Speed Limit					
Scale NTS @A3	Drawn KF	Date 24/09/2024			
Drawing No. H/KF/2106/006		Rev. 0			

Lincolnshire
COUNTY COUNCIL
Highways Alliance
Lancaster House, 36 Orchard Street,
Lincoln, LN1 1XX

© Crown copyright and database rights 2020
Ordnance Survey 100025370.

Sep 25, 2024 - 10:00am \\hpoint\users\usercommon\Traffic_Regulation_Orders\Schemes - 18-19\Kate_Frazer\Plan.dwg

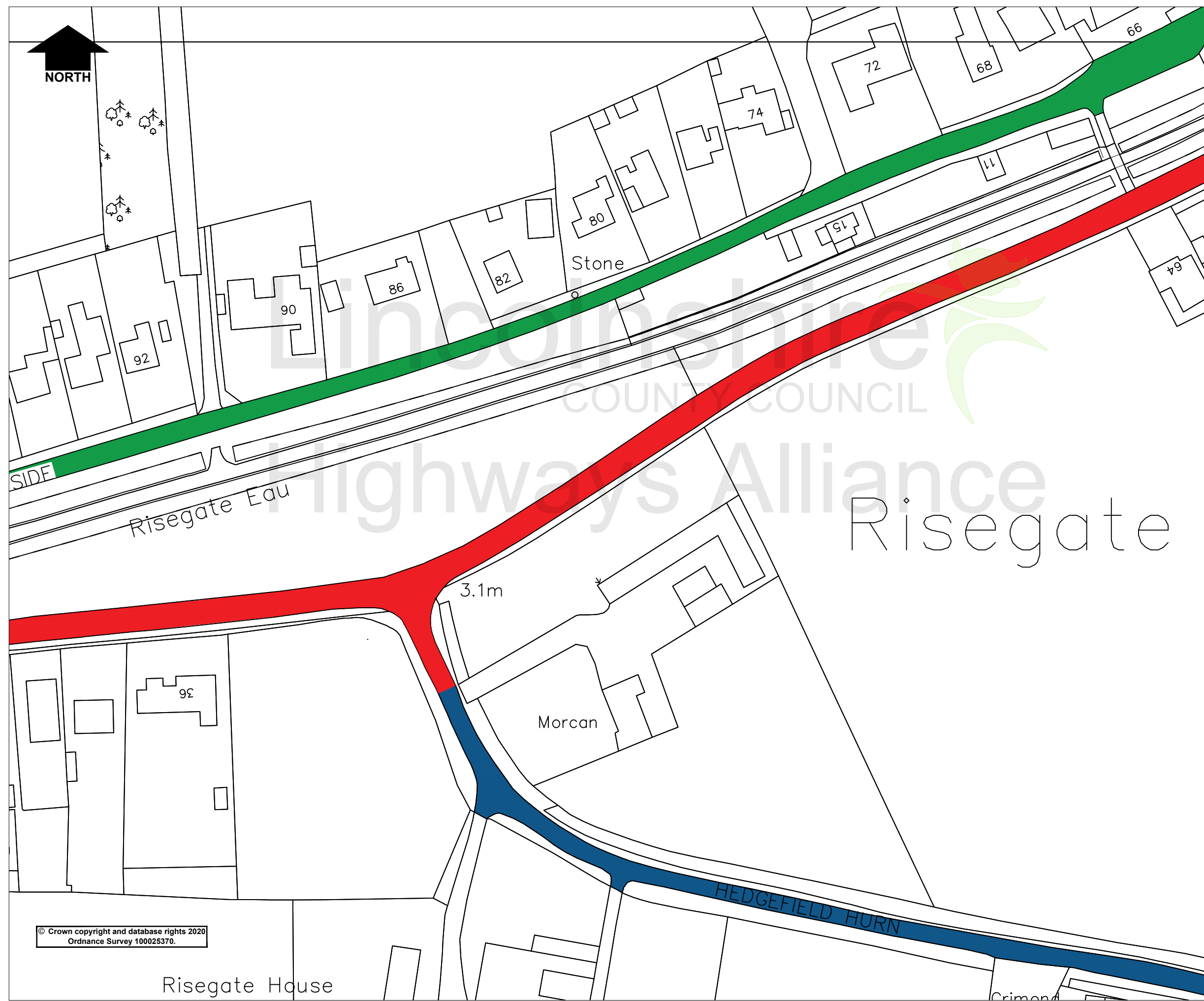

Key:

	Proposed 30mph Speed Limit
	Existing 30mph Speed Limit
	Existing 40mph Speed Limit
	Existing National Speed Limit

© Crown copyright and database rights 2020
Ordnance Survey 100025370.

Rev.	Description	Drawn	Ch'kd	Auth	Date
Project Risegate, Gosberton					
Status		Project No. 2106			
Drawing Title Proposed 30mph Speed Limit					
Scale NTS @A3		Drawn KF	Date 24/09/2024		
Drawing No. H/KF/2106/007		Rev. 0			

Lincolnshire
COUNTY COUNCIL
Highways Alliance
Lancaster House, 36 Orchard Street,
Lincoln, LN1 1XX

Sep 25, 2024 - 10:00am \\hpoint\users\usercommon\Traffic_Regulation_Orders\Schemes - 18-19\Kate_Frazer\Plan.dwg

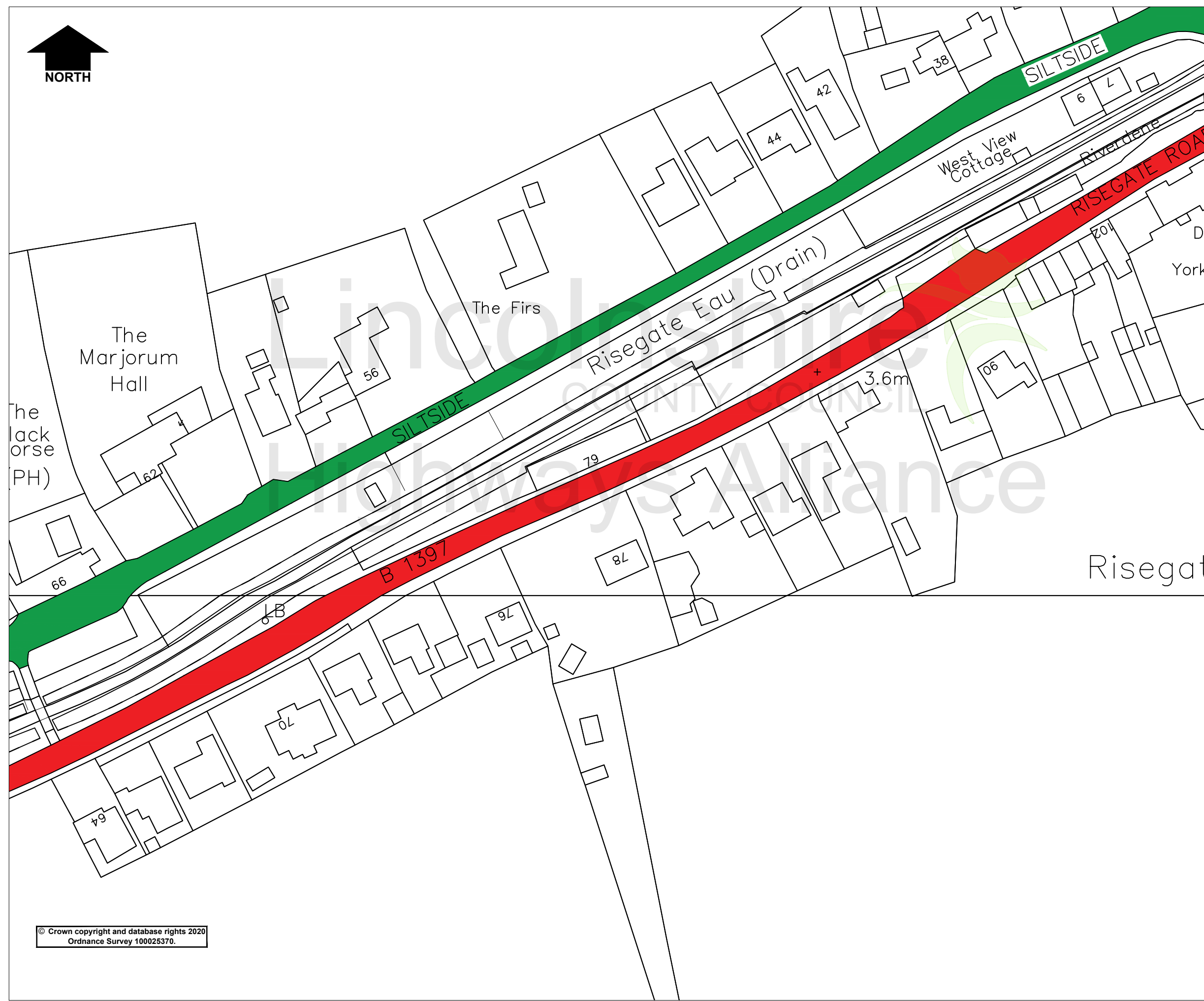

Key:

	Proposed 30mph Speed Limit
	Existing 30mph Speed Limit
	Existing 40mph Speed Limit
	Existing National Speed Limit

© Crown copyright and database rights 2020
Ordnance Survey 100025370.

Rev.	Description	Drawn	Ch'kd	Auth	Date
Project Risegate, Gosberton					
Status		Project No. 2106			
Drawing Title Proposed 30mph Speed Limit					
Scale NTS @A3	Drawn KF	Date 24/09/2024			
Drawing No. H/KF/2106/008		Rev. 0			

Lincolnshire
COUNTY COUNCIL
Highways Alliance
Lancaster House, 36 Orchard Street,
Lincoln, LN1 1XX

Sep 25, 2024 - 10:00am \\hpoint\users\usercommon\Traffic_Regulation_Order\Schemes - 18-19\Kate_Frazer\Plan.dwg

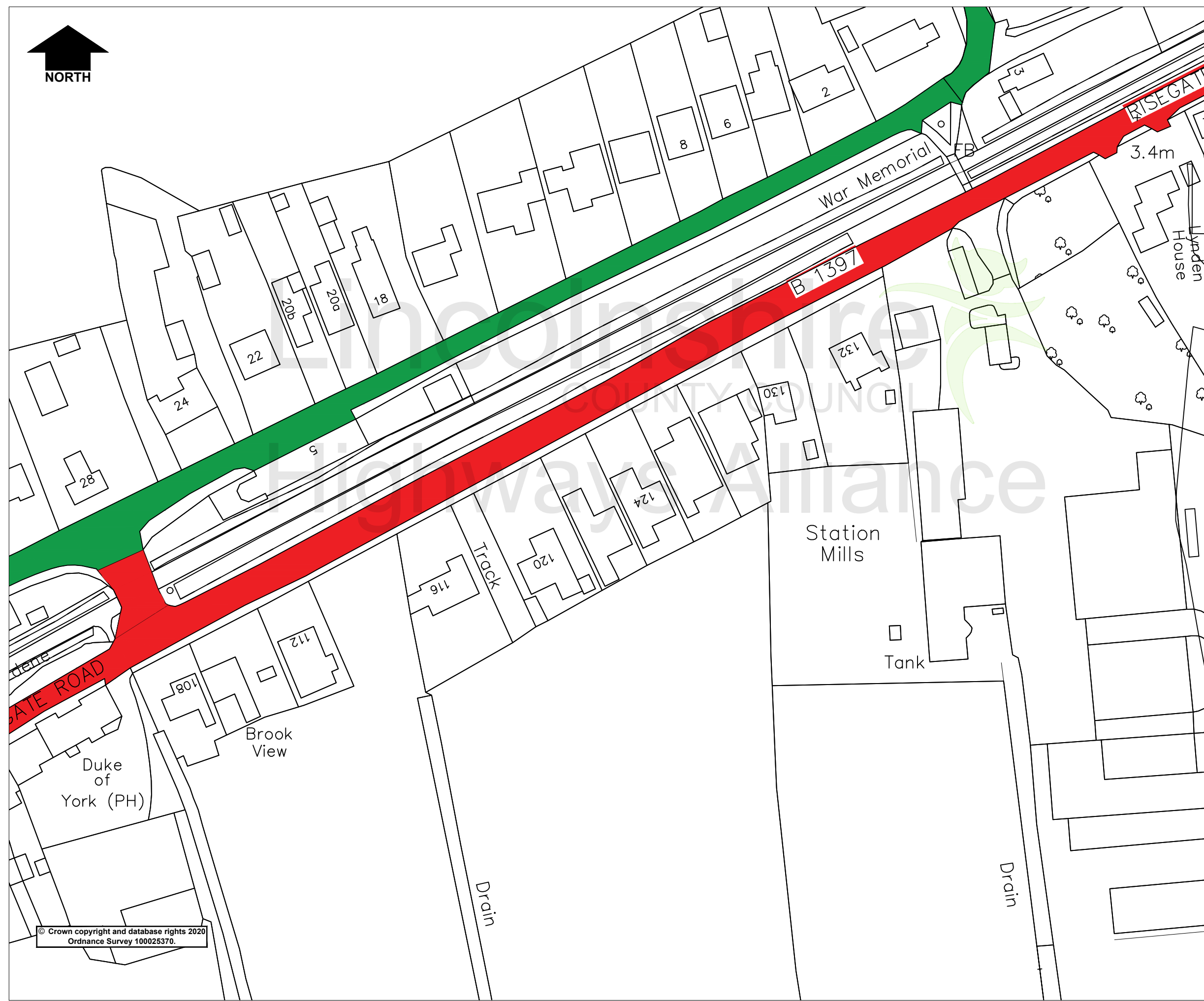

Key:

█	Proposed 30mph Speed Limit
█	Existing 30mph Speed Limit
█	Existing 40mph Speed Limit
█	Existing National Speed Limit

Rev.	Description	Drawn	Ch'kd	Auth	Date
Project Risegate, Gosberton					
Status		Project No. 2106			
Drawing Title Proposed 30mph Speed Limit					
Scale NTS @A3		Drawn KF	Date 24/09/2024		
Drawing No. H/KF/2106/009		Rev. 0			

Lincolnshire
COUNTY COUNCIL
Highways Alliance
Lancaster House, 36 Orchard Street,
Lincoln, LN1 1XX

© Crown copyright and database rights 2020
Ordnance Survey 100025370.

Sep 25, 2024 - 10:00am \\hpoint\users\usercommon\Traffic_Regulation_Order\Schemas - 18-19\Kate_Frazer\Plan.dwg

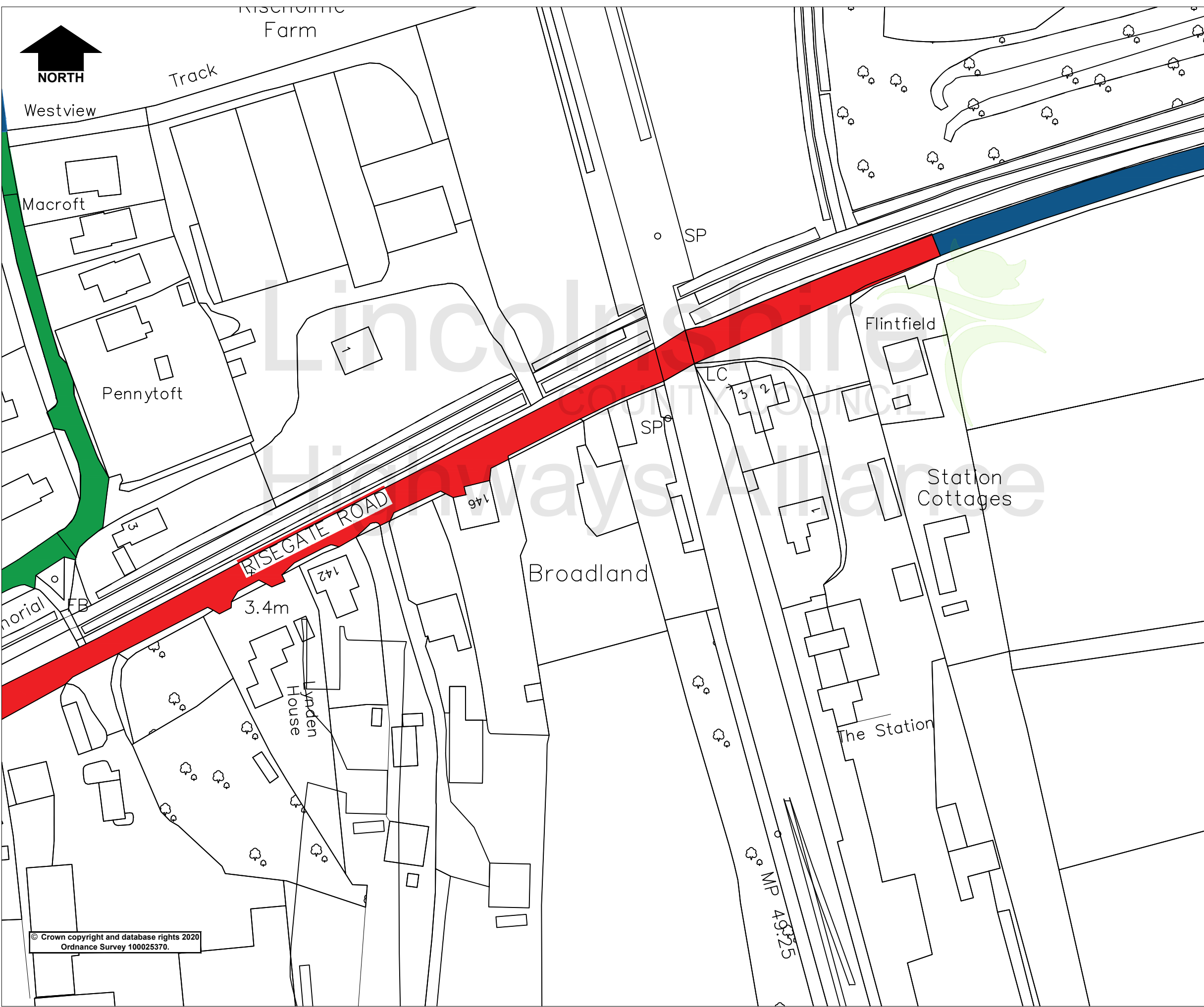

Key:

	Proposed 30mph Speed Limit
	Existing 30mph Speed Limit
	Existing 40mph Speed Limit
	Existing National Speed Limit

Rev.	Description	Drawn	Ch'kd	Auth	Date
Project					
Risegate, Gosberton					
Status					
Project No. 2106					
Drawing Title					
Proposed 30mph Speed Limit					
Scale					
NTS @A3					
Drawn		KF		Date	
				24/09/2024	
Ch'kd				Date	
Auth		Traced			
Drawing No.					Rev.
H/KF/2106/010					0

Lincolnshire
COUNTY COUNCIL



Highways Alliance

Lancaster House, 36 Orchard Street,
Lincoln, LN1 1XX

© Crown copyright and database rights 2020
Ordnance Survey 100025370.

Sep 25, 2024 - 10:00am \\hpa\point\users\usercommon\Traffic_Regulation_Orders\Schemes 18-19\Kate_Frazer\Plan.dwg

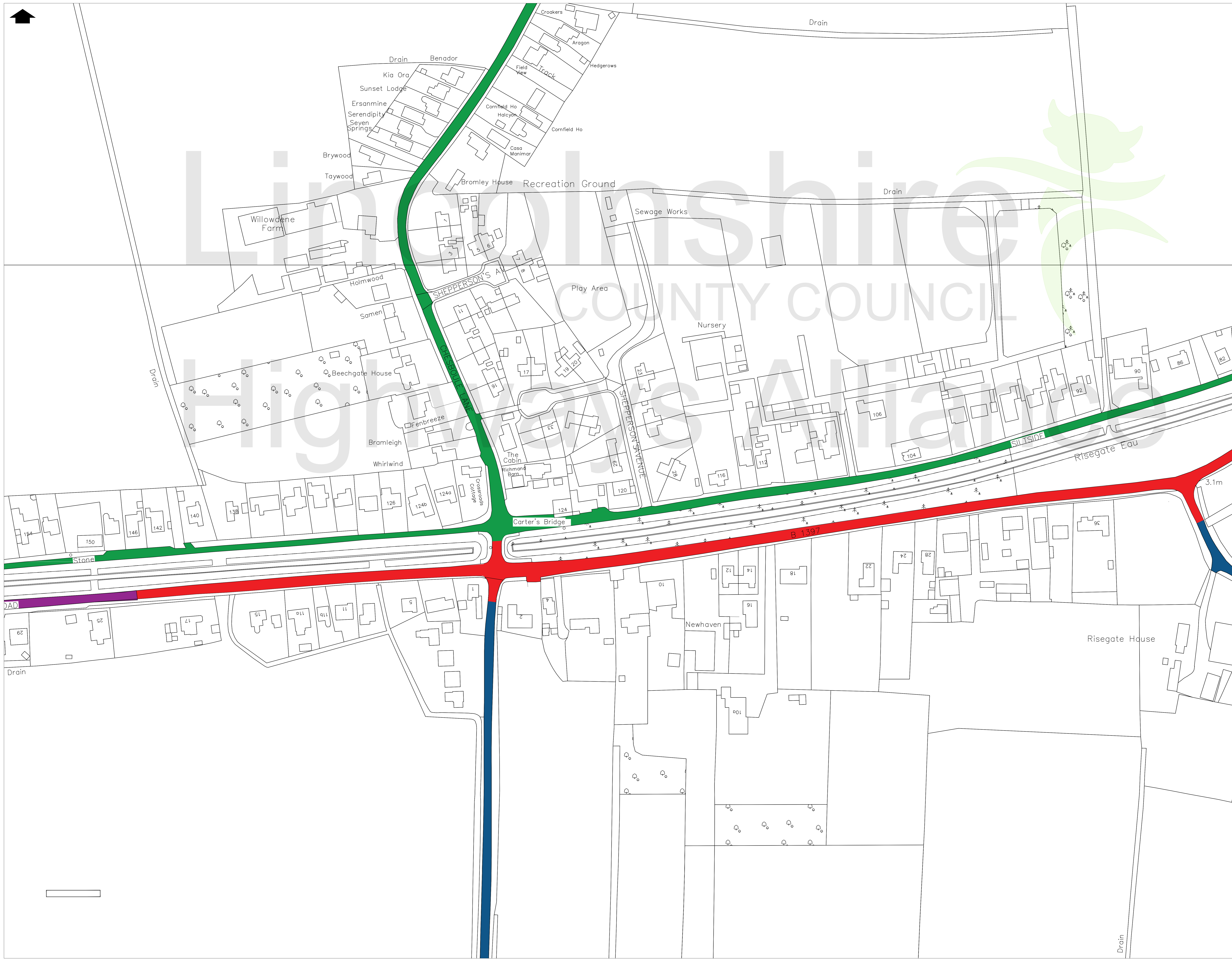
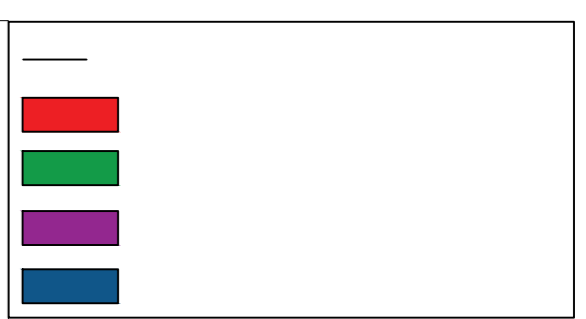

Lincolnshire COUNTY COUNCIL
Highways Alliance

Rev.	Description	Drawn	Chk'd	Auth	Date
Project: Risegate, Gosberton					
Status: 2106					
Drawing Title: Proposed 30mph Speed Limit					
Scale: NTS @A0		Drawn: KF	Chk'd:	Auth:	Date: 24/09/2024
Drawing No: H/KF/2106/001					Rev: 0

Lincolnshire
COUNTY COUNCIL
Highways Alliance
Lancaster House, 36 Orchard Street, Lincoln, LN1 1XX

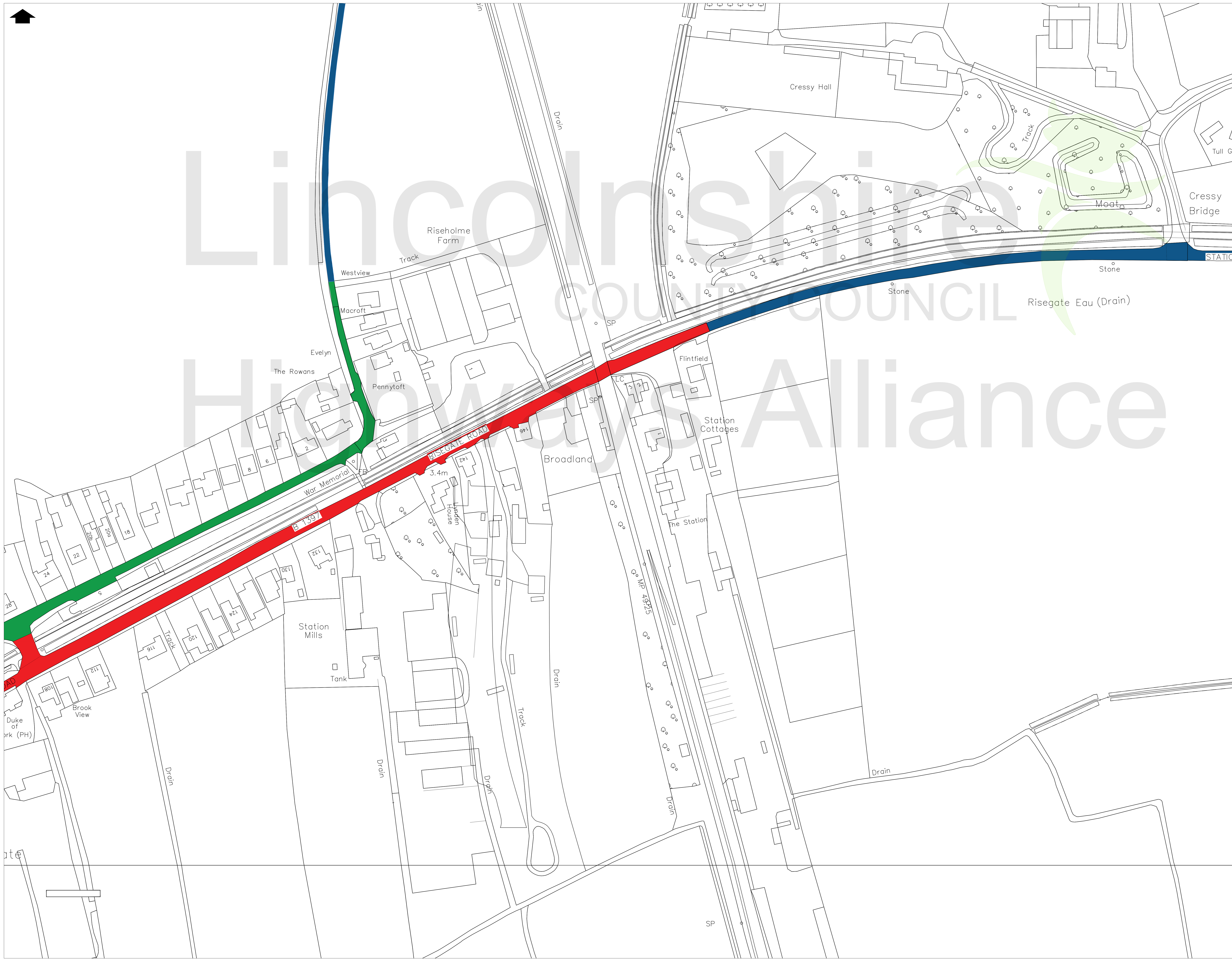
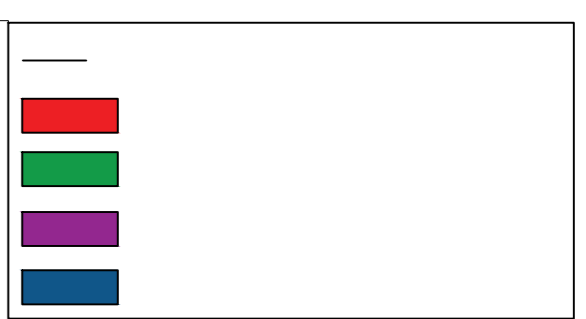
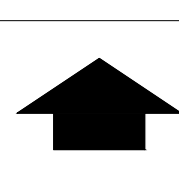

Lincolnshire COUNTY COUNCIL
Highways Alliance

Rev.	Description	Drawn	Chk'd	Auth	Date
Project: Risegate, Gosberton					
Status:		Project No: 2106			
Drawing Title: Proposed 30mph Speed Limit					
Scale:	Drawn:	Chk'd:	Auth:	Date:	
NTS @A0	KF			24/09/2024	
Drawing No: H/KF/2106/003					Rev: 0

Lincolnshire
COUNTY COUNCIL
Highways Alliance
Lancaster House, 36 Orchard Street, Lincoln, LN1 1XX