

Parish: Tetney
Title: Land at Tetney Lock
Reference number: CA/7/1/389

**DEPOSIT OF MAP AND STATEMENT AND STATUTORY DECLARATION(S) UNDER
HIGHWAYS ACT 1980, SECTION 31(6) AND COMMONS ACT 2006, SECTION 15A(1)**

Geographic Location

Grid Reference: TA344021, TA343024
**Address and postcode
of buildings on the
deposited land** 1, 2, 3 Coastguard Cottages, Tetney Lock Road, Tetney, DN36 5UW
District East Lindsey
Nearest city or town Grimsby

Highways Act 1980, Section 31(6) deposits

**Date of deposit of map
and statement** 23.01.2014
**Depositor's name and
address** Grainsby Farms Ltd. Grainsby Estate Office, Grainsby, South Humberside,
DN36 5PU
**Date of deposit of
declaration, name and
address of depositor** (1) 20.03.2014: Grainsby Farms Ltd. Grainsby Estate Office, Grainsby, South
Humberside, DN36 5PU
Date deposit expires: 19.03.2034

Commons Act 2006, Section 15A(1)

**Date of deposit of map
and statement, name
and address of
depositor** (1) 01.10.2013: Grainsby Farms Ltd. Grainsby Estate Office, Grainsby, South
Humberside, DN36 5PU
[combined deposit]

COUNTY COUNCIL'S CONTACT DETAILS

Officer and Section: Definitive Map Officer, Public Rights of Way and Countryside Access
Address: Lincolnshire County Council, Communities, 4th Floor, City Hall, Lincoln, LN1
1DN
Telephone: 01522 782070
Email: countryside_access@lincolnshire.gov.uk

REGISTER OF DEPOSITS

The County Council is required by law to keep a register of maps and statements and declarations deposited under Section 31(6) of the Highways Act 1980 and Section 15A(1) of the Commons Act 2006 available for public inspection on its website and in a paper copy format together with the deposited documents. Details including names, addresses and the location of land relating to a deposit which may be considered to be personal information are therefore in the public domain. This requirement overrides any entitlement a depositor may otherwise have under the Data Protection Act 1998 to prevent publication of such information. The paper copy of the register together with the deposited documents can be viewed by appointment during normal office hours (9:00am to 4:30pm, Monday to Friday) at the County Council's Public Rights of Way and Countryside Section at the above address.

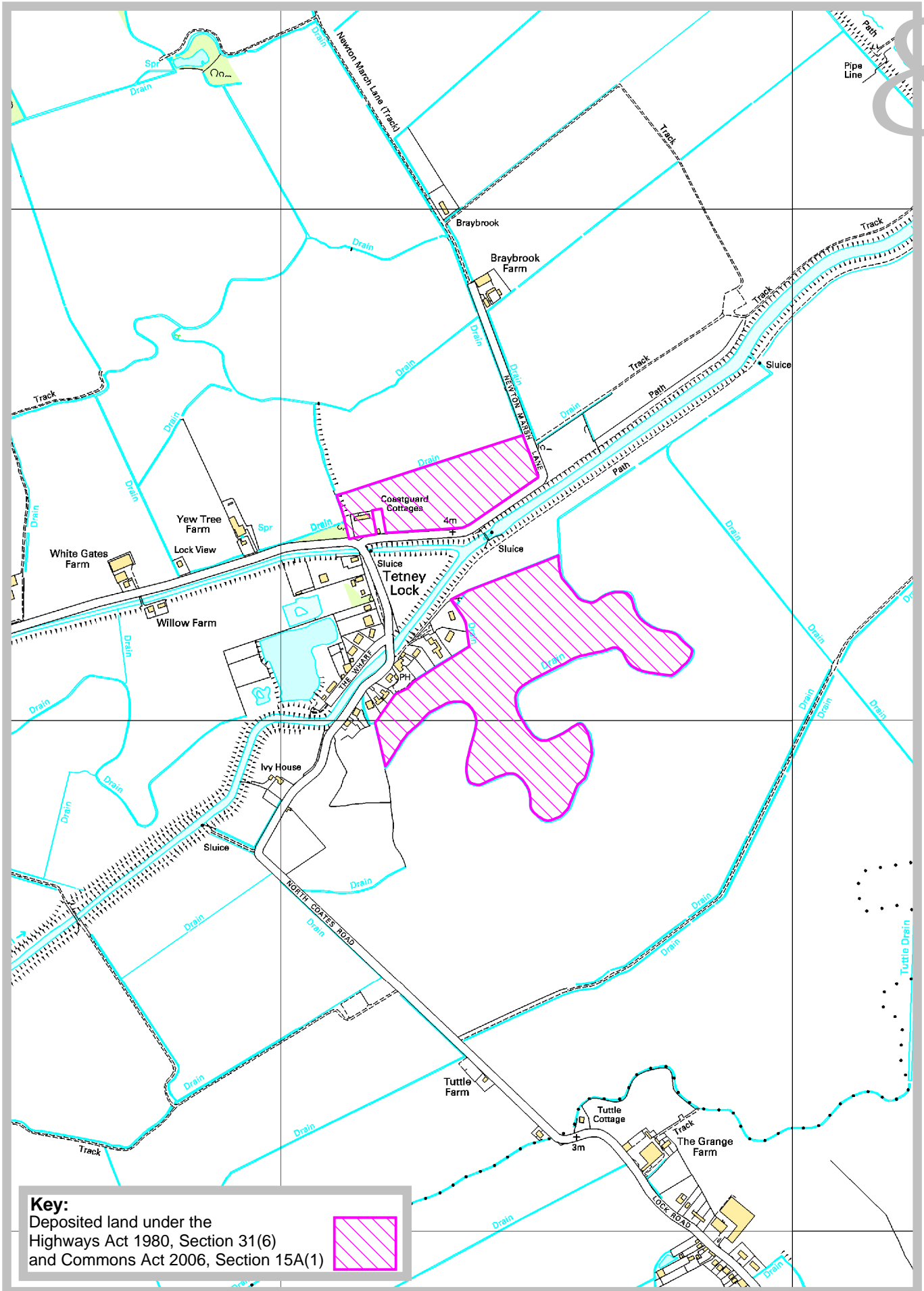

Key:
 Deposited land under the
 Highways Act 1980, Section 31(6)
 and Commons Act 2006, Section 15A(1) 



Rights of Way & Countryside Access
 RA Wills, Executive Director for Communities
 City Hall, Orchard Street,
 Lincoln LN1 1DN

Land at Tetney Lock

Ref: CA/7/1/389
 Grid Ref: TA344021, TA343024
 Scale: approx. 1:10,000

10. 'Appropriate authority' means (a) in relation to a map or statement deposited or declaration lodged under section 31(6) of that Act, an appropriate council (as defined in section 31(7) of the Highways Act 1980); and (b) in relation to a statement and map deposited under section 15A(1) of the 2006 Act, a commons registration authority (defined in section 4 of the Commons Act 2006 and section 2 of the Commons Registration Act 1965). In practice, the appropriate council and commons registration authority will usually be the same body.

PART A: Information relating to the applicant and land to which the application relates
(all applicants must complete this Part)

1. Name of appropriate authority to which the application is addressed:

Lincolnshire County Council, County Offices, Newland, Lincoln LN1 1YL

2. Name and full address (including postcode) of applicant:

Grainsby Farms Limited, Grainsby Estate Office, Grainsby, Grimsby, South Humberside, DN36 5PU

3. Status of applicant (tick relevant box or boxes):

I am

(a) making this application and the statements/declarations it contains on behalf of Grainsby Farms Limited who is the owner of the land(s) described in paragraph 4 and in my capacity as Director of Grainsby Farms Limited.

4. Insert description of the land(s) to which the application relates (including full address and postcode):

Land at Tetney Lock

5. Ordnance Survey six-figure grid reference(s) of a point within the area of land(s) to which the application relates (if known):

6. This deposit comprises the following statement(s) and/or declarations (*delete Parts B, C, or D where not applicable*):

PART B: Statement under section 31(6) of the Highways Act 1980

Grainsby Farms Limited is the owner of the land described in paragraph 4 of Part A of this form and shown edged red on the map accompanying this statement.

Ways shown coloured blue on the accompanying map are public footpaths.

No other ways over the land shown edged red on the accompanying map have been dedicated as highways.

PART D: Statement under section 15A(1) of the Commons Act 2006

Grainsby Farms Limited is the owner of the land described in paragraph 4 of Part A of this form and shown edged red on the map accompanying this statement.

Grainsby Farms Limited wishes to bring to an end any period during which persons may

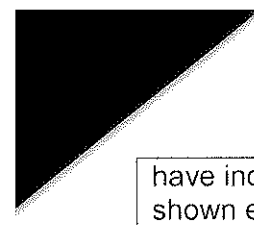

have indulged as of right in lawful sports and pastimes on the whole or any part of the land shown edged red on the accompanying map.

PART E: Additional information relevant to the application
(insert any additional information relevant to the application)

PART F: Statement of Truth
(all applicants must complete this Part)

WARNING: If you dishonestly enter information or make a statement that you know is, or might be, untrue or misleading, and intend by doing so to make a gain for yourself or another person, or to cause loss or the risk of loss to another person, you may commit the offence of fraud under section 1 of the Fraud Act 2006, the maximum penalty for which is 10 years' imprisonment or an unlimited fine, or both.

I BELIEVE THAT THE FACTS AND MATTERS CONTAINED IN THIS FORM ARE TRUE

Signature (of the person making the statement of truth)

Print full name: RICHARD HOLLAND CATON HAIGH (Director of Grainsby Farms Limited)

Date: * 13/01/2014. *

You should keep a copy of the completed form

Data Protection Act 1998 – Fair Processing Notice

The purpose of this Fair Processing Notice is to inform you of the use that will be made of your personal data, as required by the Data Protection Act 1998.





The appropriate authority (see explanation of definition in above guidance notes) in England is the data controller in respect of any personal data that you provide when you complete this form.

The information that you provide will be used by the appropriate authority in its duties to process applications to deposit statements, maps and declarations under section 31(6) the Highways Act 1980 and statements under section 15A(1) of the Commons Act 2006. The information you provide will also be used by the appropriate authority in its duty to update the registers in which details of such deposits are recorded under the Dedicated Highways (Registers under Section 31A of the Highways Act 1980) (England) Regulations 2007 and the Commons (Registration of Town or Village Greens) and Dedicated Highways (Landowner Statements and Declarations) (England) Regulations 2013.

The appropriate authority is required by the legislation above to maintain a register which holds information provided in this form, which can be inspected online or in person by members of the public on request. It may also be required to release information, including personal data and commercial information, on request under the Environmental Information Regulations 2004 or the Freedom of Information Act 2000. However, the appropriate authority will not permit any unwarranted breach of confidentiality nor will they act in contravention of their obligations under the Data Protection Act 1998.

rpa
 rural payments agency
Rural Land Register (RLR) Map
 SBI - 106451181

Map 17/17

- Legends**
-  Your RLR Parcel(s)
 -  SPS Permanent Ineligible Features
 -  Adjacent Parcel Boundary
 -  Unconfirmed Boundary

RLR Information

Sheet ID	Parcel ID	Total Area (ha)	SPS Recorded Eligible Area (ha)	English Region
TA3402	3445	3.88	3.86	N
TA3402	4715	12.07	11.75	N

Scale 1:5000

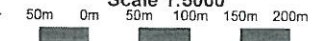

Reproduced by permission of Ordnance Survey on behalf of HMSO.
 © Crown copyright and database right 2008. All rights reserved.
 Ordnance Survey Licence number 100022861

Date: 11/08/2010

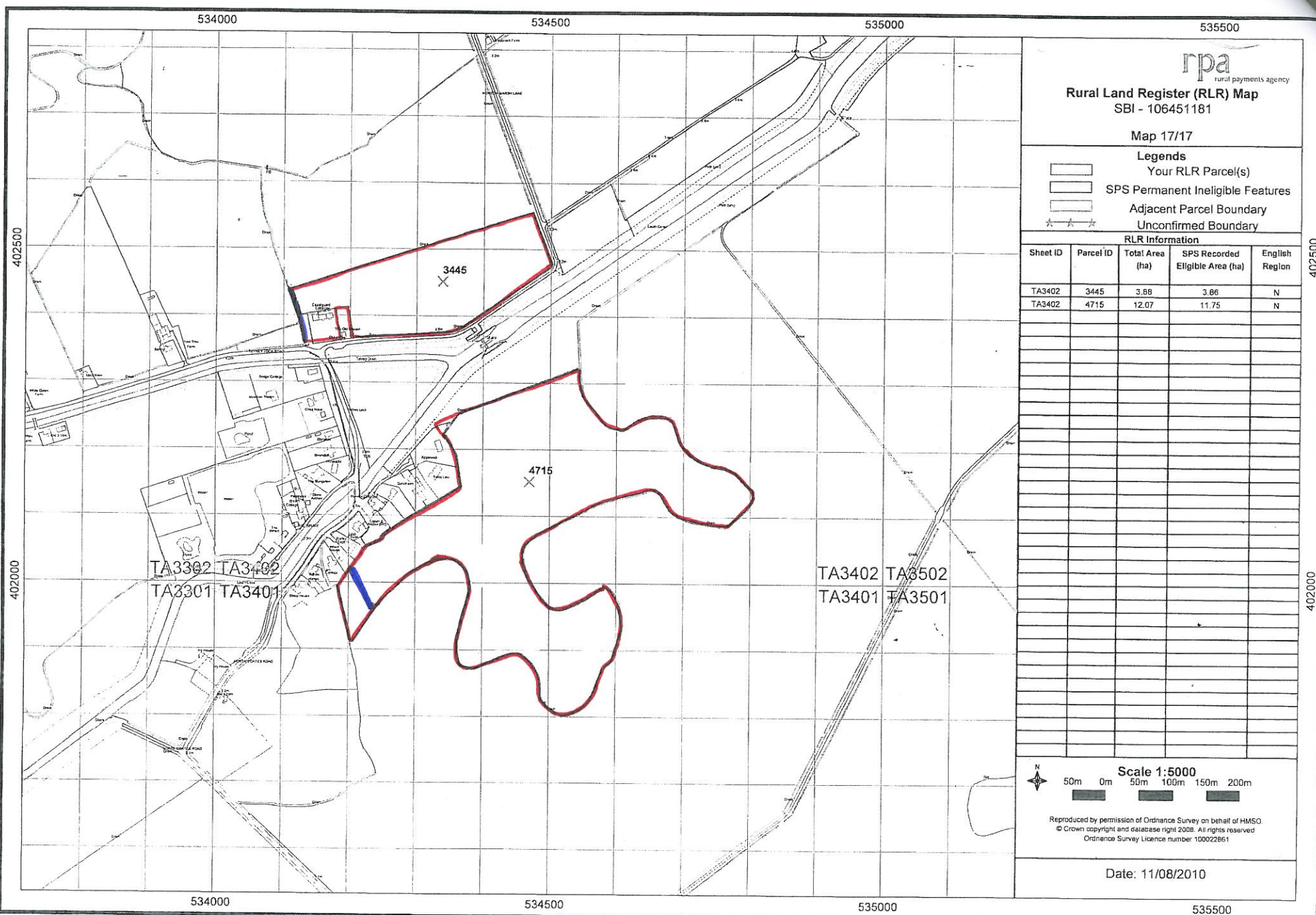

Please return this sheet to us if you want to make any changes to the parcels shown on it.

10. 'Appropriate authority' means (a) in relation to a map or statement deposited or declaration lodged under section 31(6) of that Act, an appropriate council (as defined in section 31(7) of the Highways Act 1980); and (b) in relation to a statement and map deposited under section 15A(1) of the 2006 Act, a commons registration authority (defined in section 4 of the Commons Act 2006 and section 2 of the Commons Registration Act 1965). In practice, the appropriate council and commons registration authority will usually be the same body.

PART A: Information relating to the applicant and land to which the application relates
(all applicants must complete this Part)

1. Name of appropriate authority to which the application is addressed:
LINCOLNSHIRE COUNTY COUNCIL

2. Name and full address (including postcode) of applicant:
GRAINSBY FARMS LIMITED, GRAINSBY ESTATE OFFICE, GRAINSBY, GRIMSBY, SOUTH HUMBERSIDE DN36 5PU

3. Status of applicant (tick relevant box or boxes):

I am

(b) making this application and the statements/declarations it contains on behalf of GRAINSBY FARMS LIMITED who is the owner of the land(s) described in paragraph 4 and in my capacity as DIRECTOR OF GRAINSBY FARMS LIMITED.

4. Insert description of the land(s) to which the application relates (including full address and postcode):

LAND AT TETNEY LOCK

5. Ordnance Survey six-figure grid reference(s) of a point within the area of land(s) to which the application relates (if known):

6. This deposit comprises the following statement(s) and/or declarations (*delete Parts B, C, or D where not applicable*):

PART C: Declaration under section 31(6) of the Highways Act 1980

1. GRAINSBY FARMS LIMITED is the owner of the land described in paragraph 4 of Part A of this form and shown EDGED RED on the map lodged with LINCOLNSHIRE COUNTY COUNCIL on 23 JANUARY 2014.

2. On the 23RD day of JANUARY 2014 GRAINSBY FARMS LIMITED deposited with LINCOLNSHIRE COUNTY COUNCIL, being the appropriate council, a statement accompanied by a map showing GRAINSBY FARMS LIMITED's property EDGED RED which stated that:

the ways shown COLOURED BLUE on that map had been dedicated as footpaths

no other ways had been dedicated as highways over GRAINSBY FARMS LIMITED's property.

3. No additional ways have been dedicated over the land EDGED RED on the map referenced in paragraph 1 above since the statement referred to in paragraph 2 above and at the present time GRAINSBY FARMS LIMITED has no intention of dedicating any more public rights of way over the property.

PART F: Statement of Truth
(all applicants must complete this Part)

WARNING: If you dishonestly enter information or make a statement that you know is, or might be, untrue or misleading, and intend by doing so to make a gain for yourself or another person, or to cause loss or the risk of loss to another person, you may commit the offence of fraud under section 1 of the Fraud Act 2006, the maximum penalty for which is 10 years' imprisonment or an unlimited fine, or both.

I BELIEVE THAT THE FACTS AND MATTERS CONTAINED IN THIS FORM ARE TRUE

Signature (of the person making the statement of truth):

Print full name: RICHARD HOLLAND CATON HAIGH

Date: 14/03/2014

You should keep a copy of the completed form

Data Protection Act 1998 - Fair Processing Notice

The purpose of this Fair Processing Notice is to inform you of the use that will be made of your personal data, as required by the Data Protection Act 1998.

The appropriate authority (see explanation of definition in above guidance notes) in England is the data controller in respect of any personal data that you provide when you complete this form.

The information that you provide will be used by the appropriate authority in its duties to process applications to deposit statements, maps and declarations under section 31(6) the Highways Act 1980 and statements under section 15A(1) of the Commons Act 2006. The information you provide will also be used by the appropriate authority in its duty to update the registers in which details of such deposits are recorded under the Dedicated Highways (Registers under Section 31A of the Highways Act 1980) (England) Regulations 2007 and the Commons (Registration of Town or Village Greens) and Dedicated Highways (Landowner Statements and Declarations) (England) Regulations 2013.

The appropriate authority is required by the legislation above to maintain a register which holds