

10. 'Appropriate authority' means (a) in relation to a map or statement deposited or declaration lodged under section 31(6) of that Act, an appropriate council (as defined in section 31(7) of the Highways Act 1980); and (b) in relation to a statement and map deposited under section 15A(1) of the 2006 Act, a commons registration authority (defined in section 4 of the Commons Act 2006 and section 2 of the Commons Registration Act 1965). In practice, the appropriate council and commons registration authority will usually be the same body.

**PART A: Information relating to the applicant and land to which the application relates**  
**(all applicants must complete this Part)**

1. Name of appropriate authority to which the application is addressed:

Lincolnshire County Council

2. Name and full address (including postcode) of applicant:

Mr Mark David Renshaw of 48 Burghley Street, Bourne, Lincolnshire PE 10 9NS  
Mrs Gillian Tait Renshaw of 17 Roseburn Drive, Holmhead, Cumnock, East Ayrshire, KA18 1DH

3. Status of applicant (tick relevant box or boxes):

We are

(a) ☒ the joint owners of the land described in paragraph 4.

(b) ☐ making this application and the statements/declarations it contains on behalf of [insert name of owner] who is the owner of the land(s) described in paragraph 4 and in my capacity as [insert details].

4. Insert description of the land(s) to which the application relates (including full address and postcode):

Land lying to the South of Birchwood Avenue, Lincoln LN6 3RB registered at the Land Registry under Title Number LL33881.

5. Ordnance Survey six-figure grid reference(s) of a point within the area of land(s) to which the application relates (if known): SK9368NE

6. This deposit comprises the following statement(s) and/or declarations

**PART B: Statement under section 31(6) of the Highways Act 1980**

We are the joint owners of the land described in paragraph 4 of Part A of this form and shown red on the map previously deposited with Lincolnshire County Council in accordance with section 31(6) of the Highways Act 1980 on 30 July 2009.

Ways shown green on the previously deposited map are public footpaths.

No other ways over the land shown red on the previously deposited map have been dedicated as highways.

### **PART E: Additional information relevant to the application**

Highways Statement previously deposited with the Lincolnshire County Council with respect to the land described in paragraph 4 of Part A of this form on 30 July 2009.

Highways Declaration previously deposited with the Lincolnshire County Council with respect to the land described in paragraph 4 of Part A of this form on 7 September 2009.

### **PART F: Statement of Truth** *(all applicants must complete this Part)*

**WARNING:** If you dishonestly enter information or make a statement that you know is, or might be, untrue or misleading, and intend by doing so to make a gain for yourself or another person, or to cause loss or the risk of loss to another person, you may commit the offence of fraud under section 1 of the Fraud Act 2006, the maximum penalty for which is 10 years' imprisonment or an unlimited fine, or both.

**I BELIEVE THAT THE FACTS AND MATTERS CONTAINED IN THIS FORM ARE TRUE**

**Signature (of the person making the statement of truth):**

**Print full name:** Mark David Renshaw

**Date**

10/11/2024

Gillian Tait Renshaw

**Date:**

14/5/24

**You should keep a copy of the completed form**

### **Data Protection Act 1998 - Fair Processing Notice**

The purpose of this Fair Processing Notice is to inform you of the use that will be made of your personal data, as required by the Data Protection Act 1998.

The appropriate authority (see explanation of definition in above guidance notes) in England is the data controller in respect of any personal data that you provide when you complete this form.

The information that you provide will be used by the appropriate authority in its duties to process applications to deposit statements, maps and declarations under section 31(6) the Highways Act 1980 and statements under section 15A(1) of the Commons Act 2006. The information you provide will also be used by the appropriate authority in its duty to update the registers in which details of such deposits are recorded under the Dedicated Highways (Registers under Section 31A of the Highways Act 1980) (England) Regulations 2007 and the Commons (Registration of Town or Village Greens) and Dedicated Highways (Landowner Statements and Declarations) (England) Regulations 2013.

The appropriate authority is required by the legislation above to maintain a register which holds information provided in this form, which can be inspected online or in person by members of the public on request. It may also be required to release information, including personal data and commercial information, on request under the Environmental Information Regulations 2004 or the Freedom of Information Act 2000. However, the appropriate authority will not permit any unwarranted breach of confidentiality nor will they act in contravention of their obligations under the Data Protection Act 1998.



# Land Registry Index map plan

Ordnance Survey map reference **SK9368NE**  
Scale **1:2500**  
Plan prepared on **15/05/2009** at **00:00:01**

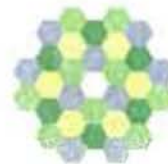

© Crown Copyright. Produced by Land Registry. Reproduction in whole or in part is prohibited without the prior written permission of Ordnance Survey. Licence Number 100026316.



This plan should be read in conjunction with result M71IVIB.

This plan shows the general position, not the exact line, of the boundaries. It may be subject to distortions in scale. Measurements scaled from this plan may not match measurements between the same points on the ground. See Land Registry Public Guide 19 - Title Plans and Boundaries.



**DEPOSIT OF STATEMENT AND MAP**

**SECTION 31(6) OF THE HIGHWAYS ACT 1980**  
**(as amended by the Countryside and Rights of Way Act 2000)**

**TO: LINCOLNSHIRE COUNTY COUNCIL**

1. I am and have been since 13 July 2009 the owner and joint registered proprietor within the meaning of the above section of land known as Great Botany Bay Plantation, Birchwood Avenue, Lincoln, registered at the Land Registry under Title number LL33881 more particularly delineated on the map accompanying this statement and thereon edged red.
2. The aforementioned land lies in the city of Lincoln.
3. The way coloured green on the plan accompanying this statement has been dedicated as a Highway maintainable at public expense.
4. No other ways over the land have been dedicated as highways, public paths, bridleways or roads used as a public path or byway.
5. The deposit comprises this statement and accompanying map.

Signed:  .....

Mark David Renshaw

of 14 Stanley Street, Bourne, Lincolnshire, PE10 9BZ

Date: 24 July 2009 .....



# Land Registry Index map plan

Ordnance Survey map reference **SK9368NE**

Scale **1:2500**

Plan prepared on **15/05/2009** at **00:00:01**

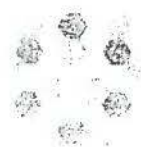

© Crown Copyright. Produced by Land Registry. Reproduction in whole or in part is prohibited without the prior written permission of Ordnance Survey. Licence Number 100026316.



This plan should be read in conjunction with result M71IVIB.

This plan shows the general position, not the exact line, of the boundaries. It may be subject to distortions in scale. Measurements scaled from this plan may not match measurements between the same points on the ground. See Land Registry Public Guide 19 - Title Plans and Boundaries.





**STATUTORY DECLARATION**  
**SECTION 31(6) OF THE HIGHWAYS ACT 1980**  
**(as amended by the Countryside and Rights of Way Act 2000)**

I MARK RENSHAW DO SOLEMNLY AND SINCERELY DECLARE as follows:

1. I am have been since the 13<sup>th</sup> day of July 2009 the owner and joint registered proprietor of the land known as Great Botany Bay Plantation, Birchwood Avenue, Lincoln, registered at the Land registry under Title Number LL33881, more particularly delineated on the map accompanying this declaration and thereon edged red
2. On the 30 day of July 2009 I deposited with Lincolnshire County Council, being the appropriate Council, a signed Statement accompanied by a map delineating my property by red edging which stated that the ways coloured green on the said map had been dedicated as Highways maintainable at the public expense.
3. No additional ways have been dedicated over the land edged red on the map accompanying this declaration since the Statement dated the 24<sup>th</sup> day of July 2009 referred to in paragraph (2) above other than those highways dedicated maintainable at the public expense marked green and at the present time I have no intention of dedicating any more public rights of way over my property

AND I MAKE this solemn declaration on the 2nd day of September 2009 conscientiously believing it to be true and by virtue of the Statutory Declarations Act 1835.

Declared at

46 Silver Street

Lincoln LN2 1ED

Signature of landowner

Before me

Solicitor

WE HEREBY CERTIFY THIS DOCUMENT  
TO William Chapman  
ON 4.9.09  
WITNESSED BY MAN EPTON BLADES  
SOLICITOR  
BANBURY  
LINCOLN LN2 1DR

[REDACTED]

This is the plan marked referred to in the annexed declaration of Mark Renshaw  
declared this 2nd day of September 2009

Before me..... [REDACTED] .....

*Solicitor*

SILLS & BETTERIDGE LLP  
SOLICITORS  
46 SILVER STREET  
LINCOLN LN2 1ED



# Land Registry Index map plan

Ordnance Survey map reference **SK9368NE**

Scale **1:2500**

Plan prepared on **15/05/2009** at **00:00:01**

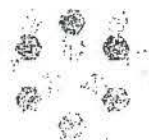

© Crown Copyright. Produced by Land Registry. Reproduction in whole or in part is prohibited without the prior written permission of Ordnance Survey. Licence Number 100026316.

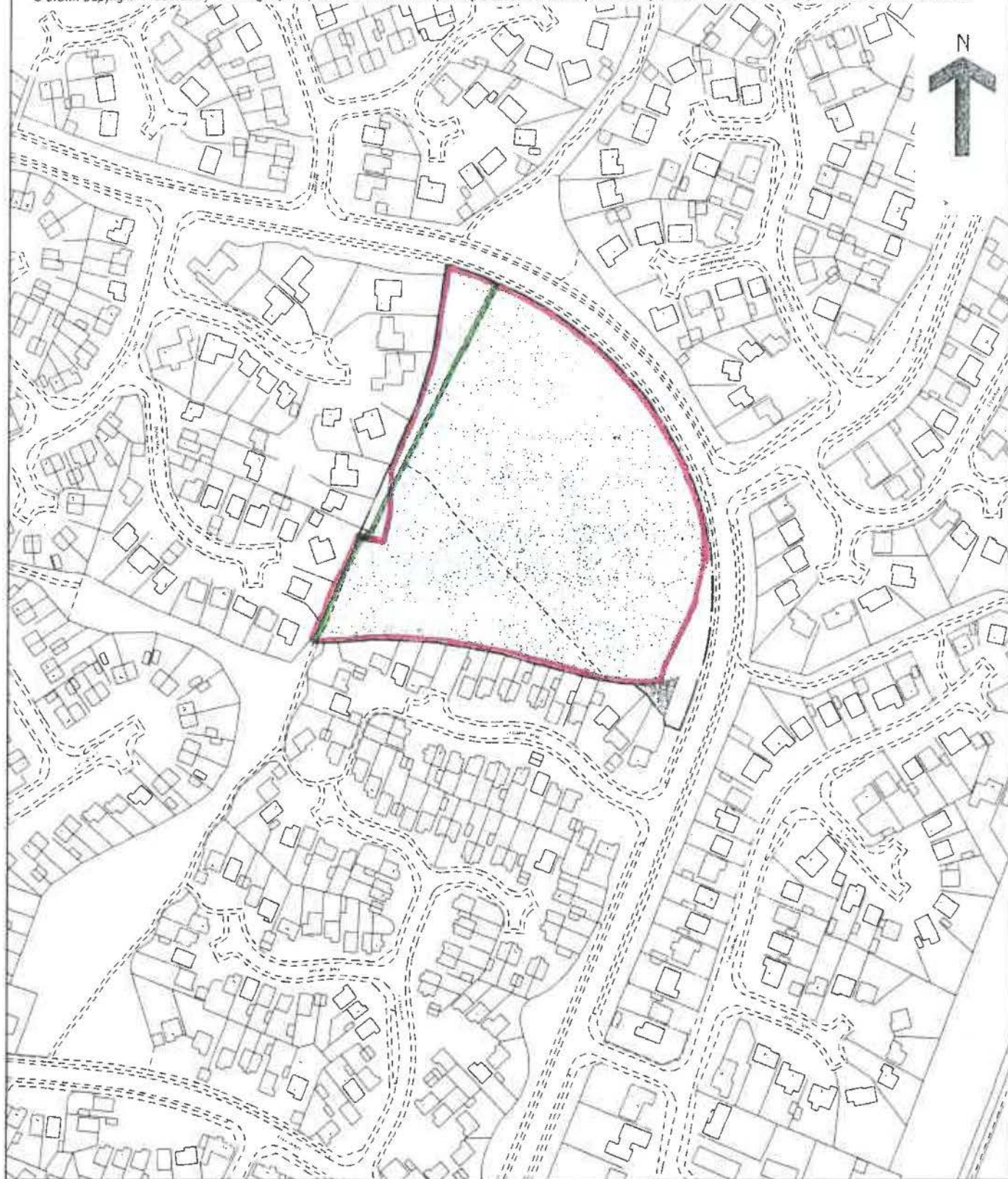

This plan should be read in conjunction with result M71IVIB.

This plan shows the general position, not the exact line, of the boundaries. It may be subject to distortions in scale. Measurements scaled from this plan may not match measurements between the same points on the ground. See Land Registry Public Guide 19 - Title Plans and Boundaries.





1980); and (b) in relation to a statement and map deposited under section 15A(1) of the 2006 Act, a commons registration authority (defined in section 4 of the Commons Act 2006 and section 2 of the Commons Registration Act 1965). In practice, the appropriate council and commons registration authority will usually be the same body.

**PART A: Information relating to the applicant and land to which the application relates**  
**(all applicants must complete this Part)**

1. Name of appropriate authority to which the application is addressed:

Lincolnshire County Council

2. Name and full address (including postcode) of applicant:

Mr Mark David Renshaw of 48 Burghley Street, Bourne, Lincolnshire PE10 9NS  
Mrs Gillian Tait Renshaw of 17 Roseburn Drive, Holmhead, Cumnock, East Ayrshire, KA18 1DH

3. Status of applicant (tick relevant box or boxes):

We are

- (a) ☒ the owners of the land(s) described in paragraph 4.  
(b) ☐ making this application and the statements/declarations it contains on behalf of [insert name of owner] who is the owner of the land(s) described in paragraph 4 and in my capacity as [insert details].

4. Insert description of the land(s) to which the application relates (including full address and postcode):

Land lying to the South of Birchwood Avenue, Lincoln LN6 3RB registered at the Land Registry under Title Number LL33881

5. Ordnance Survey six-figure grid reference(s) of a point within the area of land(s) to which the application relates (if known): SK9368NE

6. This deposit comprises the following statement(s) and/or declarations

**PART C: Declaration under section 31(6) of the Highways Act 1980**

1. We, Mark David Renshaw and Gillian Tait Renshaw are the owners of the land described in paragraph 4 of Part A of this form and shown red on the map lodged with Lincolnshire County Council on 13 June 2024.

2. On the 13th day of June 2024 we deposited with Lincolnshire County Council, being the appropriate council, statements dated 14 May 2024 (Mrs Gillian Tait Renshaw) and 10 June 2024 (Mr Mark David Renshaw) accompanied by a map showing our property shown red which stated that:

The ways shown green on that had been dedicated as public footpaths.

No other ways had been dedicated as highways over our property.

3. No additional ways have been dedicated over the land shown red on the map referenced in paragraph 1 above since the statements dated 14 May 2024 and 10 June 2024 referred to in paragraph 2 above and at the present time, we have no intention of dedicating any more public rights of way over the property.

**PART F: Statement of Truth**  
**(all applicants must complete this Part)**

**WARNING:** If you dishonestly enter information or make a statement that you know is, or might be, untrue or misleading, and intend by doing so to make a gain for yourself or another person, or to cause loss or the risk of loss to another person, you may commit the offence of fraud under section 1 of the Fraud Act 2006, the maximum penalty for which is 10 years' imprisonment or an unlimited fine, or both.

**WE BELIEVE THAT THE FACTS AND MATTERS CONTAINED IN THIS FORM ARE TRUE**

Signature:

Print full name: Mark David Renshaw

Date:

5/7/2024

Signature:

Print full name: Gillian Tait Renshaw

Date:

21/6/24

**You should keep a copy of the completed form**

#### **Data Protection Act 1998 - Fair Processing Notice**

The purpose of this Fair Processing Notice is to inform you of the use that will be made of your personal data, as required by the Data Protection Act 1998.

The appropriate authority (see explanation of definition in above guidance notes) in England is the data controller in respect of any personal data that you provide when you complete this form.

The information that you provide will be used by the appropriate authority in its duties to process applications to deposit statements, maps and declarations under section 31(6) the Highways Act 1980 and statements under section 15A(1) of the Commons Act 2006. The information you provide will also be used by the appropriate authority in its duty to update the registers in which details of such deposits are recorded under the Dedicated Highways (Registers under Section 31A of the Highways Act 1980) (England) Regulations 2007 and the Commons (Registration of Town or Village Greens) and Dedicated Highways (Landowner Statements and Declarations) (England) Regulations 2013.

The appropriate authority is required by the legislation above to maintain a register which holds information provided in this form, which can be inspected online or in person by members of the public on request. It may also be required to release information, including personal data and commercial information, on request under the Environmental Information Regulations 2004 or the Freedom of Information Act 2000. However, the appropriate authority will not permit any unwarranted breach of confidentiality nor will they act in contravention of their obligations under the Data Protection Act 1998.