

**Parish:** Harlaxton  
**Title:** Land at Park Farm, Harlaxton  
**Reference number:** CA/7/1/473

**HIGHWAYS ACT 1980, SECTION 31 (6) – DEPOSITED MAPS, HIGHWAYS STATEMENT AND HIGHWAYS DECLARATIONS**

**Date of deposit of map and highways statement** 13.02.2019

**Depositor's name and address** University of Evansville (Harlaxton College) c/o Strutt & Parker, 5 South View Business Park, Tinwell Road, Stamford, PE9 2JL

**Dates of deposit of highways declarations and names and addresses of depositors** (1) 20.02.2019: University of Evansville (Harlaxton College) c/o Strutt & Parker, 5 South View Business Park, Tinwell Road, Stamford, PE9 2JL

**Date deposit expires:** 19.02.2039

**COMMONS ACT 2006, SECTION 15A (1) – DEPOSITED MAPS AND LANDOWNER STATEMENTS**

**Dates of deposit of maps and landowner statements, and names and addresses of depositors** (1) 13.02.2019: University of Evansville (Harlaxton College) c/o Strutt & Parker, 5 South View Business Park, Tinwell Road, Stamford, PE9 2JL  
*[combined deposit]*

**GEOGRAPHIC LOCATION**

**Grid Reference:** SK891 325

**Address and postcode of buildings on the deposited land** Harlaxton Manor; Gardeners House; The Gate House, Flats 1 & 2, Harlaxton, Grantham, NG32 1AG

**District** South Kesteven

**Nearest city or town** Grantham

**ENQUIRIES ABOUT THE REGISTER OR DEPOSITS**

Enquiries concerning the register or the deposits lodged with the County Council should be made to the Definitive Map Officer at Lincolnshire County Council's Countryside Services Section by email to [countryside\\_access@lincolnshire.gov.uk](mailto:countryside_access@lincolnshire.gov.uk) or by telephone on 01522 782070.

**INFORMATION ABOUT THE REGISTER OF DEPOSITS**

The County Council is required by law to keep and maintain a register of highways statements and highways declarations deposited under section 31 (6) of the Highways Act 1980 and landowner statements deposited under section 15A (1) of the Commons Act 2006. The register is available for public inspection on its website and in a paper copy format, together with copies of the deposited documents. Details, including names, addresses and the location of land relating to an application, which may be considered to be personal information, will therefore be in the public domain. This requirement overrides any entitlement a depositor and landowner may otherwise have under the Data Protection Act 1998 to prevent the publication of such information.

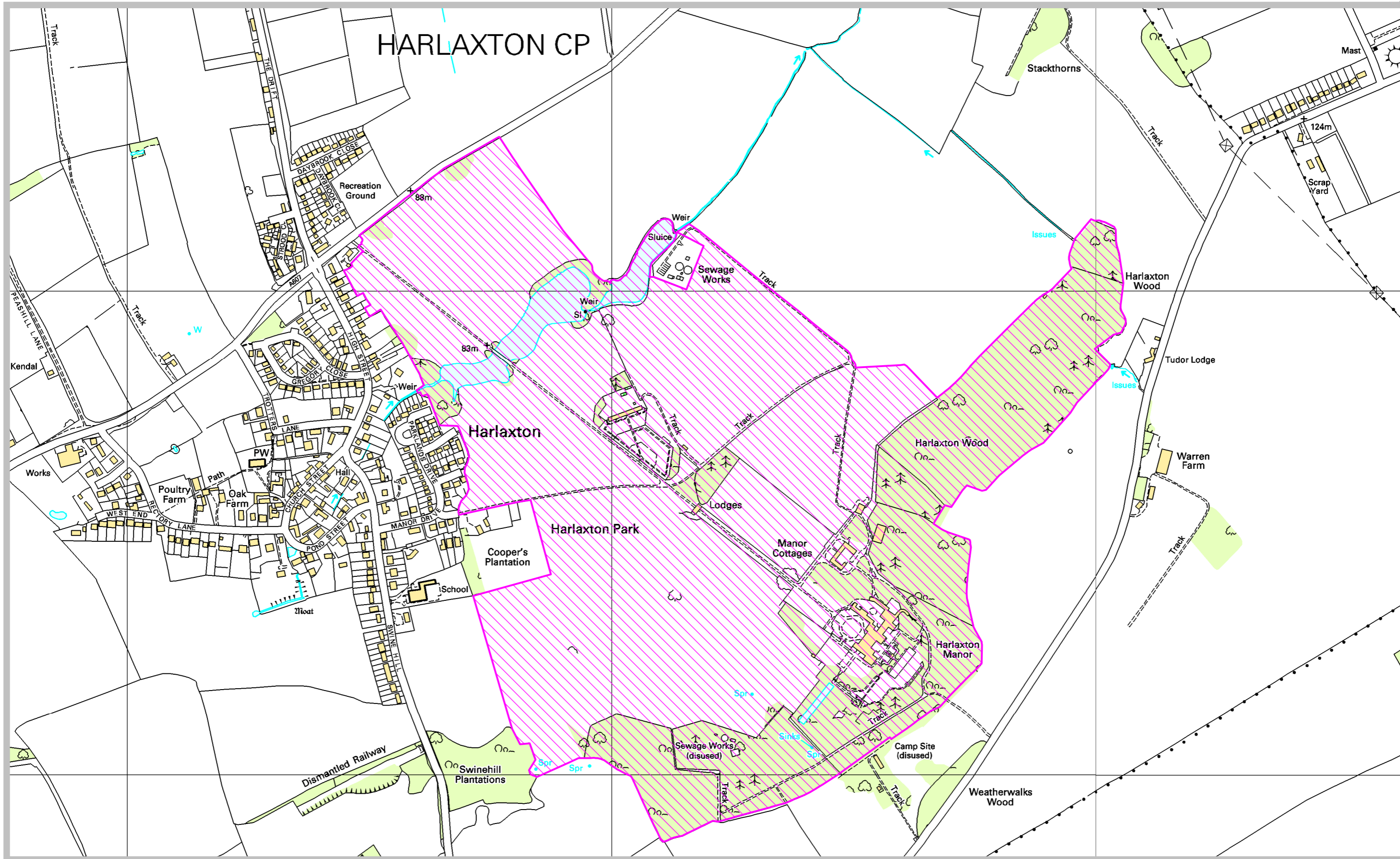

10. 'Appropriate authority' means (a) in relation to a map or statement deposited or declaration lodged under section 31(6) of that Act, an appropriate council (as defined in section 31(7) of the Highways Act 1980); and (b) in relation to a statement and map deposited under section 15A(1) of the 2006 Act, a commons registration authority (defined in section 4 of the Commons Act 2006 and section 2 of the Commons Registration Act 1965). In practice, the appropriate council and commons registration authority will usually be the same body.

**PART A: Information relating to the applicant and land to which the application relates**  
**(all applicants must complete this Part)**

1. Name of appropriate authority to which the application is addressed:  
Lincolnshire County Council

2. Name and full address (including postcode) of applicant:  
University of Evansville (Harlaxton College) c/o. Strutt & Parker, 5 South View Business Park, Tinwell Road, Stamford, PE9 2JL

3. Status of applicant (tick relevant box or boxes):

I am

(a)  the owner of the land(s) described in paragraph 4.

(b)  making this application and the statements/declarations it contains on behalf of The University of Evansville (Harlaxton College) who is the owner of the land(s) described in paragraph 4 and in my capacity as Agent.

4. Insert description of the land(s) to which the application relates (including full address and postcode):

Park Farm, Harlaxton, Grantham, Lincolnshire, NG32 1AG

5. Ordnance Survey six-figure grid reference(s) of a point within the area of land(s) to which the application relates (if known):

SK 894323

6. This deposit comprises the following statement(s) and/or declarations: Parts B, D and F.

**PART B: Statement under section 31(6) of the Highways Act 1980**

The University of Evansville (Harlaxton College) is the owner of the land described in paragraph 4 of Part A of this form and shown shaded pink on the map accompanying this statement.

Ways shown with a purple dashed line on the accompanying map are public footpaths.

No other ways over the land shown shaded pink on the accompanying map have been dedicated as highways.

**PART D: Statement under section 15A(1) of the Commons Act 2006**

The University of Evansville (Harlaxton College) is the owner of the land described in paragraph 4 of Part A of this form and shown shaded pink on the map accompanying this statement.

The University of Evansville (Harlaxton College) wishes to bring to an end any period during which persons may have indulged as of right in lawful sports and pastimes on the whole or any part of the land shown shaded pink on the accompanying map.

**PART F: Statement of Truth**  
**(all applicants must complete this Part)**

**WARNING: If you dishonestly enter information or make a statement that you know is, or might be, untrue or misleading, and intend by doing so to make a gain for yourself or another person, or to cause loss or the risk of loss to another person, you may commit the offence of fraud under section 1 of the Fraud Act 2006, the maximum penalty for which is 10 years' imprisonment or an unlimited fine, or both.**

**I BELIEVE THAT THE FACTS AND MATTERS CONTAINED IN THIS FORM ARE TRUE**

**Signature (of the person making the statement of truth):** 

**Print full name: John Goldingham (Strutt & Parker)**

**Date: 11<sup>th</sup> February 2019**

**You should keep a copy of the completed form**

**Data Protection Act 1998 – Fair Processing Notice**

The purpose of this Fair Processing Notice is to inform you of the use that will be made of your personal data, as required by the Data Protection Act 1998.

The appropriate authority (see explanation of definition in above guidance notes) in England is the data controller in respect of any personal data that you provide when you complete this form.

The information that you provide will be used by the appropriate authority in its duties to process applications to deposit statements, maps and declarations under section 31(6) the Highways Act 1980 and statements under section 15A(1) of the Commons Act 2006. The information you provide will also be used by the appropriate authority in its duty to update the registers in which details of such deposits are recorded under the Dedicated Highways (Registers under Section 31A of the Highways Act 1980) (England) Regulations 2007 and the Commons (Registration of Town or Village Greens) and Dedicated Highways (Landowner Statements and Declarations) (England) Regulations 2013.

The appropriate authority is required by the legislation above to maintain a register which holds information provided in this form, which can be inspected online or in person by members of the public on request. It may also be required to release information, including personal data and commercial information, on request under the Environmental Information Regulations 2004 or the Freedom of Information Act 2000. However, the appropriate authority will not permit any unwarranted breach of confidentiality nor will they act in contravention of their obligations under the Data Protection Act 1998.

# University of Evansville - Park Farm, Harlaxton



I Certify that this plan shows all known public rights of way over Park Farm (Harlaxton) on behalf of the legal owner in title The University of Evansville.

This plan is published for the convenience of the purchaser only. Its accuracy is not guaranteed and it is expressly excluded from any contract.

Based on Ordnance Survey 1:2,500 mapping with the permission of the Controller of HMSO © Crown Copyright Licence No ES 100018525

Not to Scale. Drawing No. N6536-08 | Date 24.03.17



Dated: 11/02/19

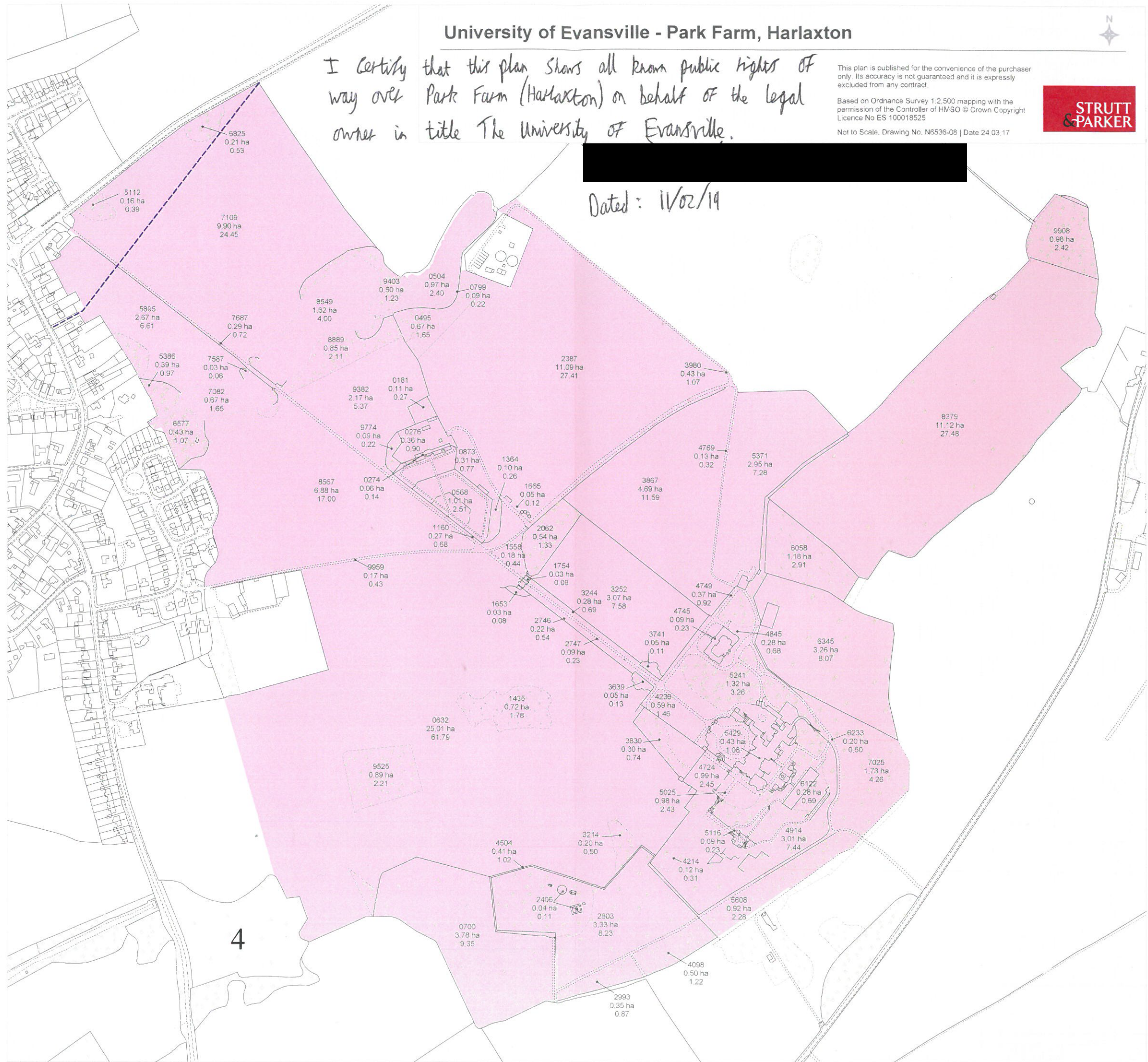

31(6) of the Highways Act 1980. Any accompanying map must be an ordnance map at a scale of not less than 1:10,560 showing the boundary of the land to which the application relates in coloured edging.

9. An application must be accompanied by the requisite fee – please ask the appropriate authority for details.

10. 'Appropriate authority' means (a) in relation to a map or statement deposited or declaration lodged under section 31(6) of that Act, an appropriate council (as defined in section 31(7) of the Highways Act 1980); and (b) in relation to a statement and map deposited under section 15A(1) of the 2006 Act, a commons registration authority (defined in section 4 of the Commons Act 2006 and section 2 of the Commons Registration Act 1965). In practice, the appropriate council and commons registration authority will usually be the same body.

**PART A: Information relating to the applicant and land to which the application relates**  
**(all applicants must complete this Part)**

1. Name of appropriate authority to which the application is addressed:  
Lincolnshire County Council

2. Name and full address (including postcode) of applicant:  
University of Evansville (Harlaxton College) c/o Strutt & Parker, 5 South View  
Business Park, Tinwell Road, Stamford, PE9 2JL

3. Status of applicant (tick relevant box or boxes):

I am

(a)  the owner of the land(s) described in paragraph 4.

(b)  making this application and the statements/declarations it contains on behalf of *The University of Evansville (Harlaxton College)* who is the owner of the land(s) described in paragraph 4 and in my capacity as *Agent*.

4. Insert description of the land(s) to which the application relates (including full address and postcode):

*Park Farm, Harlaxton, Grantham, Lincolnshire, NG32 1AG*

5. Ordnance Survey six-figure grid reference(s) of a point within the area of land(s) to which the application relates (if known):

SK 894323

6. This deposit comprises the following statement(s) and/or declarations: *Parts C and F*

**PART C: Declaration under section 31(6) of the Highways Act 1980**

1. *The University of Evansville (Harlaxton College)* is the owner of the land described in paragraph 4 of Part A of this form and shown shaded pink on the map accompanying this declaration/lodged with Lincolnshire Council on 13<sup>th</sup> February, 2019.

2. On the 13<sup>th</sup> day of February, 2019, *The University of Evansville (Harlaxton College)* deposited with *Lincolnshire County Council*, being the appropriate council, a statement accompanied by a map showing *University of Evansville (Harlaxton College)* property shaded pink which stated that:

*the ways shown with a purple dashed line on that map and on the map accompanying this declaration had been dedicated as footpaths.*

*No other ways had been dedicated as highways over The University of Evansville's (Harlaxton College's) property.*

4. No additional ways have been dedicated over the land shaded pink on the map referenced in paragraph 1 above since the statement dated 11th February, 2019 referred to in paragraph 2 above since the date of the declaration referred to in paragraph 3 above other than those footpaths marked in the appropriate colour on the map accompanying this declaration and at the present time *The University of Evansville (Harlaxton College)* has no intention of dedicating any more public rights of way over the property.

**PART F: Statement of Truth**  
**(all applicants must complete this Part)**

**WARNING:** If you dishonestly enter information or make a statement that you know is, or might be, untrue or misleading, and intend by doing so to make a gain for yourself or another person, or to cause loss or the risk of loss to another person, you may commit the offence of fraud under section 1 of the Fraud Act 2006, the maximum penalty for which is 10 years' imprisonment or an unlimited fine, or both.

**I BELIEVE THAT THE FACTS AND MATTERS CONTAINED IN THIS FORM ARE TRUE**

Signature (of the person making the statement of truth):



Print full name: John Goldingham (Strutt & Parker)

Date: 19/02/19

You should keep a copy of the completed form

**Data Protection Act 1998 – Fair Processing Notice**

The purpose of this Fair Processing Notice is to inform you of the use that will be made of your personal data, as required by the Data Protection Act 1998.



The appropriate authority (see explanation of definition in above guidance notes) in England is the data controller in respect of any personal data that you provide when you complete this form.

The information that you provide will be used by the appropriate authority in its duties to process applications to deposit statements, maps and declarations under section 31(6) of the Highways Act 1980 and statements under section 15A(1) of the Commons Act 2006. The information you provide will also be used by the appropriate authority in its duty to update the registers in which details of such deposits are recorded under the Dedicated Highways (Registers under Section 31A of the Highways Act 1980) (England) Regulations 2007 and the Commons (Registration of Town or Village Greens) and Dedicated Highways (Landowner Statements and Declarations) (England) Regulations 2013.

The appropriate authority is required by the legislation above to maintain a register which holds information provided in this form, which can be inspected online or in person by members of the public on request. It may also be required to release information, including personal data and commercial information, on request under the Environmental Information Regulations 2004 or the Freedom of Information Act 2000. However, the appropriate authority will not permit any unwarranted breach of confidentiality nor will they act in contravention of their obligations under the Data Protection Act 1998.