

10. 'Appropriate authority' means (a) in relation to a map or statement deposited or declaration lodged under section 31(6) of that Act, an appropriate council (as defined in section 31(7) of the Highways Act 1980); and (b) in relation to a statement and map deposited under section 15A(1) of the 2006 Act, a commons registration authority (defined in section 4 of the Commons Act 2006 and section 2 of the Commons Registration Act 1965). In practice, the appropriate council and commons registration authority will usually be the same body.

PART A: Information relating to the applicant and land to which the application relates
(all applicants must complete this Part)

1. Name of appropriate authority to which the application is addressed: **Lincolnshire County Council**

2. Name and full address (including postcode) of applicant:

Alfred Rose, Albion House, Manor Farm, Fillingham, Gainsborough, Lincolnshire. DN21 5BS

3. Status of applicant (tick relevant box or boxes):

I am

(a) the owner of the land(s) described in paragraph 4.

(b) making this application and the statements/declarations it contains on behalf of **The A G Rose (Decd) Trust, Albion House, Manor Farm, Fillingham, Gainsborough, Lincolnshire DN21 5BS** who is the owner of the land(s) described in paragraph 4 and in my capacity as a **Trustee of that Trust.**

4. Insert description of the land(s) to which the application relates (including full address and postcode):
Land .

The Freehold property as shown edged red on the attached maps. One map showing the areas around Ingham, the second map showing land to the west of the B1398 leading up to the A15, North East of Fillingham, the third map showing land to the west of the B1398 North of Fillingham, the 4th map shows land to the south east of Fillingham leading up to the B1398, the fifth showing land to the south of Fillingham and the 6th showing land to the west of Brink Hall farm Welton

5. Ordnance Survey six-figure grid reference(s) of a point within the area of land(s) to which the application relates (if known):

SK950839 Land to the North of Ingham, West of the B1398 (Horsefield)

SK 962839 Land to the North East of Ingham leading from the B1398 and the A 15 (Little/Big Drome fields)

SK 961868 Land east of the B1398 leading up to the A 15 North of Fillingham Park (Strip Field)

SK942866 Land North of Fillingham. (Middle Field)

SK952852 Land West of the B1398, South East of Fillingham.

SK962853 Land to the East of the B1398 leading to the A 15., South of Fillingham Park.

SK936842 Land to the South of Fillingham- Willingham road (Hungrills)

SK946858 Land By Rectory Lea in Fillingham

SK993801 Land to the West of Brink Hall Farm Welton.

6. This deposit comprises the following statement(s) and/or declarations (*delete Parts B, C, or D where not applicable*):

PART B: Statement under section 31(6) of the Highways Act 1980

The A G Rose (Deed) Trust is the owner of the land described in paragraph 4 of Part A of this form and shown **Bordered Red** on the maps accompanying this statement.

(delete wording in square brackets as appropriate and/or insert information as required)

[Ways shown **Long Broken Green** on the accompanying map are public bridleways.]

[Ways shown **Short Broken Green** on the accompanying map are public footpaths.]

No [other] ways over the land shown [*insert colouring*] on the accompanying map have been dedicated as highways.

(delete wording in square brackets as appropriate and/or insert information as required)

PART C: Declaration under section 31(6) of the Highways Act 1980

1. [I am/[insert name of owner] is] the owner of the land described in paragraph 4 of Part A of this form and shown [insert colouring] on the map [accompanying this declaration/lodged with [insert name] Council on [insert day, month, year]].

(delete wording in square brackets as appropriate and/or insert information as required)

2. On the [insert day] day of [insert month, year] [I/my/[insert name of owner's] predecessor in title [insert name]] deposited with [insert name] Council, being the appropriate council, a statement accompanied by a map showing [my/[insert name of owner's]] property [insert colouring] which stated that:

[the ways shown [insert colouring] on that map [and on the map accompanying this declaration] had been dedicated as byways open to all traffic]

[the ways shown [insert colouring] on that map [and on the map accompanying this declaration] had been dedicated as restricted byways]

[the ways shown [insert colouring] on that map [and on the map accompanying this declaration] had been dedicated as bridleways]

[the ways shown [insert colouring] on that map [and on the map accompanying this declaration] had been dedicated as footpaths]

[no [other] ways had been dedicated as highways over [my/[insert name of owner's]] property]. *(delete wording in square brackets as appropriate and/or insert information as required)*

3. On the [insert day] day of [insert month, year] [I/my/[insert name of owner's] predecessor in title [insert name]] deposited with [insert name] Council, being the appropriate council, a declaration dated [insert day, month, year], stating that no additional ways [other than those marked in the appropriate colour on the map accompanying that declaration] had been dedicated as [byways open to all traffic] [restricted byways] [bridleways] [footpaths] since the deposit of the statement referred to in paragraph 2 above.]

(delete if not applicable and delete wording in square brackets as appropriate and/or insert information as required)

4. No additional ways have been dedicated over the land [insert colouring] on the map [accompanying this declaration/referenced in paragraph 1 above] since the statement dated [insert day, month, year] referred to in paragraph 2 above [since the date of the declaration referred to in paragraph 3 above] [other than those [byways open to all traffic] [restricted byways] [bridleways] [footpaths] marked in the appropriate colour on the map accompanying this declaration] and at the present time [I/[insert name of owner]] [have/has] no intention of dedicating any more public rights of way over [my/the] property.

(delete wording in square brackets as appropriate and/or insert information as required)

PART D: Statement under section 15A(1) of the Commons Act 2006

[I am/[insert name of owner] is] the owner of the land described in paragraph 4 of Part A of this form and shown [insert colouring] on the map [accompanying this statement/deposited with [insert name] Council on [insert day, month, year]].

[I/[insert name of owner]] [wish/wishes] to bring to an end any period during which persons may have indulged as of right in lawful sports and pastimes on the whole or any part of the land shown [insert colouring] on the [accompanying map/map referenced above].

(delete wording in square brackets as appropriate and/or insert information as required)

PART E: Additional information relevant to the application
(insert any additional information relevant to the application)

PART F: Statement of Truth
(all applicants must complete this Part)

WARNING: If you dishonestly enter information or make a statement that you know is, or might be, untrue or misleading, and intend by doing so to make a gain for yourself or another person, or to cause loss or the risk of loss to another person, you may commit the offence of fraud under section 1 of the Fraud Act 2006, the maximum penalty for which is 10 years' imprisonment or an unlimited fine, or both.

I BELIEVE THAT THE FACTS AND MATTERS CONTAINED IN THIS FORM ARE TRUE

Signature (of the person making the statement of truth):

Print full name: Alfred Charles Rose

Date: 6th September 2023

You should keep a copy of the completed form

Data Protection Act 1998 - Fair Processing Notice

The purpose of this Fair Processing Notice is to inform you of the use that will be made of your personal data, as required by the Data Protection Act 1998.

The appropriate authority (see explanation of definition in above guidance notes) in England is the data controller in respect of any personal data that you provide when you complete this form.

The information that you provide will be used by the appropriate authority in its duties to process applications to deposit statements, maps and declarations under section 31(6) the Highways Act 1980 and statements under section 15A(1) of the Commons Act 2006. The information you provide will also be used by the appropriate authority in its duty to update the registers in which details of such deposits are recorded under the Dedicated Highways (Registers under Section 31A of the Highways Act 1980) (England) Regulations 2007 and the Commons (Registration of Town or Village Greens) and Dedicated Highways (Landowner Statements and Declarations) (England) Regulations 2013.

The appropriate authority is required by the legislation above to maintain a register which holds information provided in this form, which can be inspected online or in person by members of the public on request. It may also be required to release information, including personal data and commercial information, on request under the Environmental Information Regulations 2004 or the Freedom of Information Act 2000. However, the appropriate authority will not permit any unwarranted breach of confidentiality nor will they act in contravention of their obligations under the Data Protection Act 1998.

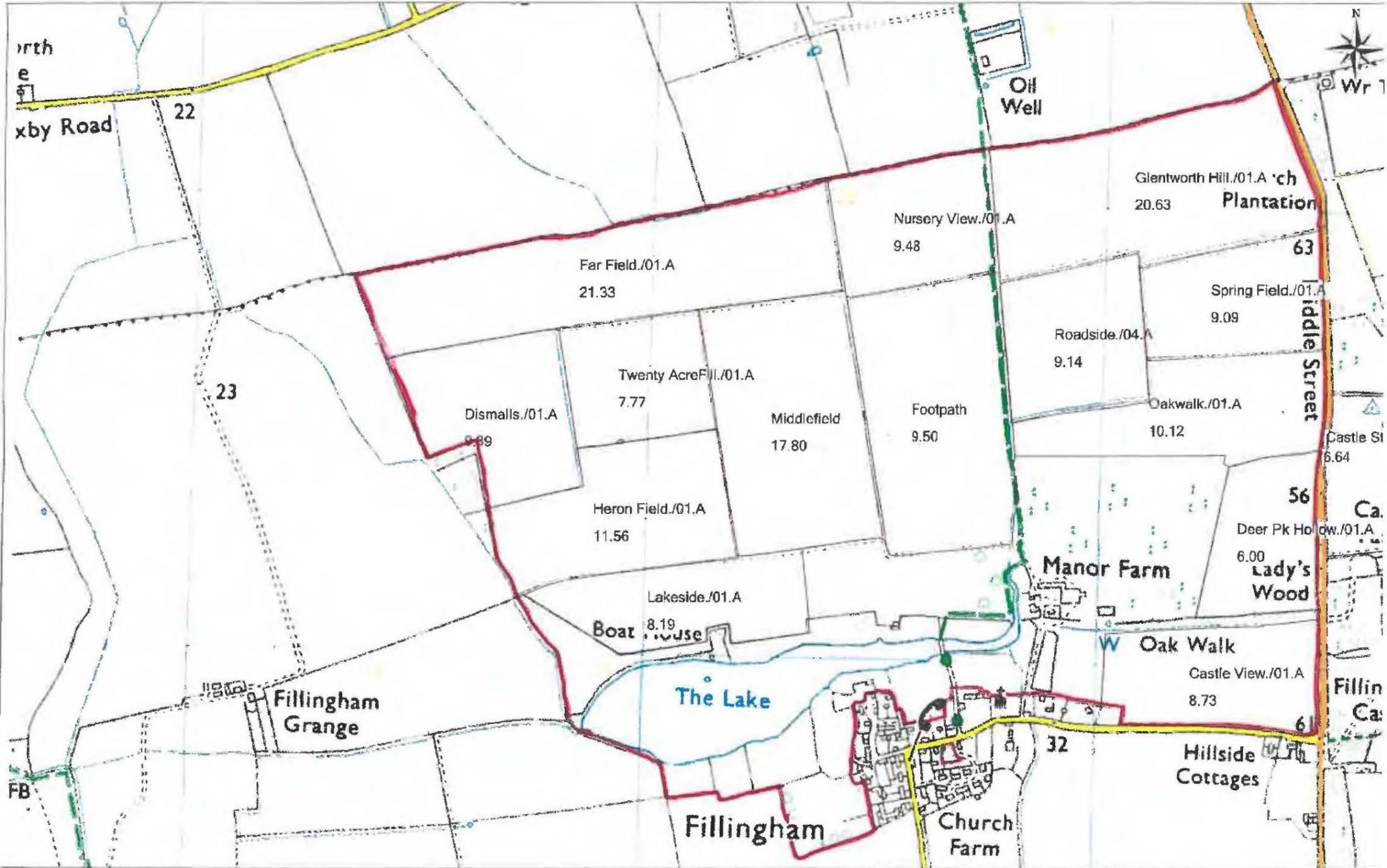

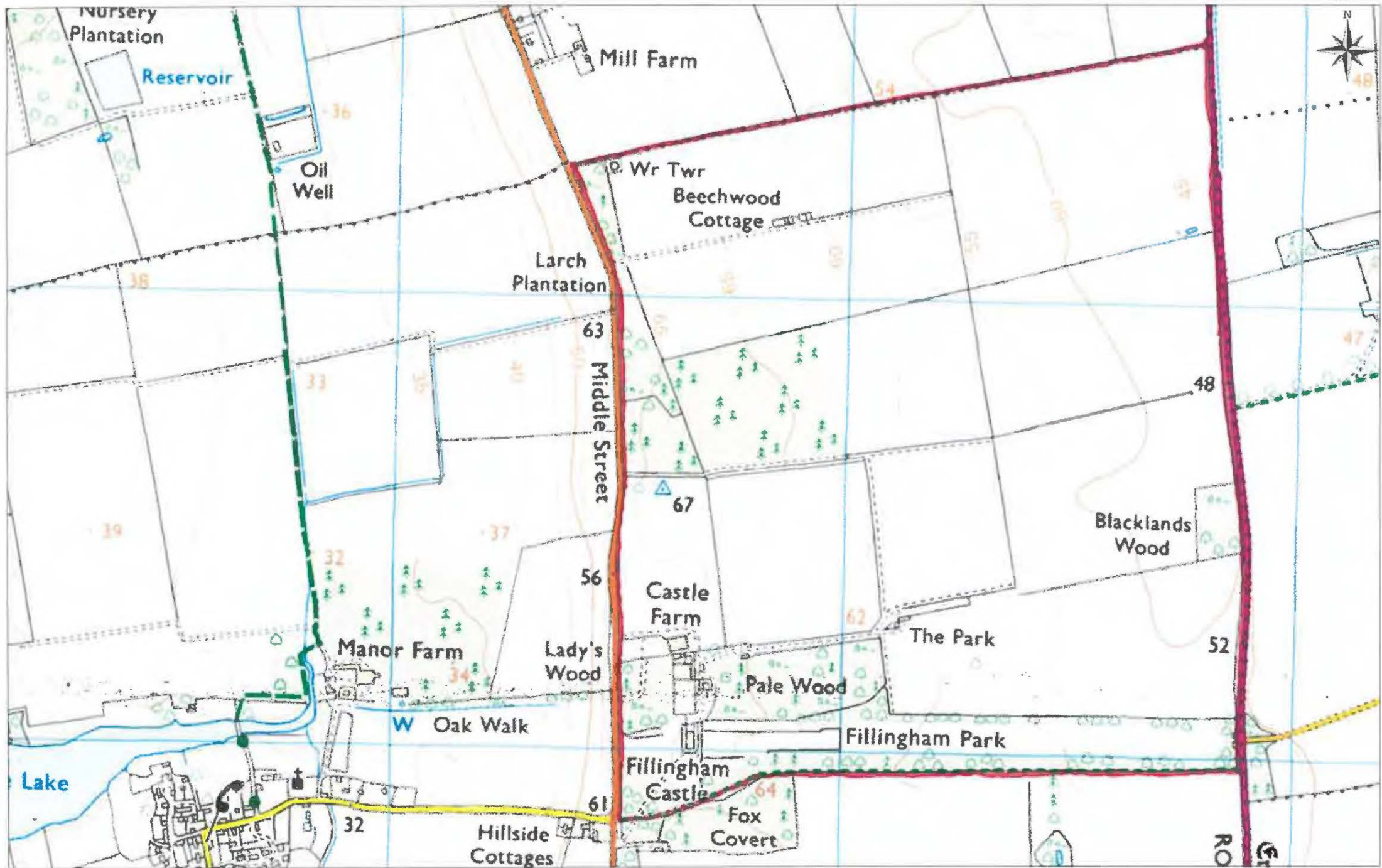



Sept

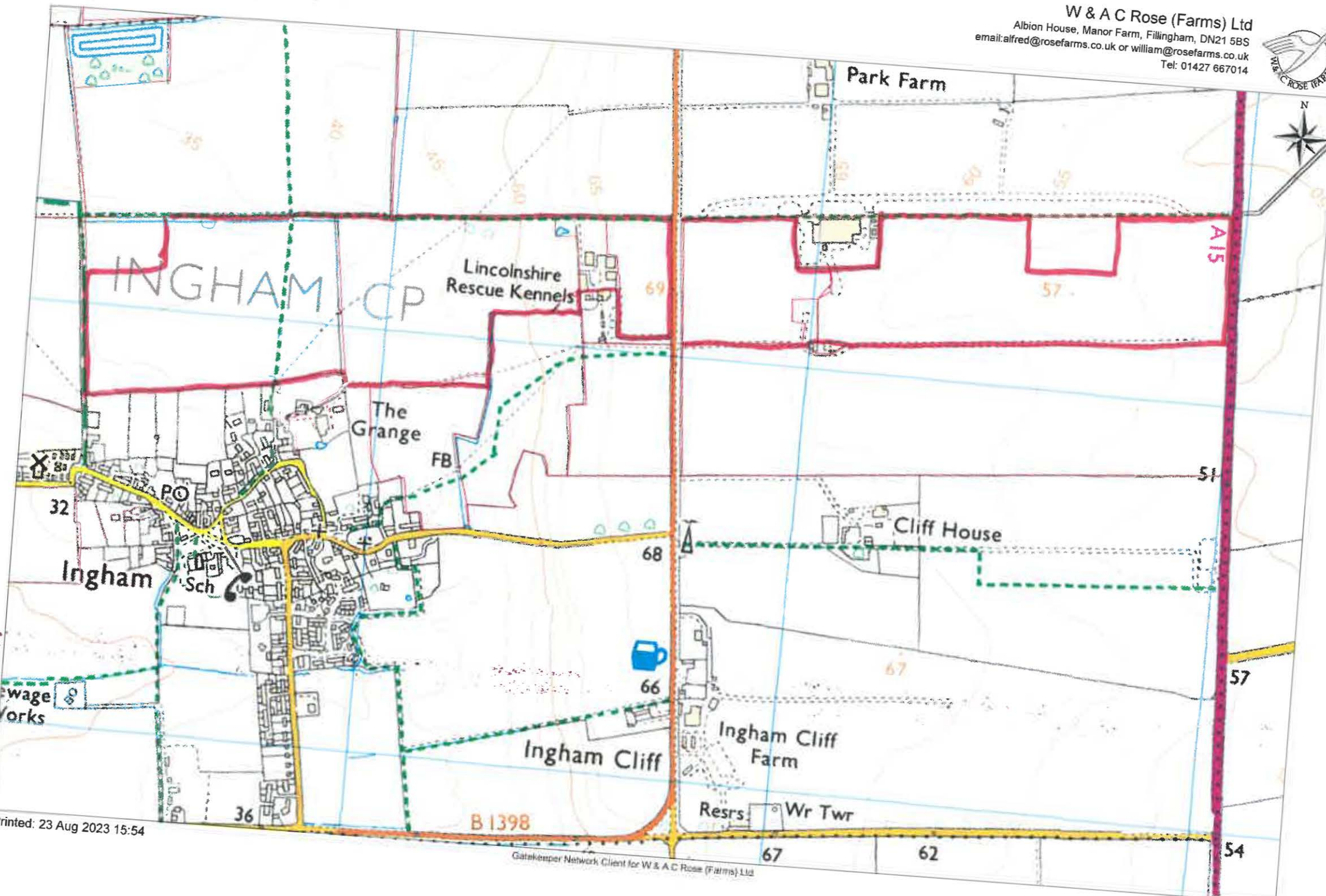

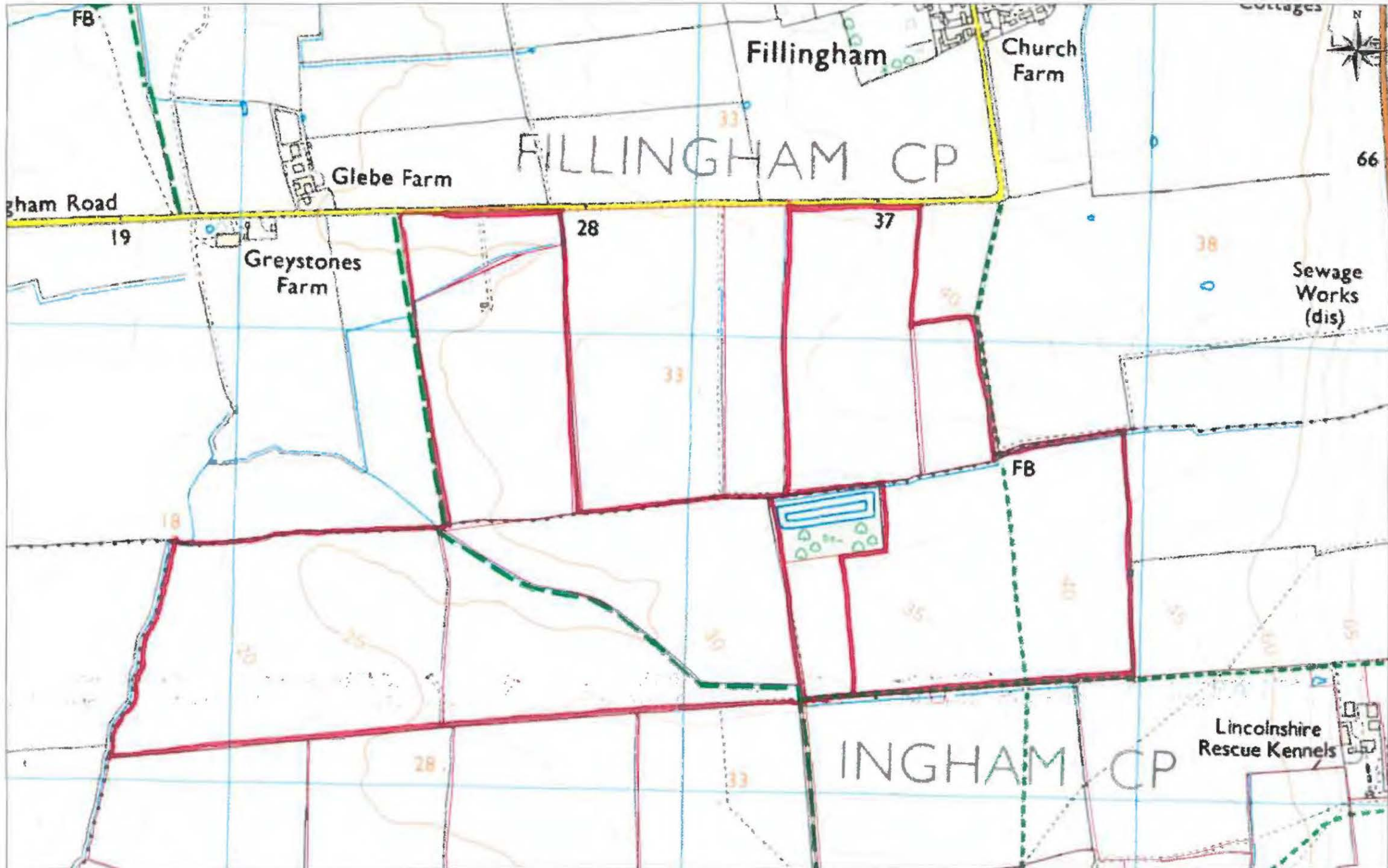

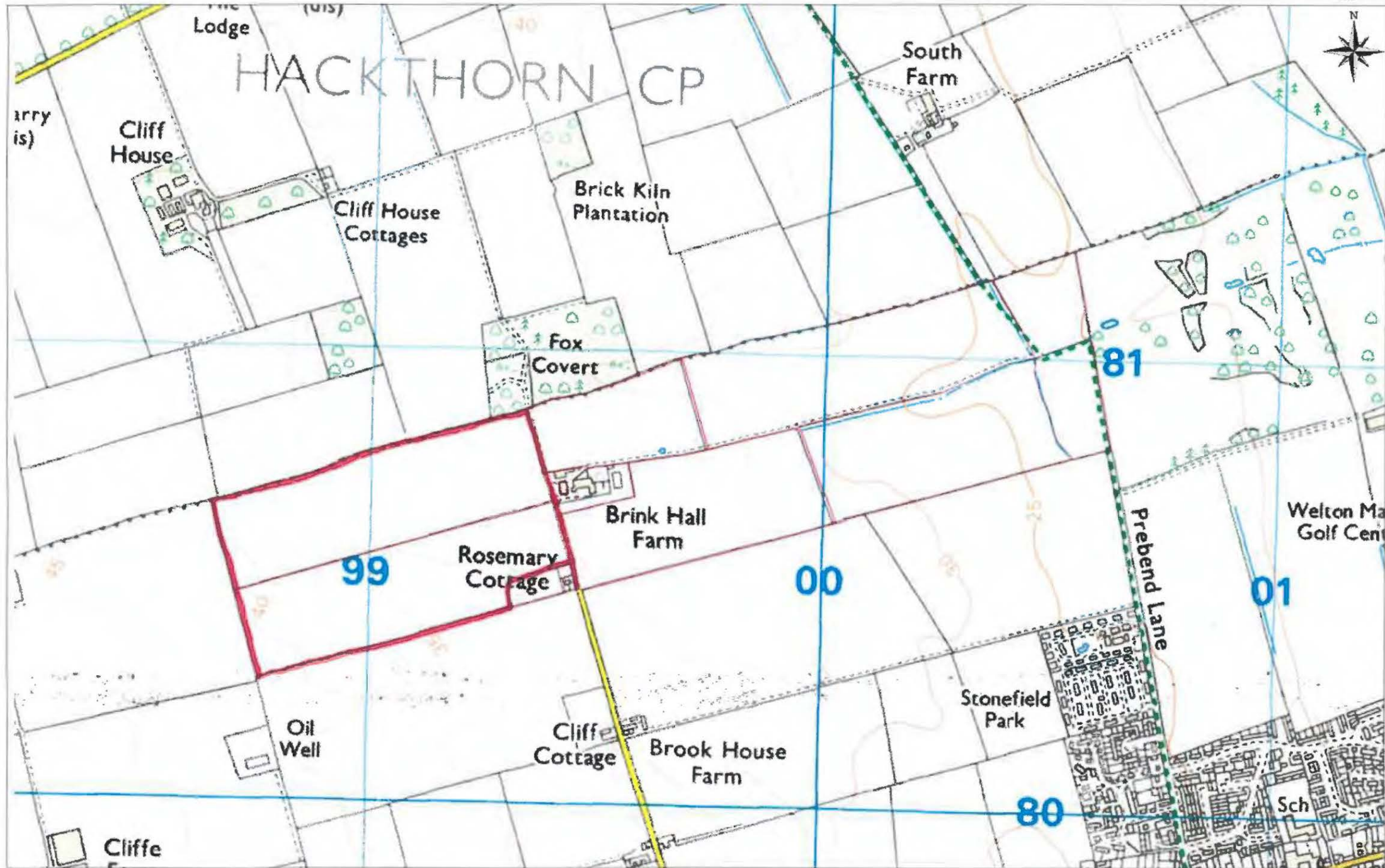

10. 'Appropriate authority' means (a) in relation to a map or statement deposited or declaration lodged under section 31(6) of that Act, an appropriate council (as defined in section 31(7) of the Highways Act 1980); and (b) in relation to a statement and map deposited under section 15A(1) of the 2006 Act, a commons registration authority (defined in section 4 of the Commons Act 2006 and section 2 of the Commons Registration Act 1965). In practice, the appropriate council and commons registration authority will usually be the same body.

PART A: Information relating to the applicant and land to which the application relates
(all applicants must complete this Part)

1. Name of appropriate authority to which the application is addressed: **Lincolnshire County Council**

2. Name and full address (including postcode) of applicant:

Alfred Rose, Albion House, Manor Farm, Fillingham, Gainsborough, Lincolnshire. DN21 5BS

3. Status of applicant (tick relevant box or boxes):

I am

(a) the owner of the land(s) described in paragraph 4.

(b) making this application and the statements/declarations it contains on behalf of **The A G Rose (Decd) Trust, Albion House, Manor Farm, Fillingham, Gainsborough, Lincolnshire DN21 5BS** who is the owner of the land(s) described in paragraph 4 and in my capacity as a **Trustee of that Trust.**

4. Insert description of the land(s) to which the application relates (including full address and postcode):
Land .

The Freehold property as shown edged red on the attached maps. One map showing the areas around Ingham, the second map showing land to the west of the B1398 leading up to the A15, North East of Fillingham, the third map showing land to the west of the B1398 North of Fillingham, the 4th map shows land to the south east of Fillingham leading up to the B1398, the fifth showing land to the south of Fillingham and ,the 6th showing land to the west of Brink Hall farm.

5. Ordnance Survey six-figure grid reference(s) of a point within the area of land(s) to which the application relates (if known):

SK950839 Land to the North of Ingham, West of the B1398 (Horsefield)

SK 962839 Land to the North East of Ingham leading from the B1398 and the A 15 (Little/Big Drome fields)

SK 961868 Land east of the B1398 leading up to the A 15 North of Fillingham Park (Strip Field)

SK942866 Land North of Fillingham. (Middle Field)

SK952852 Land West of the B1398, South East of Fillingham.

SK962853 Land to the East of the B1398 leading to the A 15., South of Fillingham Park.

SK936842 Land to the South of Fillingham- Willingham road (Hungrills)

SK946858 Land By Rectory Lea in Fillingham

SK993801 Land to the West of Brink Hall Farm Welton.

6. This deposit comprises the following statement(s) and/or declarations (*delete Parts B, C, or D where not applicable*):

PART B: Statement under section 31(6) of the Highways Act 1980

The A G Rose (Deed) Trust is the owner of the land described in paragraph 4 of Part A of this form and shown **Bordered Red** on the maps accompanying this statement.

(delete wording in square brackets as appropriate and/or insert information as required)

[Ways shown **Long Broken Green** on the accompanying map are public bridleways.]

[Ways shown **Short Broken Green** on the accompanying map are public footpaths.]

No [other] ways over the land shown [*insert colouring*] on the accompanying map have been dedicated as highways.

(delete wording in square brackets as appropriate and/or insert information as required)

PART C: Declaration under section 31(6) of the Highways Act 1980

1. The A G Rose (Decd) Trust is the owner of the land described in paragraph 4 of Part A of this form and shown red on the map accompanying this declaration/lodged with Lincolnshire County Council on 21st September 2023

2. On the 21st September 2023 The A G Rose (Decd) Trust deposited with Lincolnshire County Council, being the appropriate council, a statement accompanied by a map showing The A G Rose (Decd) Trust property red which stated that:

[the ways shown Long Broken Green on that map had been dedicated as bridleways]

[the ways shown Short Broken Green on that map had been dedicated as footpaths]

[no other ways had been dedicated as highways over The A G Rose (Decd) Trust property].

4. No additional ways have been dedicated over the land edged red on the map referenced in paragraph 1 above since the statement dated 6th September 2023 referred to in paragraph 2 other than those byways open to bridleways and footpath and at the present time The A G Rose (Decd) Trust has no intention of dedicating any more public rights of way over the property.

PART E: Additional information relevant to the application
(insert any additional information relevant to the application)

PART F: Statement of Truth
(all applicants must complete this Part)

WARNING: If you dishonestly enter information or make a statement that you know is, or might be, untrue or misleading, and intend by doing so to make a gain for yourself or another person, or to cause loss or the risk of loss to another person, you may commit the offence of fraud under section 1 of the Fraud Act 2006, the maximum penalty for which is 10 years' imprisonment or an unlimited fine, or both.

I BELIEVE THAT THE FACTS AND MATTERS CONTAINED IN THIS FORM ARE TRUE

Signature (of the person making the statement of truth)



Print full name: Alfred Charles Rose

Date: 10th October 2023

You should keep a copy of the completed form

Data Protection Act 1998 - Fair Processing Notice

The purpose of this Fair Processing Notice is to inform you of the use that will be made of your personal data, as required by the Data Protection Act 1998.

The appropriate authority (see explanation of definition in above guidance notes) in England is the data controller in respect of any personal data that you provide when you complete this form.

The information that you provide will be used by the appropriate authority in its duties to process applications to deposit statements, maps and declarations under section 31(6) the Highways Act 1980 and statements under section 15A(1) of the Commons Act 2006. The information you provide will also be used by the appropriate authority in its duty to update the registers in which details of such deposits are recorded under the Dedicated Highways (Registers under Section 31A of the Highways Act 1980) (England) Regulations 2007 and the Commons (Registration of Town or Village Greens) and Dedicated Highways (Landowner Statements and Declarations) (England) Regulations 2013.

The appropriate authority is required by the legislation above to maintain a register which holds information provided in this form, which can be inspected online or in person by members of the public on request. It may also be required to release information, including personal data and commercial information, on request under the Environmental Information Regulations 2004 or the Freedom of Information Act 2000. However, the appropriate authority will not permit any unwarranted breach of confidentiality nor will they act in contravention of their obligations under the Data Protection Act 1998.