

Parish: Ashby de la Launde with Bloxholm, Digby, Ruskington, Scopwick
Title: Land at Home Farm
Reference number: CA/7/1/6/1

**DEPOSIT OF MAP AND STATEMENT AND STATUTORY DECLARATION(S) UNDER
HIGHWAYS ACT 1980, SECTION 31(6) AND COMMONS ACT 2006, SECTION 15A(1)**

Geographic Location

Grid Reference: TF064535, TF064 541, TF049553, TF065513, TF078579
Address and postcode of buildings on the deposited land Peacock Farm, Westcliffe, Sleaford, NG34 8RF; Old Water Mill Cottage, Scopwick, LN4 3NW
District North Kesteven
Nearest city or town Sleaford

Highways Act 1980, Section 31(6) deposits

Date of deposit of map and statement 25.11.1993
Depositor's name and address Mrs C Wilkinson, Home Farm, Ashby de la Launde, Lincoln, LN4 3JG
Date of deposit of declaration, name and address of depositor
(1) 10.03.1998: Mrs C Wilkinson, Home Farm, Ashby de la Launde, Lincoln LN4 3JG
(2) 19.01.2004: Mrs C Wilkinson, Home Farm, Ashby de la Launde, Lincoln LN4 3JG
(3) 11.11.2013: Mr E M Wilkinson, Home Farm, Ashby de la Launde, Lincoln LN4 3JG and Mr C D Wilkinson, Peacock Farm, Westcliffe, Sleaford, NG34 8RF
Date deposit expires: 10.11.2033

Commons Act 2006, Section 15A(1)

Date of deposit of map and statement, name and address of depositor (1) 11.11.2013: Mr E M Wilkinson, Home Farm, Ashby de la Launde, Lincoln, LN4 3JG and Mr C D Wilkinson, Peacock Farm, Westcliffe, Sleaford, NG34 8RF [*combined deposit*]

COUNTY COUNCIL'S CONTACT DETAILS

Officer and Section: Definitive Map Officer, Public Rights of Way and Countryside Access
Address: Lincolnshire County Council, Communities, 4th Floor, City Hall, Lincoln, LN1 1DN
Telephone: 01522 782070
Email: countryside_access@lincolnshire.gov.uk

REGISTER OF DEPOSITS

The County Council is required by law to keep a register of maps and statements and declarations deposited under Section 31(6) of the Highways Act 1980 and Section 15A(1) of the Commons Act 2006 available for public inspection on its website and in a paper copy format together with the deposited documents. Details including names, addresses and the location of land relating to a deposit which may be considered to be personal information are therefore in the public domain. This requirement overrides any entitlement a depositor may otherwise have under the Data Protection Act 1998 to prevent publication of such information. The paper copy of the register together with the deposited documents can be viewed by appointment during normal office hours (9:00am to 4:30pm, Monday to Friday) at the County Council's Public Rights of Way and Countryside Section at the above address.

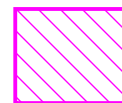
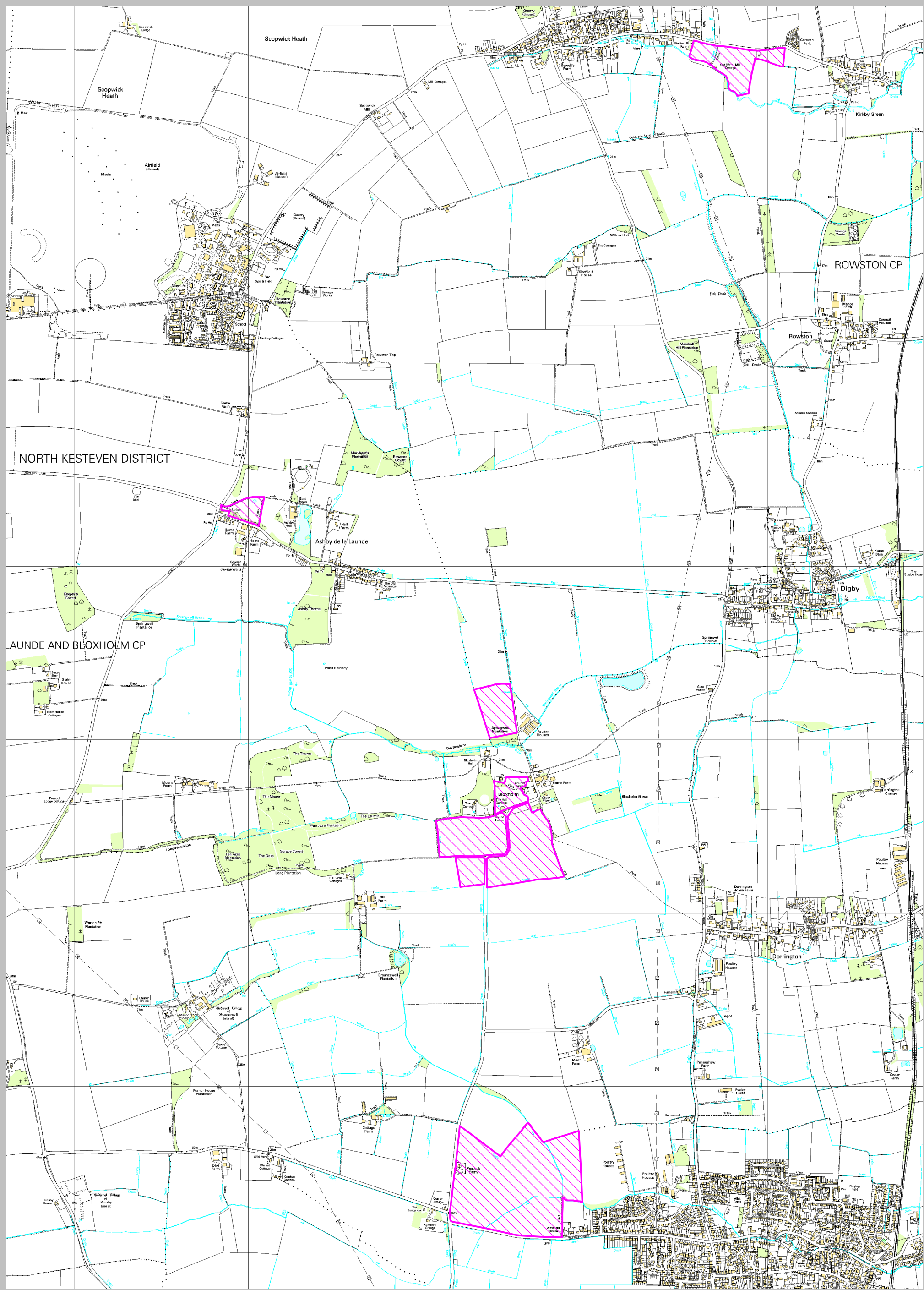

Home Farm, Ashby-de-la-Launde, Lincoln LN4 3JG
Tel: 0526 320354 Fax: 0526 322907

Lincolnshire County Council
Council Offices
Newland
Lincoln LN1 1YQ

22nd November, 1993.

Dear Sirs,

NOTICE PURSUANT TO SECTION 31 (6) HIGHWAY ACTS 1990

I refer to the accompanying plans and state that within the area edged red, which is within my ownership, that it identifies all those paths on the holding which are accepted by myself as public highway.

Yours faithfully,

DHP			
AD (H)			
AD (D)			
AD (S)			
HIGHWAYS PLANNING			
P 25 NOV 1993			
ACKT			
REPLY			
FILE			

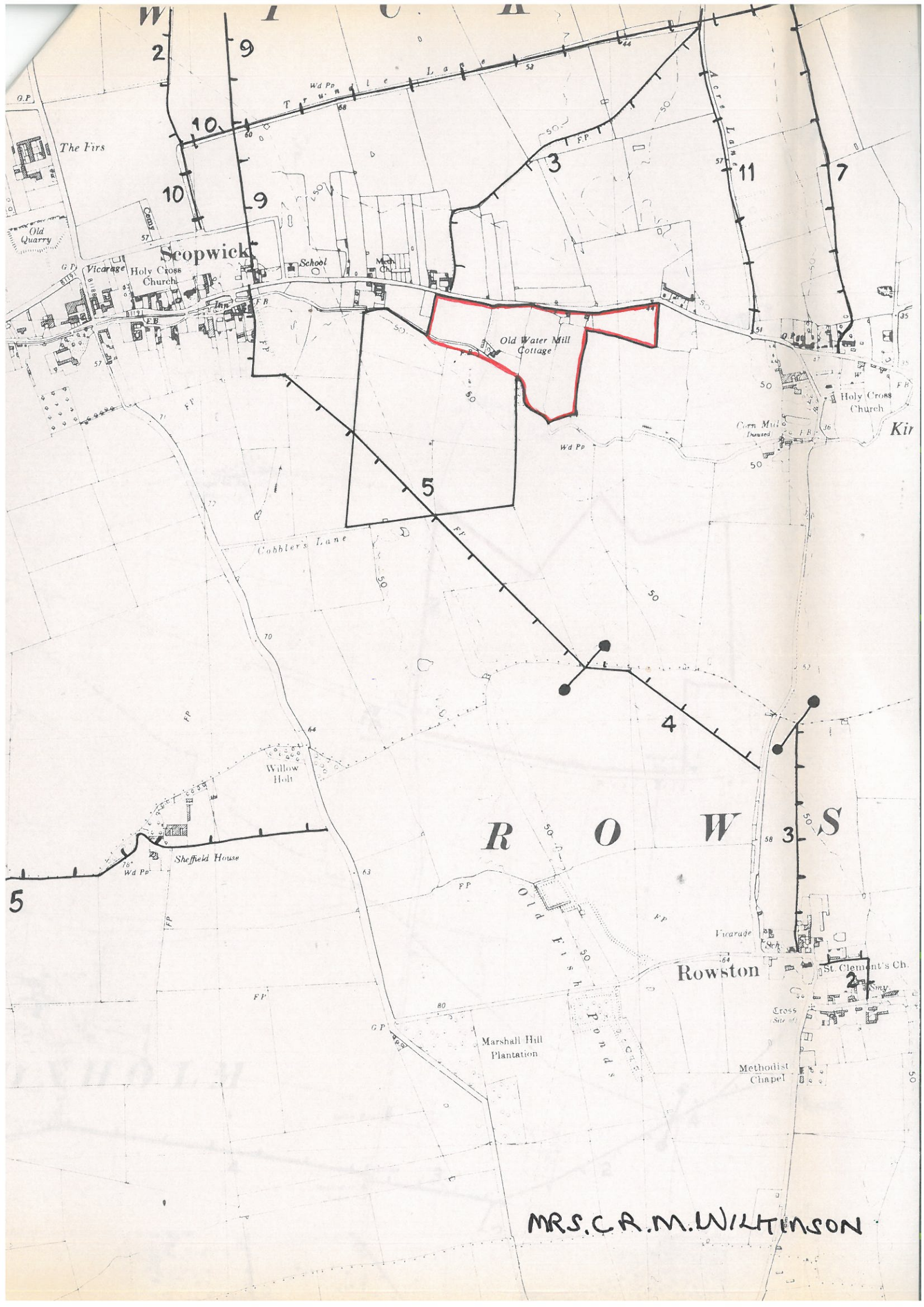

Scopwick

R O W S

Rowston

MRS. C. R. M. WILKINSON

The Firs

Old Quarry

Vicarage Holy Cross Church

School

Methodist Chapel

Old Water Mill Cottage

Cobblers Lane

Willow Hob

Sheffield House

Marshall Hill Plantation

Methodist Chapel

St. Clement's Ch.

5

2

9

10

9

3

11

7

5

4

3

2

G.P.

Wd Pp

T r u n g l e L a n e

A C T S L A N E

Wd Pp

Wd Pp

PP

Vicarage

Cross Site of

OLD FISH SUPPLIES

50

Corn Mill

Kir

Drained

50

70

50

50

50

50

50

50

50

50

50

50

50

50

50

50

50

50

50

50

50

50

50

50

50

50

50

50

50

50

50

50

50

50

50

50

50

50

50

50

50

50

50

50

50

50

50

50

50

50

50

50

50

50

50

50

50

50

50

50

50

50

50

50

50

50

50

50

50

50

50

50

50

50

50

50

50

50

50

50

50

50

50

50

50

50

50

50

50

50

50

50

50

50

50

50

50

50

50

50

50

50

50

50

50

50

50

50

50

50

50

50

50

50

50

50

50

50

50

50

50

50

50

50

50

50

50

50

50

50

50

50

50

50

50

50

50

50

50

50

50

50

50

50

50

50

50

50

50

50

50

50

50

50

50

50

50

50

50

50

50

50

50

50

50

50

50

50

50

50

50

50

50

50

50

50

50

50

50

50

50

50

50

50

50

50

50

50

50

50

50

50

50

50

50

50

50

50

50

50

50

50

50

50

50

50

50

50

50

50

50

50

50

50

50

50

50

50

50

50

50

50

50

50

50

50

50

50

50

50

50

50

50

50

50

50

50

50

50

50

50

50

50

50

50

50

50

50

50

50

50

50

50

50

50

50

50

50

50

50

50

50

50

50

50

50

50

50

50

50

50

50

50

50

50

50

50

50

50

50

50

50

50

50

50

50

50

50

50

50

50

50

50

50

50

50

50

50

50

50

50

50

50

50

50

50

50

50

50

50

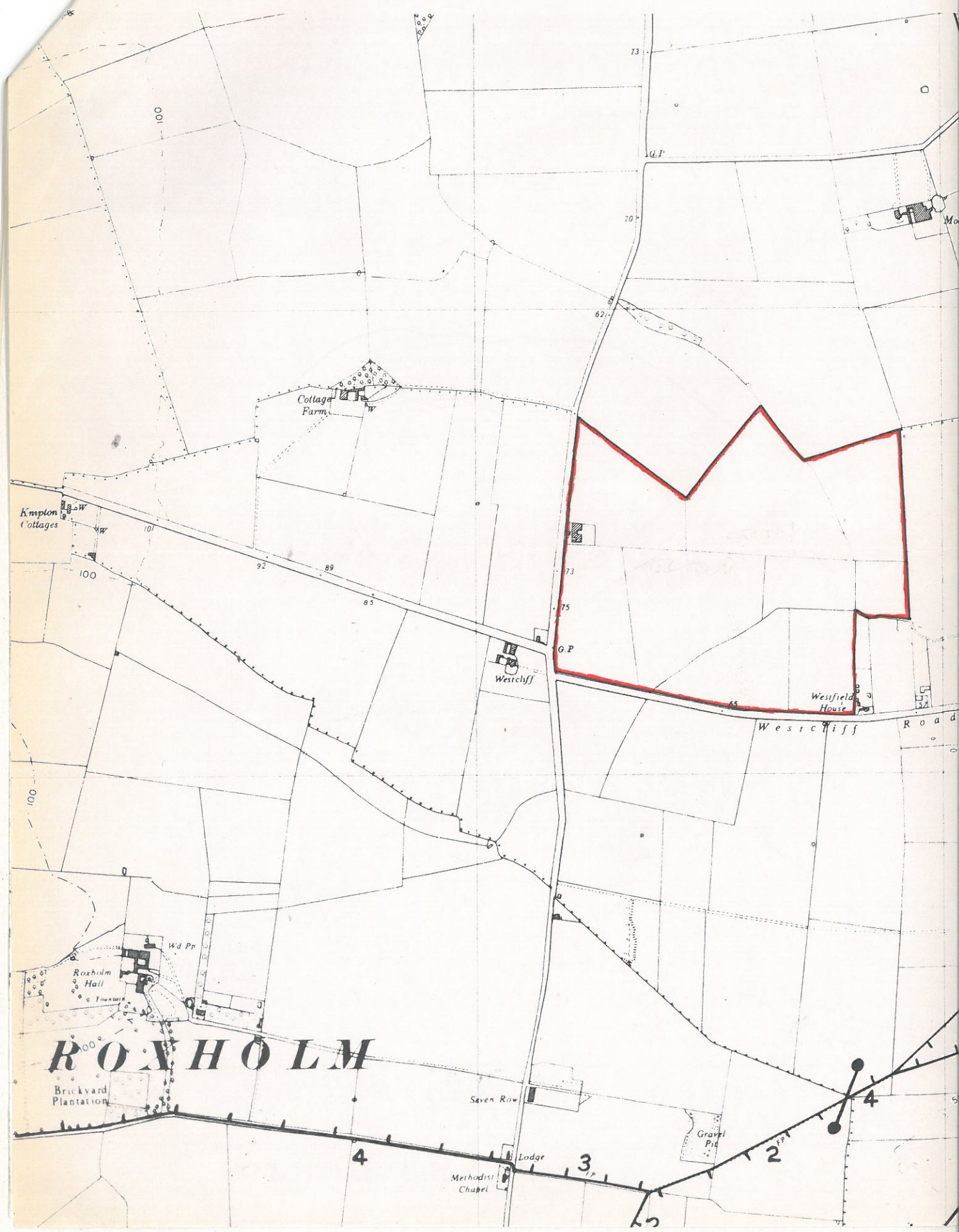

ROXHOLM

4 3 2 4

Kimplon Cottages

Cottage Farm

Westchiff

Westfield House

Roxholm Hall

Brickyard Plantation

Seven Row

Lodge

Methodist Chapel

Gravel Pit

Westchiff Road

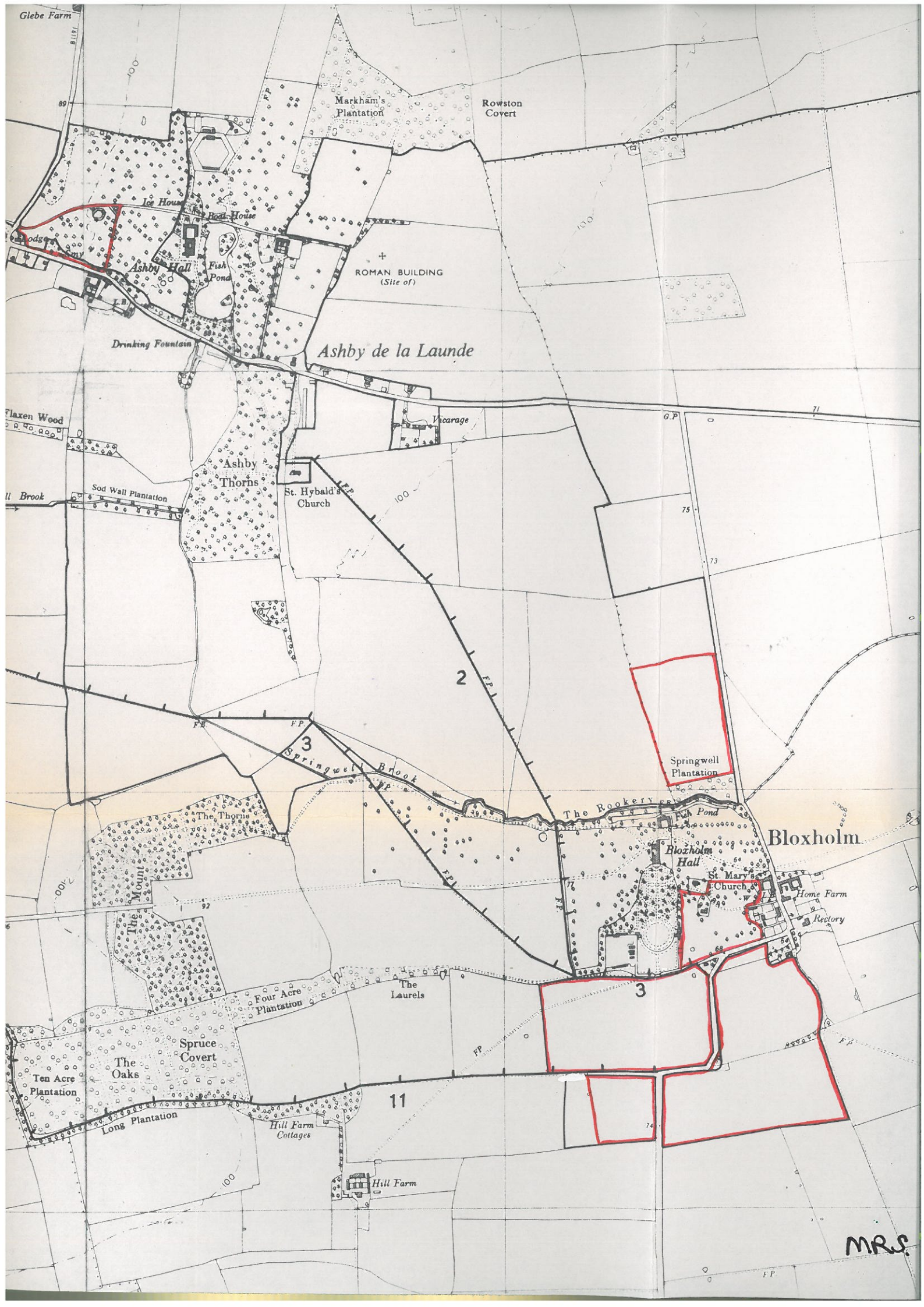

Glebe Farm

Markham's Plantation

Rowston Covert

Ice House

Boat House

Ashby Hall

Fish Pond

ROMAN BUILDING (Site of)

Drinking Fountain

Ashby de la Launde

Vicarage

Flaxen Wood

Ashby Thorns

St. Hybald's Church

Sod Wall Plantation

ll Brook

2

3

Springwell Brook

Springwell Plantation

The Thorns

The Rookery

Fish Pond

Bloxholm

Bloxholm Hall

St. Mary's Church

Home Farm

Rectory

The Mount

Four Acre Plantation

The Laurels

3

Ten Acre Plantation

The Oaks

Spruce Covert

Long Plantation

Hill Farm Cottages

11

Hill Farm

M.R.S.

STATUTORY DECLARATION

SECTION 31 (6) OF THE HIGHWAYS ACT 1980

I, CLARICE ROSE MAY WILKINSON

OF HOME FARM, ASHBY-DE-LA-LAUNDE, LINCOLN LN4 3JG

DO SOLEMNLY AND SINCERELY DECLARE AS FOLLOWS:

1. On the 22nd day of November 1993 I deposited a Map of my land at Scopwick, Bloxholm and Ruskington, Lincolnshire with the Lincolnshire County Council at Council Offices, Lincoln together with a statement indicating those highways then dedicated to the public (if any).
2. Since the Map and Statement were deposited;

No ways additional to those shown on such Map and described in such statement (if any) for use of the public as highways have been dedicated by me.

AND I MAKE this solemn Declaration on ^{6th} day of ^{March} 1998 conscientiously believing the same to be true and by virtue of the Statutory Declarations Act of 1835.

(Power of A

Declared at 27/31 Northgate
Stefan Lincolnshire NB34 7BW

Before me
(Commissioner for Oaths or a
Justice of the Peace or Solicitor)

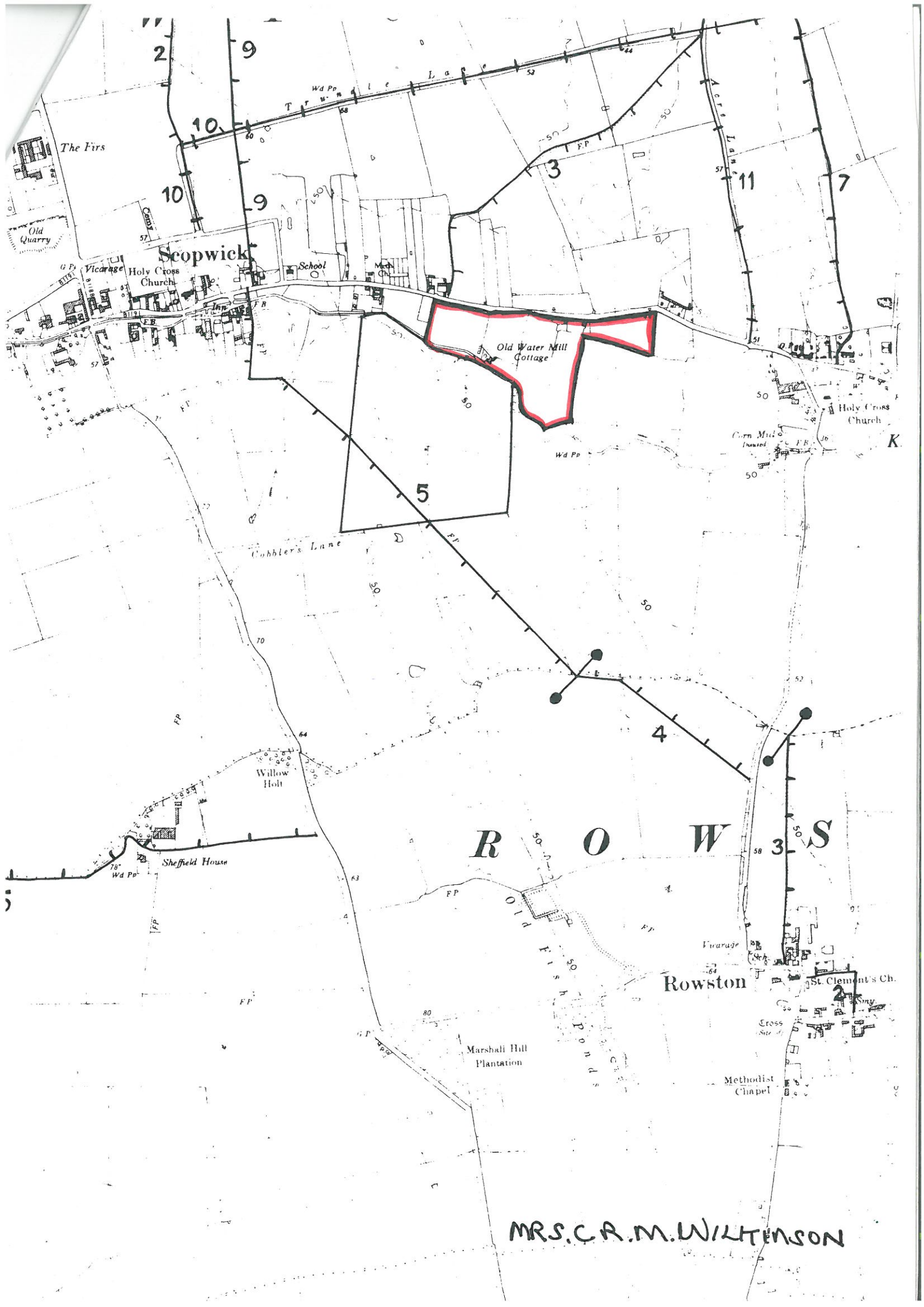

The Firs

Old Quarry

Scopwick

Holy Cross Church

School

Old Water Mill Cottage

Cobblers Lane

Willow Holt

Sheffield House

ROWSTON

Marshall Hill Plantation

Rowston

St. Clement's Ch.

Methodist Chapel

MRS. C. R. M. WILKINSON

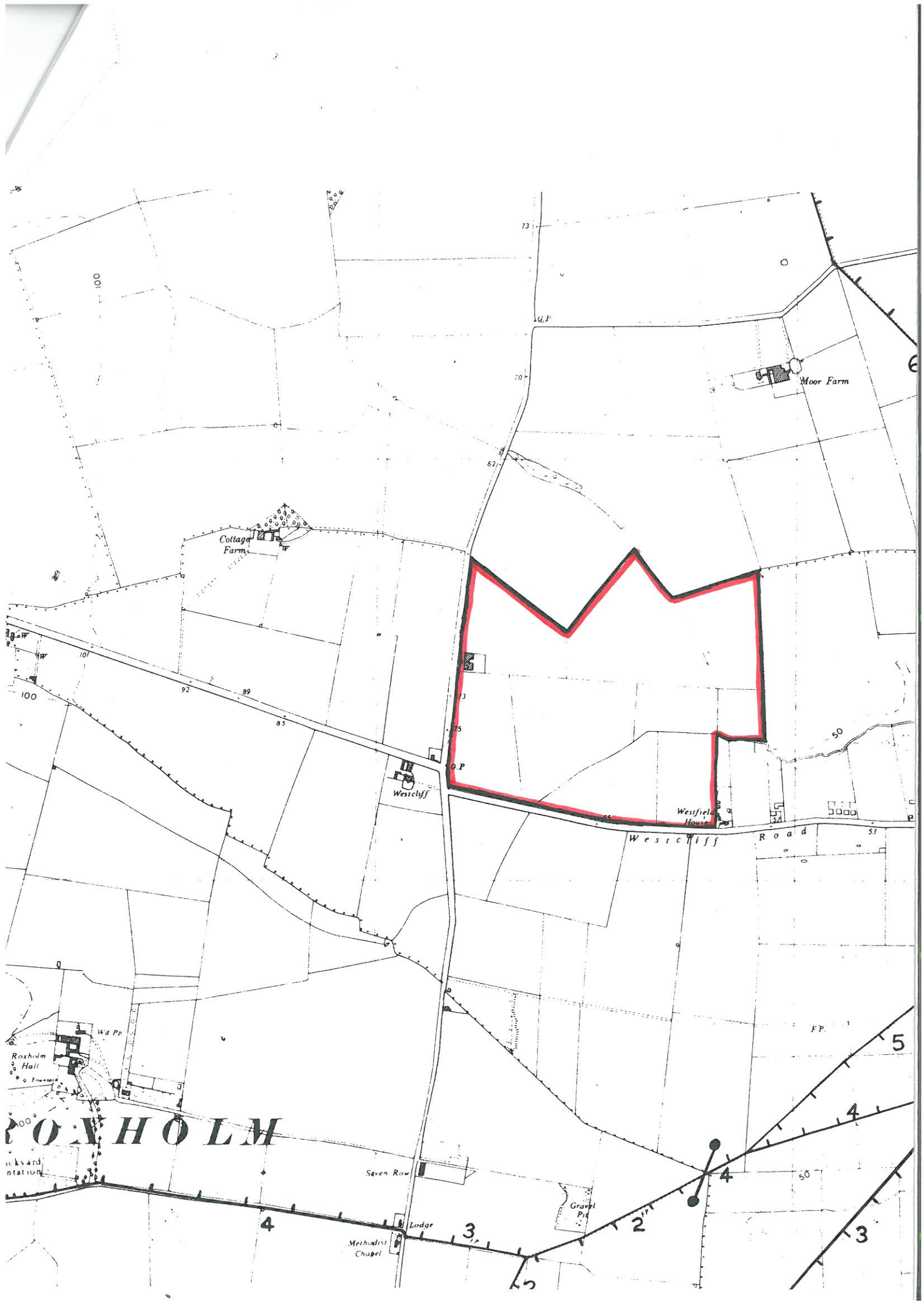

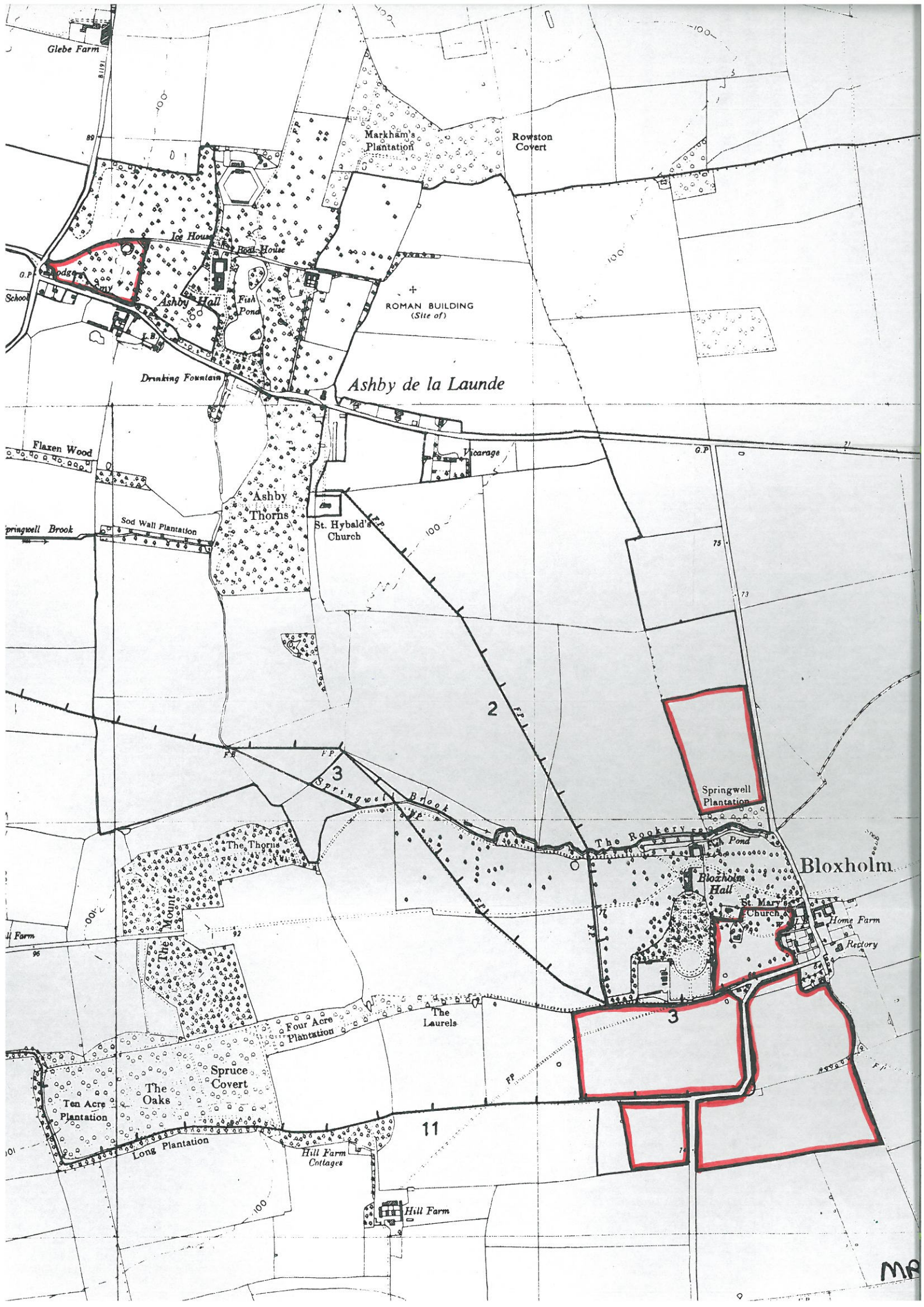

Glebe Farm

Markham's Plantation

Rowston Covert

Ice House

Boat House

Ashby Hall

Fish Pond

ROMAN BUILDING (Site of)

Drinking Fountain

Ashby de la Launde

Flaxen Wood

Vicarage

Springwell Brook

Sod Wall Plantation

Ashby Thorns

St. Hybald's Church

Springwell Plantation

The Mount

The Thorns

The Rookery

Bloxholm

Bloxholm Hall

St. Mary's Church

Home Farm

Rectory

The Oaks

Four Acre Plantation

The Laurels

Ten Acre Plantation

The Oaks

Spruce Covert

Long Plantation

Hill Farm Cottages

11

Hill Farm

MR

STATUTORY DECLARATION

SECTION 31 (6) OF THE HIGHWAYS ACT 1980

I, CLARICE ROSE MAY WILKINSON

OF HOME FARM, ASHBY-DE-LA-LAUNDE, LINCOLN LN4 3JG

DO SOLEMNLY AND SINCERELY DECLARE AS FOLLOWS:

1. On the 22nd day of November 1993 I deposited a Map of my land at Scopwick, Bloxholm and Ruskington, Lincolnshire with the Lincolnshire County Council at Council Offices, Lincoln together with a statement indicating those highways then dedicated to the public (if any).

2. Since the Map and Statement were deposited;

No ways additional to those shown on such Map and described in such statement (if any) for use of the public as highways have been dedicated by me.

AND I MAKE this solemn Declaration on 19th day of January 2004 conscientiously believing the same to be true and by virtue of the Statutory Declarations Act of 1835.

(Power o

Declared at
27/31 Northgate
Meeford
Lincs.
NG34 4D. 1

Before me
(Commissio
Justice of th

9. An application must be accompanied by the requisite fee – please ask the appropriate authority for details.

10. 'Appropriate authority' means (a) in relation to a map or statement deposited or declaration lodged under section 31(6) of that Act, an appropriate council (as defined in section 31(7) of the Highways Act 1980); and (b) in relation to a statement and map deposited under section 15A(1) of the 2006 Act, a commons registration authority (defined in section 4 of the Commons Act 2006 and section 2 of the Commons Registration Act 1965). In practice, the appropriate council and commons registration authority will usually be the same body.

PART A: Information relating to the applicant and land to which the application relates
(all applicants must complete this Part)

1. Name of appropriate authority to which the application is addressed:

Lincolnshire County Council

2. Name and full address (including postcode) of applicant(s):

Eric Michael Wilkinson
Home Farm
Ashby de la Launde
Lincoln
LN4 3JG

and

Christopher David Wilkinson
Peacock Farm
Westcliffe
Sleaford
Lincolnshire
NG34 8RF

3. Status of applicant(s) (tick relevant box or boxes):

We are

(a) the owner of the land(s) described in paragraph 4.

(b) making this application and the statements/declarations it contains on behalf of [insert name of owner] who is the owner of the land(s) described in paragraph 4 and in my capacity as [insert details].

4. Insert description of the land(s) to which the application relates (including full address and postcode):

Land at Home Farm in the Parishes of Ashby-de-la-Launde with Bloxholm, Digby, Ruskington and Scopwick, Lincolnshire, LN4 and NG34

5. Ordnance Survey six-figure grid reference(s) of a point within the area of land(s) to which the application relates (if known):

Not known

6. This deposit comprises the following statement(s) and/or declarations (*delete Parts B, C, or D where not applicable*):

Parts C and D (Part B deleted)

PART C: Declaration under section 31(6) of the Highways Act 1980

1. We are the owners of the land described in paragraph 4 of Part A of this form and shown on the map lodged with Lincolnshire County Council on the 25th day of November 1993.
2. On the 25th day of November 1993 our predecessor in title Mrs. C. Wilkinson deposited with Lincolnshire County Council, being the appropriate Council, a statement accompanied by a map showing our property which indicated any highways then dedicated to the public (if any).
3. On the 10th day of March 1998 our predecessor in title Mrs. C. Wilkinson deposited with Lincolnshire County Council, being the appropriate Council, a declaration stating that no additional ways had been dedicated as highways since the deposit of the statement and map referred to in 2 above.
4. On the 19th day of January 2004 our predecessor in title Mrs. C. Wilkinson deposited with Lincolnshire County Council, being the appropriate Council, a declaration stating that no additional ways had been dedicated as highways since the deposit of the statutory declaration referred to in 3 above.
5. No additional ways have been dedicated over the land on the map referenced in paragraph 1 above since the date of the declaration referred to in paragraph 4 above and at the present time we have no intention of dedicating any more public rights of way over our property.

PART D: Statement under section 15A(1) of the Commons Act 2006

We are the owners of the land described in paragraph 4 of Part A of this form and shown on the map deposited with Lincolnshire County Council on 25th day of November 1993.

We wish to bring to an end any period during which persons may have indulged as of right in lawful sports and pastimes on the whole or any part of the land shown on the map referenced above.

PART E: Additional information relevant to the application
(insert any additional information relevant to the application)

At the time this application was prepared the Lincolnshire County Council deposit reference number for the land described in paragraph 4 of Part A of this form was CA/7/1/6/1.

**PART F: Statement of Truth
(all applicants must complete this Part)**

WARNING: If you dishonestly enter information or make a statement that you know is, or might be, untrue or misleading, and intend by doing so to make a gain for yourself or another person, or to cause loss or the risk of loss to another person, you may commit the offence of fraud under section 1 of the Fraud Act 2006, the maximum penalty for which is 10 years' imprisonment or an unlimited fine, or both.

I BELIEVE THAT THE FACTS AND MATTERS CONTAINED IN THIS FORM ARE TRUE

Signature (of the person making the statement of truth):

P1

Date: 08/11/2013

Signature (of the person making the statement of truth):

Print full name: Christopher David Wilkinson

Date: 8/11/2013

You should keep a copy of the completed form

AP

Home Farm
71 Main Street
Ashby de la Launde
Lincoln
LN4 3JG

6th May 2014

Mr. A. Pickwell (Public Rights of Way)
PDP 50
Highways & Transportation
Lincolnshire County Council
Communities
County Offices
Newland
Lincoln
LN1 1YQ

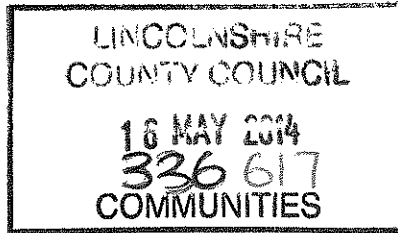

Dear Mr. Pickwell,

Highways Act 1980, Section 31(6) and Commons Act 2006, Section 15A(1) deposited land at Ashby de la Launde owned by Messrs E M and C D Wilkinson

Thank you for your letter dated 29th April 2014 (your ref. AP/CA/7/1/6/HF).

Please find enclosed Exhibit 3 with the border between Messrs Wilkinson's and The Lodges's land highlighted in red. For clarification, the land along north and east of the line belongs to Messrs Wilkinson and that to the south and west to The Lodge.

Since 1993 The Lodge has never been owned in whole or part by any members of the Wilkinson family.

Yours sincerely,

Eric Wilkinson

Exhibit 3



26.1m

Track

GP

GP

25.6m



The Lodge

28.6m



Pump House



Maple House



Drain

Name: ERIC WILKINSON
Address: HOME FARM
ASHBY-DE-LA-LAUNDE
LINC LN
Postcode: LN4 3JG

PLEASE MARK ON THE PLAN THE EXTENT OF MESSRS E M & C D WILKINSON'S LAND OWNERSHIP IN RELATION TO THE LODGE, MAIN ROAD, ASHBY DE LA LAUNDE



Rights of Way & Countryside Access
Executive Director for Communities: RA Wills
City Hall, Orchard Street,
Lincoln LN1 1DN

DEPOSITED LAND AT ASHBY DE LA LAUNDE

Ref: AP/CA/6/1
Date: 28.04.2014
Scale: 1:1,250