

VIKING WAY CONNECTION TO NHRR FOOTWAY / CYCLEWAY

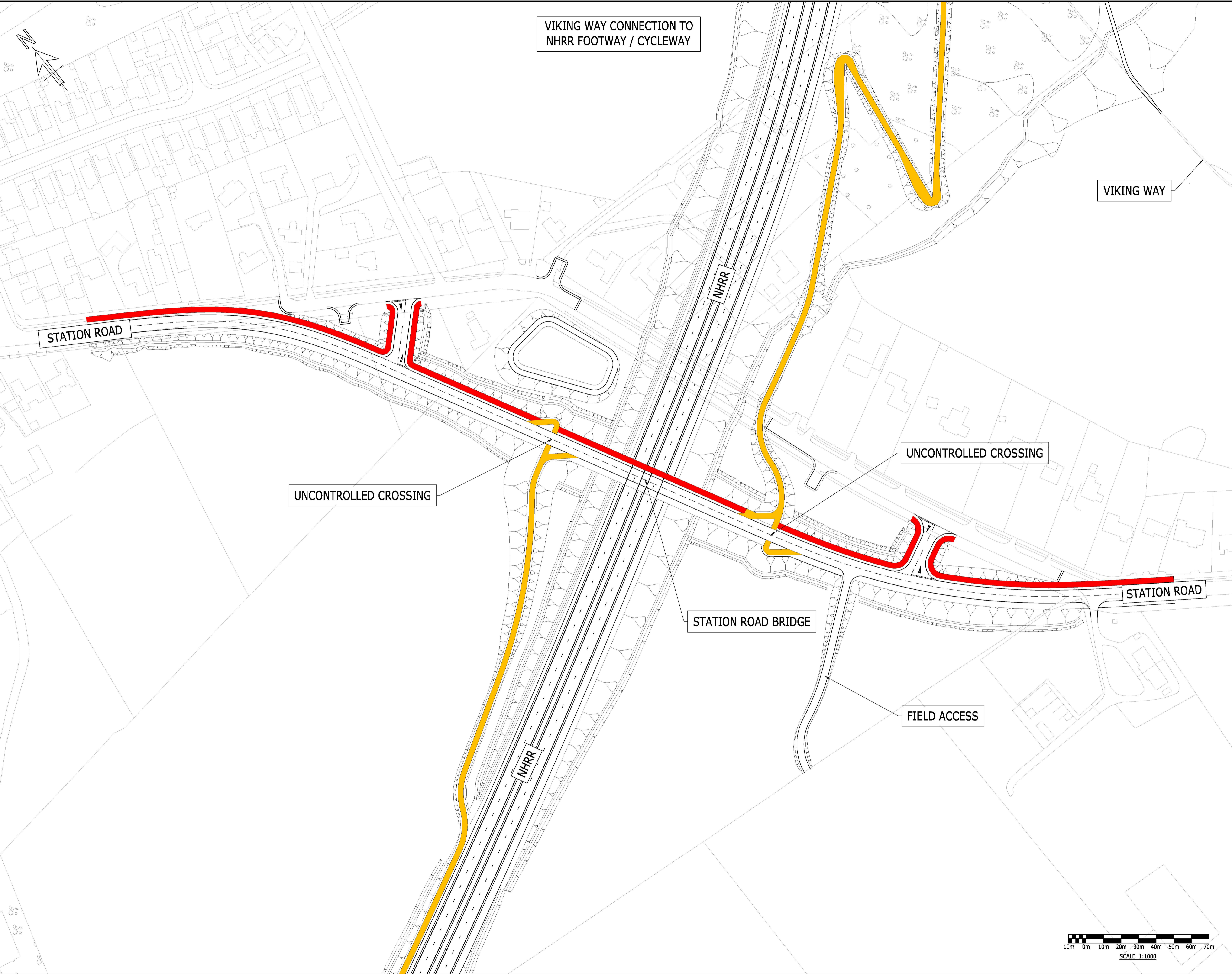

COPYRIGHT RAMBOLL UK LIMITED. ALL RIGHTS RESERVED. THIS DOCUMENT IS ISSUED FOR THE PARTY WHO COMMISSIONED IT AND FOR THE SPECIFIC PURPOSES CONNECTED WITH THE PROJECT ONLY. IT SHOULD NOT BE RELIED UPON BY ANY OTHER PARTY OR USED FOR ANY OTHER PURPOSE. RAMBOLL ACCEPTS NO RESPONSIBILITY OR LIABILITY WHICH MAY ARISE FROM RELIANCE OR USE OF THIS DOCUMENT OR THE DATA CONTAINED HEREIN BY ANY OTHER PARTY OR FOR ANY OTHER PURPOSE.

- Notes
- DO NOT SCALE FROM THIS DRAWING.
  - ALL DIMENSIONS ARE IN METRES UNLESS SHOWN OTHERWISE.
  - ALL LEVELS ARE IN METRES ABOVE ORDNANCE DATUM UNLESS SHOWN OTHERWISE.
  - THIS DRAWING IS TO BE READ IN CONJUNCTION WITH ALL RELEVANT ARCHITECTS AND ENGINEERS DRAWINGS AND SPECIFICATIONS.
  - AREAS STATED ARE TO THE CUTLINE.

KEY

	2m FOOTWAY
	3m COMBINED FOOTWAY/CYCLEWAY

Reproduced by permission of Ordnance Survey on behalf of HSMO. © Crown copyright and database right 2022. All rights reserved. Ordnance Survey License number 100025370

P01.1	First Issue				
	DB	DB	DB		
Rev	Description	Drawn	Checked	Approved	Date

Suitability: S0 Drawing Status: Work in Progress  
Project Name: North Hykeham Relief Road

Project Client:  
**Lincolnshire**  
COUNTY COUNCIL  
*Working for a better future*

Project Contractor:  
**Balfour Beatty**

Project Designer:  
**RAMBOLL**  
tel 01244 311855 chester@ramboll.co.uk www.ramboll.co.uk

Drawing Title:  
**PUBLIC INFORMATION EXHIBITION 2 STATION ROAD GEOMETRY PLAN**

Project No:	Scale (0A1):	Drawn:	Date:
1620013942	1:1000	DB	---
Drawing No:	Rev:		
NHRR-RAM-HGN-HYKE-SK-ZH-00010	P01.1		

