

Parish: Chapel St. Leonards, Hogsthorpe, Wildmore, Willoughby with Sloothby, Wrangle
Title: Land at Hogsthorpe, Pt. Willows Farm (Hogsthorpe), Wrangle and Wildmore
Reference number: CA/7/1/291

HIGHWAYS ACT 1980, SECTION 31 (6) – DEPOSITED MAPS, HIGHWAYS STATEMENT AND HIGHWAYS DECLARATIONS

Date of deposit of map and highways statement 12.02.2010
Depositor's name and address The Church Commissioners for England, Church House, Great Smith Street, London, SW1P 3AZ
Dates of deposit of highways declarations and names and addresses of depositors (1) 05.10.2015: The Church Commissioners for England, c/o Savills (UK) Ltd. The Regatta, Henley Way, Lincoln, LN6 3QR
Date deposit expires: 04.10.2035

GEOGRAPHIC LOCATION

Grid Reference: TF257 533, TF426 539, TF534 708, TF518 696, TF503 711, TF539 724, TF555 732
Address and postcode of buildings on the deposited land
District Boston Borough, East Lindsey
Nearest city or town Boston, Skegness

ENQUIRIES ABOUT THE REGISTER OR DEPOSITS

Enquiries concerning the register or the deposits lodged with the County Council should be made to the Definitive Map Officer at Lincolnshire County Council's Public Rights of Way & Countryside Access Section by email to countryside_access@lincolnshire.gov.uk or by telephone on 01522 782070.

INFORMATION ABOUT THE REGISTER OF DEPOSITS

The County Council is required by law to keep and maintain a register of highways statements and highways declarations deposited under section 31 (6) of the Highways Act 1980 and landowner statements deposited under section 15A (1) of the Commons Act 2006 available for public inspection on its website and in a paper copy format, together with copies of the deposited documents. Details, including names, addresses and the location of land relating to an application, which may be considered to be personal information, will therefore be in the public domain. This requirement overrides any entitlement a depositor and landowner may otherwise have under the Data Protection Act 1998 to prevent the publication of such information.

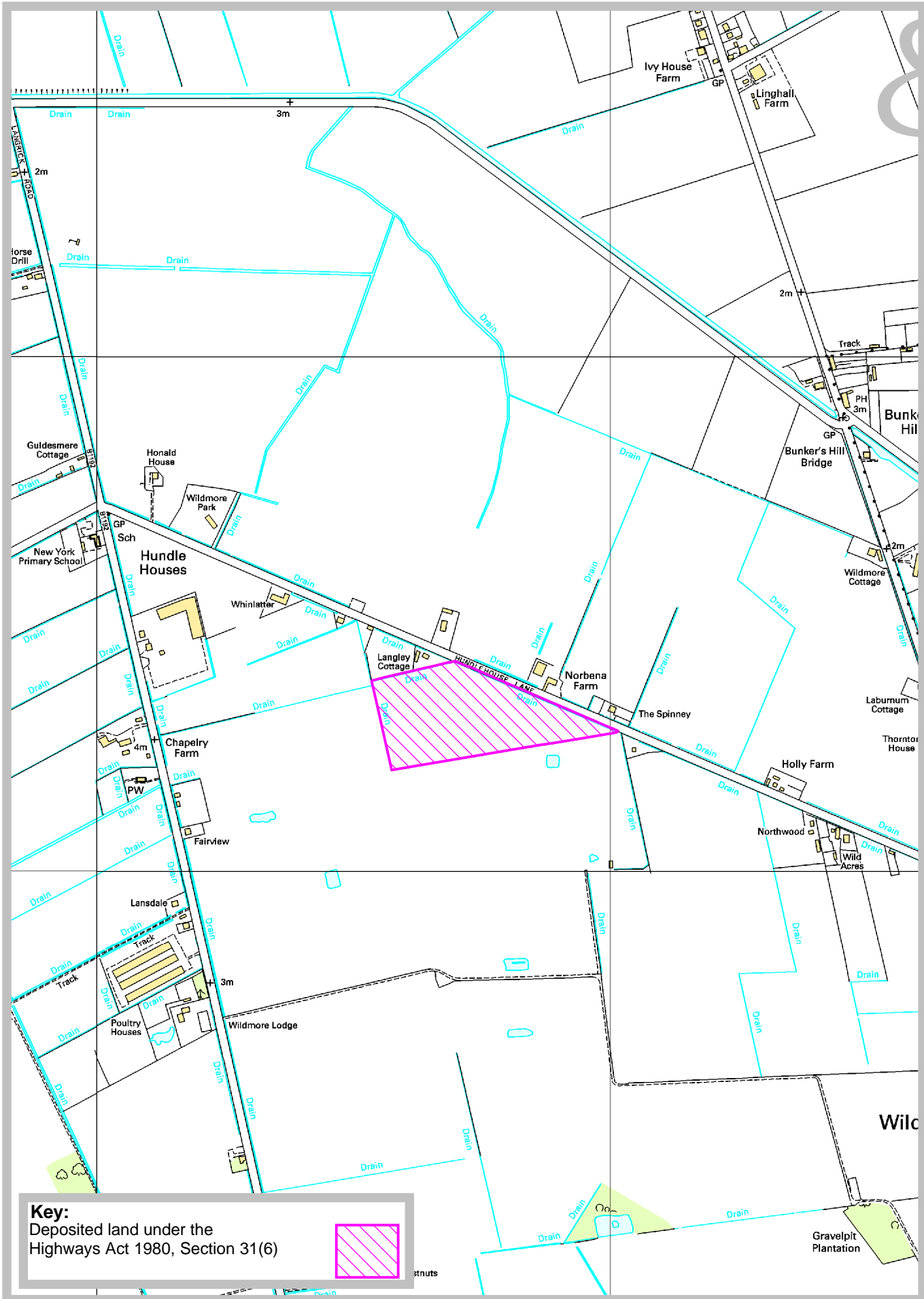
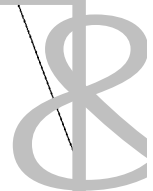

Key:
 Deposited land under the
 Highways Act 1980, Section 31(6)



Lincolnshire
 COUNTY COUNCIL

Public Rights of Way & Countryside Access
 RA Wills, Executive Director for Environment &
 Economy, County Offices, Newland, Lincoln,
 LN1 1YL.

**Land at Hogsthorpe, Pt. Willows
 Farm, Wrangle & Wildmore**
 Ref: CA/7/1/291
 Grid Ref: TF257 533
 Scale: approx. 1:10,000

NB This plan only shows the extent of the land covered by the deposit. Reproduced from Ordnance Survey with the permission of the Controller of HMSO © Crown Copyright. Licence number 100025370.

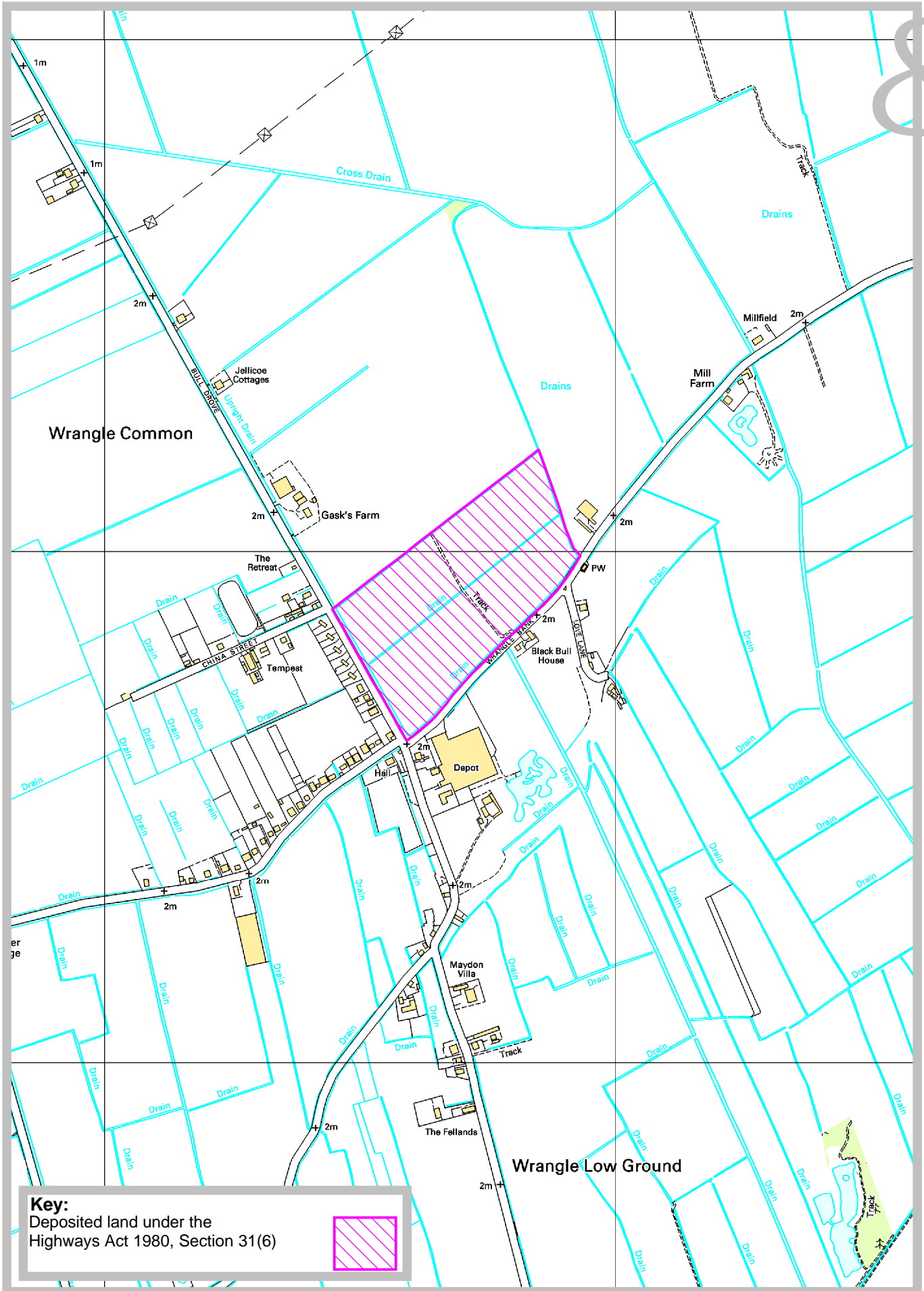
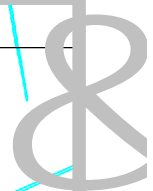

Key:
 Deposited land under the
 Highways Act 1980, Section 31(6)



Public Rights of Way & Countryside Access
 RA Wills, Executive Director for Environment &
 Economy, County Offices, Newland, Lincoln,
 LN1 1YL.

**Land at Hogsthorpe, Pt. Willows
 Farm, Wrangle & Wildmore**
 Ref: CA/7/1/291
 Grid Ref: TF426 539
 Scale: approx. 1:10,000

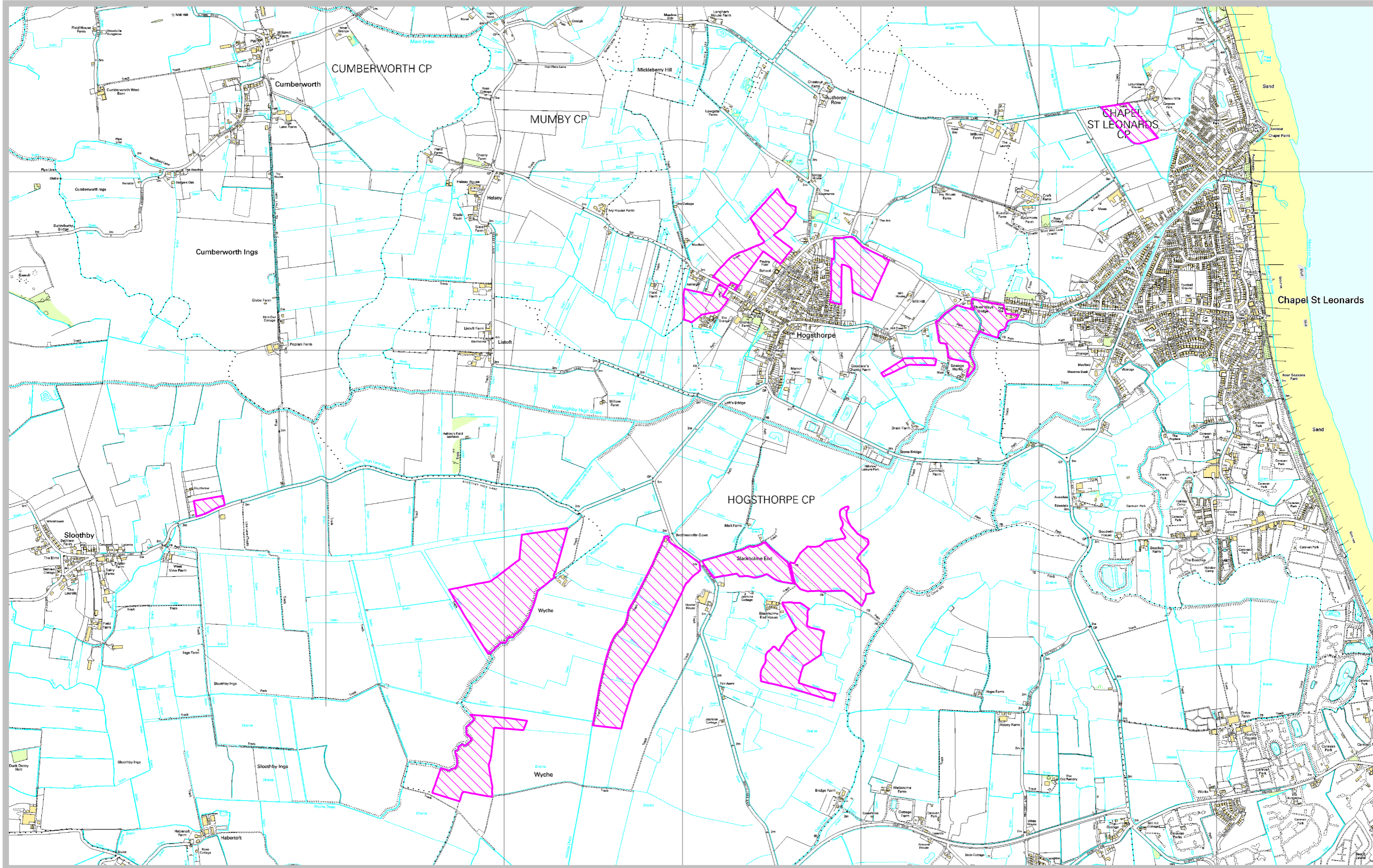

Public Rights of Way & Countryside Access
 RA Wills, Executive Director for Environment &
 Economy, County Offices, Newland, Lincoln,
 LN1 1YL.

Land at Hogsthorpe, Pt. Willows Farm, Wrangle & Wildmore

Ref: CA/7/1/291
 Grid Ref: TF534 708, TF518 696, TF503 711,
 TF539 724, TF555 732
 Scale: approx. 1:20,000

Key:
 Deposited land under the
 Highways Act 1980, Section 31(6)



Church Commissioners for England

*Deposit of statement and plan pursuant to section 31(6) Highways Act 1980 with
Lincolnshire County Council*

1. I, **JAMES ROBERT MARKBY HOWE**, am the Rural Assets Manager of the Church Commissioners for England ("the Commissioners"). The Commissioners are the owners within the meaning of the above section of the land known as Land at Hogsthorpe, Pt Willows Farm, Hogsthorpe, Land at Wrangle and Land at Wildmore more particularly delineated and shown edged red and shaded yellow on the plan accompanying this statement.
2. On behalf of the Commissioners I admit that the ways coloured purple on the plans have been dedicated as public footpaths.

Signed by

Name

Address

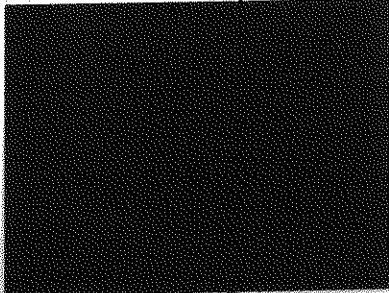

CHURCH HOUSE
GREAT SMITH ST SWIP 3AZ

Date

5-2-10

Signed by

Name

Address

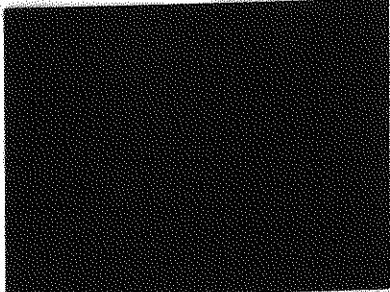

CHURCH HOUSE

GREAT SMITH STREET, SWIP 3AZ

Occupation

ASSISTANT RURAL ASSET MANAGER

Date

5/2/10

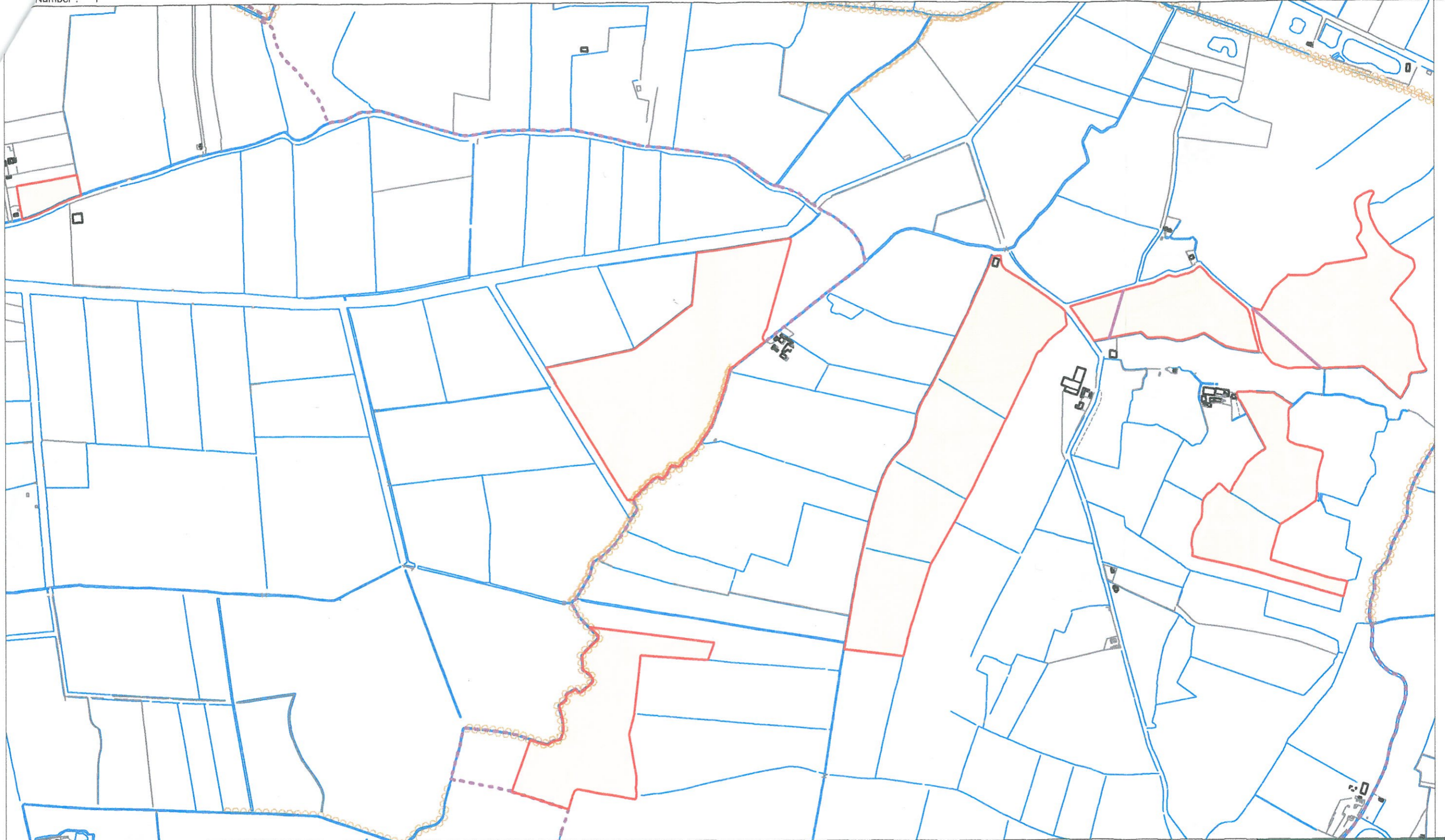

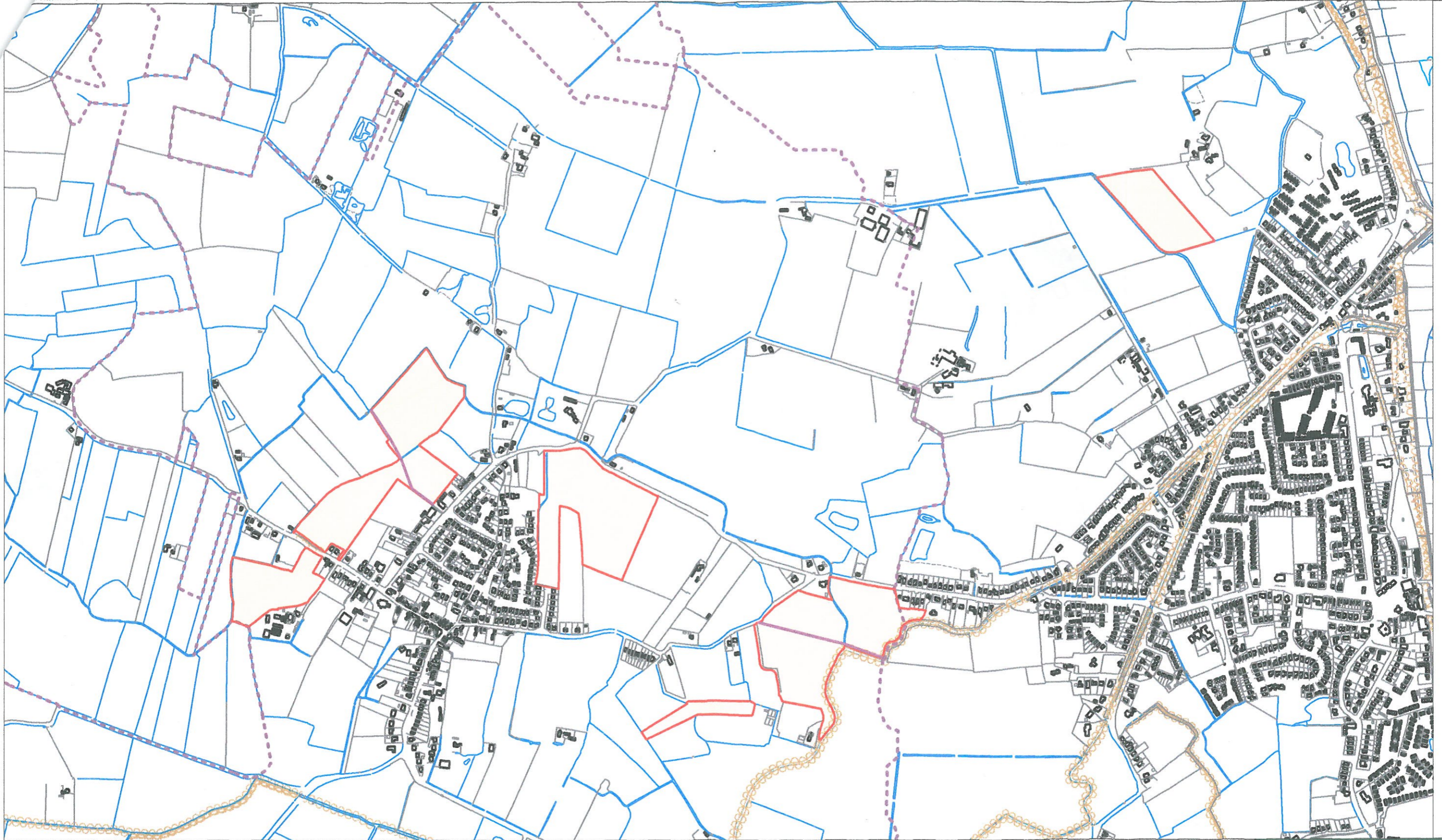

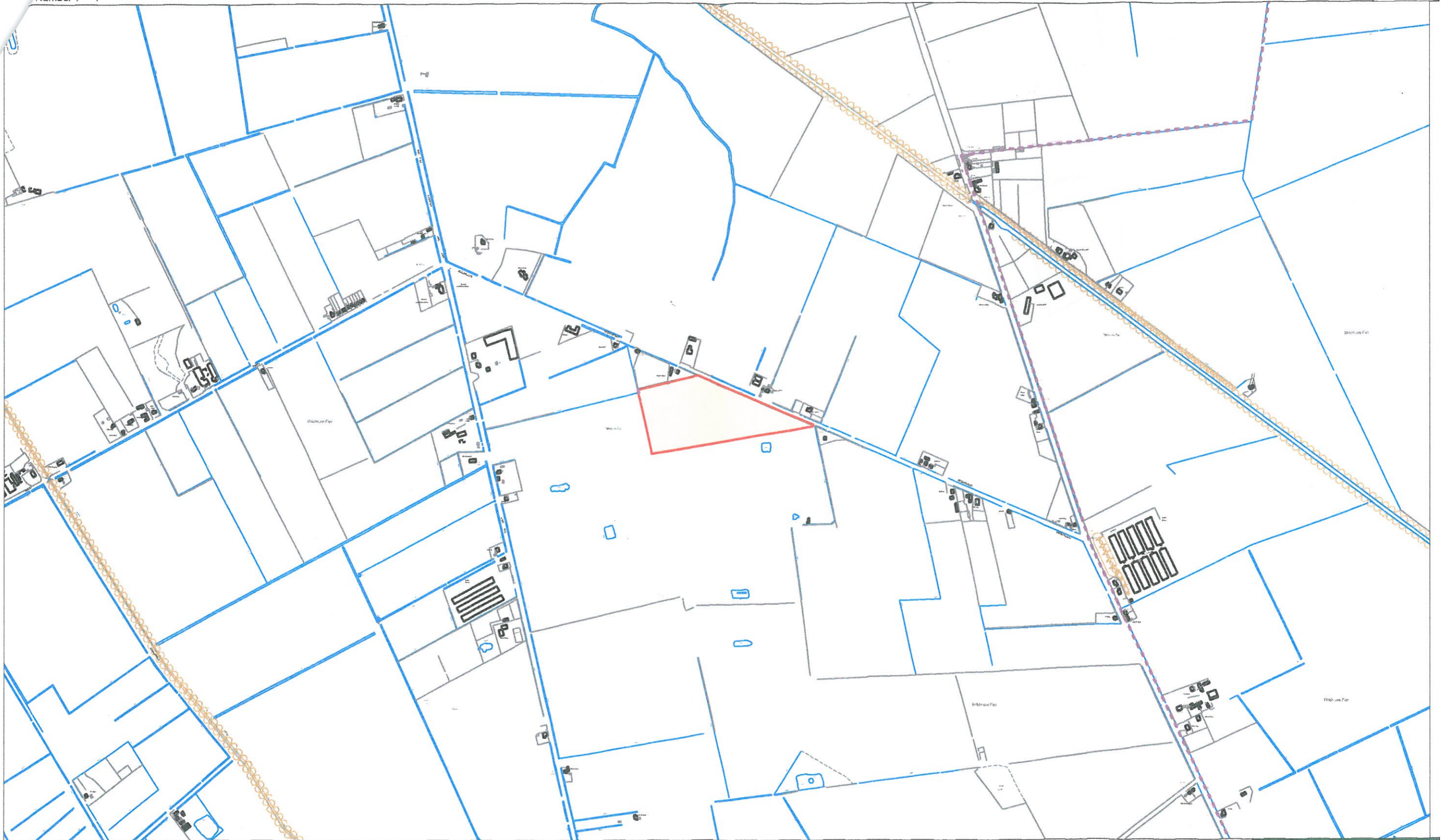

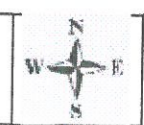

10. 'Appropriate authority' means (a) in relation to a map or statement deposited or declaration lodged under section 31(6) of that Act, an appropriate council (as defined in section 31(7) of the Highways Act 1980); and (b) in relation to a statement and map deposited under section 15A(1) of the 2006 Act, a commons registration authority (defined in section 4 of the Commons Act 2006 and section 2 of the Commons Registration Act 1965). In practice, the appropriate council and commons registration authority will usually be the same body.

PART A: Information relating to the applicant and land to which the application relates

(all applicants must complete this Part)

1. Name of appropriate authority to which the application is addressed:
Lincolnshire County Council

2. Name and full address (including postcode) of applicant:

The Church Commissioners for England
C/o Savills (UK) Ltd, the Regatta, Henley Way, Lincoln, LN6 3QR

3. Status of applicant (tick relevant box or boxes):

I am

(a) the owner of the land(s) described in paragraph 4.

(b) making this application and the statements/declarations it contains on behalf of The Church Commissioners for England who are the owners of the land(s) described in paragraph 4 and in my capacity as Rural Asset Manager.

4. Insert description of the land(s) to which the application relates (including full address and postcode):

1. Land known as Allotments, West Ashby – Wildmore, Hundle House Lane, Lincoln, LN4 4YW – **Plan 13 0624**
2. Land – Wrangle, Wra,gle Bank, PE22 9DU – **Plan 13 0589**
3. Willows Farm, Hogsthorpe, PE24 5QH – **Plan 13 0574**
4. Land Hogsthorpe, South lngs Lane, PE24 5NT – **Plan 13 0574**

5. Ordnance Survey six-figure grid reference(s) of a point within the area of land(s) to which the application relates (if known):

Unknown

6. This deposit comprises the following declarations Part C:

PART B: Statement under section 31(6) of the Highways Act 1980

The Church Commissioners for England are the owners of the land described in paragraph 4 of Part A of this form and shown outlined in red and hatched green on the map accompanying this statement.

Ways shown purple on the accompanying map are public footpaths.

No other ways over the land shown outlined in red on the accompanying map have been dedicated as highways.

PART C: Declaration under section 31(6) of the Highways Act 1980

1. The Church Commissioners for England are the owners of the land described in paragraph 4 of Part A of this form and shown outlined in red on the maps accompanying this declaration with Lincolnshire Council on 12/02/2010.

2. On the 12th day of February 2010 The Church Commissioners for England deposited with Lincolnshire County Council, being the appropriate council, a statement accompanied by a map showing The Church Commissioners for England's property outlined in red which stated that:

the ways shown green on that map and on the map accompanying this declaration had been dedicated as bridleways

the ways shown purple on that map and on the map accompanying this declaration had been dedicated as footpaths

no other ways had been dedicated as highways over The Church Commissioners for England's property.

4. No additional ways have been dedicated over the land outlined in red on the maps accompanying this declaration/referenced in paragraph 1 above since the statement dated 12/02/2010 referred to in paragraph 2 above since the date of the declaration referred to in paragraph 3 above other than those bridleways and footpaths marked in the appropriate colour on the maps accompanying this declaration and at the present time The Church Commissioners for England have no intention of dedicating any more public rights of way over the property.

PART E: Additional information relevant to the application

There are 3 plans attached to this application

- LAND INCLUDES (WILLOW) (WILLOW)
1. Allotments – West Ashby, Hundle House Lane, Lincoln, LN4 4YW – Plan 13 0624
 2. Land – Wrangle, Wrangle Bank, PE22 9DU – Plan 13 0589
 3. Willows Farm, Hogsthorpe, PE24 5QH – Plan 13 0574
 4. Land Hogsthorpe, South Ings Lane, PE24 5NT – Plan 13 0574

PART F: Statement of Truth
(all applicants must complete this Part)

WARNING: If you dishonestly enter information or make a statement that you know is, or might be, untrue or misleading, and intend by doing so to make a gain for yourself or another person, or to cause loss or the risk of loss to another person, you may commit the offence of fraud under section 1 of the Fraud Act 2006, the maximum penalty for which is 10 years' imprisonment or an unlimited fine, or both.

I BELIEVE THAT THE FACTS AND MATTERS CONTAINED

Signature (of the person making the statement of truth):

Print full name: DAVID IAN GOODSON

Date: 23/9/2015

You should keep a copy of the completed form

Data Protection Act 1998 – Fair Processing Notice

The purpose of this Fair Processing Notice is to inform you of the use that will be made of your personal data, as required by the Data Protection Act 1998.

The appropriate authority (see explanation of definition in above guidance notes) in England is the data controller in respect of any personal data that you provide when you complete this form.

The information that you provide will be used by the appropriate authority in its duties to process applications to deposit statements, maps and declarations under section 31(6) the Highways Act 1980 and statements under section 15A(1) of the Commons Act 2006. The information you provide will also be used by the appropriate authority in its duty to update the registers in which details of such deposits are recorded under the Dedicated Highways (Registers under Section 31A of the Highways Act 1980) (England) Regulations 2007 and the Commons (Registration of Town or Village Greens) and Dedicated Highways (Landowner Statements and Declarations) (England) Regulations 2013.

The appropriate authority is required by the legislation above to maintain a register which holds information provided in this form, which can be inspected online or in person by members of the public on request. It may also be required to release information, including personal data and commercial information, on request under the Environmental Information Regulations 2004 or the Freedom of Information Act 2000. However, the appropriate authority will not permit any unwarranted breach of confidentiality nor will they act in contravention of their obligations under the Data Protection Act 1998.

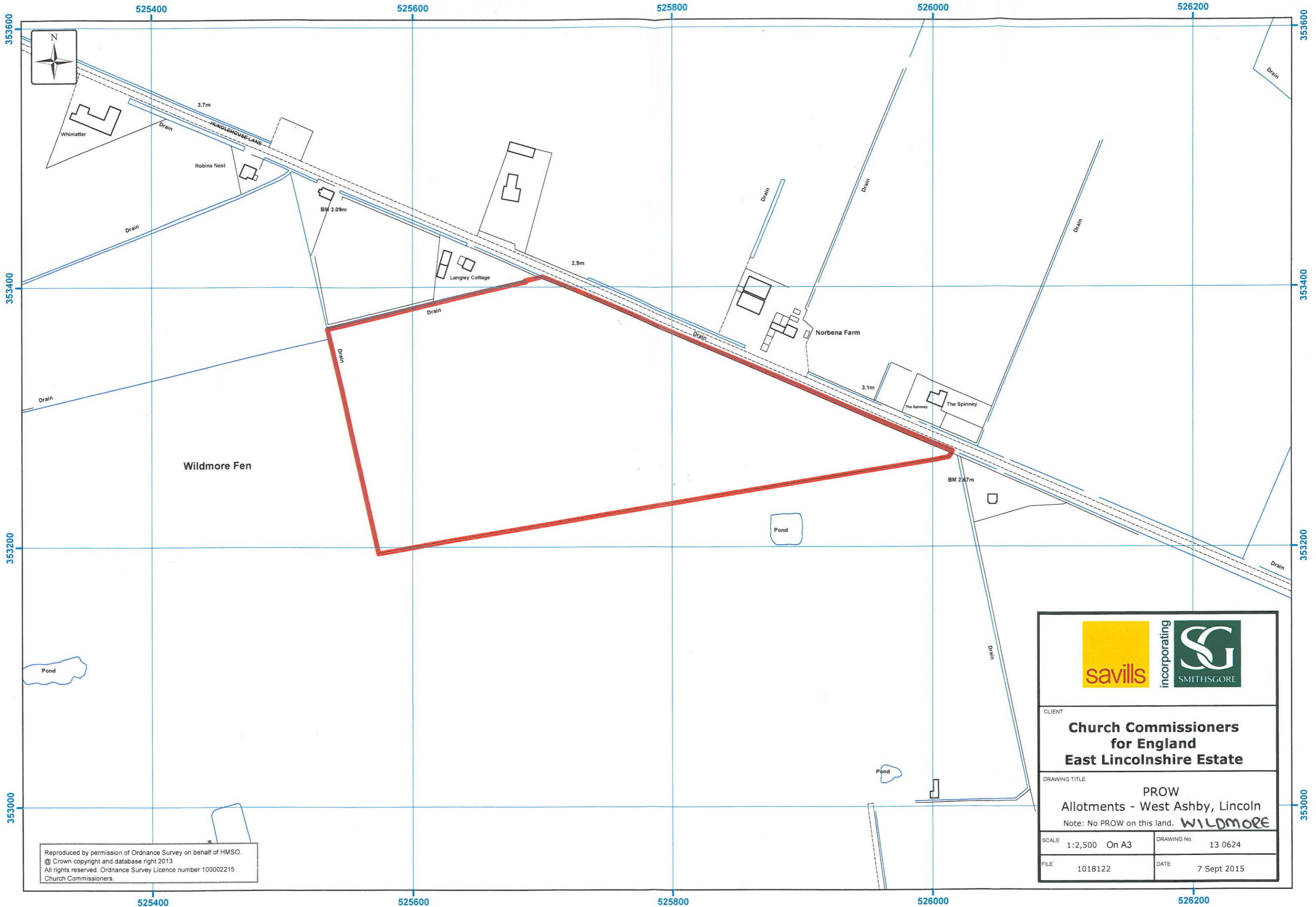

Wildmore Fen

 	
CLIENT Church Commissioners for England East Lincolnshire Estate	
DRAWING TITLE PROW Allotments - West Ashby, Lincoln Note: No PROW on this land. WILDMORE	
SCALE 1:2,500 On A3	DRAWING No. 13 0624
FILE 1018122	DATE 7 Sept 2015

Reproduced by permission of Ordnance Survey on behalf of HMSO.
 © Crown copyright and database right 2013
 All rights reserved. Ordnance Survey Licence number 100002215
 Church Commissioners.

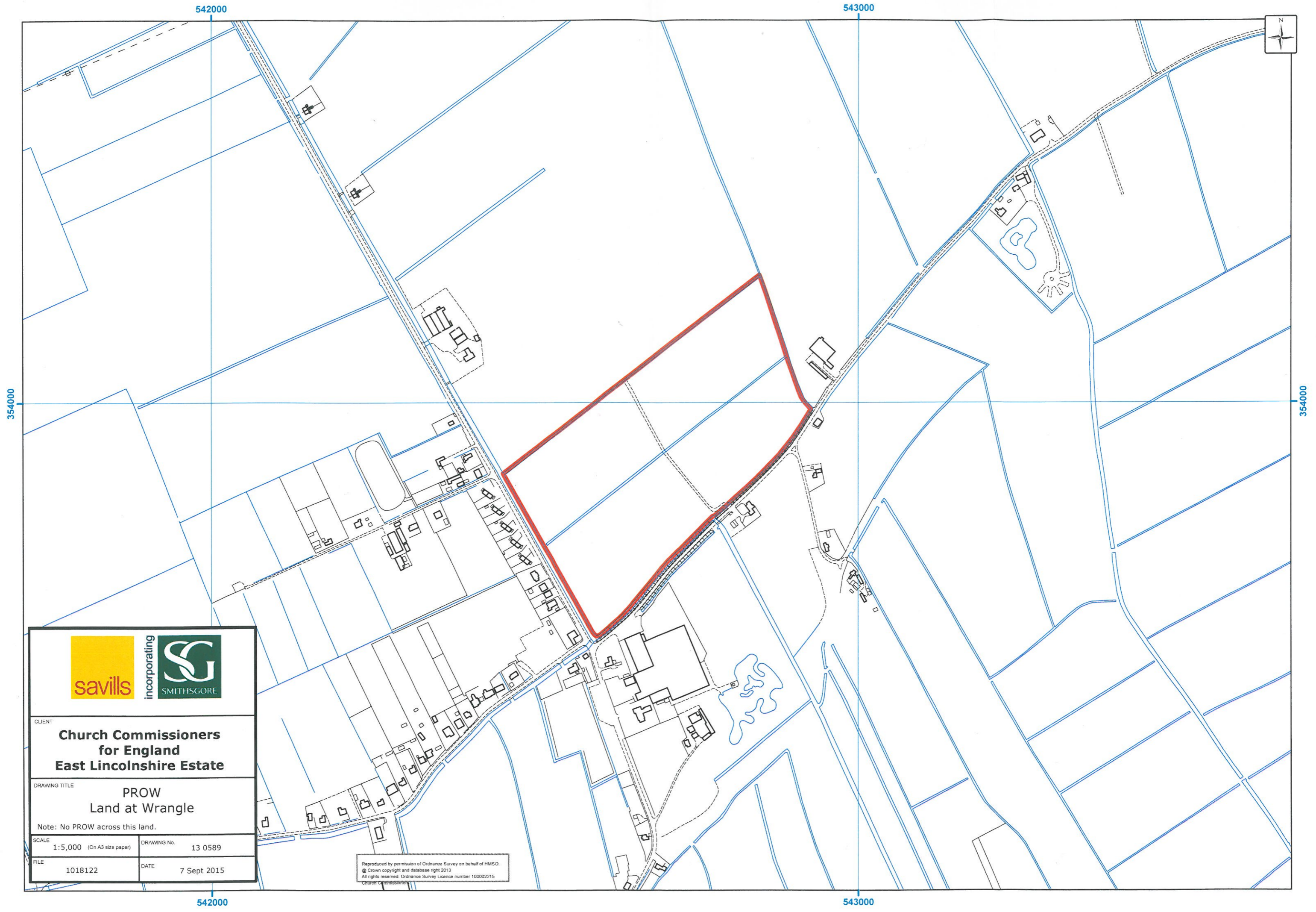

CLIENT
**Church Commissioners
for England
East Lincolnshire Estate**

DRAWING TITLE
**PROW
Land at Wrangle**
Note: No PROW across this land.

SCALE 1:5,000 (On A3 size paper) DRAWING No. 13 0589

FILE 1018122 DATE 7 Sept 2015

Reproduced by permission of Ordnance Survey on behalf of HMSO.
© Crown copyright and database right 2013.
All rights reserved. Ordnance Survey Licence number 100002215
Church Commissioners

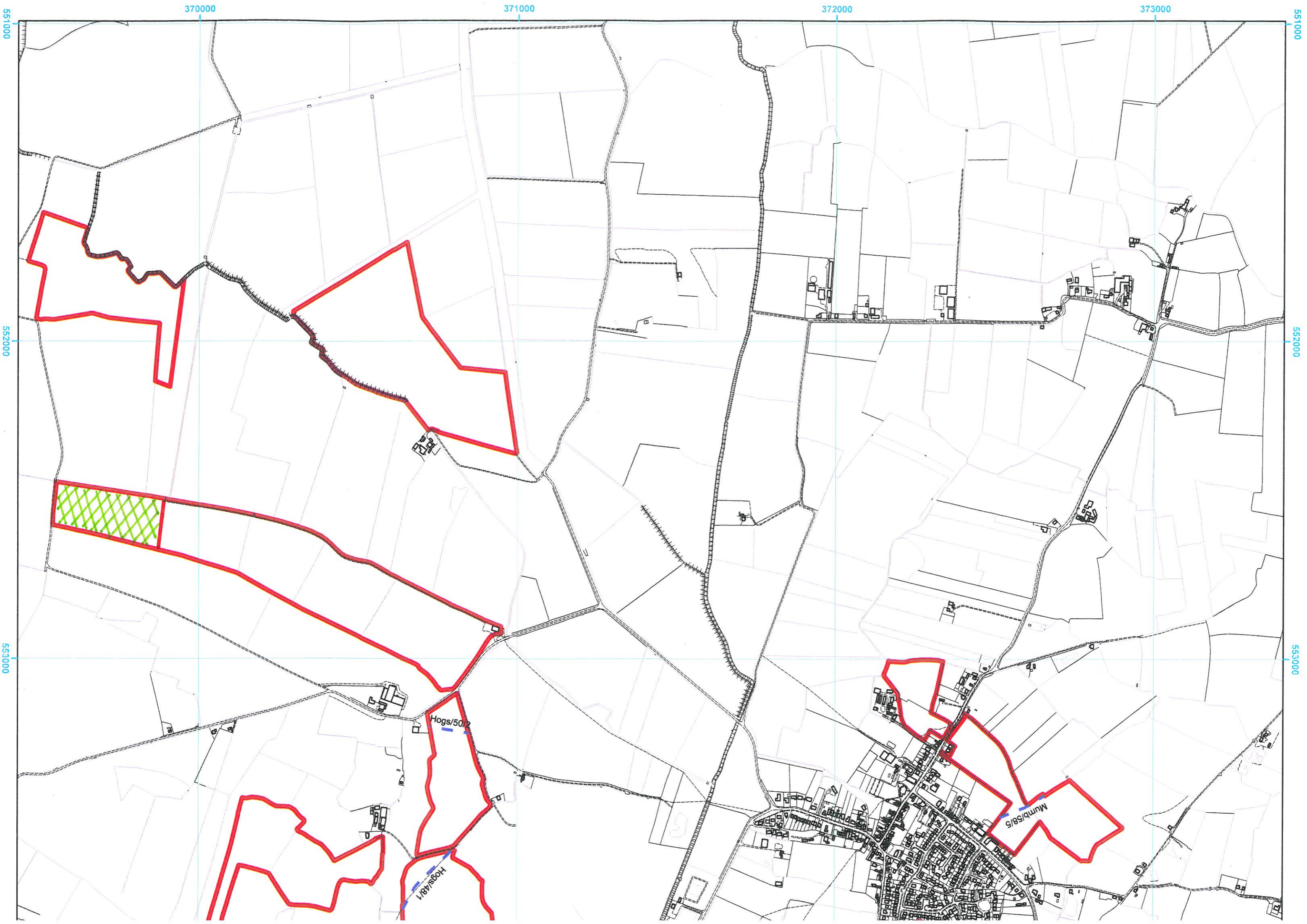



Legend
Public Footpath



incorporating



CLIENT
**Church Commissioners
for England
East Lincolnshire Estate**

DRAWING TITLE
**Public Rights of Way
Part Willows Farm and
Land At Hogsthorpe**

SCALE
1:10,000 On A2

DRAWING No. 13 0574

FILE DATE
7 Sept 2015

Reproduced by permission of Ordnance Survey on behalf of HMSO.
© Crown copyright and database right 2013
All rights reserved. Ordnance Survey Licence number: 100002215
Church Commissioners

