

Parish: Grayingham and Waddingham
Title: Land at Grayingham and Waddingham
Reference number: CA/7/1/425

HIGHWAYS ACT 1980, SECTION 31 (6) – DEPOSITED MAPS, HIGHWAYS STATEMENT AND HIGHWAYS DECLARATIONS

Date of deposit of map and highways statement 26.08.2016
Depositor's name and address Mr W Strawson, Low Risby Farms, Broughton Grange, Wressle, Brigg, DN20 0BJ
Dates of deposit of highways declarations and names and addresses of depositors NO HIGHWAYS DECLARATION HAS BEEN DEPOSITED
Date deposit expires: 25.08.2036

COMMONS ACT 2006, SECTION 15A (1) – DEPOSITED MAPS AND LANDOWNER STATEMENTS

Dates of deposit of maps and landowner statements, and names and addresses of depositors (1) 26.08.2016: Mr W Strawson, Low Risby Farms, Broughton Grange, Wressle, Brigg, DN20 0BJ
[combined deposit]

GEOGRAPHIC LOCATION

Grid Reference: SK994 962, SK945 958
Address and postcode of buildings on the deposited land True Pennys, Grayingham Cliff, Grayingham, Gainsborough, DN21 4FL
District West Lindsey
Nearest city or town Brigg

ENQUIRIES ABOUT THE REGISTER OR DEPOSITS

Enquiries concerning the register or the deposits lodged with the County Council should be made to the Definitive Map Officer at Lincolnshire County Council's Countryside Services Section by email to countryside_access@lincolnshire.gov.uk or by telephone on 01522 782070.

INFORMATION ABOUT THE REGISTER OF DEPOSITS

The County Council is required by law to keep and maintain a register of highways statements and highways declarations deposited under section 31 (6) of the Highways Act 1980 and landowner statements deposited under section 15A (1) of the Commons Act 2006. The register is available for public inspection on its website and in a paper copy format, together with copies of the deposited documents. Details, including names, addresses and the location of land relating to an application, which may be considered to be personal information, will therefore be in the public domain. This requirement overrides any entitlement a depositor and landowner may otherwise have under the Data Protection Act 1998 to prevent the publication of such information.

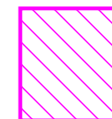
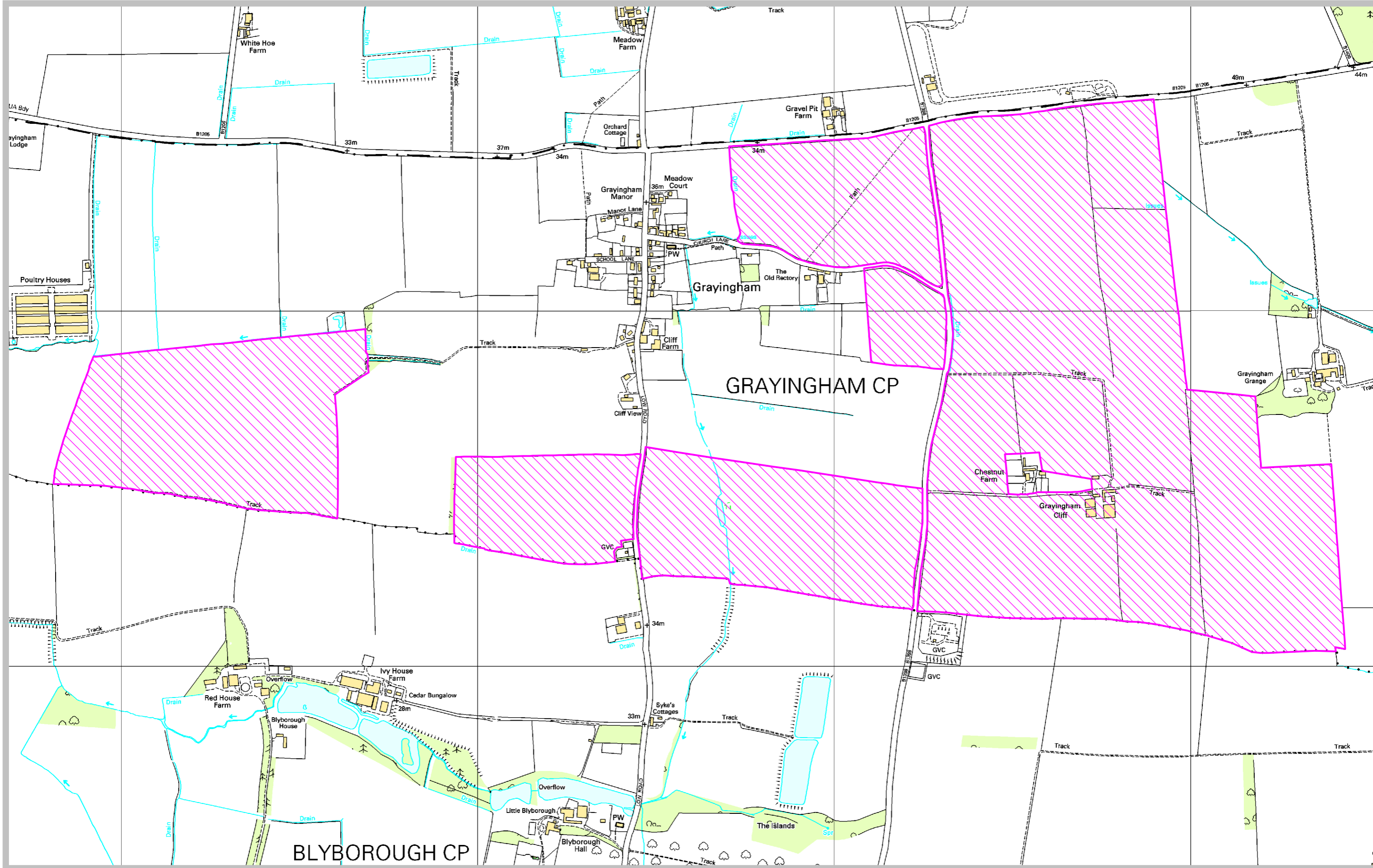

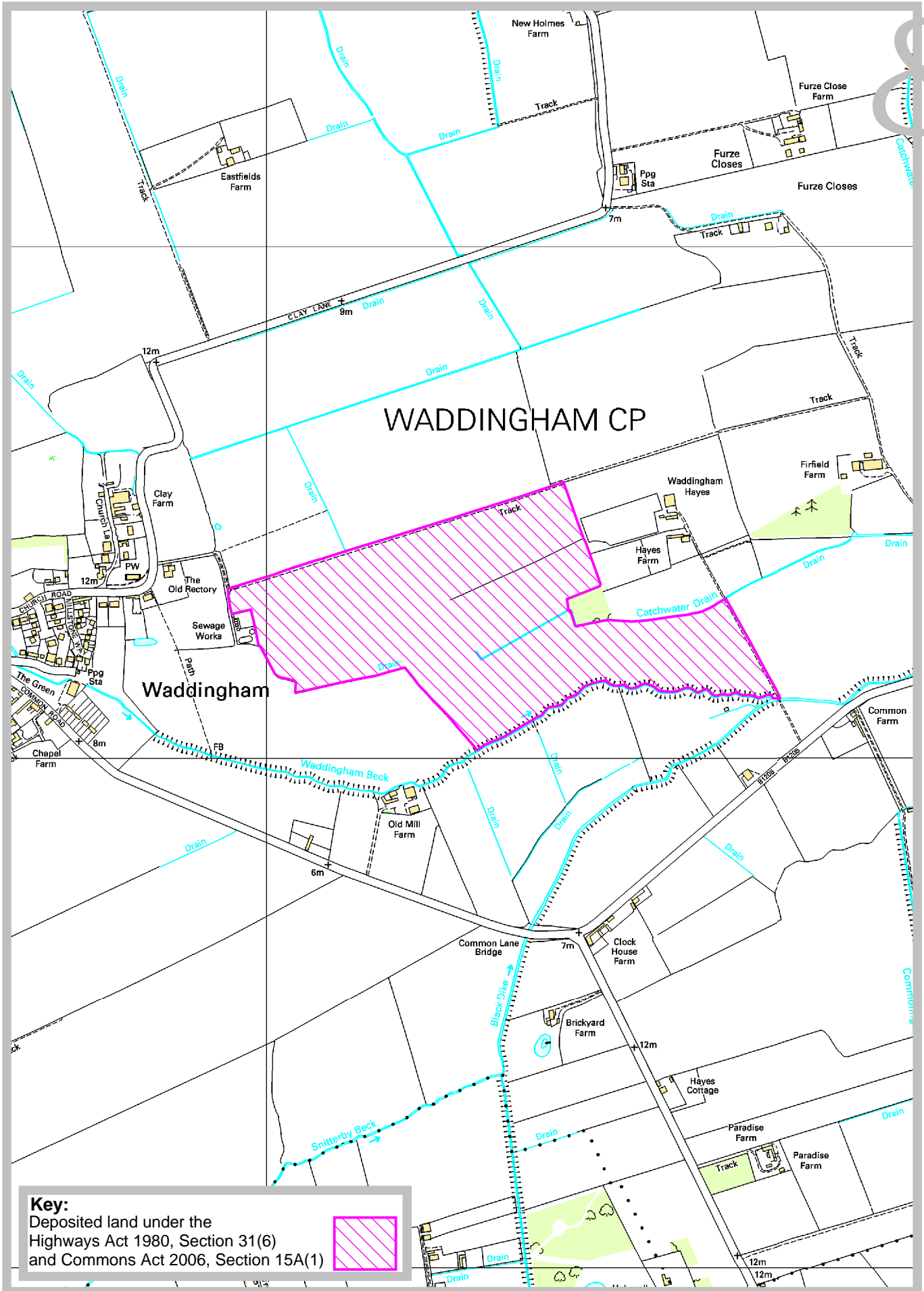
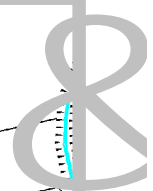

Key:
 Deposited land under the
 Highways Act 1980, Section 31(6)
 and Commons Act 2006, Section 15A(1)



Countryside Services
 RA Wills, Executive Director for Environment &
 Economy, County Offices, Newland, Lincoln,
 LN1 1YL.

**Land at Grayingham and
 Waddingham**
 Ref: CA/7/1/425
 Grid Ref: SK994 962
 Scale: approx. 1:10,000

10. 'Appropriate authority' means (a) in relation to a map or statement deposited or declaration lodged under section 31(6) of that Act, an appropriate council (as defined in section 31(7) of the Highways Act 1980); and (b) in relation to a statement and map deposited under section 15A(1) of the 2006 Act, a commons registration authority (defined in section 4 of the Commons Act 2006 and section 2 of the Commons Registration Act 1965). In practice, the appropriate council and commons registration authority will usually be the same body.

**PART A: Information relating to the applicant and land to which the application relates
(all applicants must complete this Part)**

1. Name of appropriate authority to which the application is addressed:

Lincolnshire Council

2. Name and full address (including postcode) of applicant:

William Robert Strawson
Low Risby Farms
Broughton Grange
Wressle
BRIGG
DN20 0BJ

3. Status of applicant (tick relevant box or boxes):

I am

(a) the owner of the land(s) described in paragraph 4.

4. Insert description of the land(s) to which the application relates (including full address and postcode):

Land to the South, East and West of Grayingham, Grayingham, in the Parish of Grayingham

Land to the East of Waddingham, Waddingham, in the Parish of Waddingham

5. Ordnance Survey six-figure grid reference(s) of a point within the area of land(s) to which the application relates (if known):

SK945958, SK994962

6. This deposit comprises the following statement(s) and/or declarations (*delete Parts B, C, or D where not applicable*):

PART B: Statement under section 31(6) of the Highways Act 1980

I am William Robert Strawson the owner of the land described in paragraph 4 of Part A of this form and shown outlined red on the maps accompanying this statement.

Ways shown black on the accompanying map are public footpaths.

No other ways over the land shown on the accompanying map have been dedicated as highways.

PART D: Statement under section 15A(1) of the Commons Act 2006

I William Robert Strawson the owner of the land described in paragraph 4 of Part A of this form and shown outlined red on the map [accompanying this statement/deposited with Lincolnshire Council on [25th 8th, 2016].

I William Robert Strawson wish to bring to an end any period during which persons may have indulged as of right in lawful sports and pastimes on the whole or any part of the land shown outlined red on the accompanying maps.

PART E: Additional information relevant to the application
(insert any additional information relevant to the application)

PART F: Statement of Truth
(all applicants must complete this Part)

WARNING: If you dishonestly enter information or make a statement that you know is, or might be, untrue or misleading, and intend by doing so to make a gain for yourself or another person, or to cause loss or the risk of loss to another person, you may commit the offence of fraud under section 1 of the Fraud Act 2006, the maximum penalty for which is 10 years' imprisonment or an unlimited fine, or both.

I BELIEVE THAT THE FACTS AND MATTERS CONTAINED IN THIS FORM ARE TRUE

Signature (of the person making the statement of truth):

Print full name: William Robert

Date: 25th/8th/2016

You should keep a copy of the completed form

Data Protection Act 1998 - Fair Processing Notice

The purpose of this Fair Processing Notice is to inform you of the use that will be made of your personal data, as required by the Data Protection Act 1998.

The appropriate authority (see explanation of definition in above guidance notes) in England is the data controller in respect of any personal data that you provide when you complete this form.

The information that you provide will be used by the appropriate authority in its duties to process applications to deposit statements, maps and declarations under section 31(6) the Highways Act 1980 and statements under section 15A(1) of the Commons Act 2006. The information you provide will also be used by the appropriate authority in its duty to update the registers in which details of such deposits are recorded under the Dedicated Highways (Registers under Section 31A of the Highways Act 1980) (England) Regulations 2007 and the Commons (Registration of Town or Village Greens) and Dedicated Highways (Landowner Statements and Declarations) (England) Regulations 2013.

The appropriate authority is required by the legislation above to maintain a register which holds information provided in this form, which can be inspected online or in person by members of the public on request. It may also be required to release information, including personal data and commercial information, on request under the Environmental Information Regulations 2004 or the Freedom of Information Act 2000. However, the appropriate authority will not permit any unwarranted breach of confidentiality nor will they act in contravention of their obligations under the Data Protection Act 1998.

Grayingham

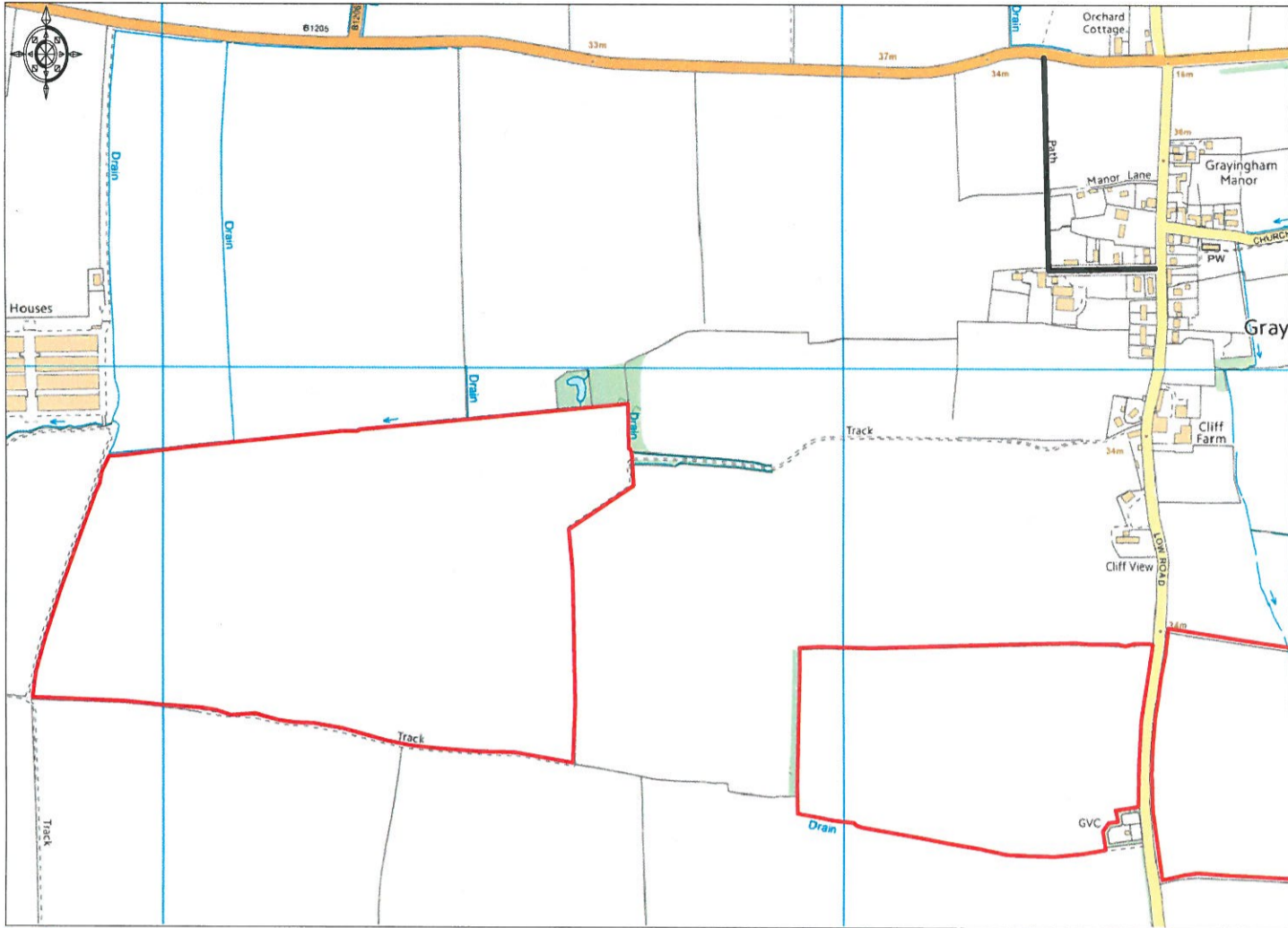

Ordnance Survey © Crown Copyright 2016. All rights reserved. Licence number 100022432. Plotted Scale - 1:10000

WW/BR-16/072
22 August 2016

Waddingham

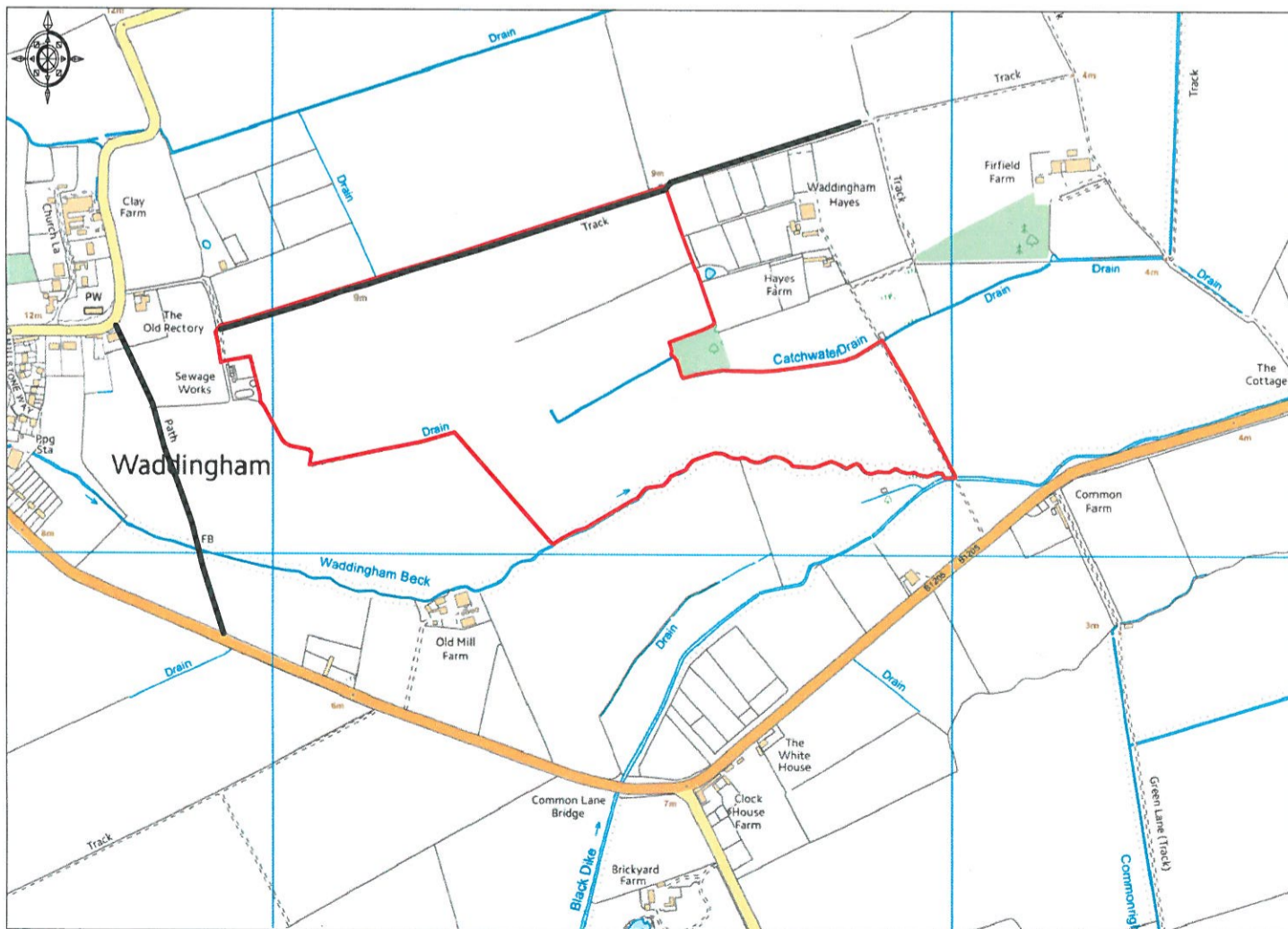

Ordnance Survey © Crown Copyright 2016. All rights reserved. Licence number 100022432. Plotted Scale - 1:10000

WW/BR-16/072
22 August 2016

Grayingham

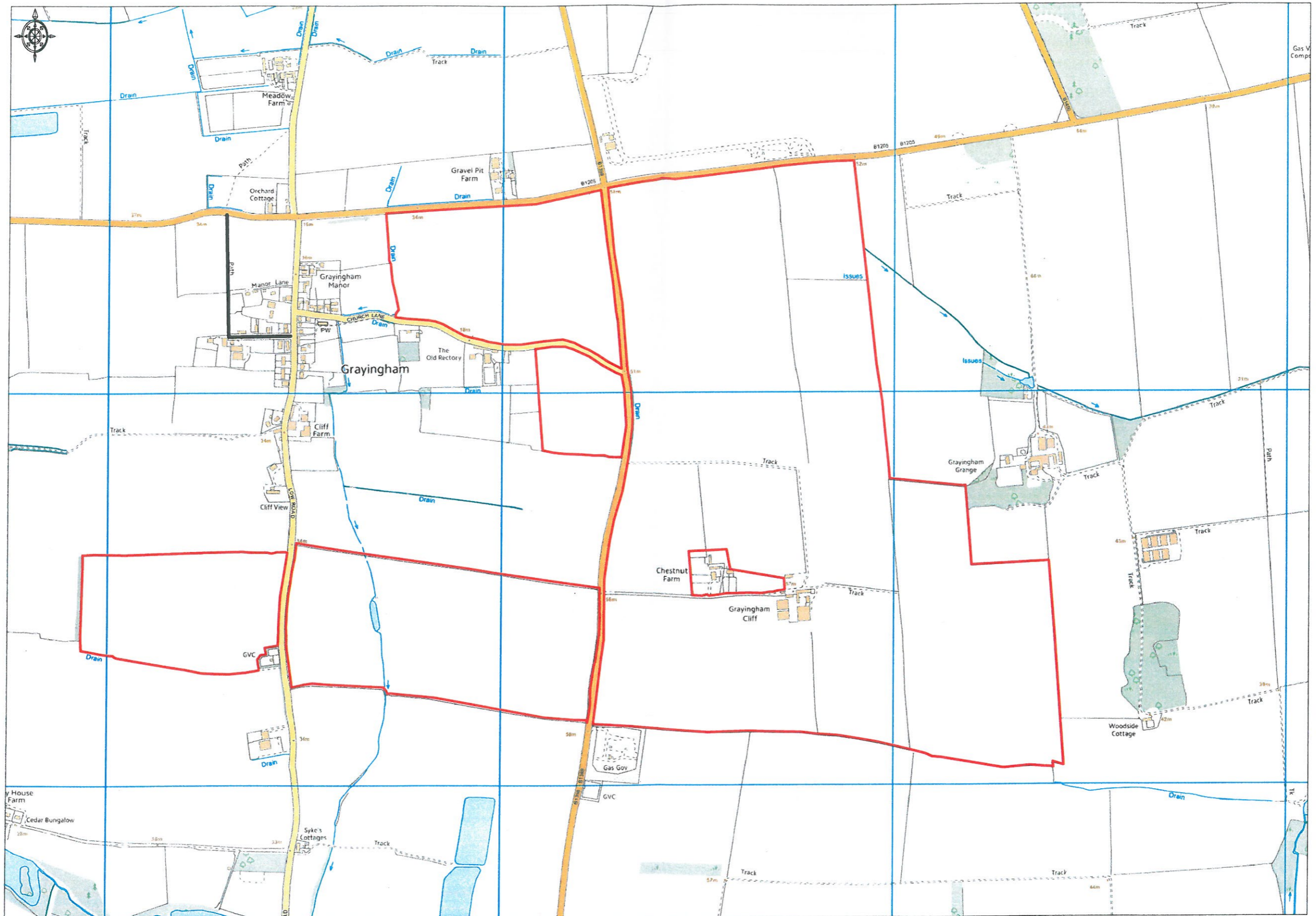

Ordnance Survey © Crown Copyright 2016. All rights reserved. Licence number 100022432. Plotted Scale - 1:10000



WW/BR-16/072
22 August 2016