

Parish: Surfleet
Title: Land at Gosberton Cheal
Reference number: CA/7/1/409

**DEPOSIT OF MAP AND STATEMENT AND STATUTORY DECLARATION(S) UNDER
HIGHWAYS ACT 1980, SECTION 31(6) AND COMMONS ACT 2006, SECTION 15A(1)**

Geographic Location

Grid Reference: TF237 282, TF229 287

**Address and postcode
of buildings on the
deposited land**

District South Holland

Nearest city or town Spalding

Highways Act 1980, Section 31(6) deposits

**Date of deposit of map
and statement** 21.07.2014

**Depositor's name and
address** Mr S Harrison, Beach Bank Farm, Beach Bank, Surfleet, Spalding, PE11 4AX

**Date of deposit of
declaration, name and
address of depositor** (1) 16.10.14: Mr S Harrison, Beach Bank Farm, Beach Bank, Surfleet,
Spalding, PE11 4AX

Date deposit expires: 15.10.2034

Commons Act 2006, Section 15A(1)

**Date of deposit of map
and statement, name
and address of
depositor** (1) 21.07.2014: Mr S Harrison, Beach Bank Farm, Beach Bank, Surfleet,
Spalding, PE11 4AX [*combined deposit*]

COUNTY COUNCIL'S CONTACT DETAILS

Officer and Section: Definitive Map Officer, Public Rights of Way and Countryside Access

Address: Lincolnshire County Council, Communities, 4th Floor, City Hall, Lincoln, LN1
1DN

Telephone: 01522 782070

Email: countryside_access@lincolnshire.gov.uk

REGISTER OF DEPOSITS

The County Council is required by law to keep a register of maps and statements and declarations deposited under Section 31(6) of the Highways Act 1980 and Section 15A(1) of the Commons Act 2006 available for public inspection on its website and in a paper copy format together with the deposited documents. Details including names, addresses and the location of land relating to a deposit which may be considered to be personal information are therefore in the public domain. This requirement overrides any entitlement a depositor may otherwise have under the Data Protection Act 1998 to prevent publication of such information. The paper copy of the register together with the deposited documents can be viewed by appointment during normal office hours (9:00am to 4:30pm, Monday to Friday) at the County Council's Public Rights of Way and Countryside Section at the above address.

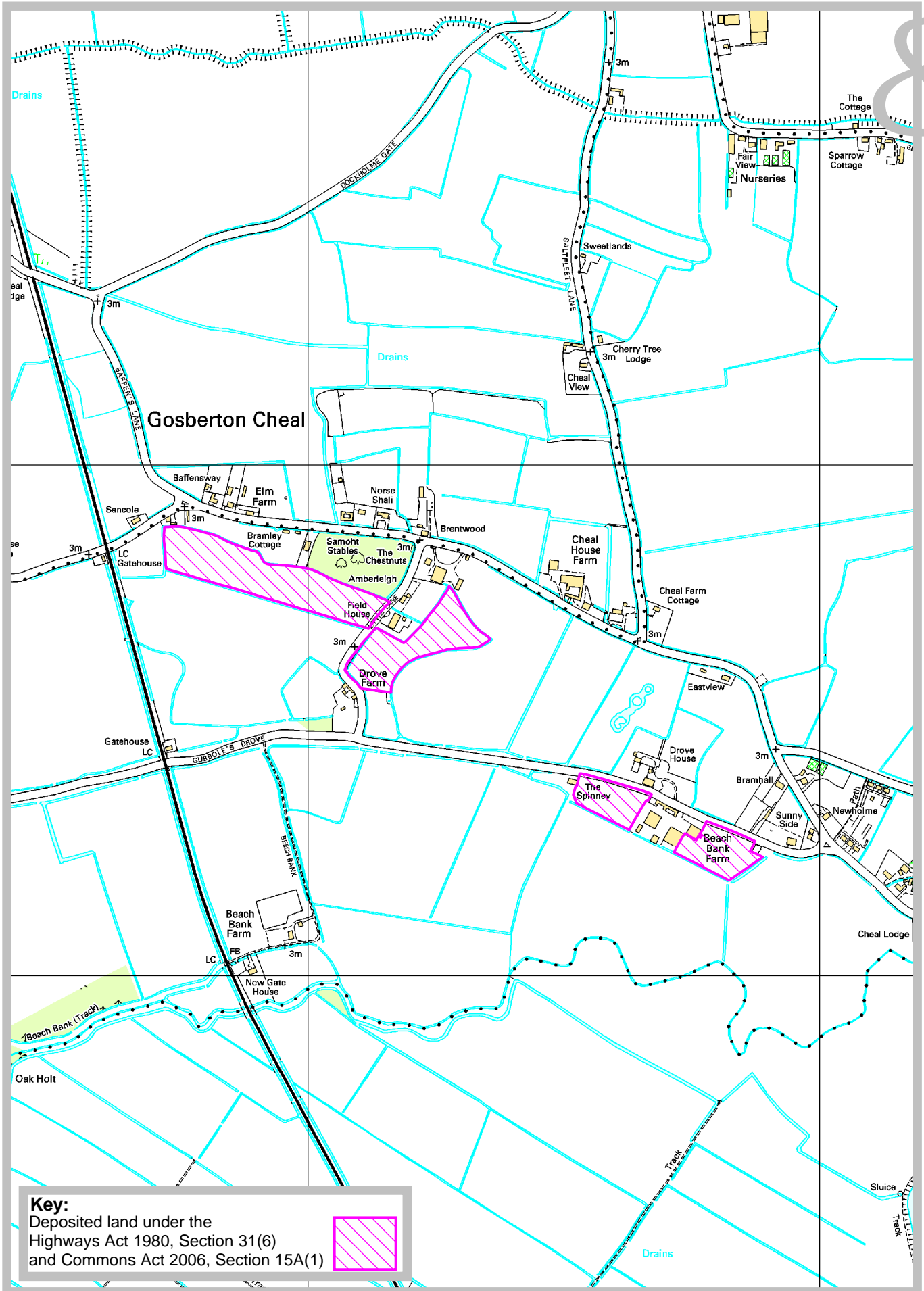

Rights of Way & Countryside Access
 RA Wills, Executive Director for Environment & Economy
 City Hall, Orchard Street,
 Lincoln LN1 1DN

Land at Gosberton Chel

Ref: CA/7/1/409
 Grid Ref: TF237 282, TF229 287
 Scale: approx. 1:10,000

PART A: Information relating to the applicant and land to which the application relates
(all applicants must complete this Part)

1. Name of appropriate authority to which the application is addressed:

Lincolnshire County Council
Communities
City Hall
4th Floor
Lincoln
LN1 1DN

2. Name and full address (including postcode) of applicants:

Simon Harrison, Beach Bank Farm, Beach Bank, Surfleet, Spalding, Lincolnshire,
PE11 4AX

3. Status of applicant (tick relevant box or boxes):

I am the owner of the land(s) described in paragraph 4.

4. Insert description of the land(s) to which the application relates (including full address and postcode):

This application relates to agricultural land, as shown edged in red on the attached plan, in the county of Lincolnshire, in close proximity to the village of Surfleet.

5. Ordnance Survey six-figure grid reference(s) of a point within the area of land(s) to which the application relates (if known):

TF 229 281

6. This deposit comprises the following statement(s) and/or declarations (*delete Parts B, C, or D where not applicable*):

Parts A, B, D & F

PART B: Statement under section 31(6) of the Highways Act 1980

I, the above-named, am the owner of the land described in paragraph 4 of Part A of this form and edged in red on the map accompanying this statement.

No other ways over the land shown edged in red on the accompanying map have been dedicated as highways.

PART D: Statement under section 15A(1) of the Commons Act 2006

I am the owner of the land described in paragraph 4 of Part A of this form and edged in red on the map accompanying this statement.

I wish to bring to an end any period during which persons may have indulged as of right in lawful sports and pastimes on the whole or any part of the land shown edged in red on the map referenced above.

PART F: Statement of Truth
(all applicants must complete this Part)

WARNING: If you dishonestly enter information or make a statement that you know is, or might be, untrue or misleading, and intend by doing so to make a gain for yourself or another person, or to cause loss or the risk of loss to another person, you may commit the offence of fraud under section 1 of the Fraud Act 2006, the maximum penalty for which is 10 years' imprisonment or an unlimited fine, or both.

I BELIEVE THAT THE FACTS AND MATTERS CONTAINED IN THIS FORM ARE TRUE

Signature (of the person making the statement of truth):



.....
Print full name:

Don

Date:

You should keep a copy of the completed form

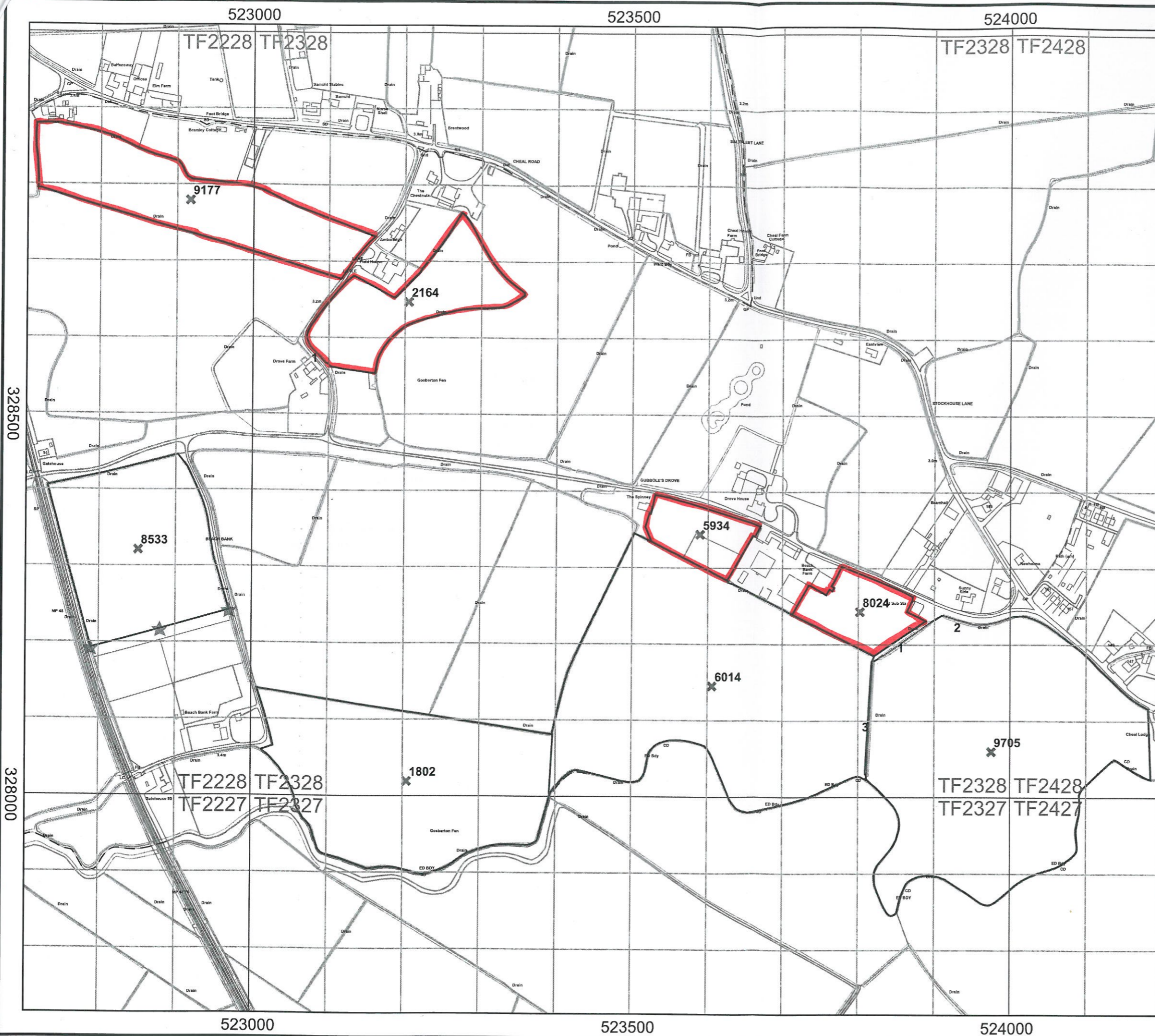

Rural Land Register (RLR) Map

SBI - 106407687
Page 1 of 4

Legend

- Your RLR Parcel(s)
- SPS Permanent Ineligible Features
- Adjacent Parcel Boundary
- Unconfirmed Boundary

RLR Information

Sheet ID	Parcel ID	Total Area (ha)	SPS Recorded Eligible Area (ha)	English Region
TF2228	9177	3.55	3.55	N
TF2328	2164	2.20	2.20	N
TF2228	8533	4.05	4.05	N
TF2328	6014	9.82	9.82	N
TF2328	8024	1.10	1.10	N
TF2328	5934	0.95	0.95	N
TF2328	1802	6.53	6.53	N
TF2328	9705	9.97	9.90	N

Scale - 1:5000

W E 50m 0m 50m 100m 150m 200m S

You are not permitted to copy, sub-license, distribute or sell any of this data to third parties in any form.
© Crown copyright and database right 2013. All rights reserved.
Ordnance Survey Licence number 100029155
Licensed for RPA for PGA through Next Perspectives™

Date: 24/02/2014

Application Forms for deposits under section 31(6) of the Highways Act 1980 and section 15A(1) of the Commons Act 2006

PART A: Information relating to the applicant and land to which the application relates

(all applicants must complete this Part)

1. Name of appropriate authority to which the application is addressed:

Lincolnshire County Council
Communities
City Hall
4th Floor
Lincoln
LN1 1DN

2. Name and full address (including postcode) of applicant:

Simon Harrison, Beach Bank Farm, Beach Bank, Surfleet, Spalding, Lincolnshire, PE11 4AX.

3. Status of applicant (tick relevant box or boxes):

I am the owner of the land described in paragraph 4.

4. Insert description of the land(s) to which the application relates (including full address and postcode):

The application relates to agricultural land, as shown edged in red on the map lodged with Lincolnshire County Council on 21st July 2014.

5. Ordnance Survey six-figure grid reference(s) of a point within the area of land(s) to which the application relates (if known):

TF 229 281

6. This deposit comprises the following statements and declarations (*delete Parts B, C, or D where not applicable*):

Parts A, C and F.

PART C: Declaration under section 31(6) of the Highways Act 1980

1. I am the owner of the land described in paragraph 4 of Part A of this form and shown edged in red on the map lodged with Lincolnshire County Council on 21st July 2014.

2. On the 21st day of July 2014 I deposited with Lincolnshire County Council, being the appropriate council, a statement accompanied by a map showing my property edged in red which stated that:

no ways had been dedicated as highways over my property.

4. No additional ways have been dedicated over the land edged in red on the map referenced in paragraph 1 above since the statement dated 10th July 2014 referred to in paragraph 2 above and at the present time I have no intention of dedicating any more public rights of way over my property.

PART F: Statement of Truth
(all applicants must complete this Part)

WARNING: If you dishonestly enter information or make a statement that you know is, or might be, untrue or misleading, and intend by doing so to make a gain for yourself or another person, or to cause loss or the risk of loss to another person, you may commit the offence of fraud under section 1 of the Fraud Act 2006, the maximum penalty for which is 10 years' imprisonment or an unlimited fine, or both.

I BELIEVE THAT THE FACTS AND MATTERS CONTAINED IN THIS FORM ARE TRUE

Signature (of the person making the statement of truth):

.....

Print full name:

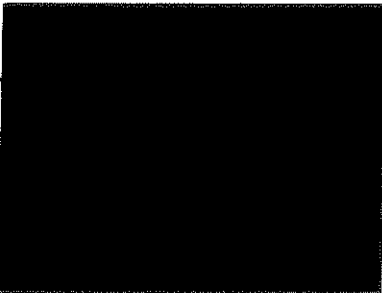

MASON

Date:

06 /

You should keep a copy of the completed form