

10. 'Appropriate authority' means (a) in relation to a map or statement deposited or declaration lodged under section 31(6) of that Act, an appropriate council (as defined in section 31(7) of the Highways Act 1980); and (b) in relation to a statement and map deposited under section 15A(1) of the 2006 Act, a commons registration authority (defined in section 4 of the Commons Act 2006 and section 2 of the Commons Registration Act 1965). In practice, the appropriate council and commons registration authority will usually be the same body.

**PART A: Information relating to the applicant and land to which the application relates
(all applicants must complete this Part)**

1. Name of appropriate authority to which the application is addressed: Lincolnshire County Council, Countryside Services, Lancaster House, 36 Orchard Street, Lincoln, LN1 1XX

2. Name and full address (including postcode) of applicant: Charlotte Martinson BSc (Hons), DDM Agriculture, Eastfield, Albert Street, Brigg, North East Lincolnshire, DN20 8HS

3. Status of applicant (tick relevant box or boxes):

I am

(a) the owner of the land(s) described in paragraph 4.

(b) making this application and the statements/declarations it contains on behalf of Herring Farms Limited who is the owner of the land(s) described in paragraph 4 and in my capacity as Land Agent.

4. Insert description of the land(s) to which the application relates (including full address and postcode):

Land surrounding Herring Farms Limited, Highfield Farm, Otby Lane, Walesby, Market Rasen, LN8 3UU

5. Ordnance Survey six-figure grid reference(s) of a point within the area of land(s) to which the application relates (if known):

TF 13675 92905 (Highfield Farms Limited)

6. This deposit comprises the following statement: Part B

PART B: Statement under section 31(6) of the Highways Act 1980

Herring Farms Limited is the owner of the land described in paragraph 4 of Part A of this form and shown edged in red on the map accompanying this statement.

Ways shown solid light blue line on the accompanying map are public footpaths.

No other ways over the land shown edged in red on the accompanying map have been dedicated as highways.

PART E: Additional information relevant to the application
(insert any additional information relevant to the application)

PART F: Statement of Truth
(all applicants must complete this Part)

WARNING: If you dishonestly enter information or make a statement that you know is, or might be, untrue or misleading, and intend by doing so to make a gain for yourself or another person, or to cause loss or the risk of loss to another person, you may commit the offence of fraud under section 1 of the Fraud Act 2006, the maximum penalty for which is 10 years' imprisonment or an unlimited fine, or both.

I BELIEVE THAT THE FACTS AND MATTERS CONTAINED IN THIS FORM ARE TRUE

Signature (of the person making the statement of truth): 

Print full name: CHARLOTTE MARTINSON

Date: 12 OCTOBER 2020

You should keep a copy of the completed form

Data Protection Act 1998 - Fair Processing Notice

The purpose of this Fair Processing Notice is to inform you of the use that will be made of your personal data, as required by the Data Protection Act 1998.

The appropriate authority (see explanation of definition in above guidance notes) in England is the data controller in respect of any personal data that you provide when you complete this form.

The information that you provide will be used by the appropriate authority in its duties to process applications to deposit statements, maps and declarations under section 31(6) the Highways Act 1980 and statements under section 15A(1) of the Commons Act 2006. The information you provide will also be used by the appropriate authority in its duty to update the registers in which details of such deposits are recorded under the Dedicated Highways (Registers under Section 31A of the Highways Act 1980) (England) Regulations 2007 and the Commons (Registration of Town or Village Greens) and Dedicated Highways (Landowner Statements and Declarations) (England) Regulations 2013.

The appropriate authority is required by the legislation above to maintain a register which holds information provided in this form, which can be inspected online or in person by members of the public on request. It may also be required to release information, including personal data and commercial information, on request under the Environmental Information Regulations 2004 or the Freedom of Information Act 2000. However, the appropriate authority will not permit any unwarranted breach of confidentiality nor will they act in contravention of their obligations under the Data Protection Act 1998.

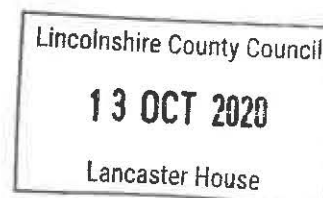

Site Plan

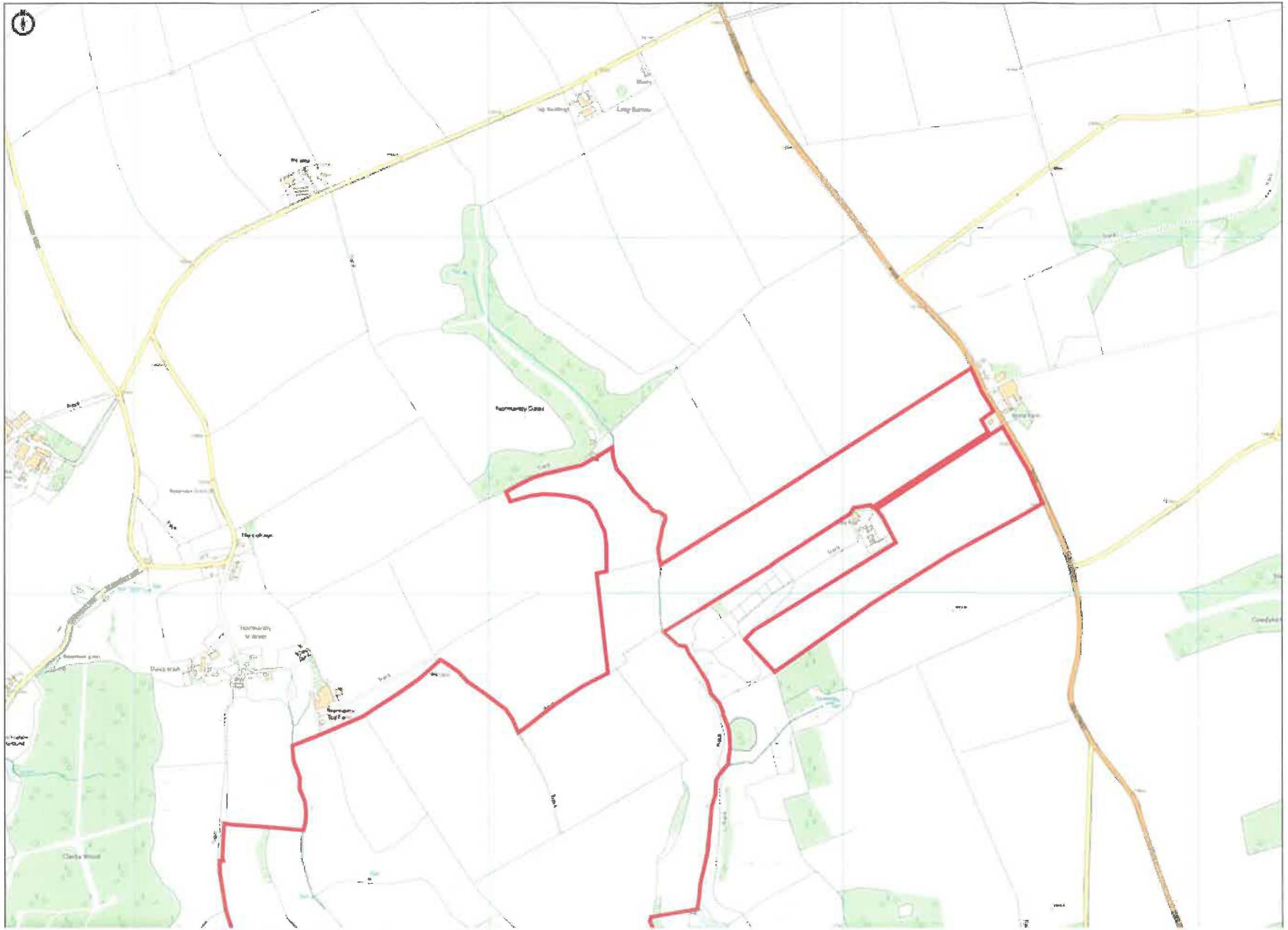
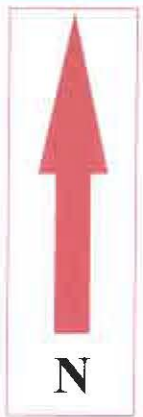

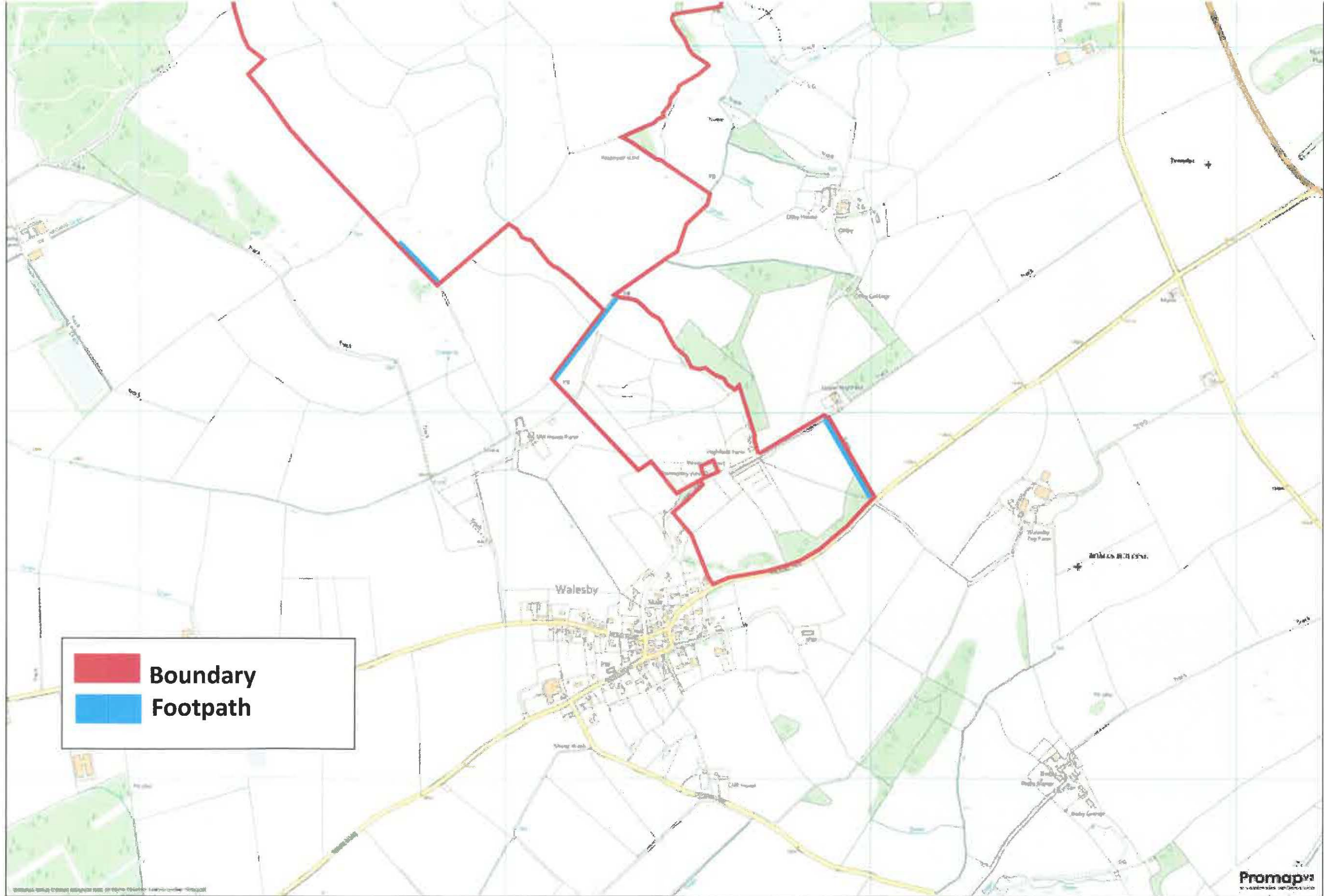

Date: 08 September 2020
Ref: CM/BW/H015D

This map is based on the Ordnance Survey with the sanction of the controller of H M Stationery Office crown copyright reserved licence number ES100029377.

Eastfield, Albert Street
BRIGG
DN20 8HS
Tel: 01652 653669
Fax: 01652 653311



10. 'Appropriate authority' means (a) in relation to a map or statement deposited or declaration lodged under section 31(6) of that Act, an appropriate council (as defined in section 31(7) of the Highways Act 1980); and (b) in relation to a statement and map deposited under section 15A(1) of the 2006 Act, a commons registration authority (defined in section 4 of the Commons Act 2006 and section 2 of the Commons Registration Act 1965). In practice, the appropriate council and commons registration authority will usually be the same body.

**PART A: Information relating to the applicant and land to which the application relates
(all applicants must complete this Part)**

1. Name of appropriate authority to which the application is addressed: Lincolnshire County Council, Countryside Services, Lancaster House, 36 Orchard Street, Lincoln, LN1 1XX

2. Name and full address (including postcode) of applicant: Charlotte Martinson BSc (Hons), DDM Agriculture, Eastfield, Albert Street, Brigg, North East Lincolnshire, DN20 8HS

3. Status of applicant (tick relevant box or boxes):

I am

(a) the owner of the land(s) described in paragraph 4.

(b) making this application and the statements/declarations it contains on behalf of Herring Farms Limited who is the owner of the land(s) described in paragraph 4 and in my capacity as Land Agent.

4. Insert description of the land(s) to which the application relates (including full address and postcode):

Land surrounding Herring Farms Limited, Highfield Farm, Otby Lane, Walesby, Market Rasen, LN8 3UU

5. Ordnance Survey six-figure grid reference(s) of a point within the area of land(s) to which the application relates (if known):

TF 13675 92905 (Highfield Farms Limited)

6. This deposit comprises the following declaration: Part C.

PART C: Declaration under section 31(6) of the Highways Act 1980

1. Herring Farms Limited is the owner of the land described in paragraph 4 of Part A of this form and shown edged red on the map lodged with Lincolnshire County Council on 13 October 2020.

2. On the 13 day of October 2020 Herring Farms Limited deposited with Lincolnshire County Council, being the appropriate council, a statement accompanied by a map showing Herring Farms Limited property edged in red which stated that:

The ways shown in light blue on that map had been dedicated as footpaths

No other ways had been dedicated as highways over Herring Farms Limited property.

4. No additional ways have been dedicated over the land edged in red on the map referenced in paragraph 1 above since the statement dated 12 October 2020 referred to in paragraph 2 above other than those footpaths marked in the appropriate colour on the map and at the present time Herring Farms Limited has no intention of dedicating any more public rights of way over the property.

PART E: Additional information relevant to the application
(insert any additional information relevant to the application)

PART F: Statement of Truth
(all applicants must complete this Part)

WARNING: If you dishonestly enter information or make a statement that you know is, or might be, untrue or misleading, and intend by doing so to make a gain for yourself or another person, or to cause loss or the risk of loss to another person, you may commit the offence of fraud under section 1 of the Fraud Act 2006, the maximum penalty for which is 10 years' imprisonment or an unlimited fine, or both.

I BELIEVE THAT THE FACTS AND MATTERS CONTAINED IN THIS FORM ARE TRUE

Signature (of the person making the statement of truth):



Print full name: CHARLOTTE MARTINSON

Date: 19TH OCTOBER 2020

You should keep a copy of the completed form

Data Protection Act 1998 - Fair Processing Notice

The purpose of this Fair Processing Notice is to inform you of the use that will be made of your personal data, as required by the Data Protection Act 1998.

The appropriate authority (see explanation of definition in above guidance notes) in England is the data controller in respect of any personal data that you provide when you complete this form.

The information that you provide will be used by the appropriate authority in its duties to process applications to deposit statements, maps and declarations under section 31(6) the Highways Act 1980 and statements under section 15A(1) of the Commons Act 2006. The information you provide will also be used by the appropriate authority in its duty to update the registers in which details of such deposits are recorded under the Dedicated Highways (Registers under Section 31A of the Highways Act 1980) (England) Regulations 2007 and the Commons (Registration of Town or Village Greens) and Dedicated Highways (Landowner Statements and Declarations) (England) Regulations 2013.

The appropriate authority is required by the legislation above to maintain a register which holds information provided in this form, which can be inspected online or in person by members of the public on request. It may also be required to release information, including personal data and commercial information, on request under the Environmental Information Regulations 2004 or the Freedom of Information Act 2000. However, the appropriate authority will not permit any unwarranted breach of confidentiality nor will they act in contravention of their obligations under the Data Protection Act 1998.

Lincolnshire County Council

20 OCT 2020

Lancaster House