

Parish: Blyton
Title: Land at East End Farm
Reference number: CA/7/1/253/3

HIGHWAYS ACT 1980, SECTION 31 (6) – DEPOSITED MAPS, HIGHWAYS STATEMENT AND HIGHWAYS DECLARATIONS

Date of deposit of map and highways statement 05.11.2007
Depositor's name and address R.J. & S.E. Marris, Cockthorn Farm, Scotton, Gainsborough, Lincs, DN21 3RD
Dates of deposit of highways declarations and names and addresses of depositors (1) 01.11.2017: R.J. & S.E. Marris, Cockthorn Farm, Scotton, Gainsborough, Lincs, DN21 3RD
Date deposit expires: 31.10.2037

GEOGRAPHIC LOCATION

Grid Reference: SK859 954
Address and postcode of buildings on the deposited land
District West Lindsey
Nearest city or town Gainsborough

ENQUIRIES ABOUT THE REGISTER OR DEPOSITS

Enquiries concerning the register or the deposits lodged with the County Council should be made to the Definitive Map Officer at Lincolnshire County Council's Countryside Services Section by email to countryside_access@lincolnshire.gov.uk or by telephone on 01522 782070.

INFORMATION ABOUT THE REGISTER OF DEPOSITS

The County Council is required by law to keep and maintain a register of highways statements and highways declarations deposited under section 31 (6) of the Highways Act 1980 and landowner statements deposited under section 15A (1) of the Commons Act 2006. The register is available for public inspection on its website and in a paper copy format, together with copies of the deposited documents. Details, including names, addresses and the location of land relating to an application, which may be considered to be personal information, will therefore be in the public domain. This requirement overrides any entitlement a depositor and landowner may otherwise have under the Data Protection Act 1998 to prevent the publication of such information.

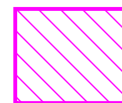
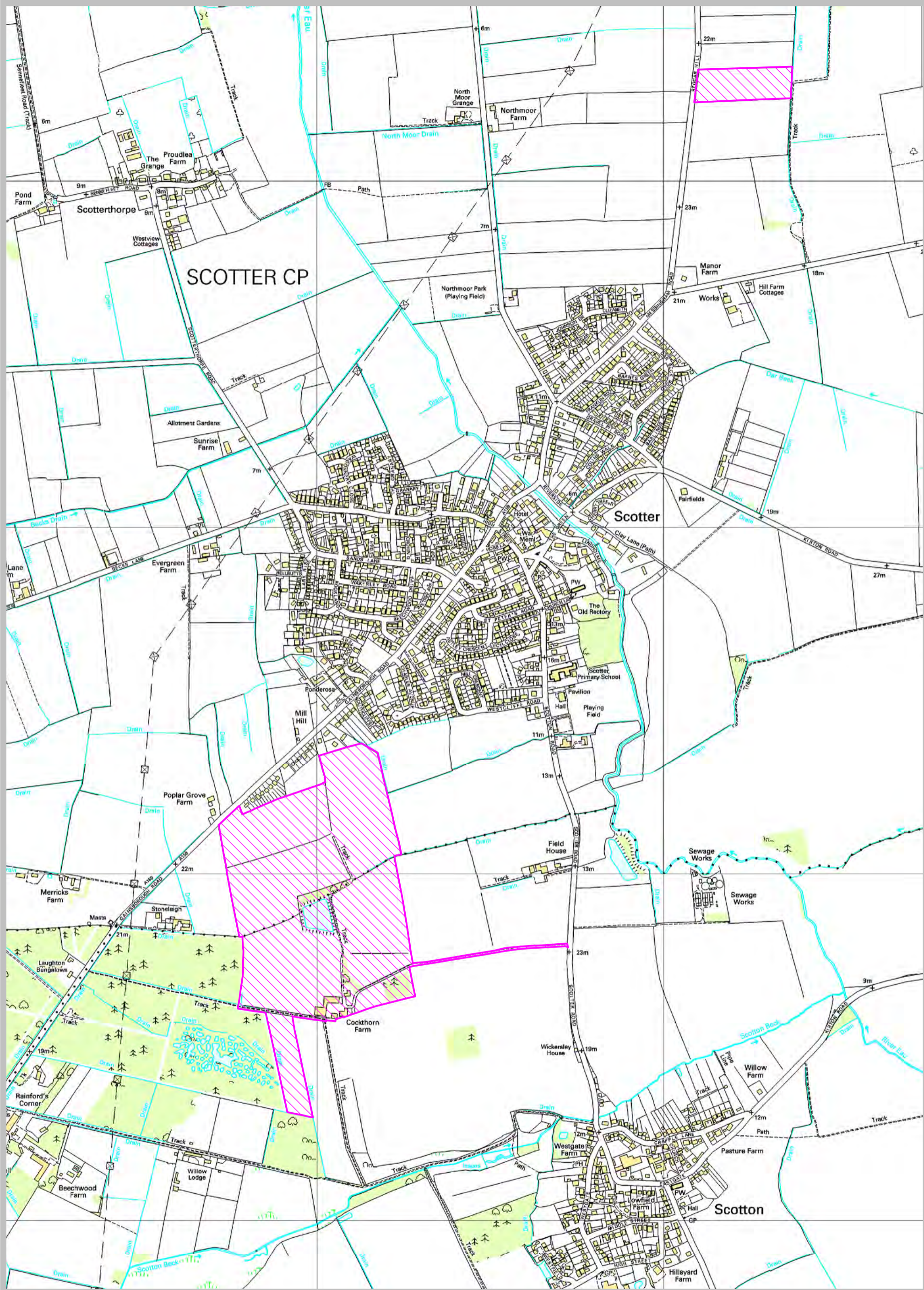

R.J. & S.E Marris
Farmers and Agricultural Contractors

Cockthorn Farm, Scotton, Gainsborough
Lincolnshire DN21 3RD
Tel: 01724 763441 or 07889 277325

V.A.T. Reg no. 129 5650 54

Lincolnshire County Council,
Public Rights of Way and Countryside Access
Development Directorate,
4th Floor City Hall,
Lincoln.
LN1 1DN

1st November 2007

Deposit of Statement and Plan
Section 31 (6) of the Highways Act 1980
(as amended by the Countryside Rights of Way Act 2000)



To Lincolnshire County Council,

1. I am and have been since 17th June 2007 the owner within the meaning of the above section of the land known as South Hills Farm, Becks Lane, Scotter, more particularly delineated on the plan accompanying this statement ("the Plan") and thereon edged red.
2. The aforementioned land lies in the Parish of Scotter.
3. No ways over the land have been dedicated as highways.
4. The deposit shall comprise this statement and accompanying plan

Signed (landowner)
Name (of Landowner)
Address

COCKTHORN FARM
GAINSBOROUGH

Date 1 - 11 - 07

C.R. Pye
39 Brigg Road
Messingham
Scunthorpe
North Lincs
DN17 3QX

25 October 2007

Dear Sir/Madam,

TO WHOM IT MAY CONCERN

With regards to the short stretch of road between Woodhill Road and Laughton Forest, the Freehold has been held by myself since 1992, previously since the 1930's by my predecessors. The remaining stretch which belongs to the Forestry Commission and their permission to use it is needed, but myself and my predecessors had this permission to gain access to the A159.

For the last 10 (ten) years or so a sign at either end of this stretch informing people that it was PRIVATE was displayed, but was largely ignored, so in frustration a locked gate was installed at the Woodhill end.

As far as I was concerned it is a Private Road as the history proves and this was passed on with the sale of the land to Mr & Mrs Marris to gain access to South Hill Farm.

Yours faithfully,



Deposit of Statement and Plan

Section 31(6) of the Highways Act 1980 (as amended by the Countryside Rights of Way Act 2000)

To Lincolnshire County Council

1. I am and have been since 23rd June 1973 the owner within the meaning of the above section of the land known as Cockthorn Farm, Scotton more particularly delineated on the plan accompanying this statement ("the Plan") and thereon edged red.
2. The aforementioned land lies in the Parishes of Scotton and Scotter.
3. No ways over the land have been dedicated as highways.
4. The deposit shall comprise this statement and accompanying plan

Signed (landowner)

Name (of landowner)

Address

COCKT

TTON

GAIN

3HS.

Date

1 - 11 - 01

Deposit of Statement and Plan
Section 31(6) of the Highways Act 1980
(as amended by the Countryside and Rights of Way Act 2000)

To Lincolnshire County Council

1. I am and have been since 1987 the owner within the meaning of the above section of the land known as East End Farm, Blyton, more particularly delineated on the plan accompanying this statement ("the Plan") and thereon edged red.
2. The aforementioned land lies in the Parish of Blyton.
3. No ways over the land have been dedicated as highways.
4. The deposit shall comprise this statement and accompanying plan.

Signed (landowner)
Name (of landowner)
Address

COCKTHORPE
GAINS. BLYTON
BHS

Date 1-11-07

Deposit of Statement and plan
Section 31(6) of the Highways Act 1980
(as amended by the Countryside and Rights of Way Act 2000)

To Lincolnshire County Council,

1. I am and have been since 1993 the owner within the meaning of the above section of the land known as Pasture Farm, Scotton more particularly delineated on the plan accompanying this statement ("the Plan") and thereon edged in red.

2. The aforementioned land lies in the Parish of Scotton.

3. The ways coloured ^{blue}~~yellow~~ on the plan have been dedicated as footpaths.

4. No other ways over the land have been dedicated as highways

5. The deposit shall comprise this statement and accompanying plan.

Signed (landowner)
Name (of landowner)
Address

COCKTON
GAIN
SCOTTON
Lincs
S.H.S.

Date 1 - 11 - 07

Deposit of Statement and Plan

Section 31(6) of the Highways Act 1980

(as amended by the Countryside and Rights of Way Act 2000)

To Lincolnshire County Council

1. I am and have been since 1989 the owner within the meaning of the above section of the land known as Low Farm, Northorpe more particularly delineated on the plan accompanying this statement ("the Plan") and thereon edged red.

2. The aforementioned land lies in the Parish of Northorpe.

3. The ways coloured ^{blue}~~yellow~~ on the plan have been dedicated as footpaths.

4. No other ways over the land have been dedicated as highways

5. The deposit shall comprise this statement and accompanying plan.

Signed (landowner)

Name (of landowner)

Address

COCKTON
GRAVEY FINE & N21 3HS.

Date 1-11-07

LAND PURCHASED OUTLINED IN BLACK.

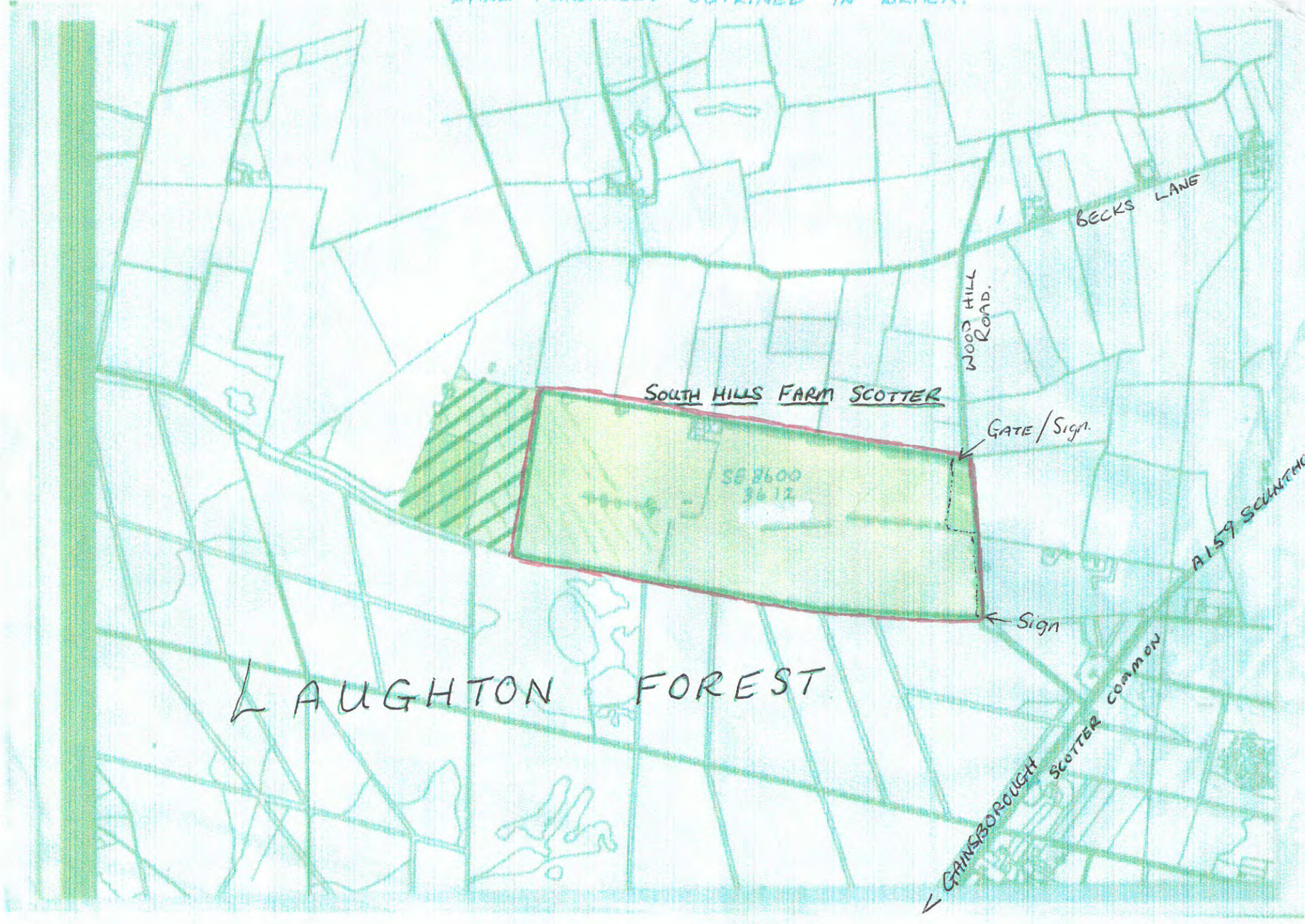

SOUTH HILLS FARM SCOTTER

BECKS LANG

WOOD HILL ROAD.

Gate/Sign.

SS 8600
5612

Sign

LAUGHTON FOREST

GAINSBOROUGH SCOTTER COMMON

A159 SCANTHORPE

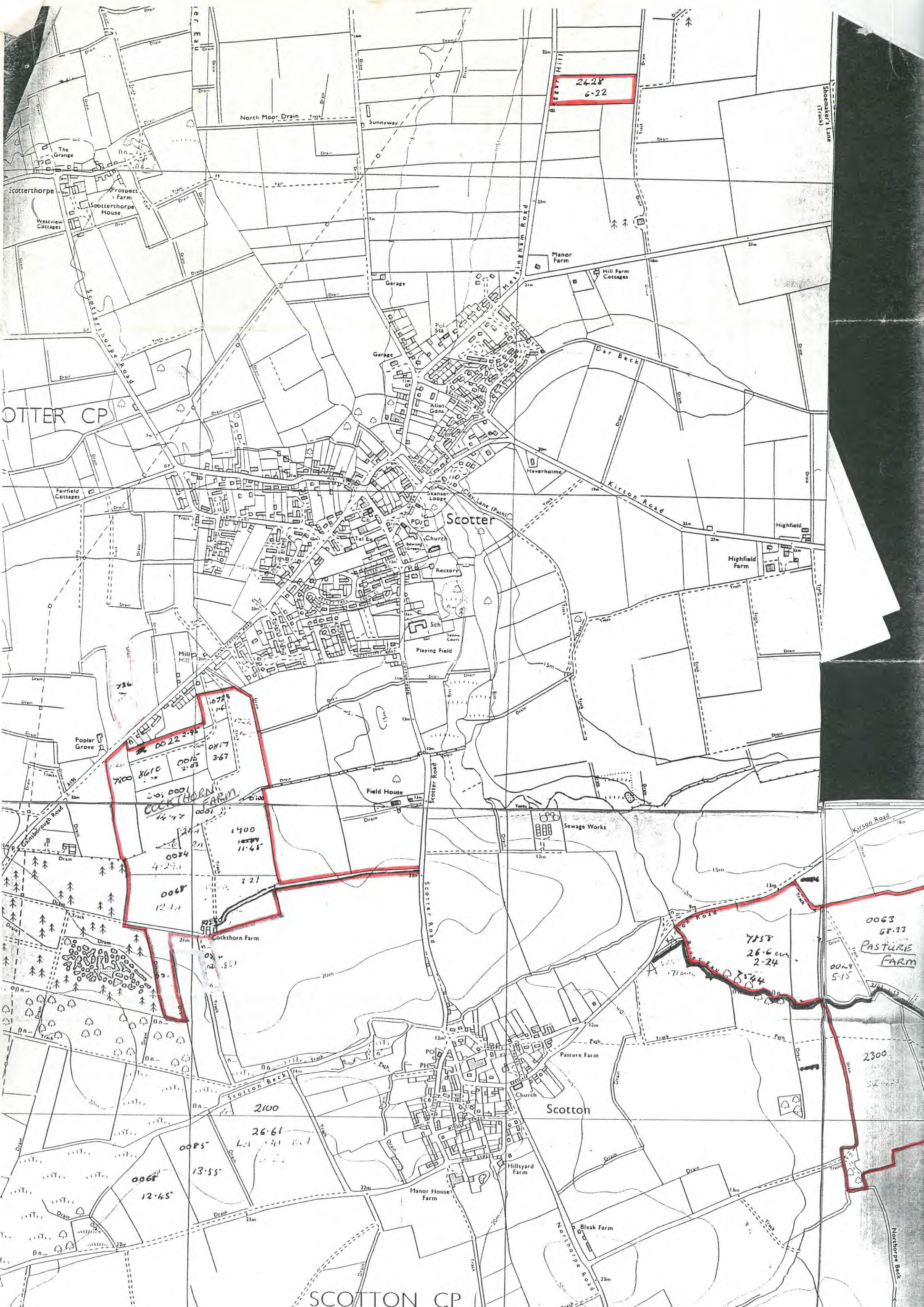

SHEET SK 89 NE

EAST END FARM
BLYTON NORTH ZINGS

LAT 53° 27'

395000m

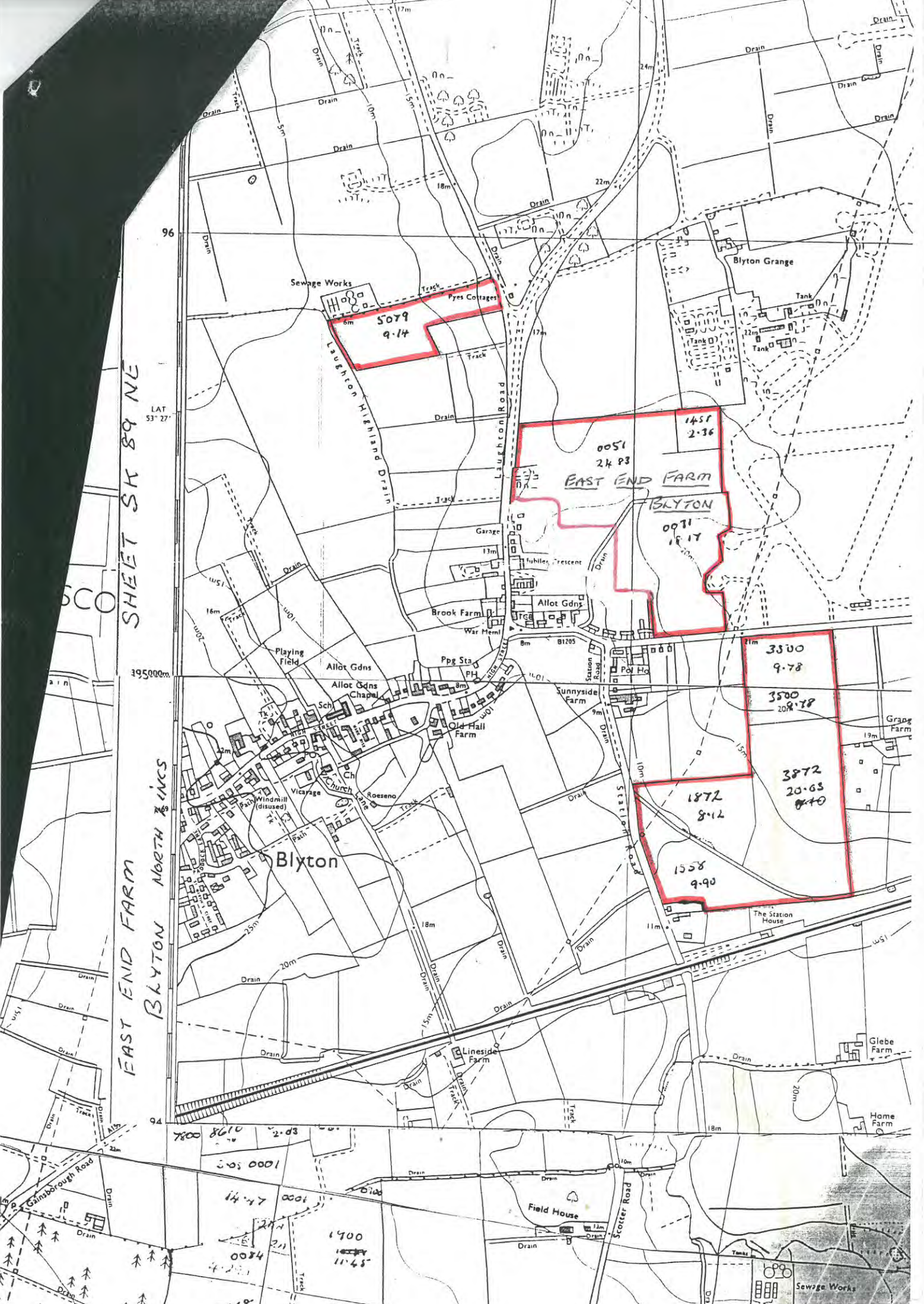

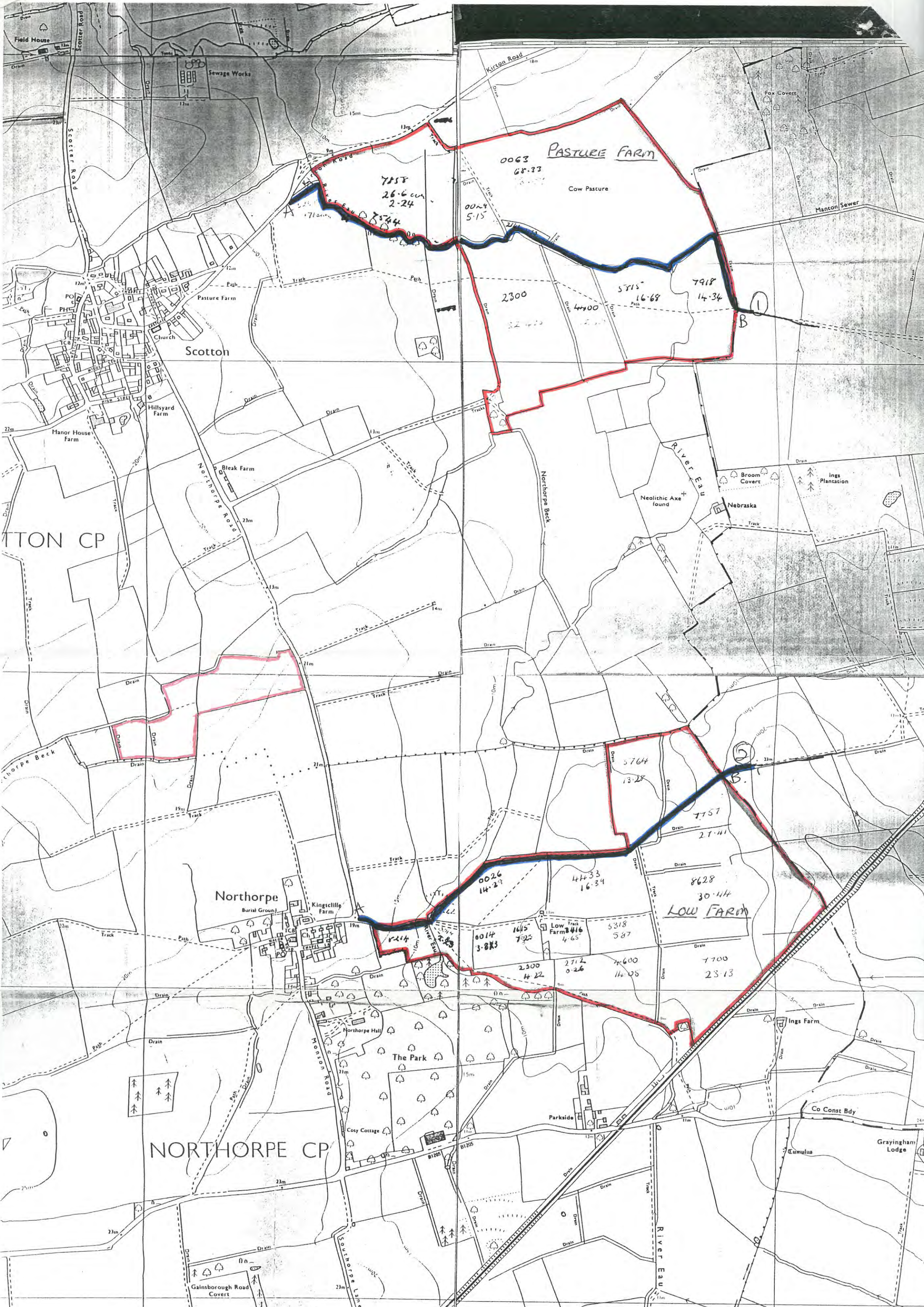

PASTURE FARM

0063
68.33

Cow Pasture

7158
26.6 ac
2-24

0029
5.15

2300

5715
16.68

7918
14.34

4400

Scotton

Scotton CP

Northorpe

NORTHORPE CP

LOW FARM

5764
13.28

7157
21.41

0026
14.29

4433
16.34

8628
30.44

0014
3.83

1645
7.25

Low Farm
4.65

5318
5.87

2300
4.22

2712
9.26

4600
14.05

7700
23.13

Co Const Bdy

Grayingham Lodge

Deposit of Statement and Plan

Section 31(6) of the Highways Act 1980

Part A

- 1) To Lincolnshire County Council
- 2) R.J. and S.E. Marris
Cockthorn Farm,
Scotton,
Gainsborough,
Lincs,
DN21 3HS
- 3) We are the owners of the land described in paragraph 4.
- 4) Cockthorn Farm,
Scotter Road,
Scotton,
Gainsborough,
Lincs.
DN21 3HS

Pasture Farm,
Kirton Road.
Scotton,
Gainsborough,
Lincs.

South Hills Farm,
Wood Hill Road,
Scotter,
Gainsborough,
Lincs.

East End Farm,
Scotter Road,
Blyton,
Gainsborough,
Lincs.

Low Farm,
Northorpe,
Gainsborough,
Lincs.

5) Ordnance Survey Reference Numbers taken from RPA documents.

Cockthorn Farm, Scotton: Sheet ID: SK8799, Parcel ID 9297

Pasture Farm, Scotton: Sheet ID: SK9099, Parcel ID 4253

South Hills Farm, Scotter: Sheet ID: SE8600, Parcel ID: 3612

East End Farm, Blyton: Sheet ID: SK8595, Parcel ID: 9548

Low Farm, Northorpe: Sheet ID: SK9097, Parcel ID: 8433

6) This deposit comprises the following statements lodging a highways declaration.

Part C. Declaration under section 31 (6) of the Highways Act 1980

- 1) R.J. and S.E. Marris are the owners of the land described in paragraph 4 of Part A of this form and shown red on the maps lodged with Lincolnshire County Council on the 5th November 2007.
- 2) On the 1st November 2007, R.J. and S.E. Marris 's predecessor in title R.J. Marris deposited with Lincolnshire County Council, being the appropriate council, a statement accompanied by maps showing our, R.J. and S.E. Marris's, property outlined in red which stated that:
 - The ways shown in yellow on those maps had been dedicated as footpaths.
 - No other ways had been dedicated as highways over R.J. and S.E. Marris's property.
- 4) No additional ways have been dedicated over the land coloured red on the maps referenced in paragraph 1 above since the statement dated 1st November 2007 referred to in paragraph 2 above and at the present time we, R.J. and S.E. Marris have no intention of dedicating any more public rights of way over the property.

Part F: Statement of Truth.

WE BELIEVE THAT THE FACTS AND MATTERS CONTAINED IN THIS FORM ARE TRUE.

Signature:

R. J. Marris

Date:

Signature:

S. E. Marris

Date:

31st October 2017.