

C/10/24/189

WILDLIFE AND COUNTRYSIDE ACT 1981

LINCOLNSHIRE COUNTY COUNCIL

ADDITION TO TETFORD PUBLIC FOOTPATH NUMBER 33

DEFINITIVE MAP MODIFICATION ORDER 2019

This Order is made by Lincolnshire County Council ("the Authority") under Section 53(2)(b) of the Wildlife and Countryside Act 1981 ("the Act") because it appears to the Authority that the Definitive Map and Statement for the area of the Lindsey County Council (Rural District of Horncastle) require modification in consequence of the occurrence of an event specified in Section 53(3)(c)(i) of the Act namely the discovery by the Authority of evidence which (when considered with all other relevant evidence available to them) shows that a right of way which is not shown in the map and statement subsists or is reasonably alleged to subsist over land in the area to which the map relates, being a right of way such that the land over which the right subsists is a public path

The Authority has consulted with every local authority whose area includes the land to which the Order relates

1. For the purposes of this Order the relevant date is 3 May 2019
2. The Lincolnshire County Council Definitive Map and Statement for the area of the Lindsey County Council (Rural District of Horncastle) shall be modified as described in Part I and Part II of the Schedule and

shown on Drawing Number 2019/013/DMMO365/A4 which is attached to the Order

- This Order shall take effect on the date it is confirmed and may be cited as the Lincolnshire County Council, Addition to Tetford Public Footpath Number 33, Definitive Map Modification Order 2019

SCHEDULE

PART I

Modification of Definitive Map

Description of Way to be added

In the parish of Tetford

Public Footpath Number 33

A footpath continuing ~~from~~ ^{AS} Tetford Footpath 33 ~~at~~ ^{from} Point ~~A~~ ^X on Drawing Number 2019/013/DMMO365/A4 (Ordnance Survey Grid Reference TF 3315 ⁴ 7480) ~~to continue~~ ³ in a northerly direction to meet the maintainable highway North Road at point B (TF 3314 7484). The length of this path is approximately ~~46~~ ¹⁵ metres. The width of ~~the whole of this path varies between~~ ^{this section of the path and its continuation southwards (between points A-X) is 1.5 metres.} 5 and 9.7 metres as shown on the Ordnance Survey 1906 25 inch map

PART II

Modification of Definitive Statement

Variation of Particulars of Path or Way

The following details shall be added:-

In the parish of Tetford

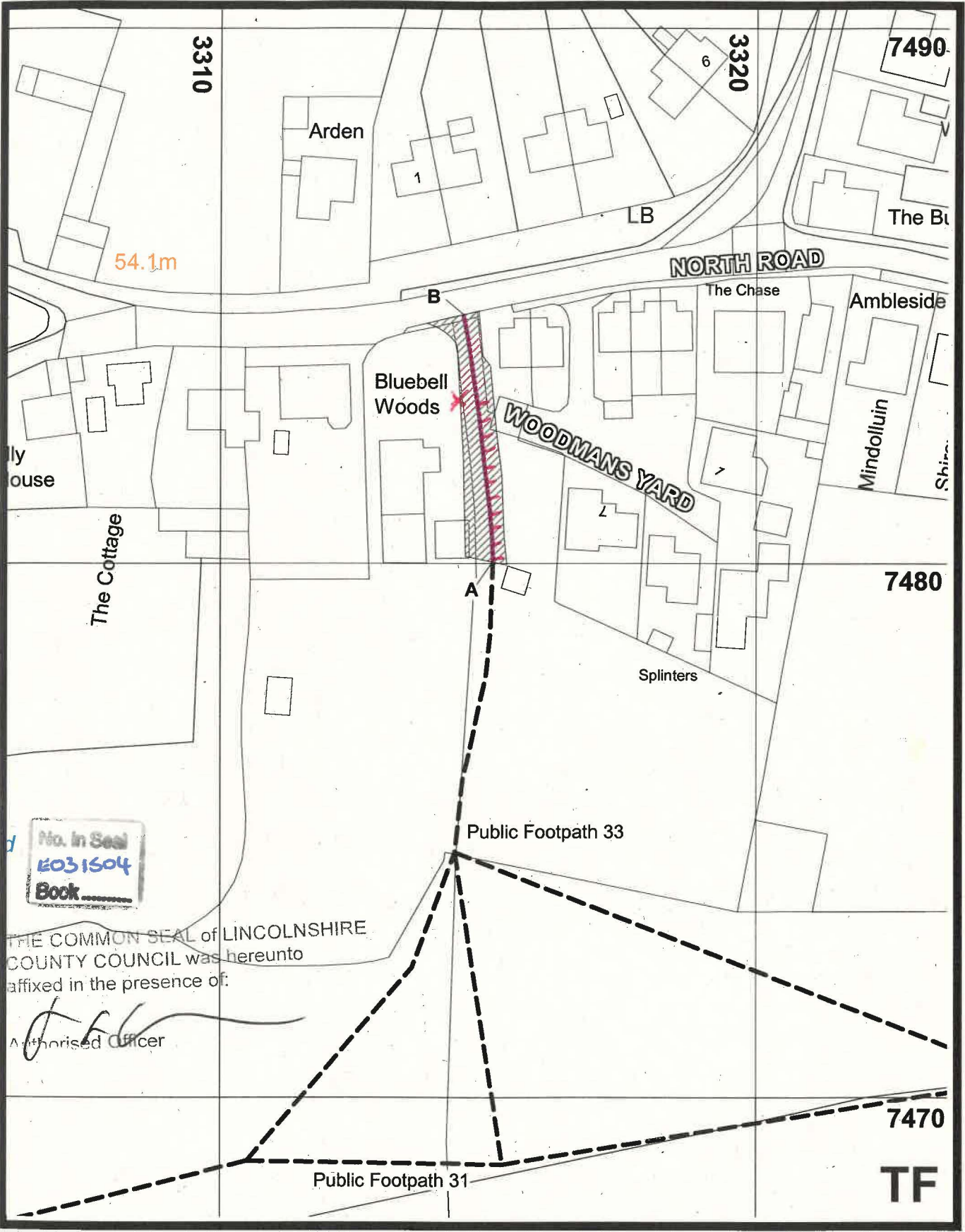

Public Footpath Number 33



THE COMMON SEAL of LINCOLNSHIRE COUNTY COUNCIL was hereunto affixed in the presence of:

[Signature]
Authorised Officer

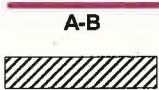
Key:

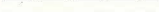
- Addition to FP 33 
- Width of footpath as per Ordnance Survey 25' map 
- Affected Public Footpath 

Lincolnshire
COUNTY COUNCIL
Working for a better future

Drn. LP Date 25/04/2019

TETFORD
(Definitive Map Modification Order)
Addition to FP 33 to North Road

Reproduced from Ordnance Survey with the permission of the Controller of HMSO © Crown Copyright. Licence number 100025370

Countryside Services
County Offices, Newland, Lincoln, LN1 1YL.

Scale: 1 : 1,000

Drawing No: 2019/013/DMMO365/A4

A footpath continuing ~~from~~^{as} Tetford Footpath 33 ~~at~~^{from} Ordnance Survey Grid Reference TF 3315 7480^{4 3} to continue in a northerly direction to meet the maintainable highway North Road at TF 3314 7484. The length of this path is approximately ~~46~~¹⁵ metres. The width of ~~the whole of this path varies between~~^{this section of the path and its continuation southwards (between Grid References TF 3315 7480 and TF 3314 7483)} ~~5 and 9.7 metres as shown on the Ordnance Survey 1906 25 inch map~~ is 1.5 metres.

Given under the Common Seal of Lincolnshire County Council this 3rd day
of May Two thousand and nineteen

THE COMMON SEAL of)
LINCOLNSHIRE COUNTY COUNCIL)
was hereunto affixed in the)
presence of :-)

Authorised Officer

LEIGH MIDDLETON

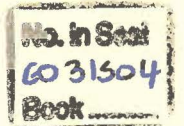

The foregoing order is hereby confirmed
subject to the red ink modifications thereon

Mark Yates 8 JUN 2022

An Inspector appointed by The Secretary of
State for Environment, Food and
Rural Affairs

DATED 3 MAY 2019

WILDLIFE AND COUNTRYSIDE ACT 1981
LINCOLNSHIRE COUNTY COUNCIL
ADDITION TO TETFORD PUBLIC FOOTPATH NUMBER 33
DEFINITIVE MAP MODIFICATION ORDER 2019

Legal Services Lincolnshire

County Offices

Newland

Lincoln