

Parish: Wilsford
Title: Land at Duke's Covert Nature Reserve
Reference number: CA/7/1/124

**DEPOSIT OF MAP AND STATEMENT UNDER SECTION 31(6) OF THE HIGHWAYS
ACT 1980**

Details about the Deposit

Landowner's name: Lincolnshire Wildlife Trust
Landowner's address: Banovallum House, Manor House Street, Horncastle, Lincs LN9 5HF
Date of deposit of the map and statement: 14 December 2001
Date on which the map and statement expires: 13 December 2011

Geographic Location

Grid Reference: SK 979 423

Address(es) and postcode of any buildings on the land:

Postcodes covering the area land: NG32 3

Principal city or town nearest to land: Sleaford

Parish: Wilsford

Electoral Division: Sleaford Rural South

District: North Kesteven

**DEPOSIT OF A STATUTORY DECLARATION UNDER SECTION 31(6) OF THE
HIGHWAYS ACT 1980**

Landowner's name: Lincolnshire Wildlife Trust
Landowner's address: Banovallum House, Manor House Street, Horncastle, Lincs LN9 5HF
Date on which the Statutory Declaration expires: 18 December 2016

COUNTY COUNCIL'S CONTACT DETAILS

Section: Public Rights of Way and Countryside Access Section

Department: Development Directorate

Address: Lincolnshire County Council, 4th Floor, City Hall, LINCOLN LN1 1DN

Telephone: 01522 782070

E-mail: countryside_access@lincolnshire.gov.uk

ELECTRONIC REGISTER

Government legislation requires that details of maps and statements and Statutory Declarations deposited with Lincolnshire County Council under Section 31(6) of the Highways Act 1980 be made available for viewing by the public on the authority's website. This Register will be updated with any new deposits lodged with the County Council. The Register is also available to be viewed in hard copy format together with the actual documents at City Hall. If you have any queries about this register or the details contained in it, please telephone 01522 782070.

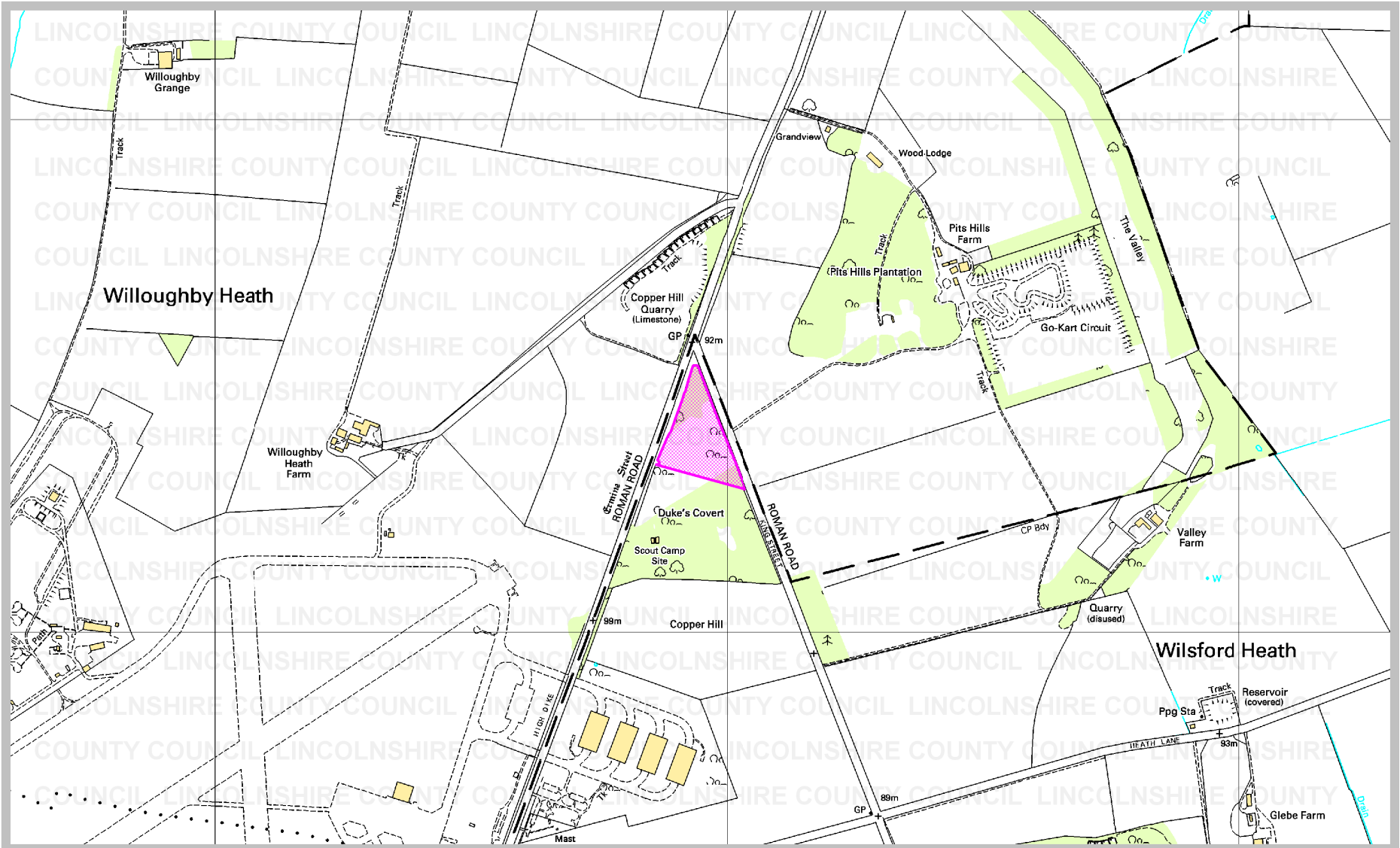

Rights of Way & Countryside Access
 Director of Development: RA Wills
 City Hall, Orchard Street,
 Lincoln LN1 1DN

**Title: Land at Duke's Covert
 Nature Reserve**
 Ref: CA/7/1/124
 Grid Ref: SK 979 423
 Scale: approx 1:10,000

Key:
 Land covered by a deposit made
 under Section 31(6) of the
 Highways Act 1980



This map is for information only and should not be regarded as the Definitive Map of Rights of Way. Reproduced from Ordnance Survey with the permission of the Controller of HMSO © Crown Copyright. Licence number 100025370.