

STATEMENT AND MAP PURSUANT TO SECTION 31(6) OF THE HIGHWAYS ACT 1980

1. I am a director of Mark Caudwell Limited which company is wholly owned by the trustees of the M Caudwell 1997 Settlement of which I am also a trustee. Mark Caudwell Limited and myself in my personal capacity are the owners of the freehold property at Croft Skegness shown edged red on the map ("the Map") attached to this statement ("the Property").

2. The Property has been owned by Mark Caudwell Limited and myself since approximately ~~1989~~ 1992

3. The Property is situated in the local authority district of East Lindsey in the county of Lincolnshire.

4. There are no ways over the Property which have been dedicated as highway.

5. My deposit comprises this statement and the Map.

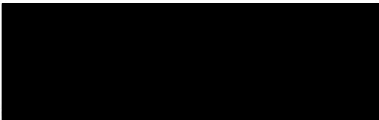
Signed... 

Mark Leopold Caudwell

Date 20/9/2013

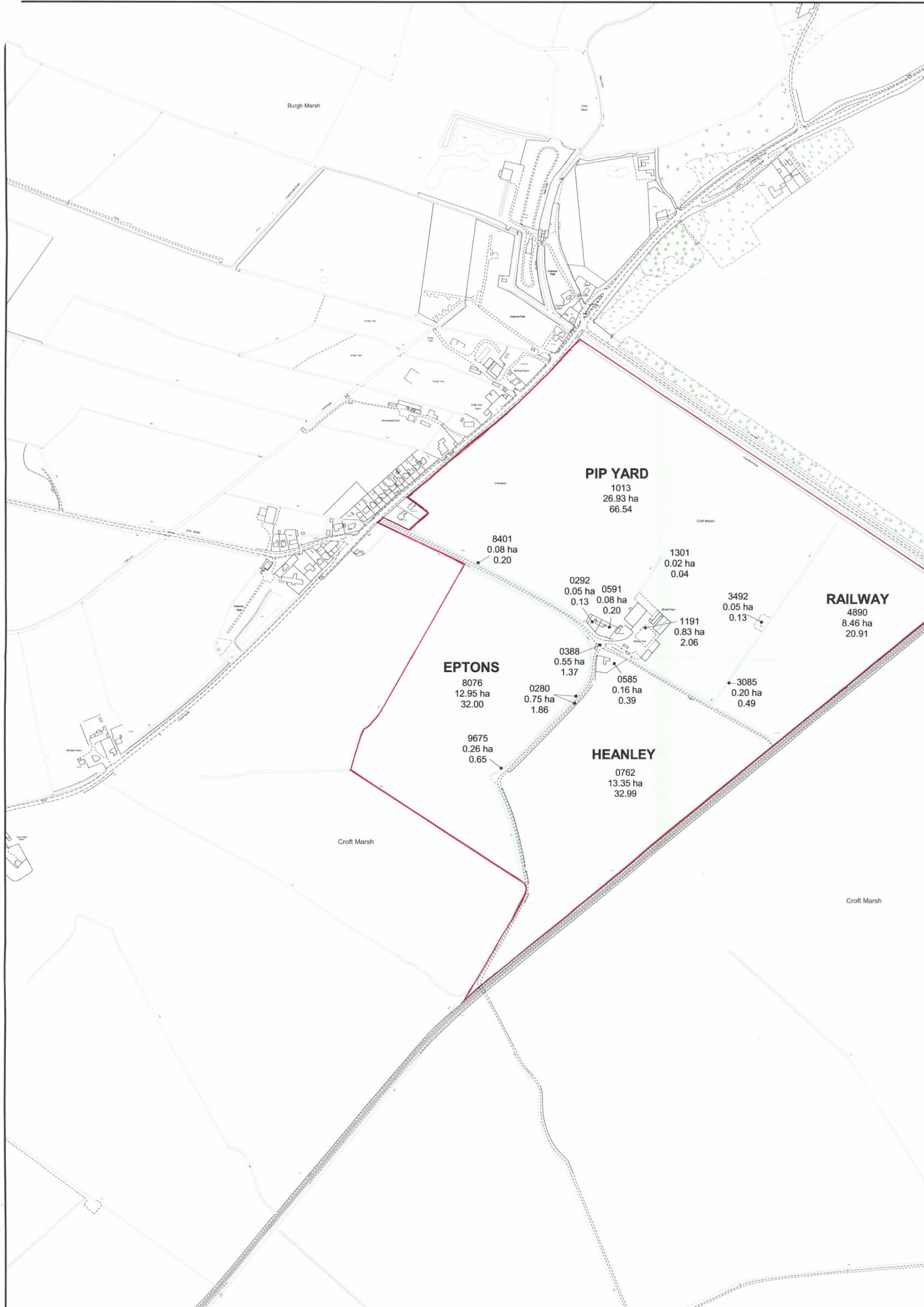

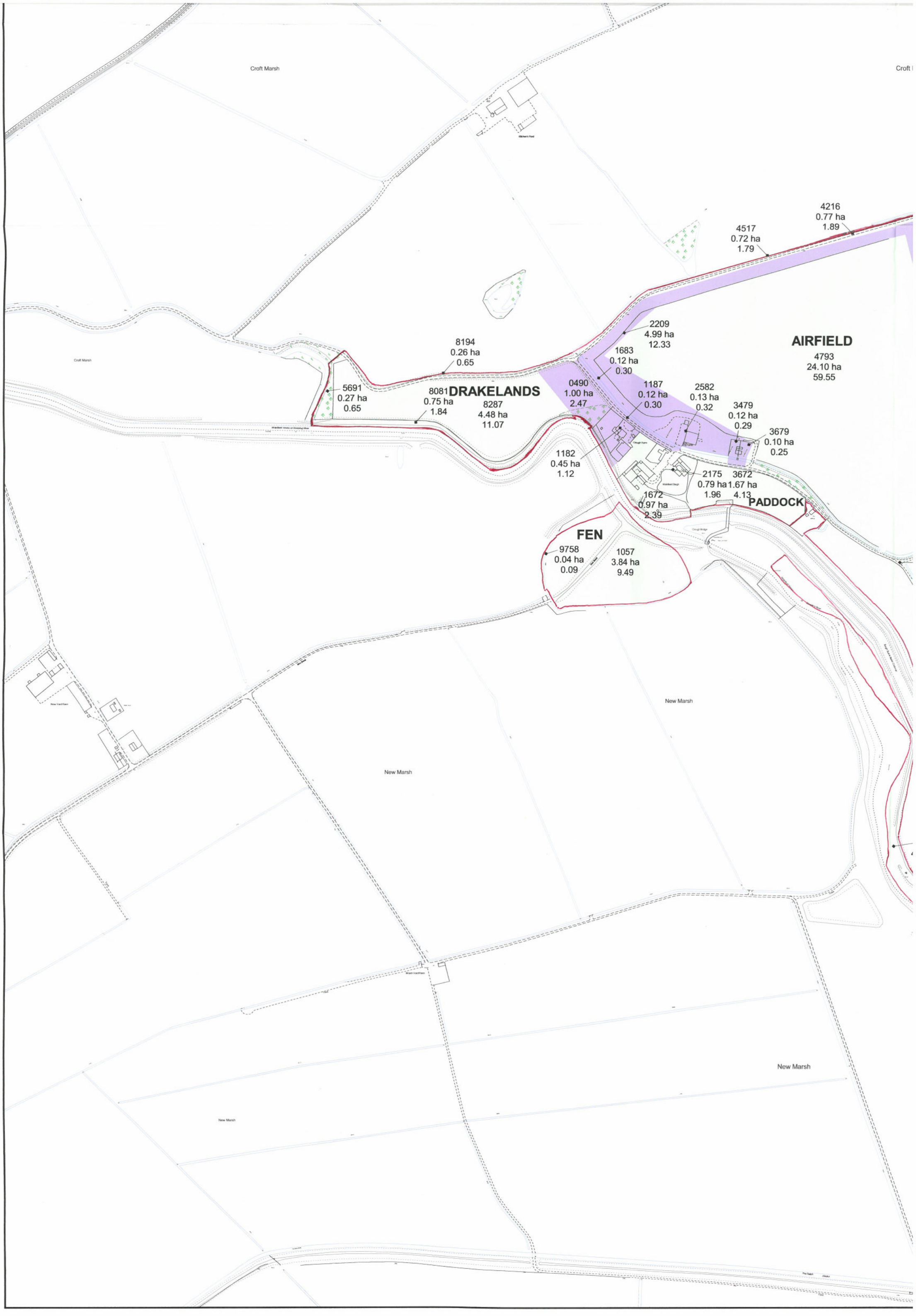

Howlett House Farm

This plan is published for the convenience of the purchaser only. Its accuracy is not guaranteed and it is expressly excluded from any contract.



Based on Ordnance Survey 1:2,500 mapping with the permission of the Controller of HMSO
©Crown Copyright
Licence No. VA 100033416

Drawing No. M5166-07 Date 24.05.13





Scale
1:6,000 @ A1



**THE
MAPPING
COMPANY**

Little Cutsey, Cutsey, Taunton, Somerset. TA3 7NY
Tel: 01823 421354 Email: patrick@mapping-company.co.uk

Ownership Key

-  Mark Cauldwell Ltd
-  Mark Leopold Cauldwell
-  Pension Fund Trustees
-  Trustees Mark Cauldwell Settlement

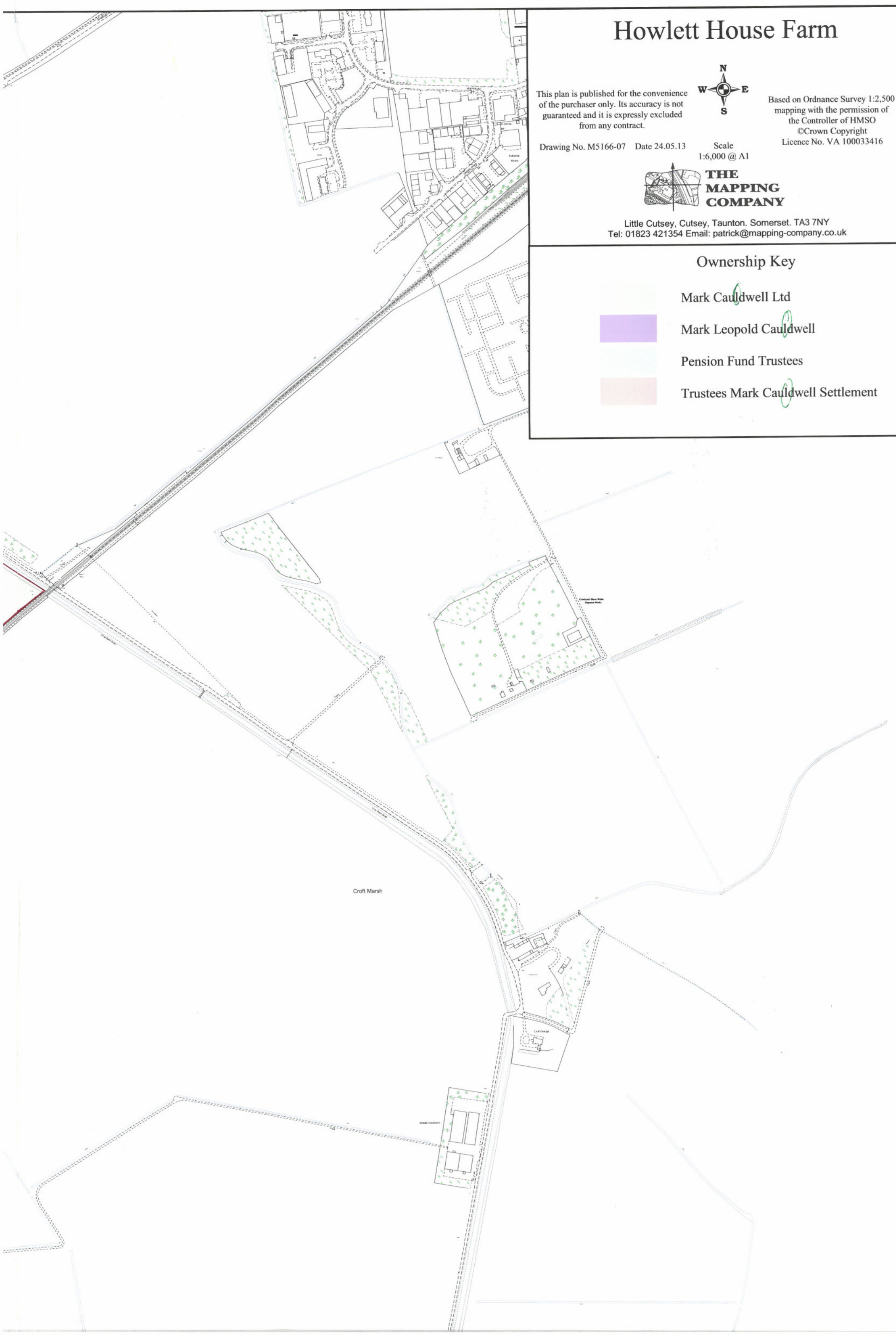

Croft Marsh

Croft Marsh

PILL BOX

0608
39.85 ha
98.47

0101
0.16 ha
0.39

8475
0.62 ha
1.52

GRANTS

0252
23.19 ha
57.31

6658
0.74 ha
1.84

9133
0.27 ha
0.66

9129
0.05 ha
0.13

MINEFIELD

9312
21.88 ha
54.06

6697
4.15 ha
10.26

2265
0.09 ha
0.22

Bramble Hills

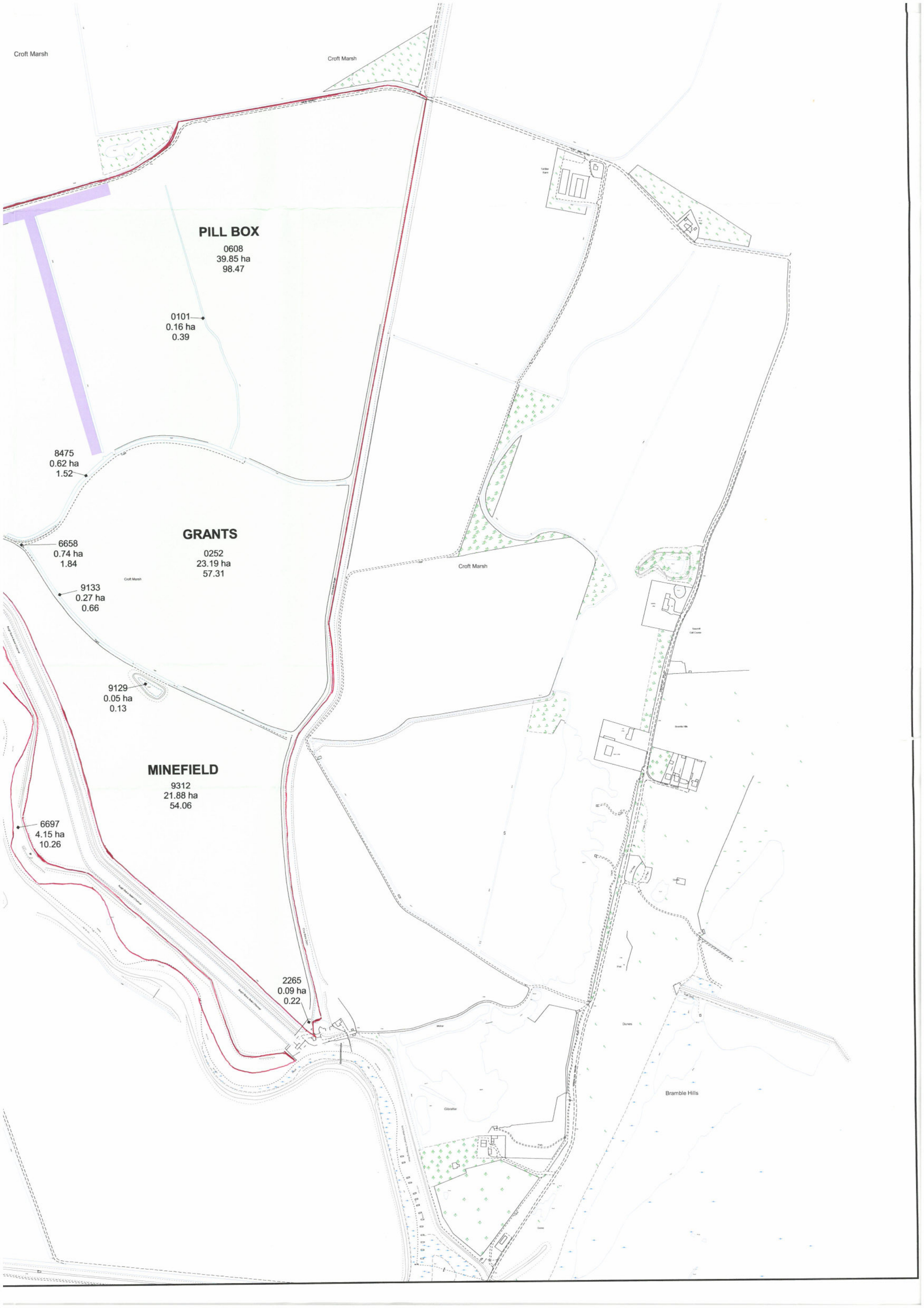

I, Mark Leopold Caudwell, of Howlett House, Slackholme End, Hogsthorpe, Skegness, Lincolnshire PE24 5NS do solemnly and sincerely declare that:

1. I am a director of Mark Caudwell Limited which company is wholly owned by the trustees of the M Caudwell 1997 Settlement of which I am also a trustee. Mark Caudwell Limited and myself in my personal capacity are the owners of the freehold property at Croft Skegness (Property) shown edged red on the Map referred to in paragraph 3 of this declaration.
2. The Property has been owned by Mark Caudwell Limited and myself since 1992.
3. On the 24th September 2013 I deposited with Lincolnshire County Council a statement (Statement) and map (Map) pursuant to section 31(6) of the Highways Act 1980 in respect of the Property.
4. The Statement stated that there are no ways over the Property which have been dedicated as highway.
5. Since 24 September 2013, which is the date the Statement was deposited with Lincolnshire County Council, there has been no dedication of any highway over the Property.
6. I have no current intention to dedicate any highway over the Property.

I make this solemn declaration conscientiously believing the same to be true and by virtue of the Statutory Declarations Act 1835.

Declared at 'Aunties House' 45 Algonquin
Road, Skegness, Lincolnshire
on 25th September 2013

before me

Signed.....  FCTLEX.....

A commissioner for oaths or a solicitor empowered to administer oaths.