

Parish: Harpswell, Hemswell
Title: Land at Church Farm, Harpswell & land at Hemswell
Reference number: CA/7/1/402

**DEPOSIT OF MAP AND STATEMENT AND STATUTORY DECLARATION(S) UNDER
HIGHWAYS ACT 1980, SECTION 31(6) AND COMMONS ACT 2006, SECTION 15A(1)**

Geographic Location

Grid Reference: SK 940893, SK 918906
Address and postcode of buildings on the deposited land Church Farm, Church Lane, Harpswell, Gainsborough, DN21 5UY
District West Lindsey
Nearest city or town Gainsborough

Highways Act 1980, Section 31(6) deposits

Date of deposit of map and statement 23.06.2014
Depositor's name and address Mr G Kealey, Church Farm, Middle Street, Harpswell, Gainsborough, DN21 5UY
Date of deposit of declaration, name and address of depositor (1) 16.07.2014: Mr G Kealey, Church Farm, Middle Street, Harpswell, Gainsborough, DN21 5UY
Date deposit expires: 15.07.2034

Commons Act 2006, Section 15A(1)

Date of deposit of map and statement, name and address of depositor (1) 23.06.2014: Mr G Kealey, Church Farm, Middle Street, Harpswell, Gainsborough, DN21 5UY
[combined deposit]

COUNTY COUNCIL'S CONTACT DETAILS

Officer and Section: Definitive Map Officer, Public Rights of Way and Countryside Access
Address: Lincolnshire County Council, Communities, 4th Floor, City Hall, Lincoln, LN1 1DN
Telephone: 01522 782070
Email: countryside_access@lincolnshire.gov.uk

REGISTER OF DEPOSITS

The County Council is required by law to keep a register of maps and statements and declarations deposited under Section 31(6) of the Highways Act 1980 and Section 15A(1) of the Commons Act 2006 available for public inspection on its website and in a paper copy format together with the deposited

documents. Details including names, addresses and the location of land relating to a deposit which may be considered to be personal information are therefore in the public domain. This requirement overrides any entitlement a depositor may otherwise have under the Data Protection Act 1998 to prevent publication of such information. The paper copy of the register together with the deposited documents can be viewed by appointment during normal office hours (9:00am to 4:30pm, Monday to Friday) at the County Council's Public Rights of Way and Countryside Section at the above address.

PART A: Information relating to the applicant and land to which the application relates
(all applicants must complete this Part)

1. Name of appropriate authority to which the application is addressed:

LINCOLNSHIRE COUNTY COUNCIL

2. Name and full address (including postcode) of applicant:

GEOFFREY BERNARD KEALEY of Church Farm, Middle Street, Harpswell, Gainsborough,
Lincolnshire, DN21 5UY

3. Status of applicant (tick relevant box or boxes):

I am

- (a) the owner of the land(s) described in paragraph 4.
(b) making this application and the statements/declarations it contains on behalf of
Pauline Mary Kealey and Harpswell Farms Limited (Company Registration Number 01302902)
who are two of the three joint owners of the land(s) described in paragraph 4 and in my capacity
as the third joint legal owner of the said land and also as a Director of Harpswell Farms Limited.

4. Insert description of the land(s) to which the application relates (including full address and
postcode):

Land situate at Church Farm, Middle Street, Harpswell, Gainsborough, Lincolnshire, DN21 5UY
shown edged red on the attached maps labelled Map 1 and Map 2 and Two parcels of land lying to
the north of the A631 shown edged red on the attached map labelled Map 3

5. Ordnance Survey six-figure grid reference(s) of a point within the area of land(s) to which the
application relates (if known):

6. This deposit comprises the following statement(s) and/or declarations (*delete Parts B, C, or D
where not applicable*):

PART B: Statement under section 31(6) of the Highways Act 1980

I am/We Geoffrey Bernard Kealey, Pauline Mary Kealey and Harpswell Farms Limited is are the joint owners of the land described in paragraph 4 of Part A of this form and shown edged red on the three maps labelled Map 1, Map 2 and Map 3 accompanying this statement.

(delete wording in square brackets as appropriate and/or insert information as required)

~~[Ways shown *[insert colouring]* on the accompanying map are byways open to all traffic.]~~

~~[Ways shown *[insert colouring]* on the accompanying map are restricted byways.]~~

~~[Ways shown *[insert colouring]* on the accompanying map are public bridleways.]~~

~~[Ways shown *[insert colouring]* on the accompanying map are public footpaths.]~~

No ways over the land shown edged red on the accompanying maps labelled Map 1, Map 2 and Map 3 have been dedicated as highways.

(delete wording in square brackets as appropriate and/or insert information as required)

PART D: Statement under section 15A(1) of the Commons Act 2006

I/~~am~~/We Geoffrey Bernard Kealey, Pauline Mary Kealey and Harpswell Farms Limited ~~is~~ are the joint owners of the land described in paragraph 4 of Part A of this form and shown edged red on the three maps labelled Map 1, Map 2 and Map 3 accompanying this statement.

I/~~am~~/We Geoffrey Bernard Kealey, Pauline Mary Kealey and Harpswell Farms Limited wish/~~wishes~~ to bring to an end any period during which persons may have indulged as of right in lawful sports and pastimes on the whole or any part of the land shown edged red on the three accompanying maps referred to above.
(delete wording in square brackets as appropriate and/or insert information as required)

PART E: Additional information relevant to the application
(insert any additional information relevant to the application)

PART F: Statement of Truth
(all applicants must complete this Part)

WARNING: If you dishonestly enter information or make a statement that you know is, or might be, untrue or misleading, and intend by doing so to make a gain for yourself or another person, or to cause loss or the risk of loss to another person, you may commit the offence of fraud under section 1 of the Fraud Act 2006, the maximum penalty for which is 10 years' imprisonment or an unlimited fine, or both.

I BELIEVE THAT THE FACTS AND MATTERS CONTAINED IN THIS FORM ARE TRUE.

Signature (of the person making the statement of truth)

Print full name: GEOFFREY BERNARD KEALEY

Date: 19/6/2014

You should keep a copy of the completed form

Data Protection Act 1998 - Fair Processing Notice

The purpose of this Fair Processing Notice is to inform you of the use that will be made of your personal data, as required by the Data Protection Act 1998.

The appropriate authority (see explanation of definition in above guidance notes) in England is the data controller in respect of any personal data that you provide when you complete this form.

The information that you provide will be used by the appropriate authority in its duties to process applications to deposit statements, maps and declarations under section 31(6) the Highways Act 1980 and statements under section 15A(1) of the Commons Act 2006. The information you provide will also be used by the appropriate authority in its duty to update the registers in which details of such deposits are recorded under the Dedicated Highways (Registers under Section 31A of the Highways Act 1980) (England) Regulations 2007 and the Commons (Registration of Town or Village Greens) and Dedicated Highways (Landowner Statements and Declarations) (England) Regulations 2013.

The appropriate authority is required by the legislation above to maintain a register which holds information provided in this form, which can be inspected online or in person by members of the public on request. It may also be required to release information, including personal data and commercial information, on request under the Environmental Information Regulations 2004 or the Freedom of Information Act 2000. However, the appropriate authority will not permit any unwarranted breach of confidentiality nor will they act in contravention of their obligations under the Data Protection Act 1998.

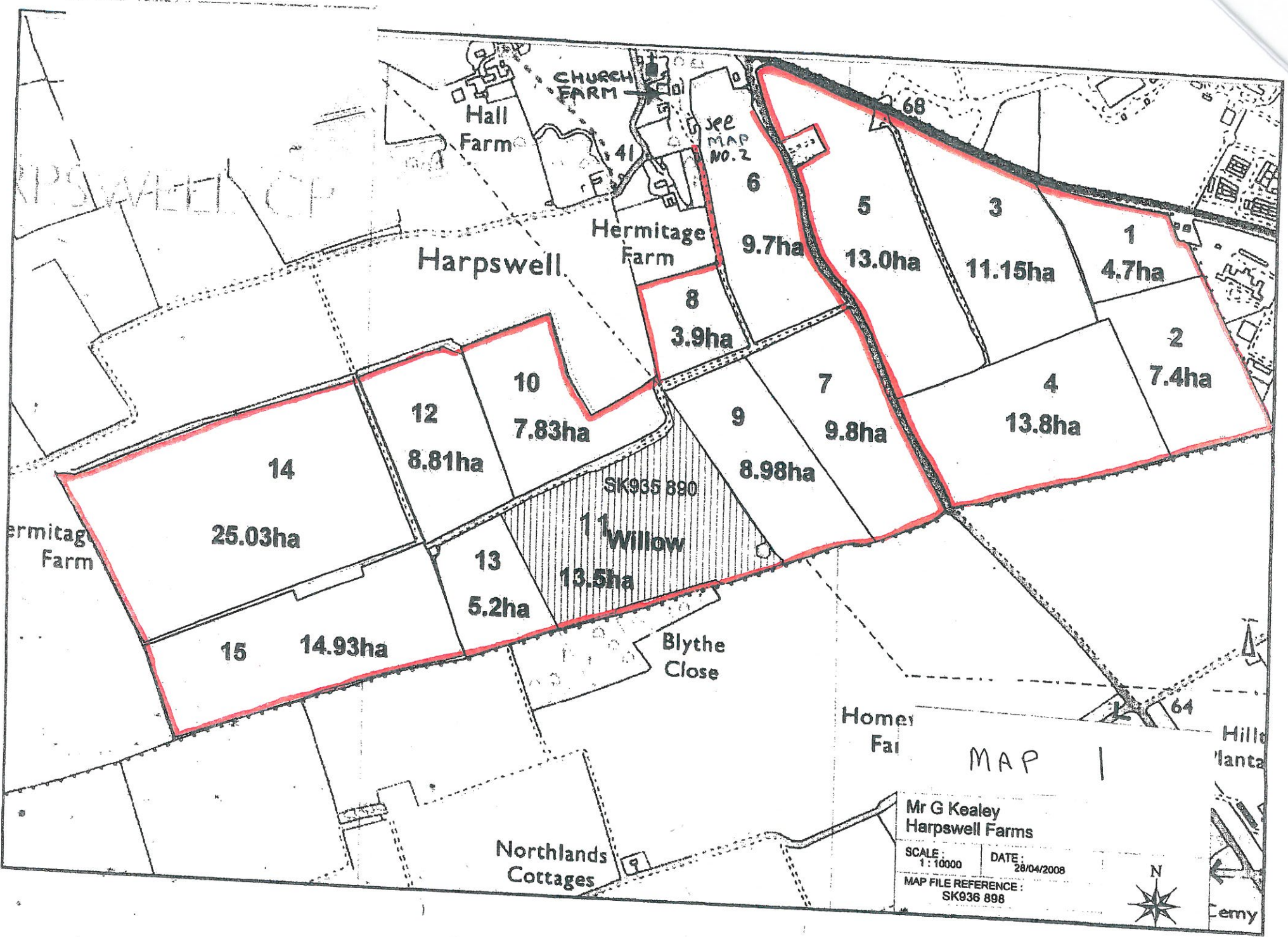

HARPSWELL OP

CHURCH FARM

Hall Farm

See MAP NO. 2

Hermitage Farm

Harpswell

Willow

Blythe Close

Northlands Cottages

Homes Farm

Hillside Farm

Cemetery



The boundaries shown by dotted lines have been plotted from the plans on the deeds. The title plan may be updated from later survey information

MAP 2

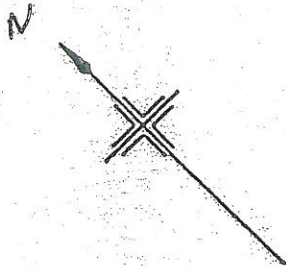

1:2500

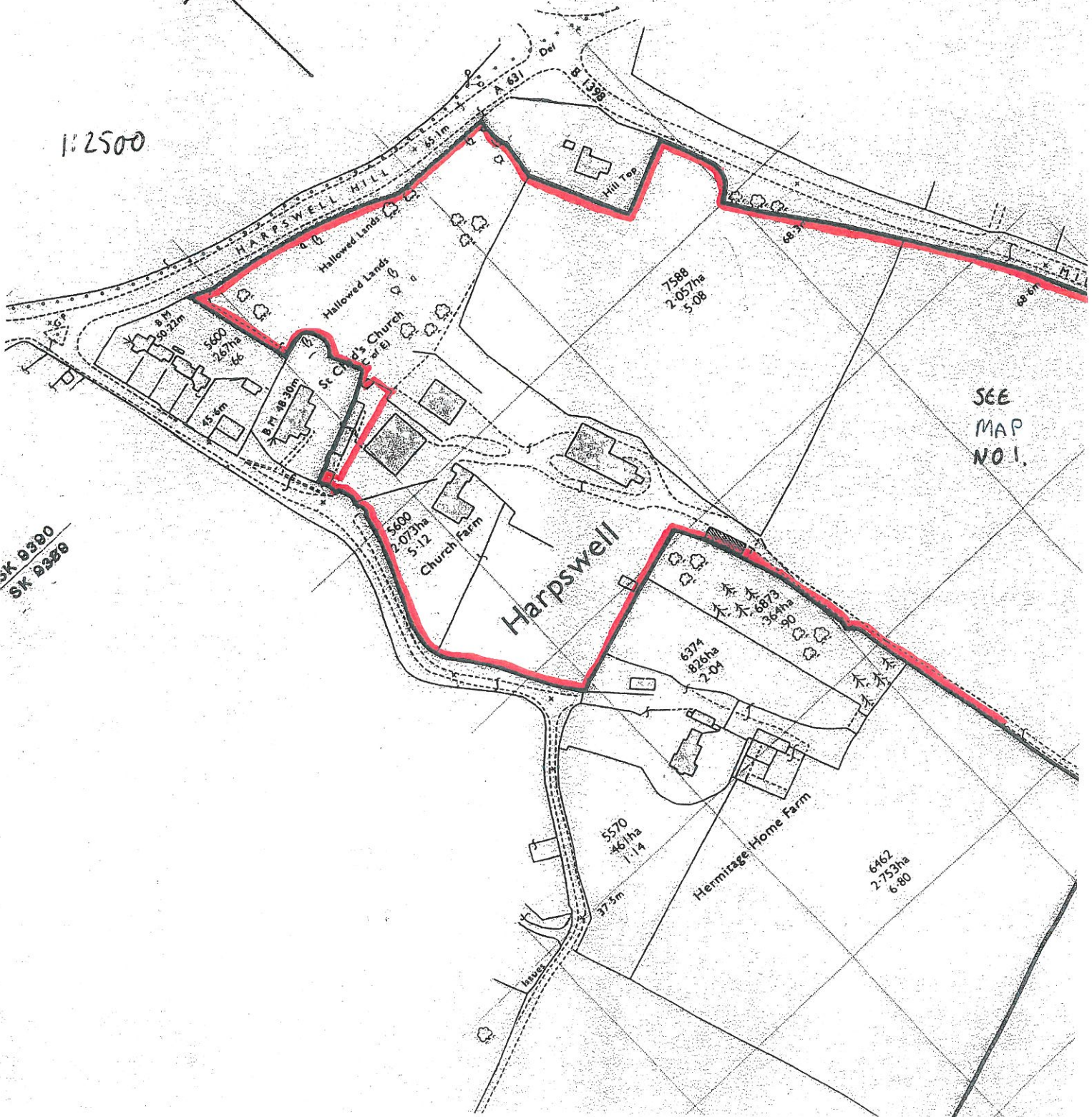

SEE MAP NO. 1.

SK 0390
SK 0388

↑
N

PARISH OF HEMSWELL,

MAP 3

1:5000

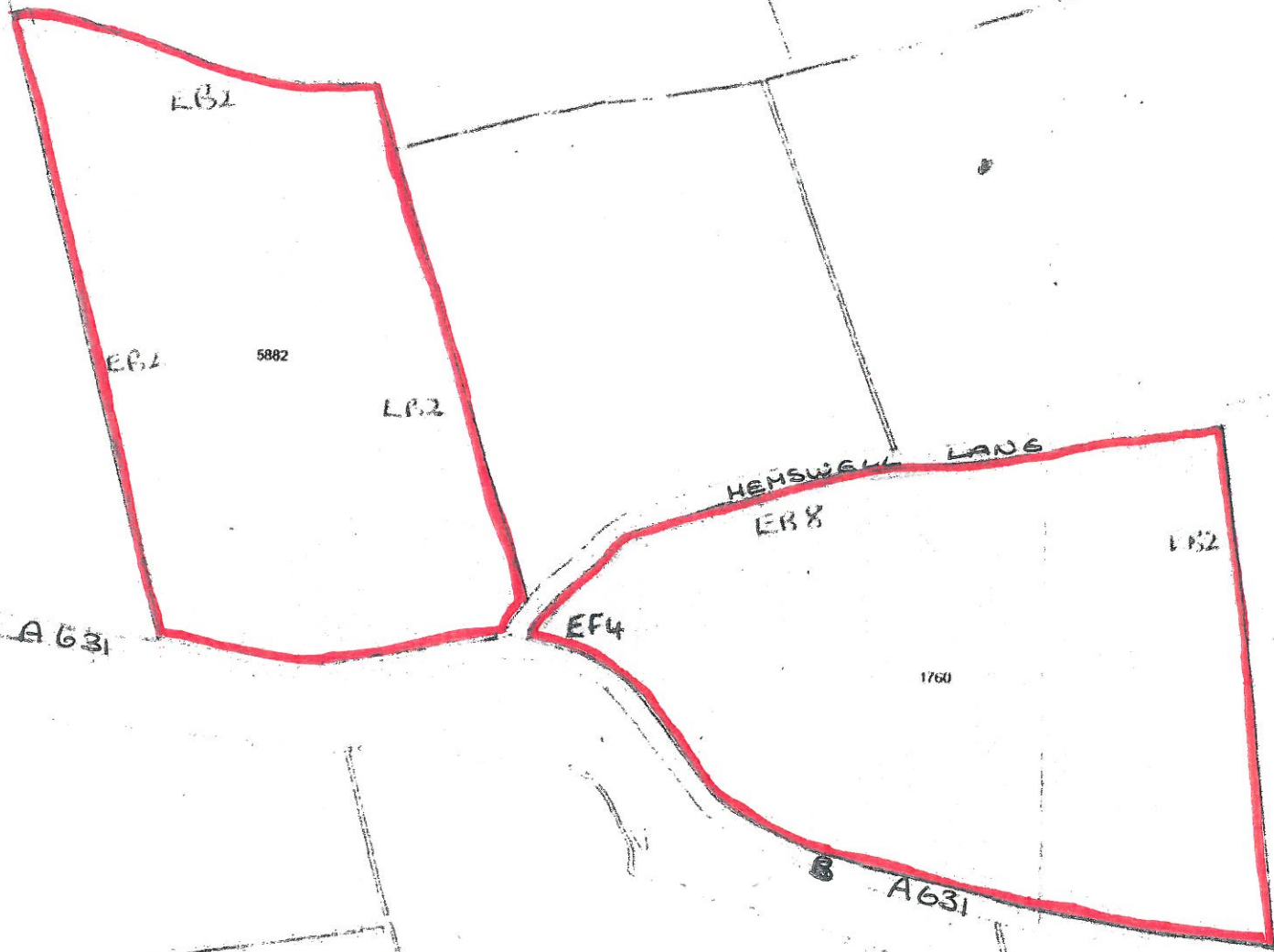

HEMSWELL VILLAGE

- EB -
- EB -
- EB -
- EB -
- EC
- EC
- ED [
- EE
- EF [
- EG [
- EJ [
- EK [
- EL [

You m
in blac

0
L

This map h
This map is
of the Centr

HARPSWOLL
GRANGE

PART A: Information relating to the applicant and land to which the application relates
(all applicants must complete this Part)

1. Name of appropriate authority to which the application is addressed:

LINCOLNSHIRE COUNTY COUNCIL

2. Name and full address (including postcode) of applicant:

GEOFFREY BERNARD KEALEY of Church Farm, Middle Street, Harpswell, Gainsborough,
Lincolnshire, DN21 5UY

3. Status of applicant (tick relevant box or boxes):

I am

- (a) the owner of the land(s) described in paragraph 4.
(b) making this application and the statements/declarations it contains on behalf of
Pauline Mary Kealey and Harpswell Farms Limited (Company Registration Number 01302902)
who are two of the three joint owners of the land(s) described in paragraph 4 and in my capacity
as the third joint legal owner of the said land and also as a Director of Harpswell Farms Limited.

4. Insert description of the land(s) to which the application relates (including full address and
postcode):

Land situate at Church Farm, Middle Street, Harpswell, Gainsborough, Lincolnshire, DN21 5UY
shown edged red on the attached maps labelled Map 1 and Map 2 and Two parcels of land lying to
the north of the A631 shown edged red on the attached map labelled Map 3

5. Ordnance Survey six-figure grid reference(s) of a point within the area of land(s) to which the
application relates (if known):

6. This deposit comprises the following statement(s) and/or declarations (*delete Parts B, C, or D
where not applicable*):

PART C: Declaration under section 31(6) of the Highways Act 1980

1. I am/We Geoffrey Bernard Kealey, Pauline Mary Kealey and Harpswell Farms Limited is are the joint owners of the land described in paragraph 4 of Part A of this form and shown edged red on the map lodged with Lincolnshire County Council on 23 June 2014.

(delete wording in square brackets as appropriate and/or insert information as required)

2. On the 23 day of June 2014 I deposited with Lincolnshire County Council, being the appropriate council, a statement accompanied by a map showing the property belonging to Geoffrey Bernard Kealey, Pauline Mary Kealey and Harpswell Farms Limited edged in red on three maps which stated that:

[the ways shown *[insert colouring]* on that map [and on the map accompanying this declaration] had been dedicated as byways open to all traffic]

[the ways shown *[insert colouring]* on that map [and on the map accompanying this declaration] had been dedicated as restricted byways]

[the ways shown *[insert colouring]* on that map [and on the map accompanying this declaration] had been dedicated as bridleways]

[the ways shown *[insert colouring]* on that map [and on the map accompanying this declaration] had been dedicated as footpaths]

No ways had been dedicated as highways over our property.

[3. On the *[insert day]* day of *[insert month, year]* [I/my/*[insert name of owner's]* predecessor in title *[insert name]*] deposited with *[insert name]* Council, being the appropriate council, a declaration dated *[insert day, month, year]*, stating that no additional ways [other than those marked in the appropriate colour on the map accompanying that declaration] had been dedicated as [byways open to all traffic] [restricted byways] [bridleways] [footpaths] since the deposit of the statement referred to in paragraph 2 above.]
(delete if not applicable and delete wording in square brackets as appropriate and/or insert information as required)

4. No additional ways have been dedicated over the land edged red on the maps accompanying this declaration and referenced in paragraph 1 above since the statement referred to in paragraph 2 above dated the 19 day of June 2014 [other than those [byways open to all traffic] [restricted byways] [bridleways] [footpaths] marked in the appropriate colour on the map accompanying this declaration] and at the present time the Owners have/has no intention of dedicating any more public rights of way over my/the their property.

(delete wording in square brackets as appropriate and/or insert information as required)

PART E: Additional information relevant to the application
(insert any additional information relevant to the application)

PART F: Statement of Truth
(all applicants must complete this Part)

WARNING: If you dishonestly enter information or make a statement that you know is, or might be, untrue or misleading, and intend by doing so to make a gain for yourself or another person, or to cause loss or the risk of loss to another person, you may commit the offence of fraud under section 1 of the Fraud Act 2006, the maximum penalty for which is 10 years' imprisonment or an unlimited fine, or both.

I BELIEVE THAT THE FACTS AND MATTERS CONTAINED IN THIS FORM ARE TRUE

Signature (of the person making the statement of truth):

Print full name: GEOFFREY BERNARD KEALEY

Date: 1st July 2014

You should keep a copy of the completed form

Data Protection Act 1998 - Fair Processing Notice

The purpose of this Fair Processing Notice is to inform you of the use that will be made of your personal data, as required by the Data Protection Act 1998.

The appropriate authority (see explanation of definition in above guidance notes) in England is the data controller in respect of any personal data that you provide when you complete this form.

The information that you provide will be used by the appropriate authority in its duties to process applications to deposit statements, maps and declarations under section 31(6) the Highways Act 1980 and statements under section 15A(1) of the Commons Act 2006. The information you provide will also be used by the appropriate authority in its duty to update the registers in which details of such deposits are recorded under the Dedicated Highways (Registers under Section 31A of the Highways Act 1980) (England) Regulations 2007 and the Commons (Registration of Town or Village Greens) and Dedicated Highways (Landowner Statements and Declarations) (England) Regulations 2013.

The appropriate authority is required by the legislation above to maintain a register which holds information provided in this form, which can be inspected online or in person by members of the public on request. It may also be required to release information, including personal data and commercial information, on request under the Environmental Information Regulations 2004 or the Freedom of Information Act 2000. However, the appropriate authority will not permit any unwarranted breach of confidentiality nor will they act in contravention of their obligations under the Data Protection Act 1998.

The boundaries shown by dotted lines have been plotted from the plans on the deeds. The title plan may be updated from later survey information

MAP 2

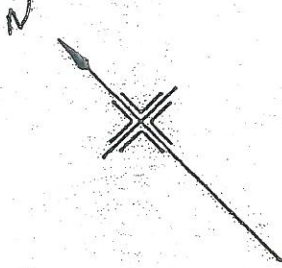

1:2500

SK 9380
SK 9388

SEE
MAP
NO. 1.

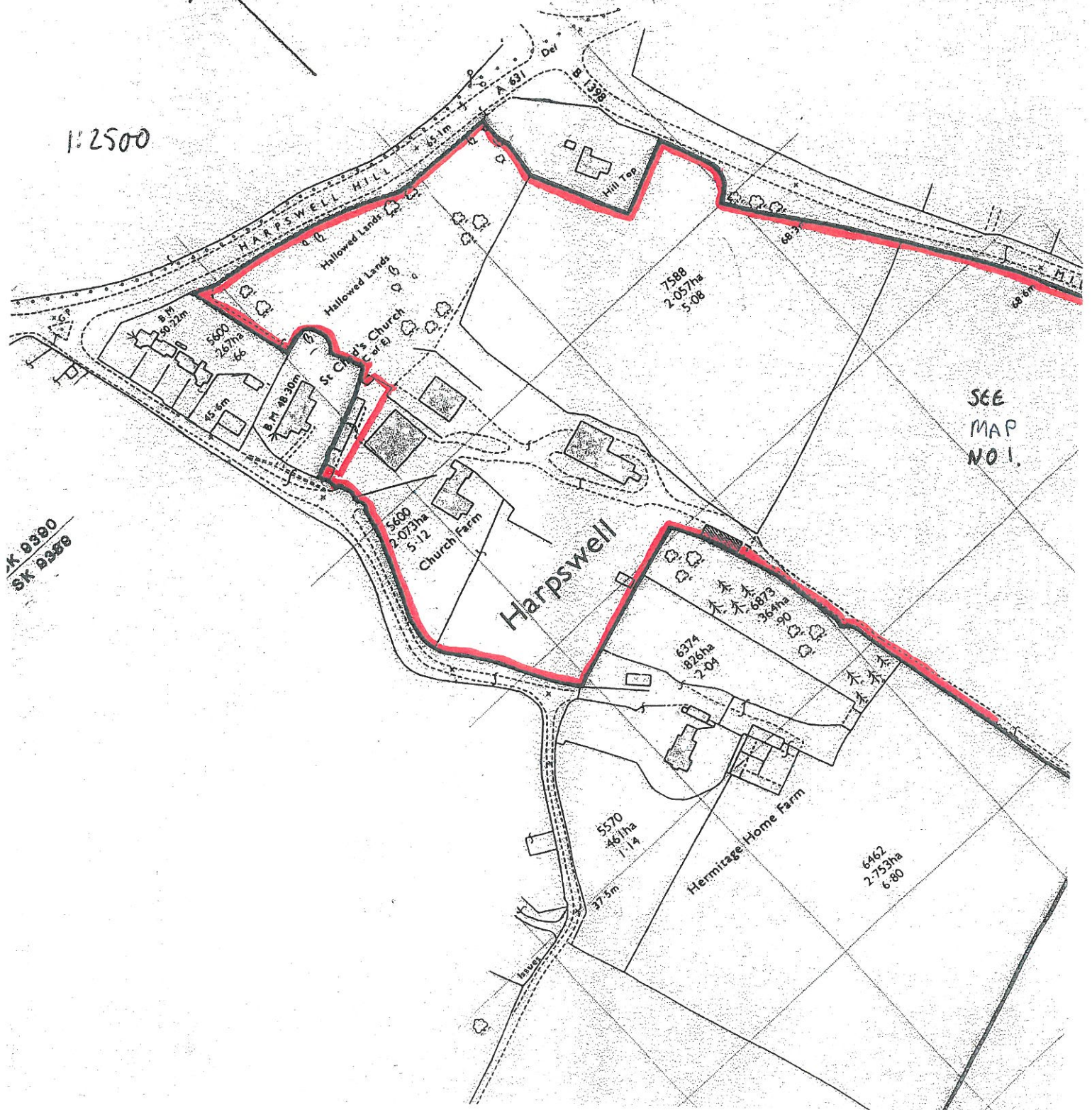

↑
N PARISH OF HEMSWELL.

MAP 3

1:5000

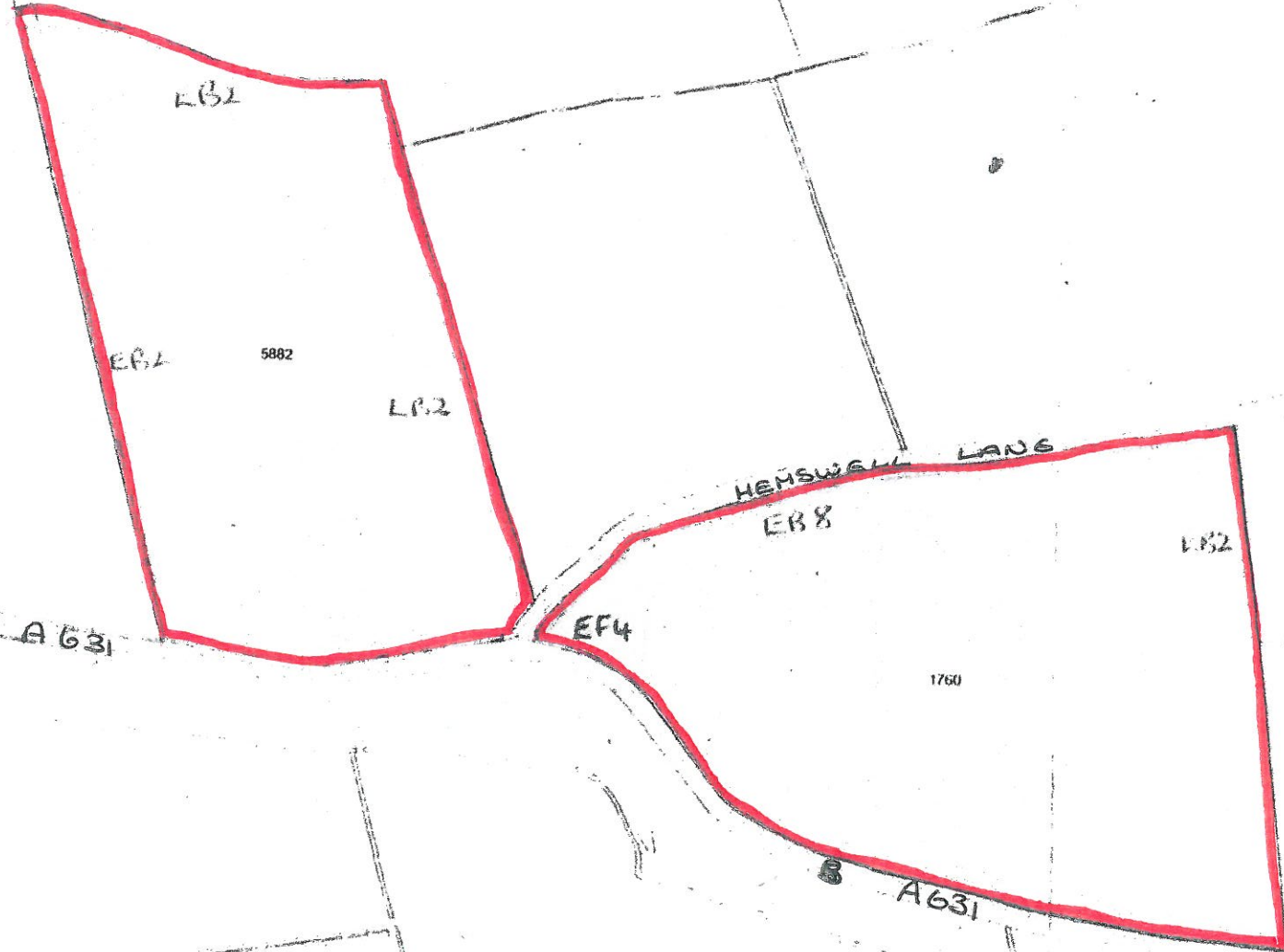

- EB
- EB
- EB
- EB
- EC
- EC
- ED
- EE
- EF
- EG
- EJ
- EK
- EL

You may
in black

0
L

This map is
of the Centre