

Parish: Canwick
Title: Land at Canwick Park Golf Club
Reference number: CA/7/1/269

HIGHWAYS ACT 1980, SECTION 31 (6) – DEPOSITED MAPS, HIGHWAYS STATEMENT AND HIGHWAYS DECLARATIONS

Date of deposit of map and highways statement 03.11.2008
Depositor's name and address Mr R Stansfield, Jesus College, Oxford, OX1 3DW
Dates of deposit of highways declarations and names and addresses of depositors (1) 03.11.2008: Mr R Stansfield, Jesus College, Oxford, OX1 3DW
Date deposit expires: 02.11.2018

GEOGRAPHIC LOCATION

Grid Reference: SK 991 702
Address and postcode of buildings on the deposited land Club House, Washingborough Road, LN4 1EF; Rose Cottage, Washingborough Road, Lincoln, LN4 1EF; Pitstop Garage, Canwick Road, Canwick, Lincoln, LN4 2RF; Canwick Hill House, Canwick Road, Canwick, Lincoln, LN4 2RF
District North Kesteven
Nearest city or town Lincoln

ENQUIRIES ABOUT THE REGISTER OR DEPOSITS

Enquiries concerning the register or the deposits lodged with the County Council should be made to the Definitive Map Officer at Lincolnshire County Council's Countryside Services Section by email to countryside_access@lincolnshire.gov.uk or by telephone on 01522 782070.

INFORMATION ABOUT THE REGISTER OF DEPOSITS

The County Council is required by law to keep and maintain a register of highways statements and highways declarations deposited under section 31 (6) of the Highways Act 1980 and landowner statements deposited under section 15A (1) of the Commons Act 2006. The register is available for public inspection on its website and in a paper copy format, together with copies of the deposited documents. Details, including names, addresses and the location of land relating to an application, which may be considered to be personal information, will therefore be in the public domain. This requirement overrides any entitlement a depositor and landowner may otherwise have under the Data Protection Act 1998 to prevent the publication of such information.

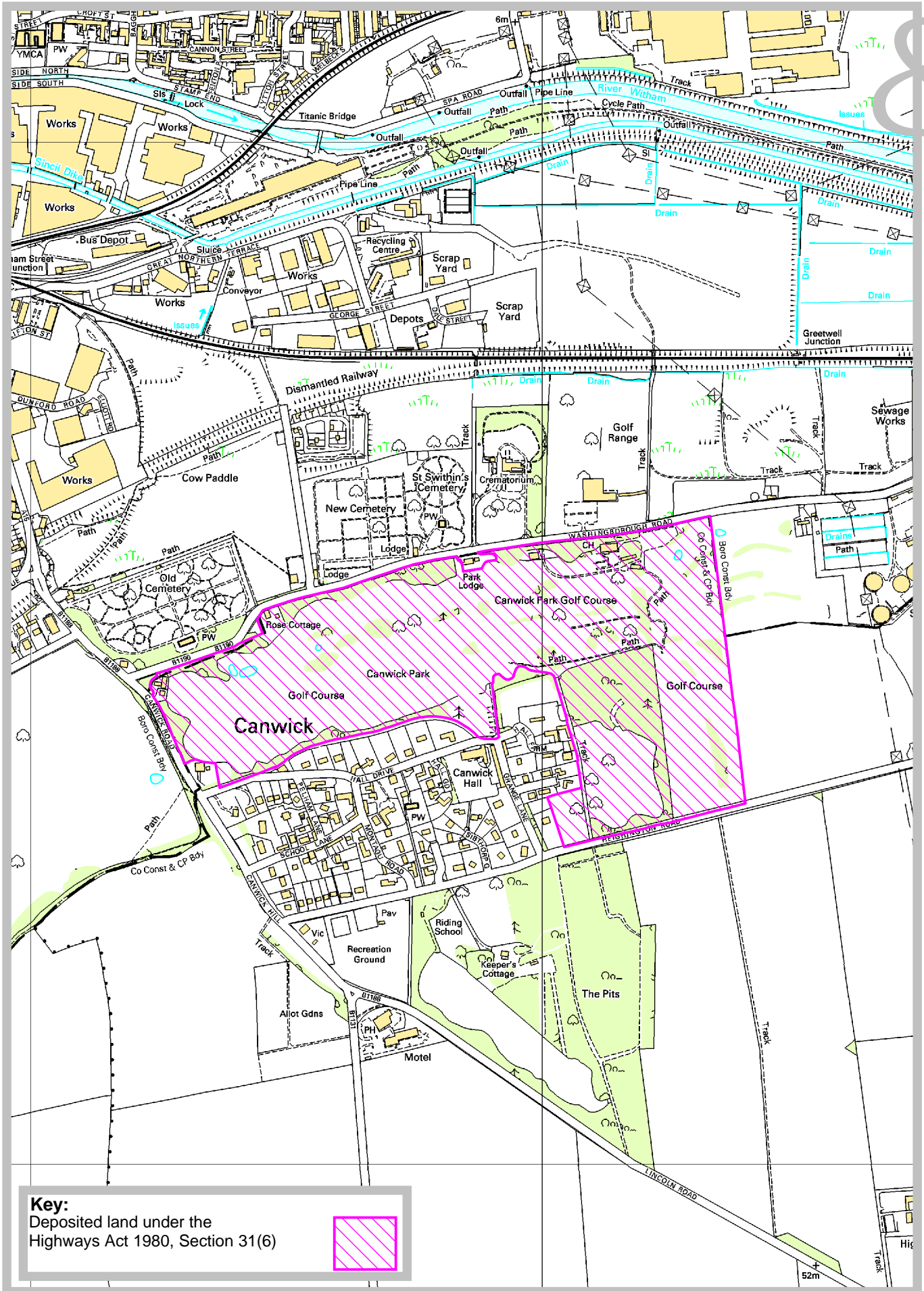
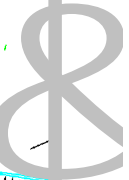

Key:
 Deposited land under the
 Highways Act 1980, Section 31(6)



Countryside Services
 RA Wills, Executive Director for Environment &
 Economy, County Offices, Newland, Lincoln,
 LN1 1YL.

Land at Canwick Park Golf Club

Ref: CA/7/1/269
 Grid Ref: SK 991 702
 Scale: 1:10,000

CA/7/1/269

DEPOSIT OF STATEMENT AND MAP

SECTION 31 (6) OF THE HIGHWAYS ACT 1980

To Countryside Section, Highways and Planning Directorate, Lincolnshire County Council, City Hall, Lincoln, LN1 1DN

1. The Principal, Fellows and Scholars of Jesus College within the City and University of Oxford are and have been since 1940 the owners within the meaning of the above section of the land known as land at Canwick Park Golf Club, Washingborough Road, Lincoln, LN4 1EF more particularly delineated on the map accompanying this statement and thereon edged red.
2. The aforementioned land lies in the Parish of Canwick
3. The way coloured brown on the said map have been dedicated as highways with restricted access.
4. No ways over the land have been dedicated as highways.
5. The deposit shall comprise this statement and accompanying map.

(for and behalf of Jesus College) .. 

Name (of landowners) The Principal and Fellows of Jesus College within the City and University of Oxford

Date: 27th September 2008

Signed: 

Name (of )

Address:  Farm close, Kingham

Occupation: 

0

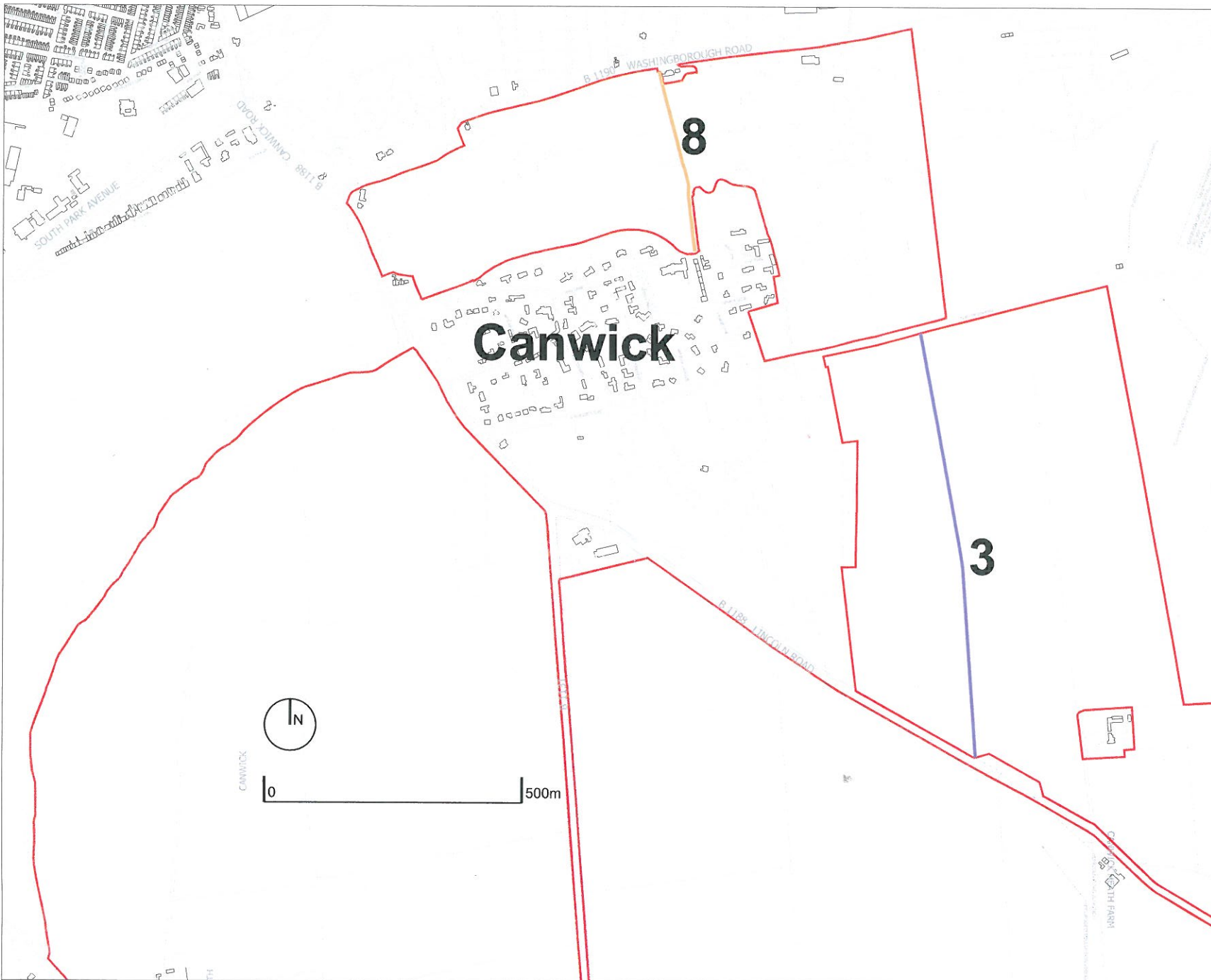

KEY

-  Land Ownership
-  8
Highway (restricted)
-  3
Bridalway Footpath



STATUTORY DECLARATION

SECTION 31 (6) OF THE HIGHWAYS ACT 1980

I, PETER NICHOLAS MIRFIELD of JESUS COLLEGE, OXFORD, OX1 3DW do solemnly and sincerely declare as follows:-

1 I am the Estate Bursar to the Principal, Fellows and Scholars of Jesus College within the City and University of Oxford of Queen Elizabeth's Foundation ("the Owners") and as such Estates Bursar I receive the rents due to the Owners in respect of their properties and I have access to the documents and books of account relating to such properties and rents

2 I am acquainted with the land and premises at Canwick Park Golf Club, Hall Farm in the Parish of Canwick Heath, Lincoln and Whitehall Farm in the Oparish of Bracebridge Heath, Lincoln ("the Land") which is show edged red on the two plans ("the Plans") annexed hereto and both marked "fp.01" and dated January 2008 ("the Property"). I have been acquainted with the Land since 1981.

3 THE Owners are and have been since 1940 the owners of the Land

4 ON the 17th October 2008 The Owners deposited with Lincolnshire County Council being the appropriate Council, a statement accompanied by a map delineating the Land by red edging which stated that the ways coloured brown on the said maps had been dedicated as highways with restricted access, the ways coloured purple on the said maps has been dedicated as footpaths and no other ways had been dedicated as highways over the Land.

5 NO additional ways have been dedicated of the Land since the statement dated 24th September 2008 referred to in 4. above and at the present time the Owners have no intention of dedicating any more public rights of way over the Land.

I MAKE this solemn declaration on the 28th day of October 2008 conscientiously believing it to be true and by virtue of the Statutory Declarations Act 1835.

Declared at (address)

52 N

Before me

(Commissi

