

DEPOSIT OF STATEMENT AND PLAN
SECTION 31(6) OF THE HIGHWAYS ACT 1980

To: Lincolnshire County Council

1. Loveden Holdings Limited is and has been since 13 November 1993 the owner within the meaning of the above section of the land known as Cardwell (otherwise Wiles) Farm Gedney Lincolnshire as more particularly delineated on the plan number 1 accompanying this statement and thereon edged red.
2. The aforementioned land lies in the Parish of Gedney
3. The ways shown by blue lines on the plan number 2 accompanying this statement appear on the Definitive Map as public footpaths Number 1 and 4 (part) respectively.
4. No other ways over the land have been dedicated as highways.
5. The deposit shall comprise this statement and the accompanying 2 plans.

Signed: (landowner)

 for and on behalf of Loveden Holdings Ltd

Name: (of landowner)

Loveden Holdings Ltd

Address

Brook House
42 Manor Street
Ruskington
Sleaford Lincs
NG34 9EP

Date:

22 January 2004

Signed (witness)

Name (of witness)

PFS BROWN
Hornsea PE12 7LP
Solicitor

Address

Occupation

H.M. LAND REGISTRY

TITLE NUMBER

LL101211

ORDNANCE SURVEY
PLAN REFERENCE

TF4129 TF4130 TF4131 TF4229 TF4230
TF4231 TF4329 TF4330 TF4331 TF4429
TF4430

Scale
1/6000
Reduced From 1/2600

COUNTY LINCOLNSHIRE

DISTRICT SOUTH HOLLAND

© Crown copyright

Enlargement No. 1 Scale 1:1250

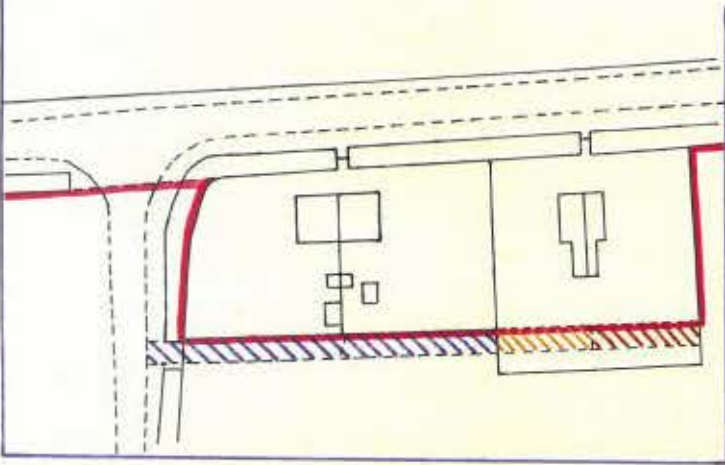

Enlargement No. 2 Scale 1:1250

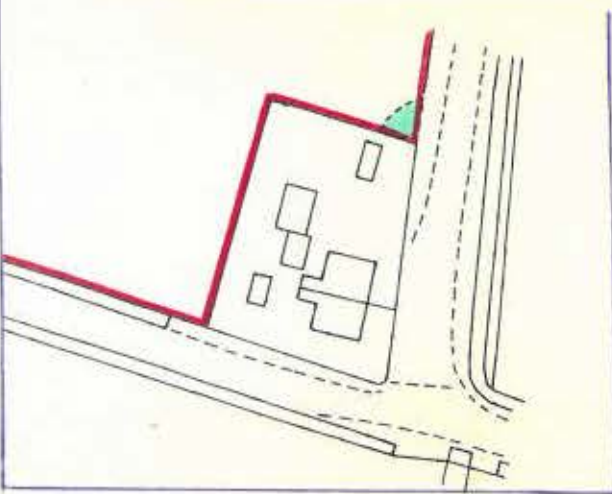

Enlargement No. 3 Scale 1:1250

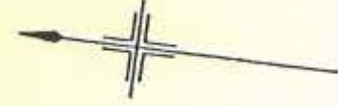
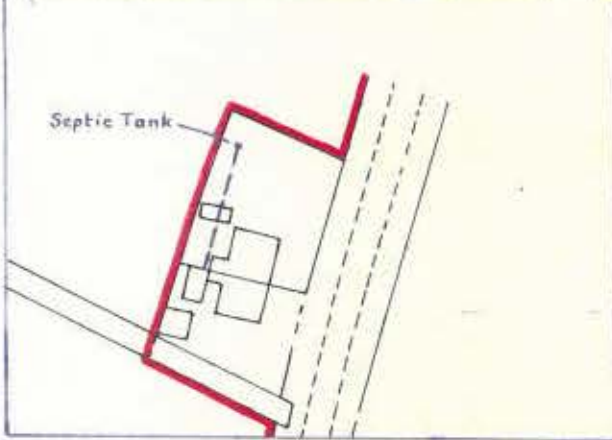

TF4430

TF4330

TF4331

Gedney Marsh

Holbach Marsh

Holbach Marsh

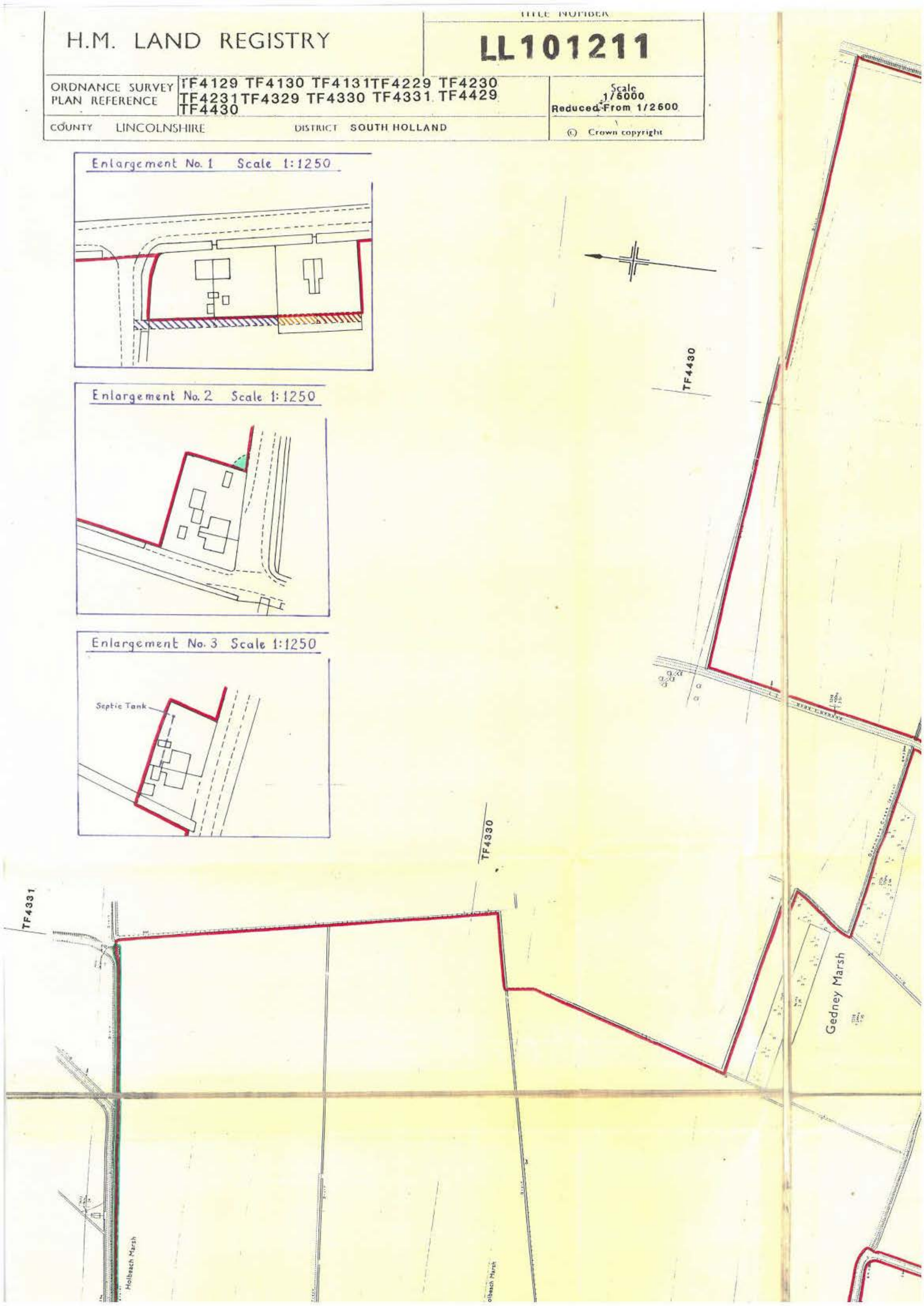

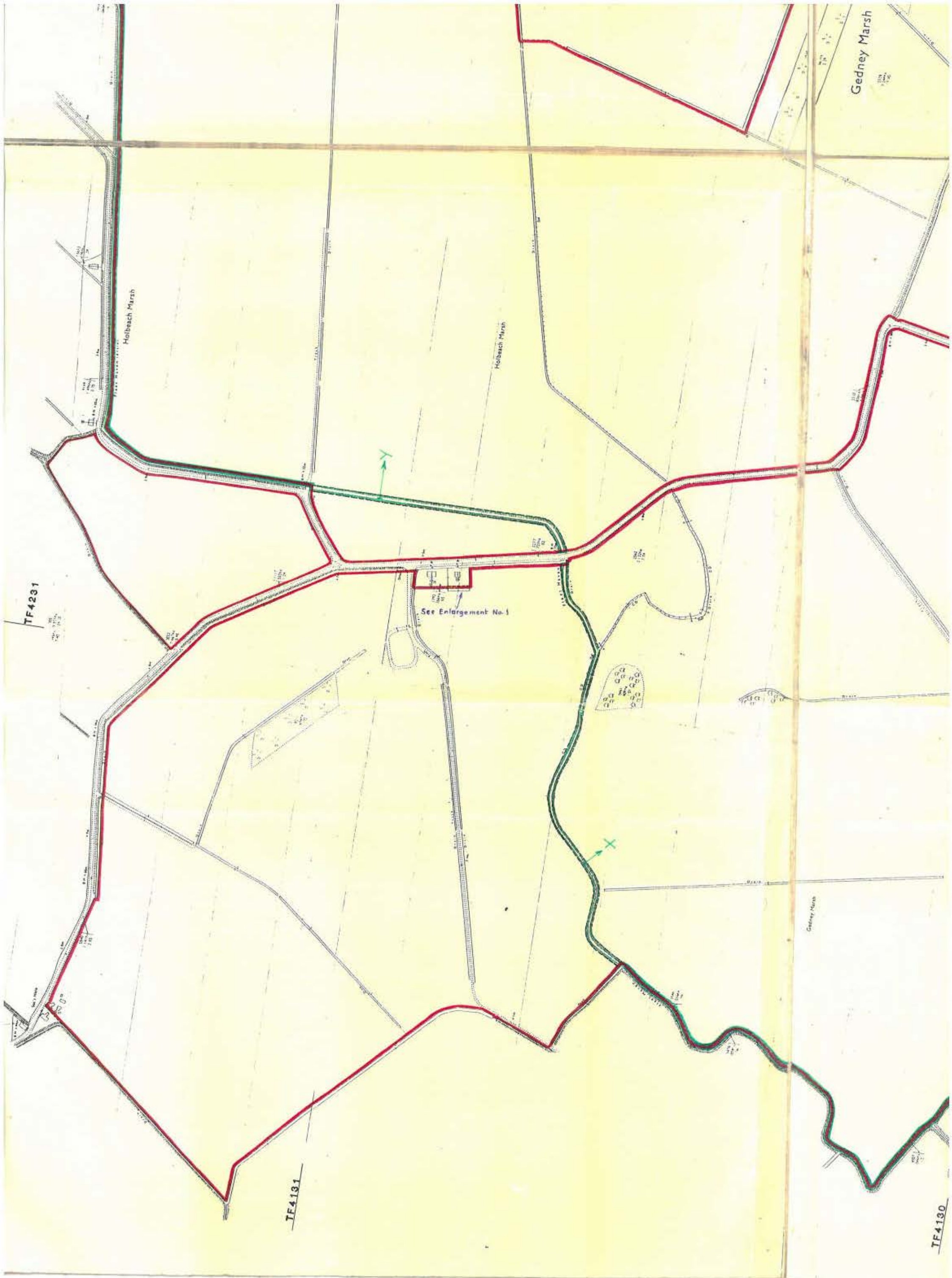

TF4231

Holbeach Marsh

Holbeach Marsh

Gedney Marsh

See Enlargement No. 1

TF4131

Gedney Marsh

TF4130

PLAN 1

This title plan shows the
Measurements scaled
For more information s
This office copy shows

2600

ight

TF4430

TF4429

TF4329

Gedney Marsh

Gedney Marsh

Dawsmere

See Enlargement No 2

See Enlargement No 2

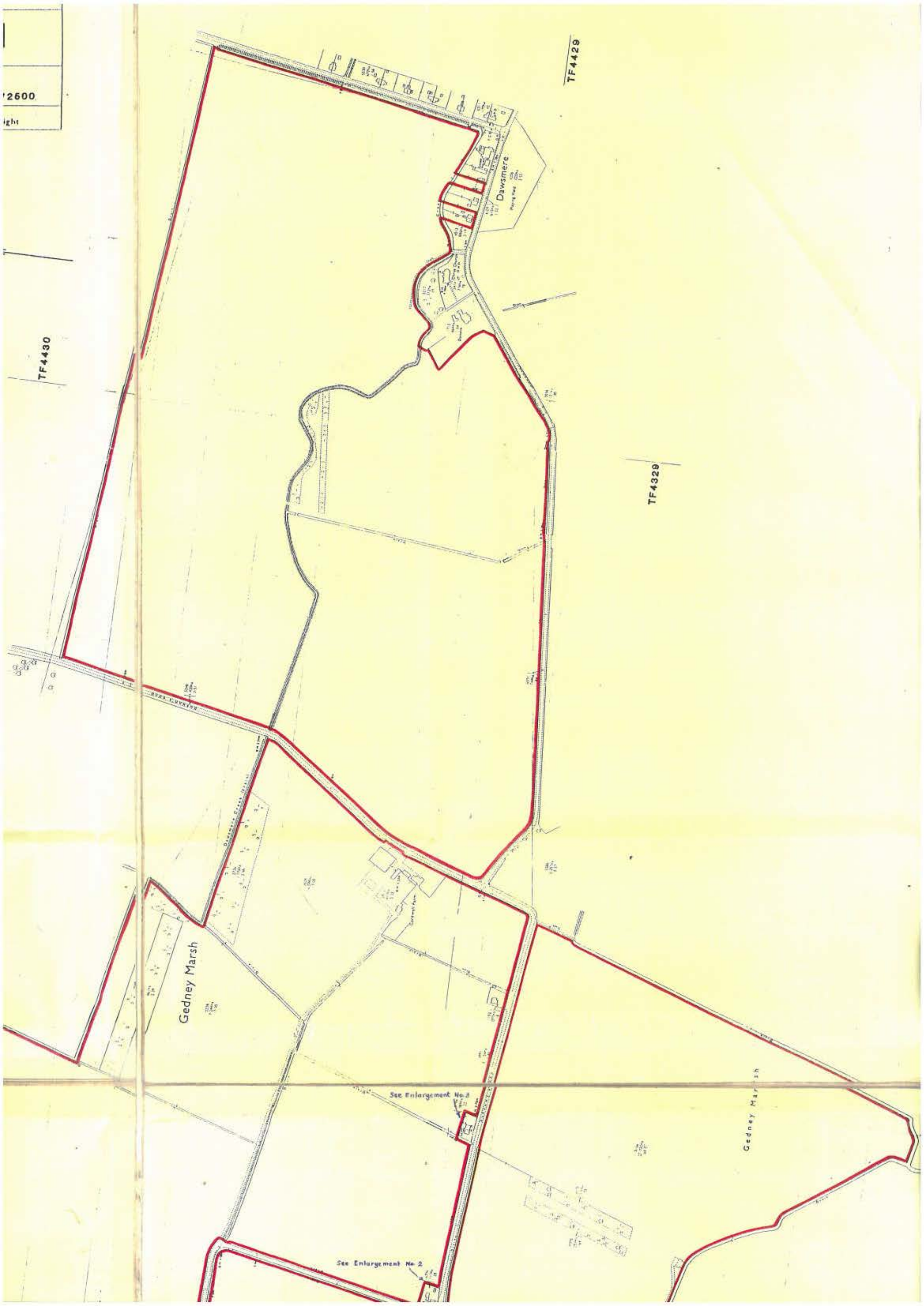



This title plan shows the general position of the boundaries: it does not show the exact line of boundaries. Measurements scaled from this plan may not match measurements between the same points on the ground. For more information see Land Registry Explanatory Leaflet 24.
 This office copy shows the state of the title plan on 20/6/03 at 13:50:35. It may be subject to distortions in scale.
 Under s.113 of the Land Registration Act 1925, this copy is admissible in evidence to the same extent as the original.
 Issued on 20/6/03
 This title is dealt with by the Kingston Upon Hull District Land Registry
 © Crown copyright. Produced by HMLR. Further reproduction in whole or part is prohibited without the prior written permission of Ordnance Survey. Licence Number GD272728.

21

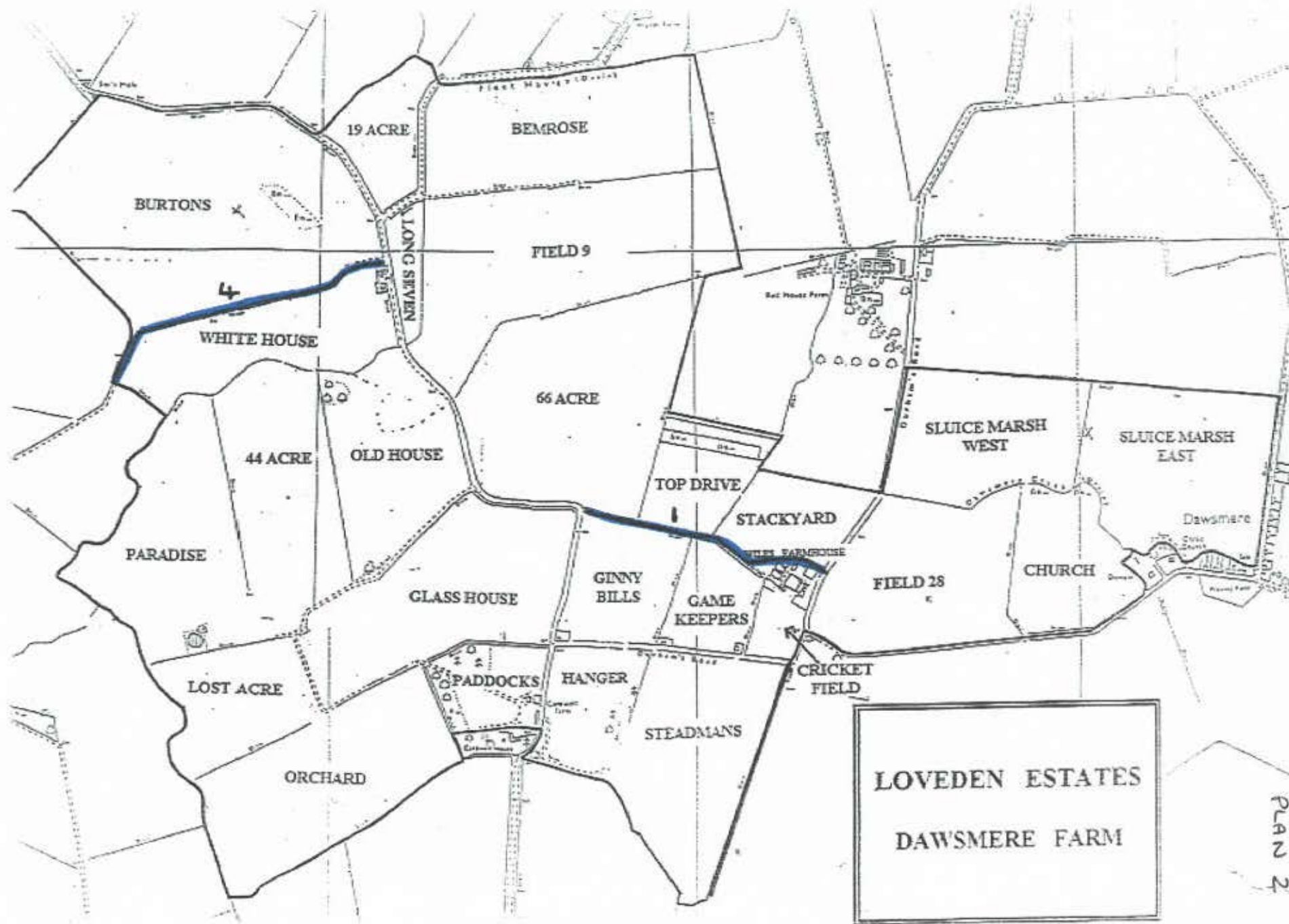

PLAN 2

I **NIGEL DENIS SPENCE BROWN** of Brook House 42 Manor Street Ruskington Lincolnshire NG34 9EP do solemnly and sincerely declare as follows:

1. Loveden Holdings Ltd is and has been since 13 November 1993 the owner of the land known as Cardwell (otherwise Wiles) Farm Gedney Lincolnshire as more particularly delineated on the plan marked "NDSB1" accompanying this declaration and thereon edged red

^{2.} On the 22 day of January 2004 Loveden Holdings Ltd deposited with Lincolnshire County Council being the appropriate Council a statement accompanied by 2 plans delineating its property by red edging which stated that the ways shown by blue lines on the plan marked "NDSB2" accompanying this declaration appear on the Definitive Map as public footpaths Number 1 and 4 (part) respectively.

3. No additional ways have been dedicated over the land edged red on the plan marked "NDSB1" accompanying this declaration since the date of the statement referred to in 2. above.

AND I make this solemn declaration conscientiously believing the same to be true and by virtue of the Statutory Declarations Act 1835

Declared at 122, 123, 124, 125, 126, 127, 128, 129, 130, 131, 132, 133, 134, 135, 136, 137, 138, 139, 140, 141, 142, 143, 144, 145, 146, 147, 148, 149, 150, 151, 152, 153, 154, 155, 156, 157, 158, 159, 160, 161, 162, 163, 164, 165, 166, 167, 168, 169, 170, 171, 172, 173, 174, 175, 176, 177, 178, 179, 180, 181, 182, 183, 184, 185, 186, 187, 188, 189, 190, 191, 192, 193, 194, 195, 196, 197, 198, 199, 200, 201, 202, 203, 204, 205, 206, 207, 208, 209, 210, 211, 212, 213, 214, 215, 216, 217, 218, 219, 220, 221, 222, 223, 224, 225, 226, 227, 228, 229, 230, 231, 232, 233, 234, 235, 236, 237, 238, 239, 240, 241, 242, 243, 244, 245, 246, 247, 248, 249, 250, 251, 252, 253, 254, 255, 256, 257, 258, 259, 260, 261, 262, 263, 264, 265, 266, 267, 268, 269, 270, 271, 272, 273, 274, 275, 276, 277, 278, 279, 280, 281, 282, 283, 284, 285, 286, 287, 288, 289, 290, 291, 292, 293, 294, 295, 296, 297, 298, 299, 300, 301, 302, 303, 304, 305, 306, 307, 308, 309, 310, 311, 312, 313, 314, 315, 316, 317, 318, 319, 320, 321, 322, 323, 324, 325, 326, 327, 328, 329, 330, 331, 332, 333, 334, 335, 336, 337, 338, 339, 340, 341, 342, 343, 344, 345, 346, 347, 348, 349, 350, 351, 352, 353, 354, 355, 356, 357, 358, 359, 360, 361, 362, 363, 364, 365, 366, 367, 368, 369, 370, 371, 372, 373, 374, 375, 376, 377, 378, 379, 380, 381, 382, 383, 384, 385, 386, 387, 388, 389, 390, 391, 392, 393, 394, 395, 396, 397, 398, 399, 400, 401, 402, 403, 404, 405, 406, 407, 408, 409, 410, 411, 412, 413, 414, 415, 416, 417, 418, 419, 420, 421, 422, 423, 424, 425, 426, 427, 428, 429, 430, 431, 432, 433, 434, 435, 436, 437, 438, 439, 440, 441, 442, 443, 444, 445, 446, 447, 448, 449, 450, 451, 452, 453, 454, 455, 456, 457, 458, 459, 460, 461, 462, 463, 464, 465, 466, 467, 468, 469, 470, 471, 472, 473, 474, 475, 476, 477, 478, 479, 480, 481, 482, 483, 484, 485, 486, 487, 488, 489, 490, 491, 492, 493, 494, 495, 496, 497, 498, 499, 500, 501, 502, 503, 504, 505, 506, 507, 508, 509, 510, 511, 512, 513, 514, 515, 516, 517, 518, 519, 520, 521, 522, 523, 524, 525, 526, 527, 528, 529, 530, 531, 532, 533, 534, 535, 536, 537, 538, 539, 540, 541, 542, 543, 544, 545, 546, 547, 548, 549, 550, 551, 552, 553, 554, 555, 556, 557, 558, 559, 560, 561, 562, 563, 564, 565, 566, 567, 568, 569, 570, 571, 572, 573, 574, 575, 576, 577, 578, 579, 580, 581, 582, 583, 584, 585, 586, 587, 588, 589, 590, 591, 592, 593, 594, 595, 596, 597, 598, 599, 600, 601, 602, 603, 604, 605, 606, 607, 608, 609, 610, 611, 612, 613, 614, 615, 616, 617, 618, 619, 620, 621, 622, 623, 624, 625, 626, 627, 628, 629, 630, 631, 632, 633, 634, 635, 636, 637, 638, 639, 640, 641, 642, 643, 644, 645, 646, 647, 648, 649, 650, 651, 652, 653, 654, 655, 656, 657, 658, 659, 660, 661, 662, 663, 664, 665, 666, 667, 668, 669, 670, 671, 672, 673, 674, 675, 676, 677, 678, 679, 680, 681, 682, 683, 684, 685, 686, 687, 688, 689, 690, 691, 692, 693, 694, 695, 696, 697, 698, 699, 700, 701, 702, 703, 704, 705, 706, 707, 708, 709, 710, 711, 712, 713, 714, 715, 716, 717, 718, 719, 720, 721, 722, 723, 724, 725, 726, 727, 728, 729, 730, 731, 732, 733, 734, 735, 736, 737, 738, 739, 740, 741, 742, 743, 744, 745, 746, 747, 748, 749, 750, 751, 752, 753, 754, 755, 756, 757, 758, 759, 760, 761, 762, 763, 764, 765, 766, 767, 768, 769, 770, 771, 772, 773, 774, 775, 776, 777, 778, 779, 780, 781, 782, 783, 784, 785, 786, 787, 788, 789, 790, 791, 792, 793, 794, 795, 796, 797, 798, 799, 800, 801, 802, 803, 804, 805, 806, 807, 808, 809, 810, 811, 812, 813, 814, 815, 816, 817, 818, 819, 820, 821, 822, 823, 824, 825, 826, 827, 828, 829, 830, 831, 832, 833, 834, 835, 836, 837, 838, 839, 840, 841, 842, 843, 844, 845, 846, 847, 848, 849, 850, 851, 852, 853, 854, 855, 856, 857, 858, 859, 860, 861, 862, 863, 864, 865, 866, 867, 868, 869, 870, 871, 872, 873, 874, 875, 876, 877, 878, 879, 880, 881, 882, 883, 884, 885, 886, 887, 888, 889, 890, 891, 892, 893, 894, 895, 896, 897, 898, 899, 900, 901, 902, 903, 904, 905, 906, 907, 908, 909, 910, 911, 912, 913, 914, 915, 916, 917, 918, 919, 920, 921, 922, 923, 924, 925, 926, 927, 928, 929, 930, 931, 932, 933, 934, 935, 936, 937, 938, 939, 940, 941, 942, 943, 944, 945, 946, 947, 948, 949, 950, 951, 952, 953, 954, 955, 956, 957, 958, 959, 960, 961, 962, 963, 964, 965, 966, 967, 968, 969, 970, 971, 972, 973, 974, 975, 976, 977, 978, 979, 980, 981, 982, 983, 984, 985, 986, 987, 988, 989, 990, 991, 992, 993, 994, 995, 996, 997, 998, 999, 1000
this 24th day of January
2004



Before me 

Solicitor

H.M. LAND REGISTRY

FILE NUMBER

LL101211

ORDNANCE SURVEY PLAN REFERENCE
TF4129 TF4130 TF4131 TF4229 TF4230
TF4231 TF4329 TF4330 TF4331 TF4429
TF4430

Scale
1/6000
Reduced From 1/2500.

COUNTY LINCOLNSHIRE

DISTRICT SOUTH HOLLAND

© Crown copyright

Enlargement No. 1 Scale 1:1250

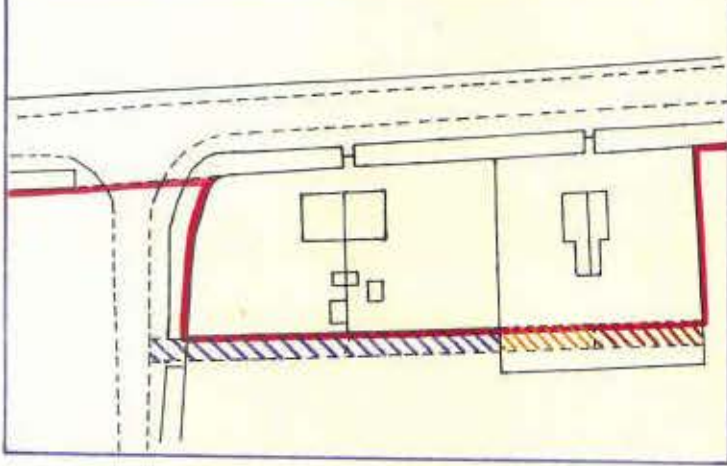

Enlargement No. 2 Scale 1:1250

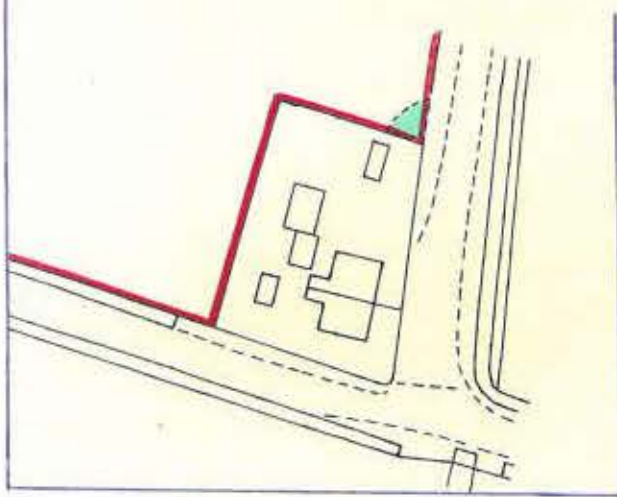

Enlargement No. 3 Scale 1:1250

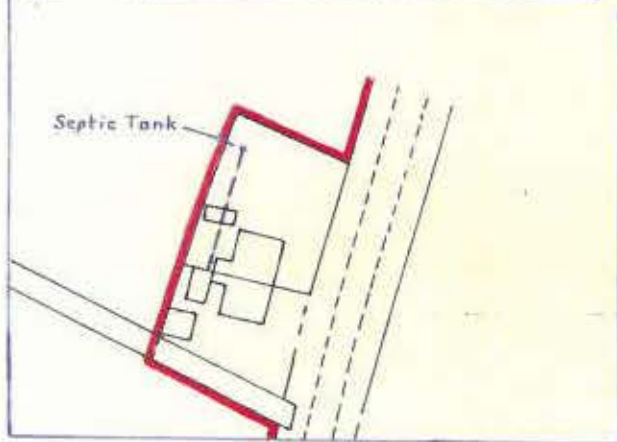

This is the exhibit marked "NDSB1" referred to in the Statutory Declaration of Nigel Denis Spence Brown declared before me this 27th day of [redacted] 2008.

Solicitor



TF4430

TF4330

TF4331

Gedney Marsh

Holbeach Marsh

Holbeach Marsh

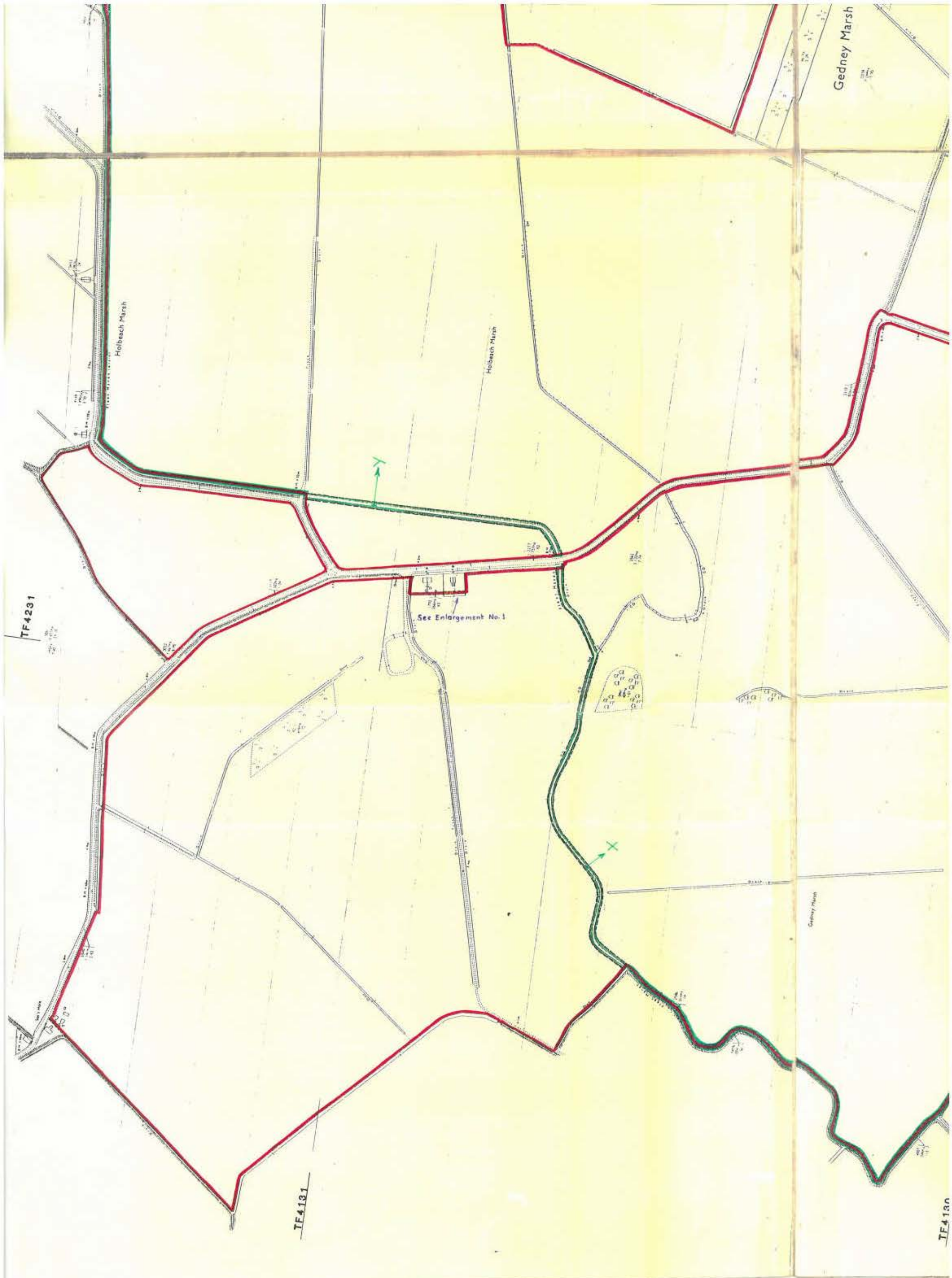

TF4231

TF4131

TF4130

Gedney Marsh

Holbeach Marsh

Holbeach Marsh

See Enlargement No. 1

Gedney Marsh

ROAD

This title plan shows
Measurements scale
For more information
This office copy shows
distortions in scale

2600

light

* referred
 Nigel Denis Spence Brown

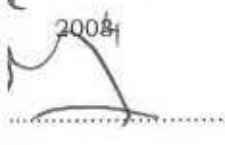

TF4430

TF4429

TF4329

Gedney Marsh

Gedney Marsh

See Enlargement No. 3

See Enlargement No. 2

Dawsmere
Ponding Pond 1.00m

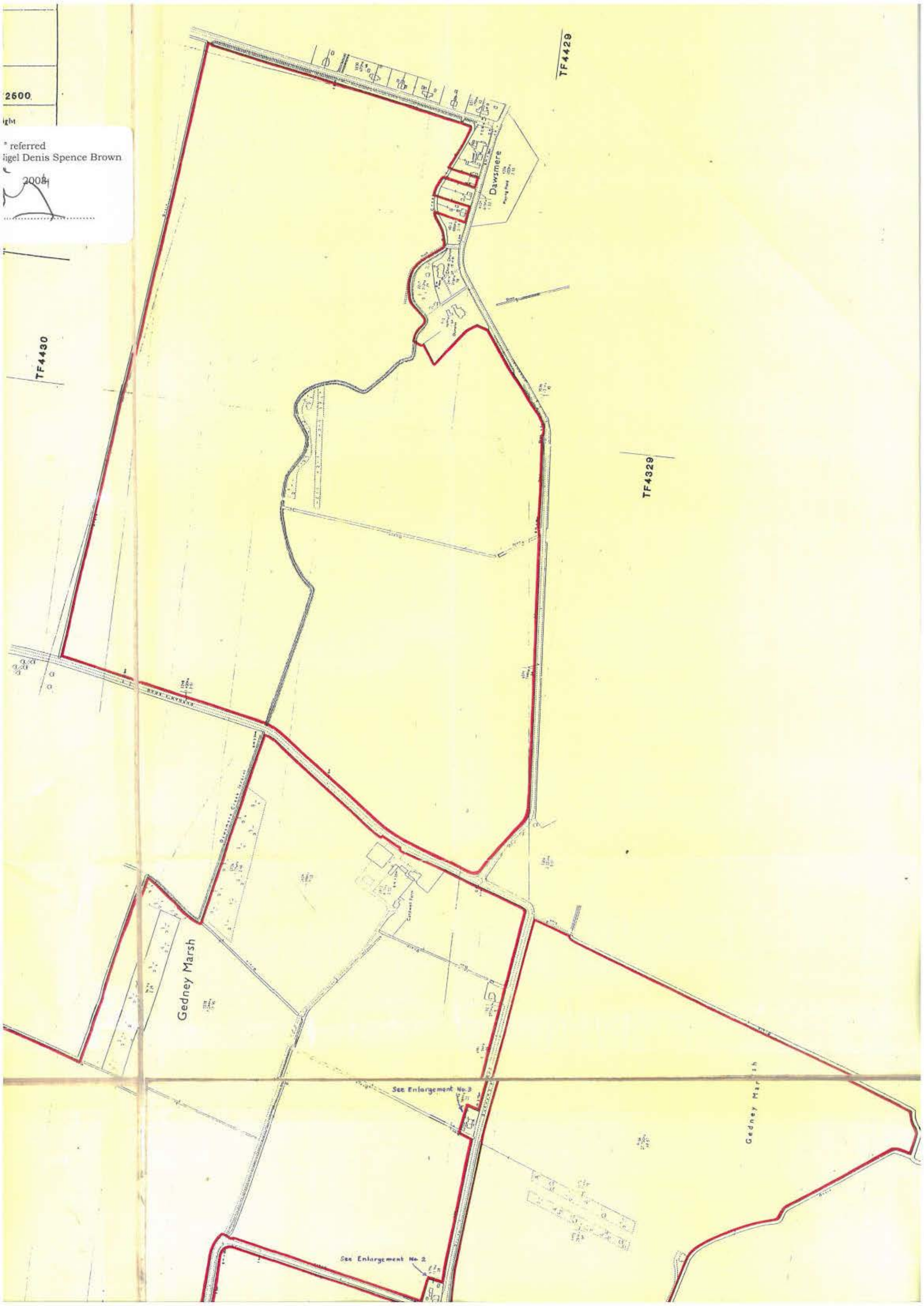



This title plan shows the general position of the boundaries: it does not show the exact line of boundaries. Measurements scaled from this plan may not match measurements between the same points on the ground. For more information see Land Registry Explanatory Leaflet 24.

This office copy shows the state of the title plan on 2016/03 at 13:50:35 It may be subject to distortions in scale.

Under s.113 of the Land Registration Act 1925, this copy is admissible in evidence to the same extent as the original.

Issued on 2016/03

This title is dealt with by the Kingston Upon Hull District Land Registry

© Crown copyright. Produced by HMLR. Further reproduction in whole or part is prohibited without the prior written permission of Ordnance Survey. Licence Number GD272728.

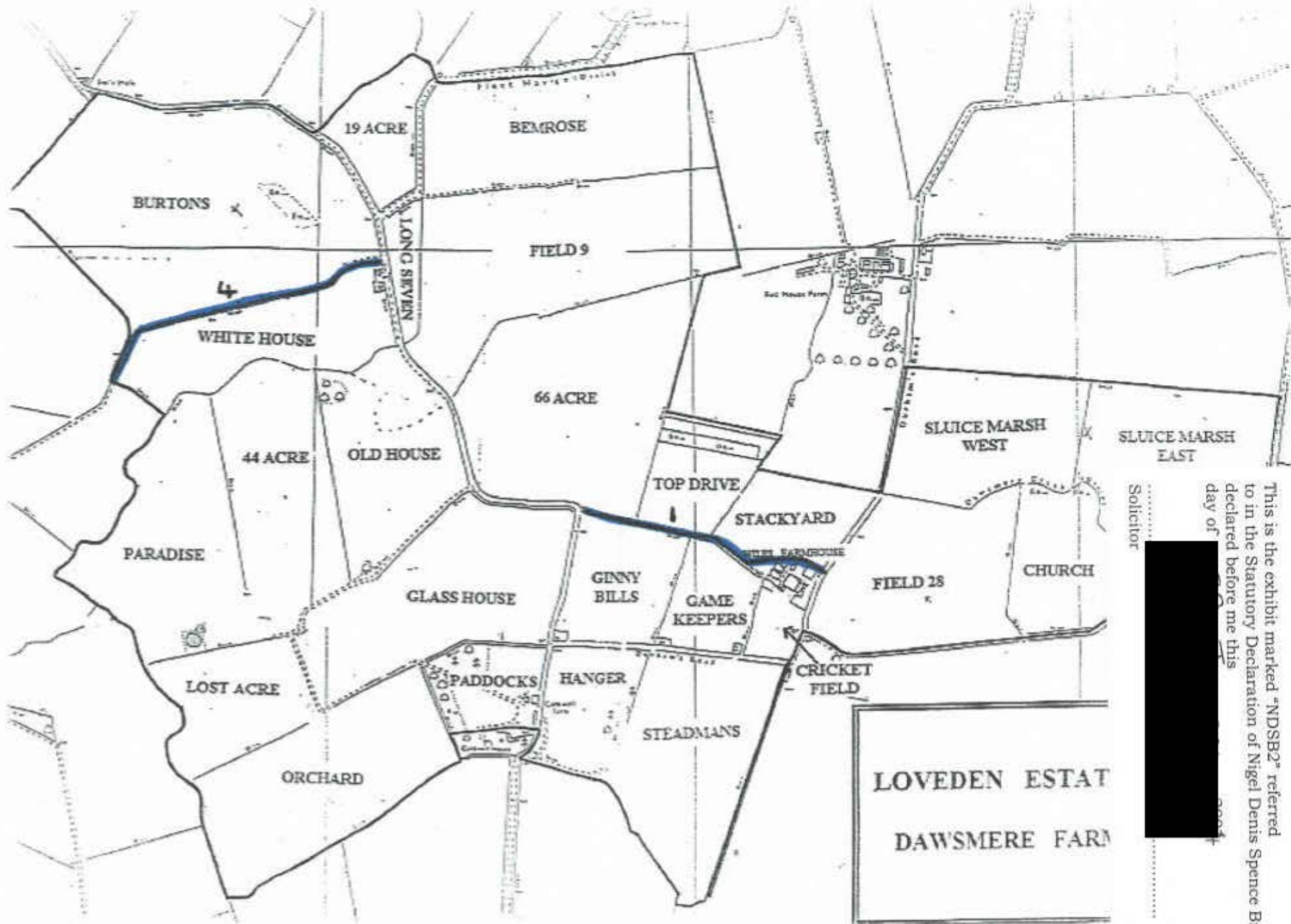

This is the exhibit marked "NDSB2" referred
to in the Statutory Declaration of Nigel Denis Spence Brown
declared before me this
day of [redacted] 2004

Solicitor

STATUTORY DECLARATION HIGHWAYS ACT 1980 S.31(6)

I NIGEL DENIS SPENCE BROWN of The Old Rectory Fulbeck Grantham Lincolnshire NG32 3JS **DO SOLEMNLY AND SINCERELY DECLARE** as follows:

1. Loveden Estates Ltd (CRN: 894965) (formerly Loveden Holdings Ltd) is and has been since 13 November 1993 the owner of the land known as Cardwell (otherwise Wiles) Farm Gedney Lincolnshire more particularly delineated on the plan marked "NDSB1" accompanying this declaration and thereon edged red.
2. On 22 January 2004 Loveden Estates Ltd deposited with Lincolnshire County Council, being the appropriate council, a statement accompanied by a plan delineating its property by red edging which stated that the ways shown by blue lines on the plan marked "NDSB2" accompanying this declaration appeared on the definitive map as public footpaths Number 1 and Number 4 (part) respectively and that no ways over the land had been dedicated as highways
3. On or about 29 January 2004 I deposited with Lincolnshire County Council, a statutory declaration dated 29 January 2004 stating that no additional ways had been dedicated since the deposit of the statement referred to in 2 above.
4. No additional ways have been dedicated over the land edged red on the plan marked "NDSB1" accompanying this declaration since the date of the statutory declaration referred to in 3 above and at the present time Loveden Estates Ltd has no intention of dedicating any more public rights of way over its property.

AND I MAKE this solemn declaration conscientiously believing it to be true and by virtue of the Statutory Declarations Act 1835.

Declared at
this
2013

Spence Brown
Holwell Lincolnshire
this *4th* day of *MARCH*

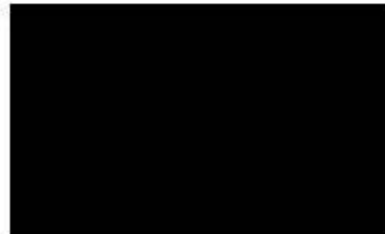

Before me



.....
Solicitor/Commissioner for Oaths

J. C. Woolley
Solicitor

PB/7487/Cardwell (otherwise Wiles) Farm Gedney Lincolnshire

H.M.

This is the exhibit marked "NDSB1" referred to in the Statutory Declaration of Nigel Denis Spence Brown declared before me this day of March 2013

LL101211

ORDNANCE
PLAN REFERENCE

TF4131 TF4229 TF4230
TF4330 TF4331 TF4429

Scale
1/5000
Reduced From 1/2600

COUNTY

J. C. Woolley
Solicitor

DISTRICT SOUTH HOLLAND

© Crown copyright

Enlargement No. 1 Scale 1:1250

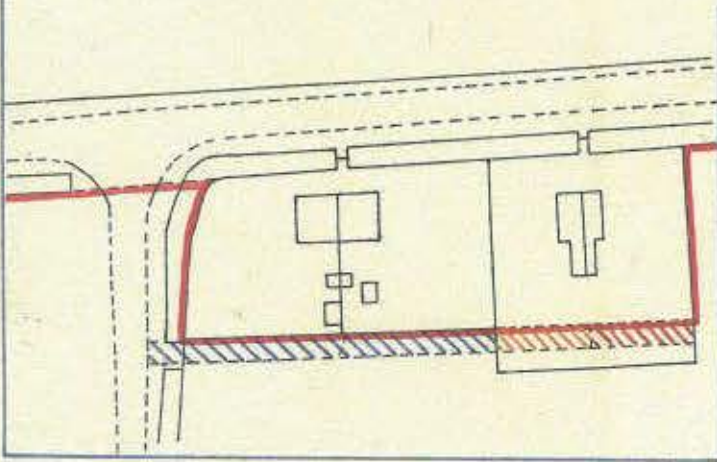

Enlargement No. 2 Scale 1:1250

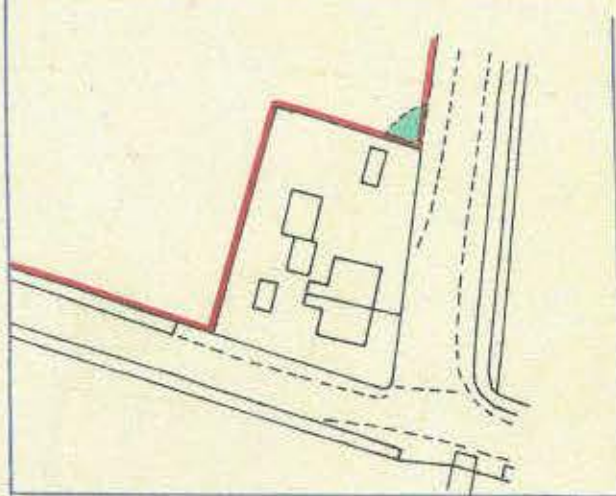

Enlargement No. 3 Scale 1:1250

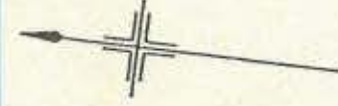
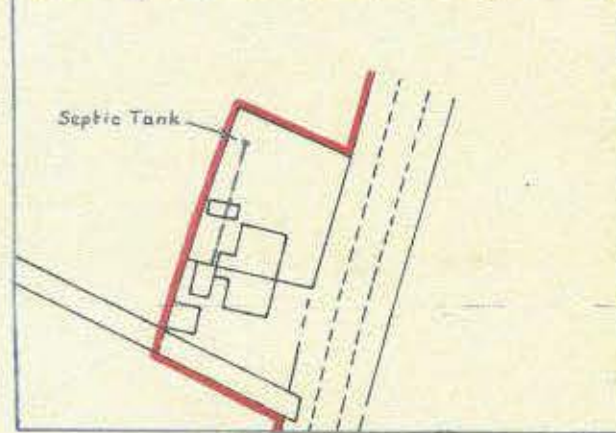

TF4430

TF4330

TF4331

Gedney Marsh

Holbeach Marsh

Holbeach Marsh

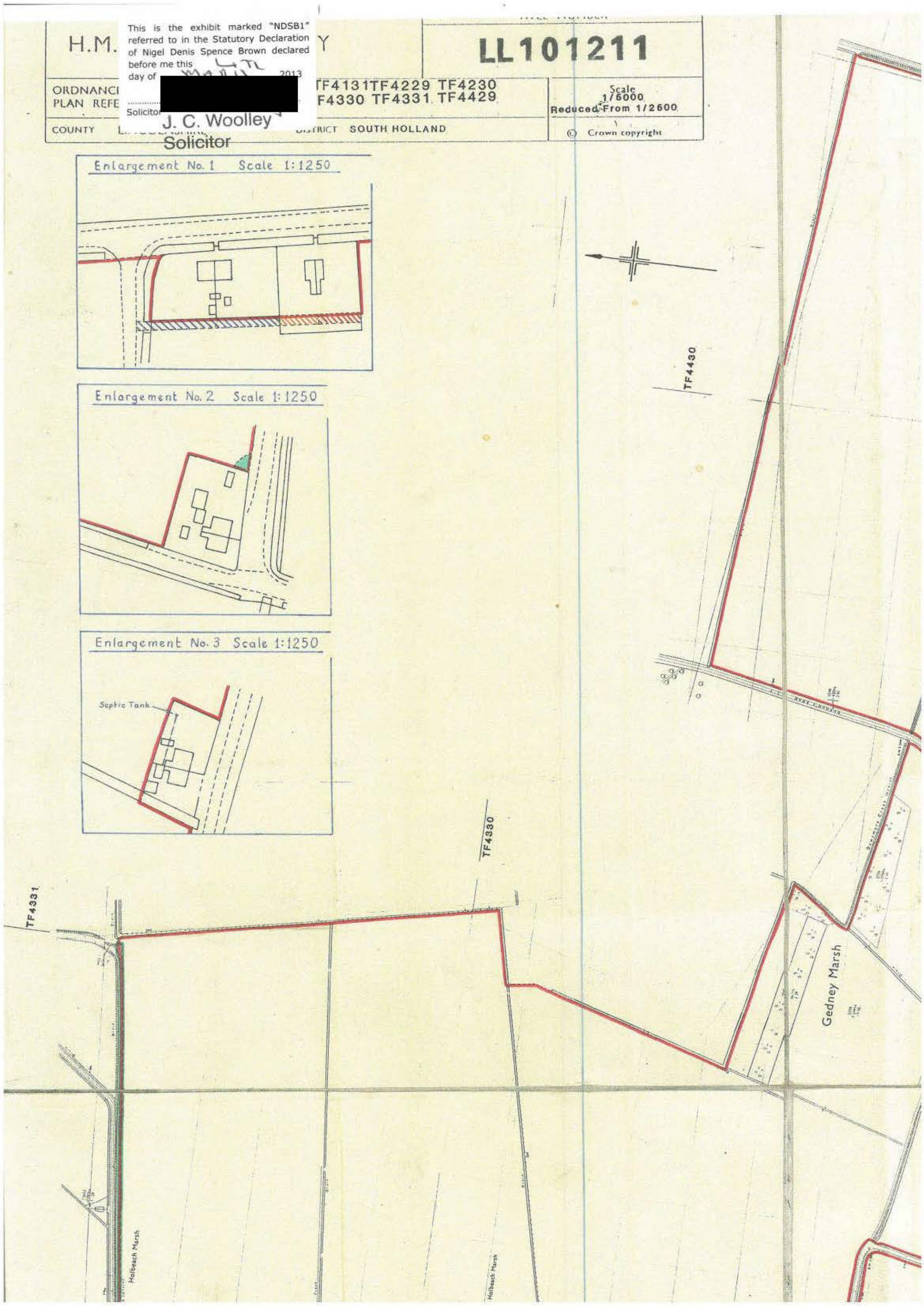

TF4331

Gedney Marsh

Holbeach Marsh

Holbeach Marsh

TF4231

See Enlargement No. 1

TF4131

Gedney Marsh

TF4131



This official copy issued on 2 August 2012 shows the state of this title plan on 2 August 2012 at 00:00:01. It is admissible in evidence to the same extent as the original (s.67 Land Registration Act 2002). This title plan shows the general position, not the exact line, of the boundaries. It may be subject to distortions in scale. Measurements scaled from this plan may not match measurements between the same points on the ground. See Land Registry Public Guide 19 - Title Plans and Boundaries. This title is dealt with by Land Registry, Kingston upon Hull Office. © Crown Copyright. Produced by Land Registry. Reproduction in whole or part is prohibited without the prior written permission of Ordnance Survey. Licence number 100026316.

TF4429

TF4329

TF4430



without the
subject to
to persons at
se the re au
u

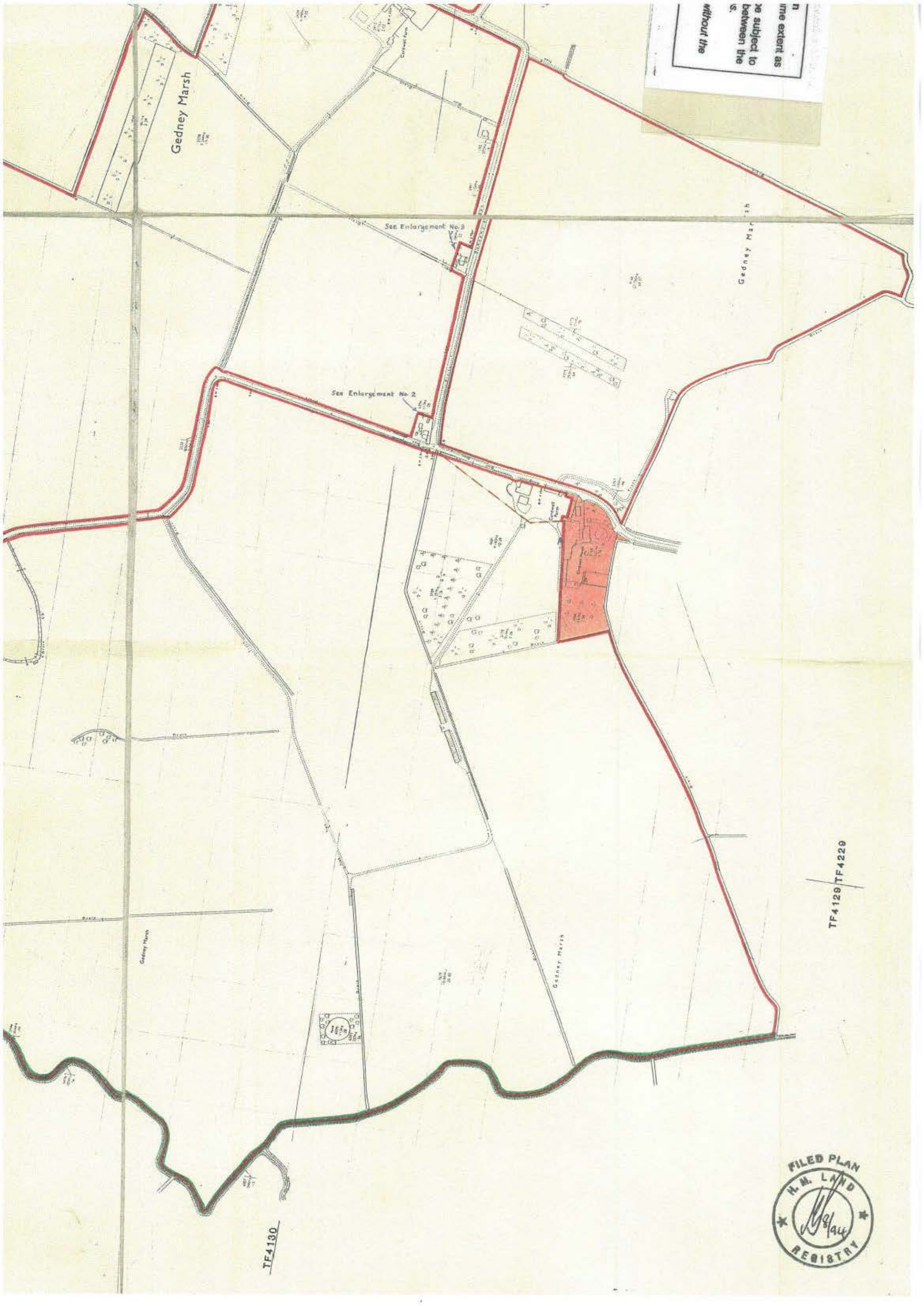

Gedney Marsh

Gedney Marsh

See Enlargement No. 3

See Enlargement No. 2

TF4129/TF4229

TF4130



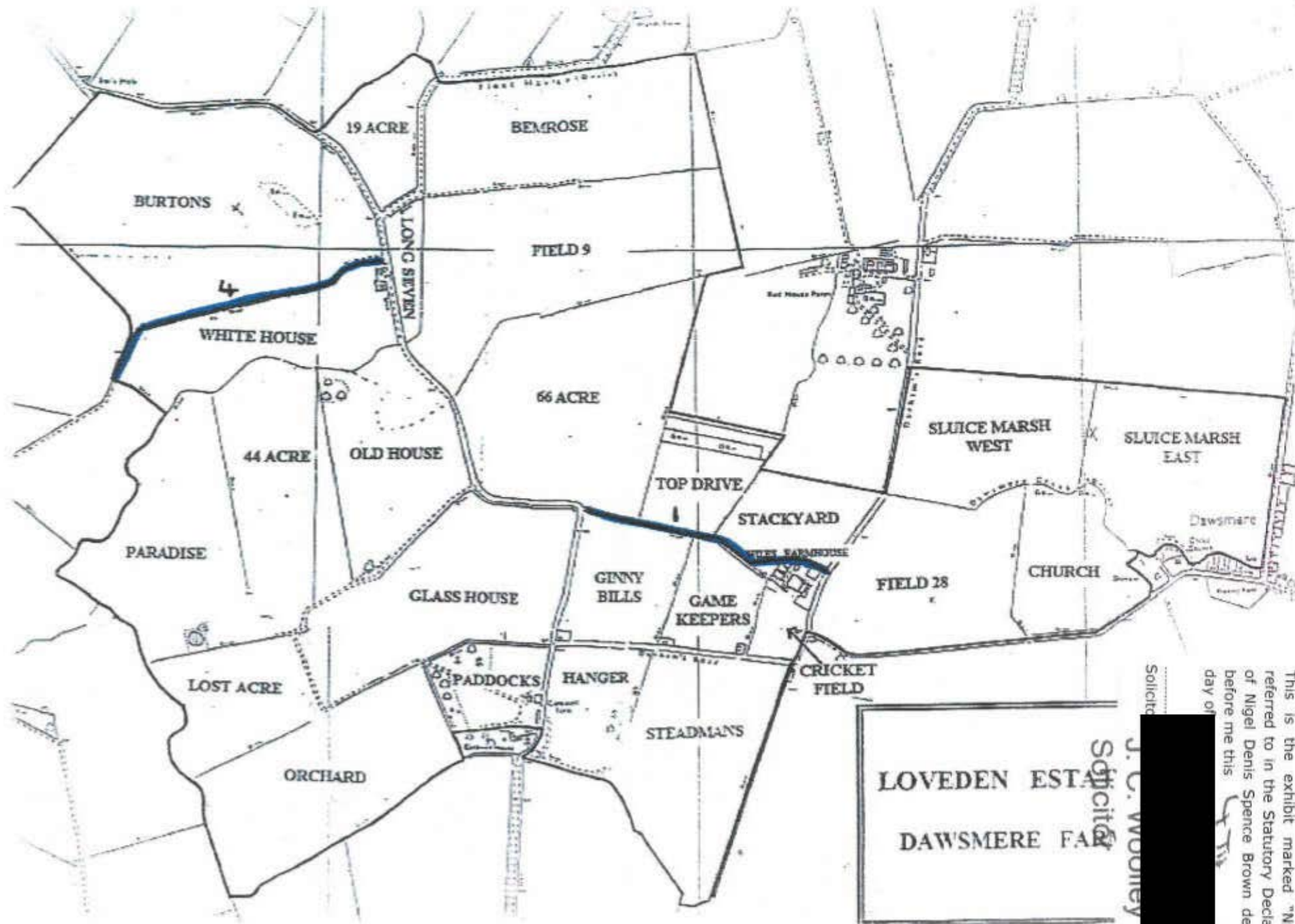

LOVEDEN ESTATE
 DAWSMERE FARM

This is the exhibit marked "NDSB2" referred to in the Statutory Declaration of Nigel Denis Spence Brown declared before me this [redacted] day of [redacted] 2008.

Solicitor
 J. C. WOOLLEY