

10. 'Appropriate authority' means (a) in relation to a map or statement deposited or declaration lodged under section 31(6) of that Act, an appropriate council (as defined in section 31(7) of the Highways Act 1980); and (b) in relation to a statement and map deposited under section 15A(1) of the 2006 Act, a commons registration authority (defined in section 4 of the Commons Act 2006 and section 2 of the Commons Registration Act 1965). In practice, the appropriate council and commons registration authority will usually be the same body.

PART A: Information relating to the applicant and land to which the application relates
(all applicants must complete this Part)

1. Name of appropriate authority to which the application is addressed:
Lincolnshire County Council

2. Name and full address (including postcode) of applicant:
Simmons and Sons Surveyors LLP (c/o Edward Dixon),
32 Bell Street, Henley on Thames, Oxon RG9 2BH

3. Status of applicant (tick relevant box or boxes):

I am

- (a) the owner of the land(s) described in paragraph 4.
(b) making this application and the statements/declarations it contains on behalf of Mrs Joan Rowe who is the owner of the land(s) described in paragraph 4 and in my capacity as agent.

4. Insert description of the land(s) to which the application relates (including full address and postcode):
Land at Portugal Farm, Great Carlton, Louth, Lincolnshire LN11 8BF

5. Ordnance Survey six-figure grid reference(s) of a point within the area of land(s) to which the application relates (if known):

TF4184 4648

6. This deposit comprises the following statement(s) and/or declarations:

PART B: Statement under section 31(6) of the Highways Act 1980

Mrs Joan Rowe is the owner of the land described in paragraph 4 of Part A of this form and shown edged blue on the map accompanying this statement.

Ways shown green on the accompanying map are public bridleways.

Ways shown red on the accompanying map are public footpaths.

No other ways over the land shown edged blue on the accompanying map have been dedicated as highways.

PART E: Additional information relevant to the application
(insert any additional information relevant to the application)

PART F: Statement of Truth
(all applicants must complete this Part)

WARNING: If you dishonestly enter information or make a statement that you know is, or might be, untrue or misleading, and intend by doing so to make a gain for yourself or another person, or to cause loss or the risk of loss to another person, you may commit the offence of fraud under section 1 of the Fraud Act 2006, the maximum penalty for which is 10 years' imprisonment or an unlimited fine, or both.

I BELIEVE THAT THE FACTS AND MATTERS CONTAINED IN THIS FORM ARE TRUE

Signature (of the person making the statement of truth):



Print full name: Edward Dixon (as agent)

Date: 13th January 2022

You should keep a copy of the completed form

Data Protection Act 1998 - Fair Processing Notice

The purpose of this Fair Processing Notice is to inform you of the use that will be made of your personal data, as required by the Data Protection Act 1998.

The appropriate authority (see explanation of definition in above guidance notes) in England is the data controller in respect of any personal data that you provide when you complete this form.

The information that you provide will be used by the appropriate authority in its duties to process applications to deposit statements, maps and declarations under section 31(6) the Highways Act 1980 and statements under section 15A(1) of the Commons Act 2006. The information you provide will also be used by the appropriate authority in its duty to update the registers in which details of such deposits are recorded under the Dedicated Highways (Registers under Section 31A of the Highways Act 1980) (England) Regulations 2007 and the Commons (Registration of Town or Village Greens) and Dedicated Highways (Landowner Statements and Declarations) (England) Regulations 2013.

The appropriate authority is required by the legislation above to maintain a register which holds information provided in this form, which can be inspected online or in person by members of the public on request. It may also be required to release information, including personal data and commercial information, on request under the Environmental Information Regulations 2004 or the Freedom of Information Act 2000. However, the appropriate authority will not permit any unwarranted breach of confidentiality nor will they act in contravention of their obligations under the Data Protection Act 1998.

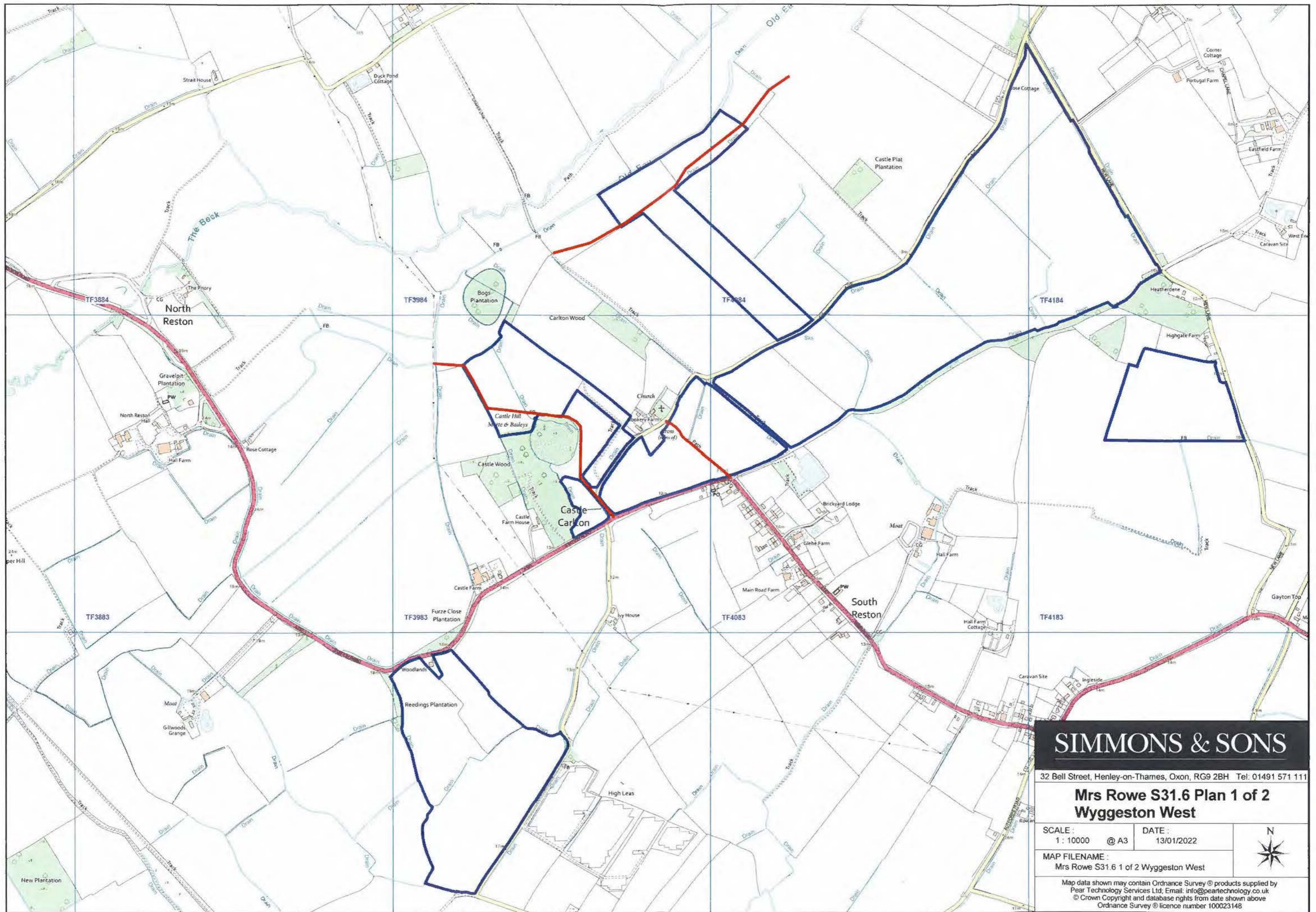

SIMMONS & SONS

32 Bell Street, Henley-on-Thames, Oxon, RG9 2BH Tel: 01491 571 111

Mrs Rowe S31.6 Plan 1 of 2 Wyggeston West

SCALE: 1:10000 @ A3 DATE: 13/01/2022

MAP FILENAME:
Mrs Rowe S31.6 1 of 2 Wyggeston West



Map data shown may contain Ordnance Survey © products supplied by
Pear Technology Services Ltd; Email: info@peartechology.co.uk
© Crown Copyright and database rights from date shown above
Ordnance Survey © licence number 100023148

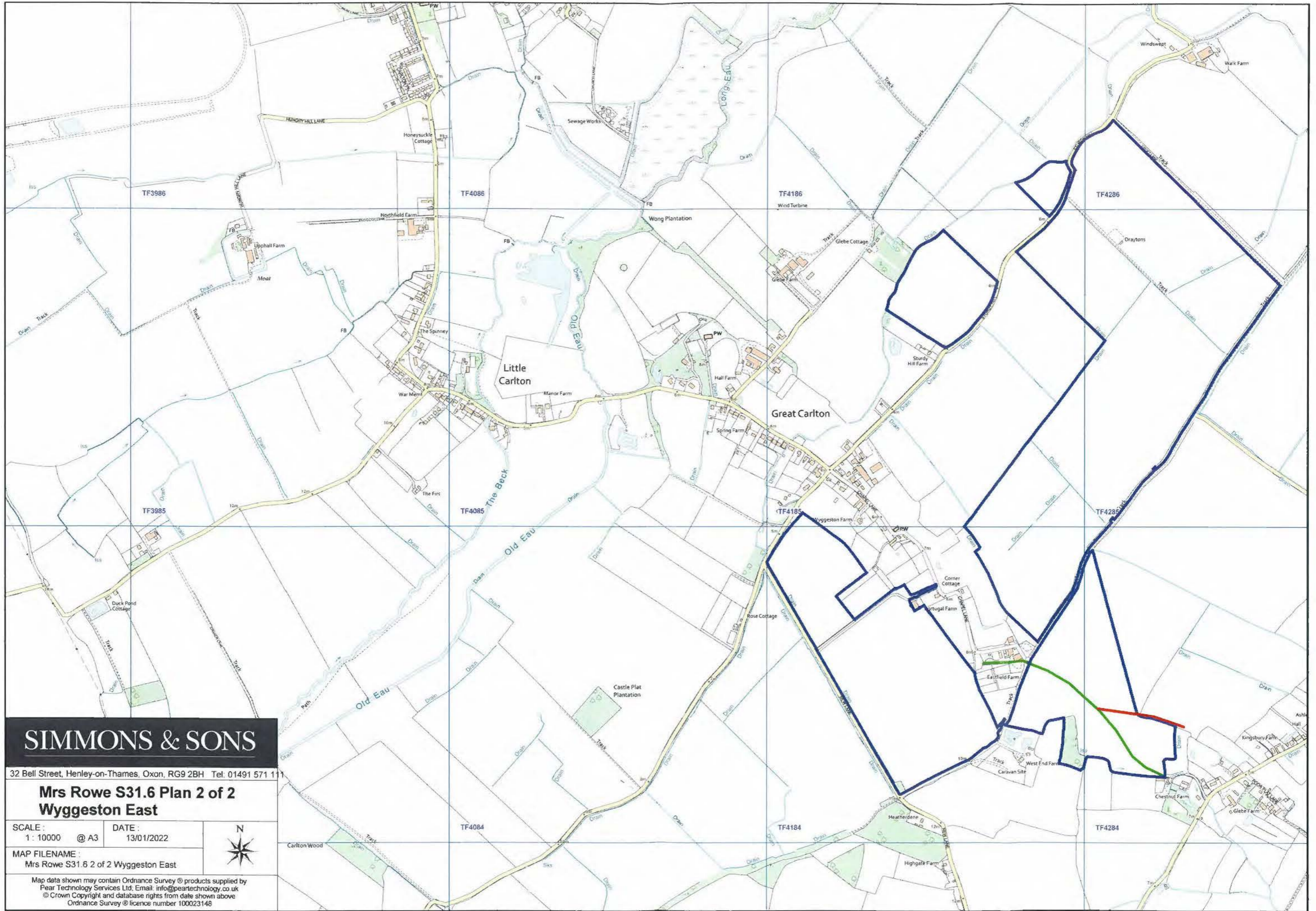

SIMMONS & SONS

32 Bell Street, Henley-on-Thames, Oxon, RG9 2BH Tel: 01491 571 111

Mrs Rowe S31.6 Plan 2 of 2 Wyggeston East

SCALE: 1 : 10000 @ A3 DATE: 13/01/2022

MAP FILENAME:
Mrs Rowe S31.6 2 of 2 Wyggeston East



Map data shown may contain Ordnance Survey © products supplied by
Pear Technology Services Ltd. Email: info@peartechology.co.uk
© Crown Copyright and database rights from date shown above
Ordnance Survey @ licence number 100023148

10. 'Appropriate authority' means (a) in relation to a map or statement deposited or declaration lodged under section 31(6) of that Act, an appropriate council (as defined in section 31(7) of the Highways Act 1980); and (b) in relation to a statement and map deposited under section 15A(1) of the 2006 Act, a commons registration authority (defined in section 4 of the Commons Act 2006 and section 2 of the Commons Registration Act 1965). In practice, the appropriate council and commons registration authority will usually be the same body.

**PART A: Information relating to the applicant and land to which the application relates
(all applicants must complete this Part)**

1. Name of appropriate authority to which the application is addressed:
Lincolnshire County Council

2. Name and full address (including postcode) of applicant:
Simmons and Sons Surveyors LLP (c/o Edward Dixon),
32 Bell Street, Henley on Thames, Oxon RG9 2BH

3. Status of applicant (tick relevant box or boxes):

I am

(a) the owner of the land(s) described in paragraph 4.

(b) making this application and the statements/declarations it contains on behalf of Mrs Joan Rowe who is the owner of the land(s) described in paragraph 4 and in my capacity as agent.

4. Insert description of the land(s) to which the application relates (including full address and postcode):
Land at Portugal Farm, Great Carlton, Louth, Lincolnshire LN11 8BF

5. Ordnance Survey six-figure grid reference(s) of a point within the area of land(s) to which the application relates (if known):

TF4184 4648

6. This deposit comprises the following statement(s) and/or declarations:

PART B: Statement under section 31(6) of the Highways Act 1980

~~[I am/[insert name of owner] is] the owner of the land described in paragraph 4 of Part A of this form and shown [insert colouring] on the map accompanying this statement.~~

~~(delete wording in square brackets as appropriate and/or insert information as required)~~

~~{Ways shown [insert colouring] on the accompanying map are byways open to all traffic.}~~

~~{Ways shown [insert colouring] on the accompanying map are restricted byways.}~~

~~{Ways shown [insert colouring] on the accompanying map are public bridleways.}~~

~~{Ways shown [insert colouring] on the accompanying map are public footpaths.}~~

~~No [other] ways over the land shown [insert colouring] on the accompanying map have been dedicated as highways.~~

~~(delete wording in square brackets as appropriate and/or insert information as required)~~

PART C: Declaration under section 31(6) of the Highways Act 1980

1. Mrs Joan Rowe is the owner of the land described in paragraph 4 of Part A of this form and shown edged blue on the map lodged with Lincolnshire County Council on 14th January 2022.

2. On the 14th day of January 2022 I deposited with Lincolnshire County Council, being the appropriate council, a statement accompanied by a map showing Mrs Joan Rowe's property [*edged blue*] which stated that:

~~{the ways shown [*insert colouring*] on that map [and on the map accompanying this declaration] had been dedicated as byways open to all traffic}~~

~~{the ways shown [*insert colouring*] on that map [and on the map accompanying this declaration] had been dedicated as restricted byways}~~

the ways shown coloured green on that map had been dedicated as bridleways

the ways shown coloured red on that map had been dedicated as footpaths

no other ways had been dedicated as highways over Mrs Joan Rowe's property.

~~{3. On the [*insert day*] day of [*insert month, year*] [*I/my*/{*insert name of owner's*} predecessor in title [*insert name*}] deposited with [*insert name*] Council, being the appropriate council, a declaration dated [*insert day, month, year*], stating that no additional ways [other than those marked in the appropriate colour on the map accompanying that declaration] had been dedicated as [*byways open to all traffic*] [*restricted byways*] [*bridleways*] [*footpaths*] since the deposit of the statement referred to in paragraph 2 above.} (*delete if not applicable and delete wording in square brackets as appropriate and/or insert information as required*)~~

4. No additional ways have been dedicated over the land edged blue on the map referenced in paragraph 1 above since the statement dated 13th January 2022 referred to in paragraph 2 above and at the present time Mrs Joan Rowe has no intention of dedicating any more public rights of way over the property.

PART D: Statement under section 15A(1) of the Commons Act 2006

~~{I am/{*insert name of owner*} is} the owner of the land described in paragraph 4 of Part A of this form and shown [*insert colouring*] on the map [accompanying this statement/deposited with [*insert name*] Council on [*insert day, month, year*]}.~~

~~{I/{*insert name of owner*}} [*wish/wishes*] to bring to an end any period during which persons may have indulged as of right in lawful sports and pastimes on the whole or any part of the land shown [*insert colouring*] on the [accompanying map/map referenced above]. (*delete wording in square brackets as appropriate and/or insert information as required*)~~

PART E: Additional information relevant to the application
(insert any additional information relevant to the application)

PART F: Statement of Truth
(all applicants must complete this Part)

WARNING: If you dishonestly enter information or make a statement that you know is, or might be, untrue or misleading, and intend by doing so to make a gain for yourself or another person, or to cause loss or the risk of loss to another person, you may commit the offence of fraud under section 1 of the Fraud Act 2006, the maximum penalty for which is 10 years' imprisonment or an unlimited fine, or both.

I BELIEVE THAT THE FACTS AND MATTERS CONTAINED IN THIS FORM ARE TRUE

Signature (of the person making the statement of truth):



Print full name: EDWARD DIXON (as agent)

Date: 1st February 2022

You should keep a copy of the completed form

Data Protection Act 1998 - Fair Processing Notice

The purpose of this Fair Processing Notice is to inform you of the use that will be made of your personal data, as required by the Data Protection Act 1998.

The appropriate authority (see explanation of definition in above guidance notes) in England is the data controller in respect of any personal data that you provide when you complete this form.

The information that you provide will be used by the appropriate authority in its duties to process applications to deposit statements, maps and declarations under section 31(6) the Highways Act 1980 and statements under section 15A(1) of the Commons Act 2006. The information you provide will also be used by the appropriate authority in its duty to update the registers in which details of such deposits are recorded under the Dedicated Highways (Registers under Section 31A of the Highways Act 1980) (England) Regulations 2007 and the Commons (Registration of Town or Village Greens) and Dedicated Highways (Landowner Statements and Declarations) (England) Regulations 2013.

The appropriate authority is required by the legislation above to maintain a register which holds information provided in this form, which can be inspected online or in person by members of the public on request. It may also be required to release information, including personal data and commercial information, on request under the Environmental Information Regulations 2004 or the Freedom of Information Act 2000. However, the appropriate authority will not permit any unwarranted breach of confidentiality nor will they act in contravention of their obligations under the Data Protection Act 1998.