

Location Plan
 Scale 1:50000

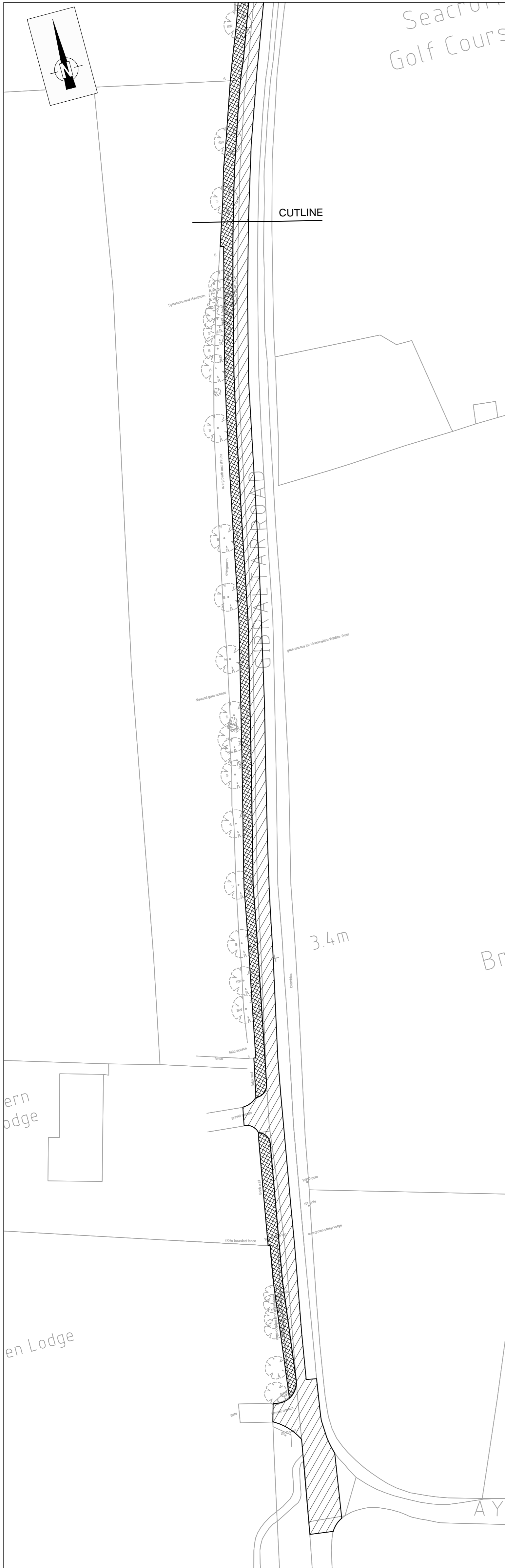

Inset 1
 Scale 1:500



Inset 2
 Scale 1:500

Key

	Proposed carriageway surfacing
	Proposed Shared foot/cycleway

APPROVED FOR GENERAL ISSUE
 (NOT TO BE USED FOR PRICING OR CONSTRUCTION PURPOSES)
 FOR THIRD PARTY USE, THIS DRAWING SHALL BE DEEMED
 CURRENT ONLY AT THE DATE OF APPROVAL. PLEASE CHECK
 FOR AMENDMENTS BEFORE USE

Revision	Description	Drawn By	CAD By	Approved By	Approval Date

Amendment Details

Drawing 1st Approval

1st Approval by: EF Date: 08/11/18

Drawn/Designed by: EF CAD Drawing Creation

Created By: DS Date: 08/11/18

Scale: (@A1)

Primary: 1:500 (Do not scale from this drawing)

Secondary:

Lincolnshire
 COUNTY COUNCIL
Highways Alliance
 TECHNICAL SERVICES PARTNERSHIP
 CROWN HOUSE
 GIBALTAH STREET
 LINCOLN
 LN2 1BD
 Customer Service Centre: 01522 782070

Drawing Number: 0040 /04/ 2036

Alternative Scheme Code:

Parish: SKEGNESS

Road No: Structure No:

Description:

GIBALTAR POINT

PHASE 4b

SECTION S58 PLAN