

Key

- Proposed Carriageway
- Proposed Non Motorised User Route

Grid Ref: 500350/370477
500202/370439

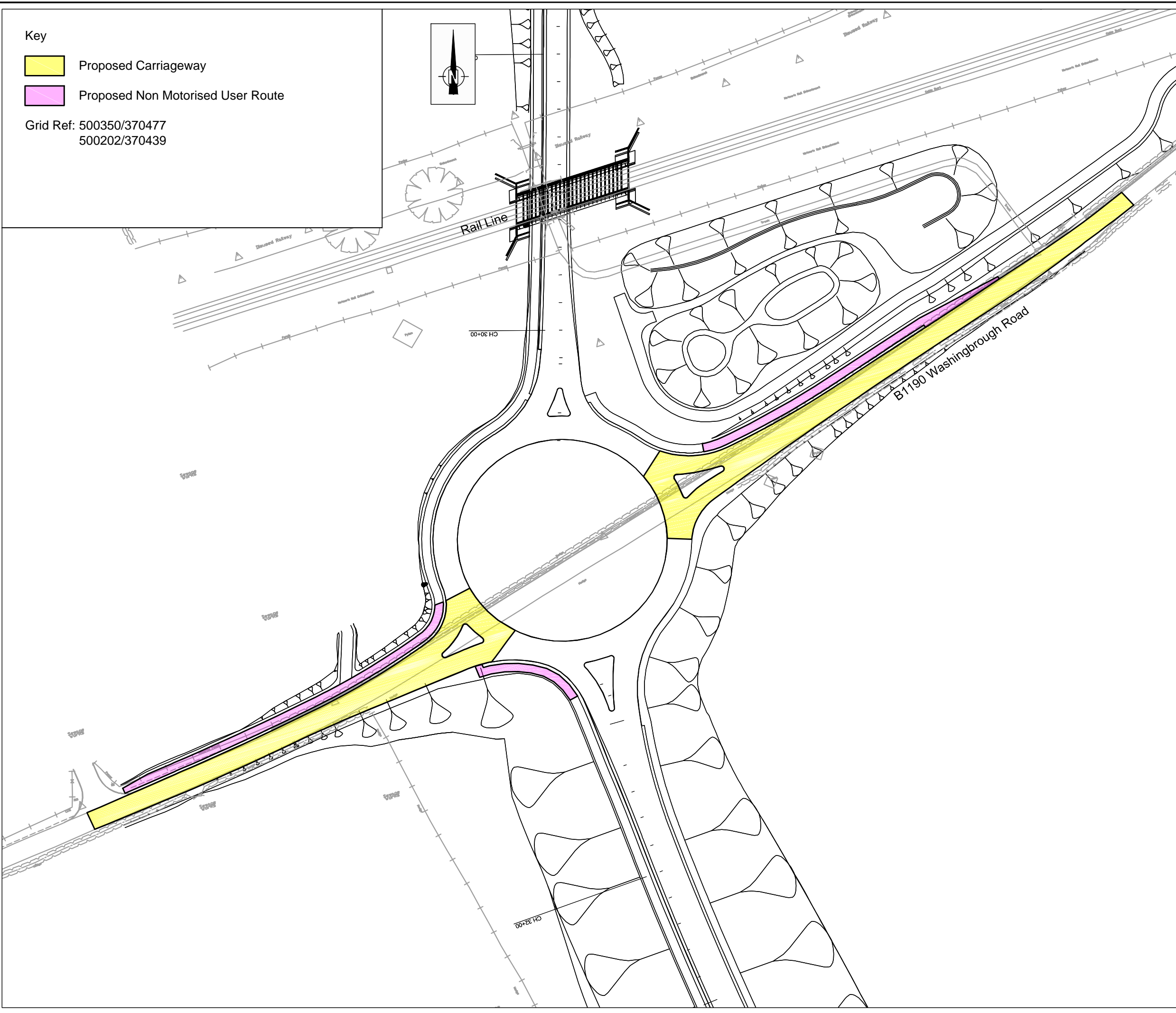

X-Refs & Blocks used in this Drawing
x-Topographical Survey
MX TENDER 2016_2D MX
Raster Base
x- S58 Washingbrough Rd Rbt

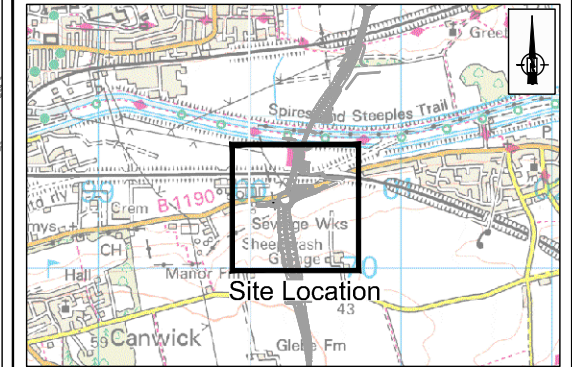

Location Plan
Scale 1:50,000

APPROVED FOR GENERAL ISSUE
(NOT TO BE USED FOR PRICING OR CONSTRUCTION PURPOSES)
FOR THIRD PARTY USE, THIS DRAWING SHALL BE DEEMED
CURRENT ONLY AT THE DATE OF APPROVAL. PLEASE CHECK
FOR AMENDMENTS BEFORE USE

Revision	Description	Drawn By	CAD By	Approved By	Approval Date

Amendment Details

Drawing 1st Approval
1st Approval by: EF | Date: 18/10/18

Drawn/Designed by: EF | CAD Drawing Creation
Created By: DS | Date: 16/10/18

Scale:
(@A3)
Primary: 1:1250
Secondary: 1:100,000 (Do not scale from this drawing)

Lincolnshire COUNTY COUNCIL
Highways Alliance
TECHNICAL SERVICES PARTNERSHIP
CROWN HOUSE
GRANTHAM STREET
LINCOLN
LN2 1BD
Customer Service Centre: (01522) 782070



Drawing Number: **HCMSA0021/ 01 / 9019**
Scheme Reference ID Number Drawing Series No. Revision Number (if applicable)

Alternative Scheme Code: | Road No:

Parish: **LINCOLN**

Structure No: N/A | SCN No: N/A | Site Ref: N/A

Description:
**LINCOLN EASTERN BYPASS
SECTION 58
WASHINGBOROUGH ROAD ROUNDABOUT
Ch30+00 - Ch32+00**

LINCOLNSHIRE COUNTY COUNCIL - Reproduced from Ordnance Survey material with the permission of Ordnance Survey on behalf of the Controller of Her Majesty's Stationery Office © Crown copyright. Unauthorised reproduction infringes Crown copyright and may lead to prosecution or civil proceedings. OS Licence 100025370