

**PART A: Information relating to the applicant and land to which the application relates
(all applicants must complete this Part)**

1. Name of appropriate authority to which the application is addressed:

Lincolnshire County Council

2. Name and full address (including postcode) of applicant:

**The Master Fellows and Scholars of the College of St John the Evangelist in the
University of Cambridge**

c/o Kate Barlow

Savills (UK) Ltd

Unex House

132-134 Hills Road

Cambridge

CB2 8PA

3. Status of applicant (tick relevant box or boxes):

I am

(a) the owner of the land(s) described in paragraph 4.

(b) making this application and the statements/declarations it contains on

behalf of **The Master Fellows and Scholars of the College of St John the Evangelist in the
University of Cambridge**

who is the owner of the land(s) described in paragraph 4 and in my capacity as
managing agent.

4. Insert description of the land(s) to which the application relates (including full
address and postcode):

- Avenue Farm, Dowsdale, Crowland, Peterborough, PE6 0NF
- Willoughby Farm, Swineshead Road, Frampton Fen, Lincs, PE20 1SF
- Land at Holbeach (Poplars Farm) Gould, Cowfold, Spalding, Lincs, PE12 8DP
- Whaplode Lodge Farm, Washway Road, Moulton Seas End, Spalding, PE12 6LP
- Woodbine Lodge, Hulls Drove, Postland, Crowland, Peterborough, PE6 0JX
- Land at Moulton, Eaugate Road, Spalding, PE12 0TA

5. Ordnance Survey six-figure grid reference(s) of a point within the area of land(s) to
which the application relates (if known):

Avenue Farm TF 296 099

Willoughby Farm TF 287 427

Land at Holbeach TF 371 281

Whaplode Lodge Farm TF 329 300

Woodbine Lodge Farm TF 284 121

Land at Moulton TF 297 155

6. This deposit comprises the following statement(s) and/or declarations (*delete
Parts B, C, or D where not applicable*):

PART B: Statement under section 31(6) of the Highways Act 1980

PART D: Statement under section 1SA(1) of the Commons Act 2006

PART B: Statement under section 31(6) of the Highways Act 1980

The Master Fellows and Scholars of the College of St John the Evangelist in the University of Cambridge is the owner of the land described in paragraph 4 of Part A of this form and shown edged red on the map accompanying this statement.

Ways shown purple on the accompanying maps are public footpaths.

No other ways over the land shown red on the accompanying maps have been dedicated as highways.

PART D: Statement under section 15A(1) of the Commons Act 2006

The Master Fellows and Scholars of the College of St John the Evangelist in the University of Cambridge is the owner of the land described in paragraph 4 of Part A of this form and shown edged red on the map accompanying this statement.

The Master Fellows and Scholars of the College of St John the Evangelist in the University of Cambridge wish to bring to an end any period during which persons may have indulged as of right in lawful sports and pastimes on the whole or any part of the land shown edged red on the accompanying map referenced above.

PART E: Additional information relevant to the application

(insert any additional information relevant to the application)

N/A

PART F: Statement of Truth
(all applicants must complete this Part)

WARNING: If you dishonestly enter information or make a statement that you know is, or might be, untrue or misleading, and intend by doing so to make a gain for yourself or another person, or to cause loss or the risk of loss to another person, you may commit the offence of fraud under section 1 of the Fraud Act 2006, the maximum penalty for which is 10 years' imprisonment or an unlimited fine, or both.

I BELIEVE THAT THE FACTS AND MATTERS CONTAINED IN THIS FORM ARE TRUE

Signature (of the person making the statement of truth):

A solid black rectangular box redacting the signature of the person making the statement of truth.

Print full name: Kate Barlow for and on behalf of Savills (UK) Ltd as Agent to The Master Fellows and Scholars of the College of St John the Evangelist in the University of Cambridge

Date: 11 January 2021

You should keep a copy of the completed form

Lincolnshire County Council
19 JAN 2021
Lancaster House

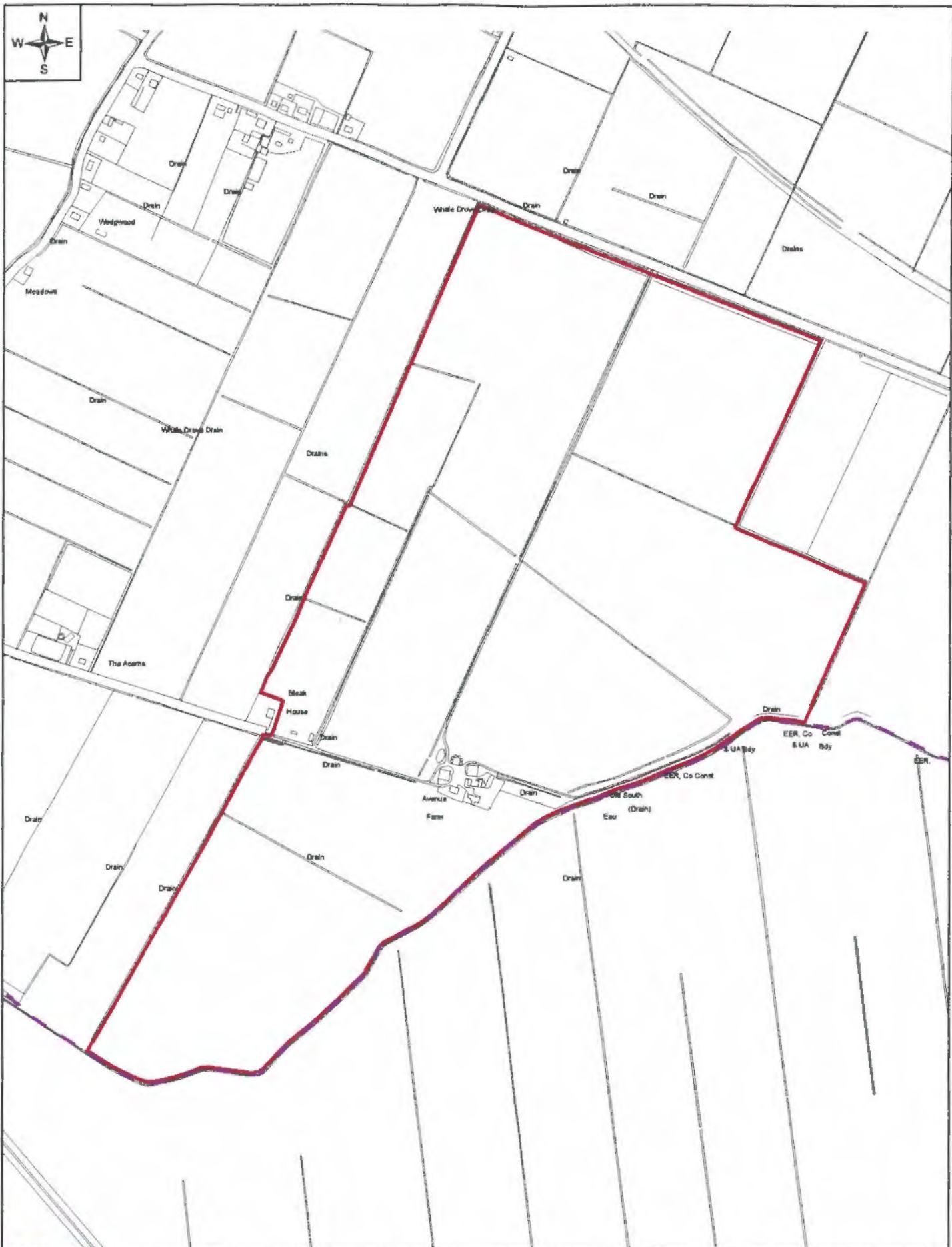



St John's College
Cambridge
CB2 1TP
United Kingdom
Tel: 01223 33860
k.lea@joh.cam.ac.uk

Property No.
844
County:
Lincs

Address:
**Avenue Farm, Dowsdale, Crowland
Section 31 (6)**
Scale: 1:6,000
O.S. Ref: TF=710
Plan No: B.12,555
Date: 06/01/2001

Legend

-  Public Footpath
-  St John's College Ownership

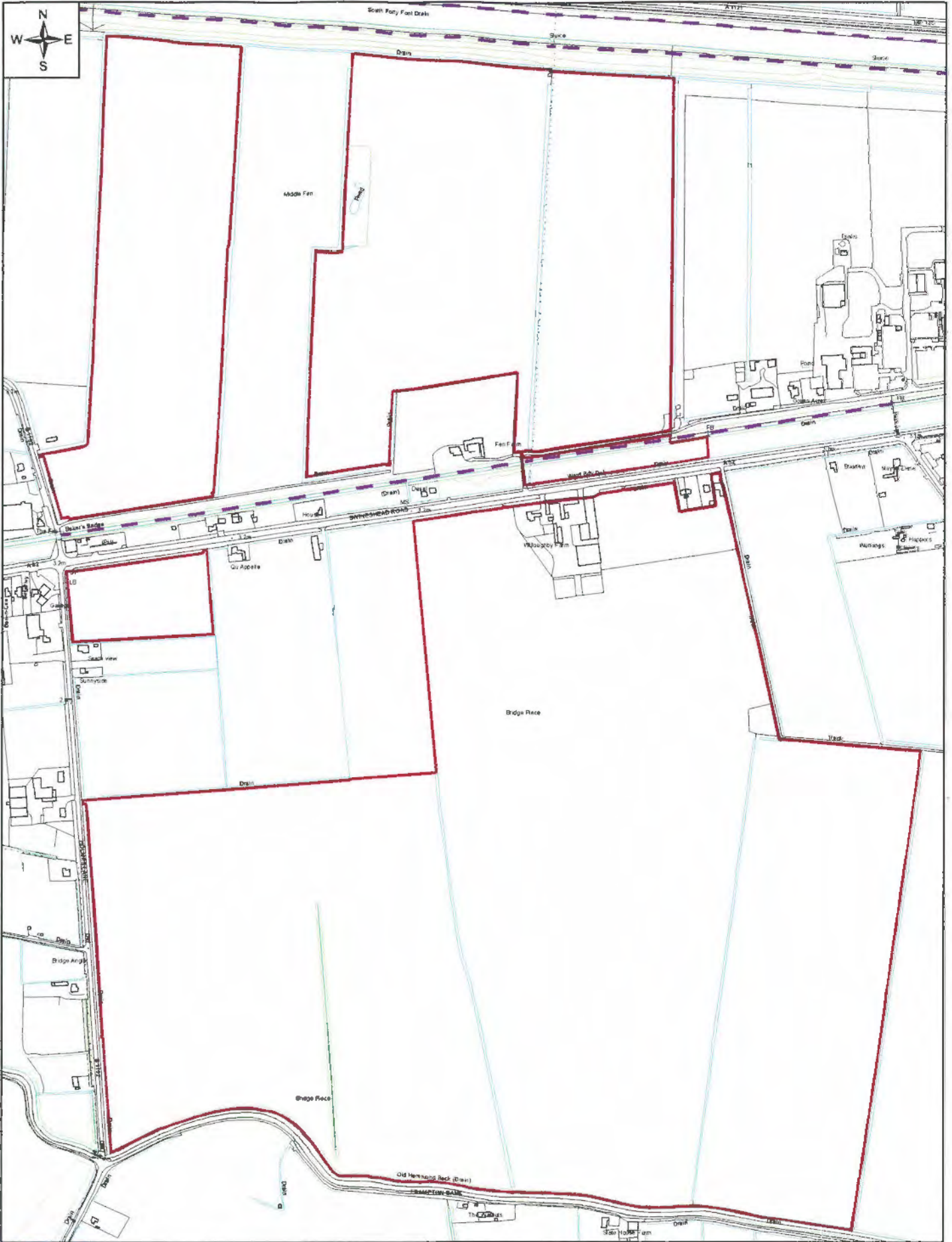

St John's College
Cambridge
CB2 1TP
United Kingdom

Tel: 01223 33860
k.les@joh.cam.ac.uk

Property No.
845

County:
Lincs

Address: **Willoughby Farm, Frampton
Boston
Section 31(6)**

Scale: 1:5,000 G44 O.S. Ref: TF2842 BD Plan No: B12,374s Date: 06/01/2021

Legend
 - - - Public Footpath
 [Red Outline] St John's College Ownership

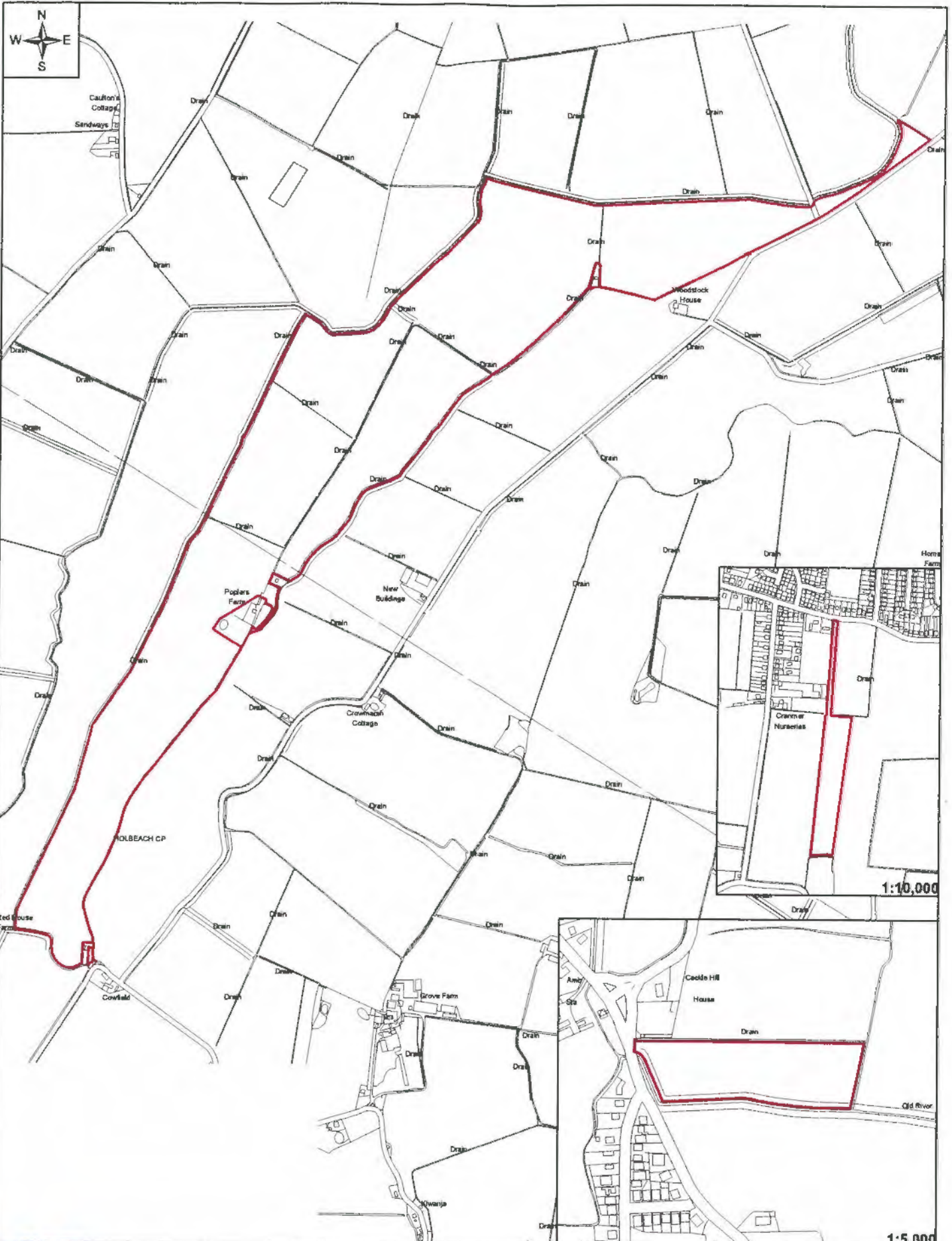

St John's College
Cambridge
CB2 1TP
United Kingdom
Tel: 01223 33860
k.lea@joh.cam.ac.uk

Property No.
846
County:
Lincs

Address:
**Holbeach
Section 31 (6)**
Scale: 1:11,000 O.S. Ref: TF3729 UID Plan No: B.12,553 Date: 06/01/2021

Legend
 St John's College Ownership



St John's College
 Cambridge
 CB2 1TP
 United Kingdom
 Tel: 01223 338600
 E: lee@joh.cam.ac.uk

Property No.
856
 County:
Lincs

Address:
**Whaplode Lodge Farm
 Section 31(6)**
 Scale 1:5,000 ©44 O.S. Ref. TF3330 BD Plan No. B.12,556/4 Date 9/2/2015

Legend

 St John's College Ownership

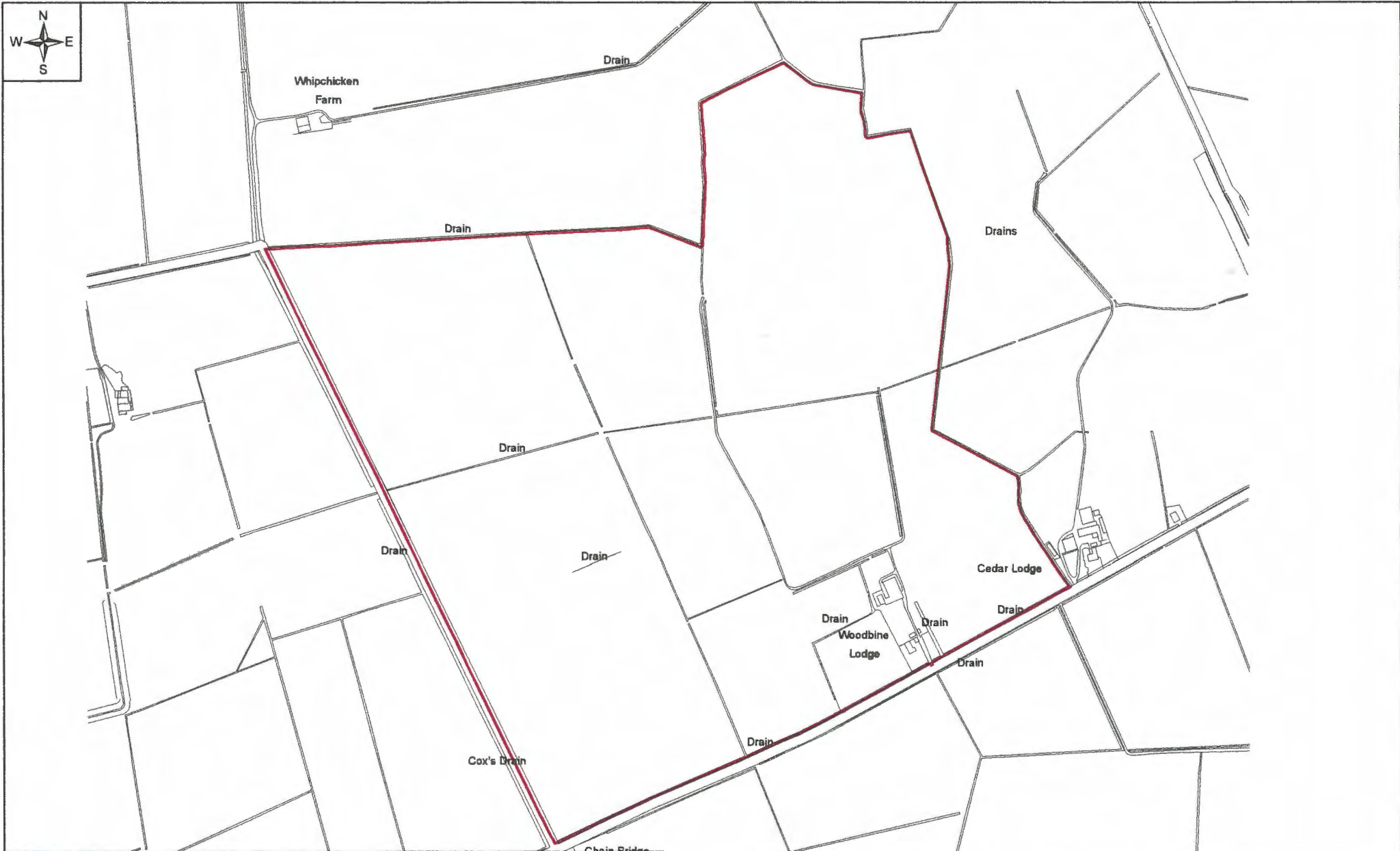

St John's College
Cambridge
CB2 1TP
United Kingdom

Tel: 01223 338600
k.lea@joh.cam.ac.uk

Property No.
859

County:
Lincs

Address: **Woodbine Lodge, Postland
Crowland
Section 31 (6)**

Scale: 1:5,000 @A4 O.S. Ref: TF2812 BID Plan No: E.12,697/5 Date: 08/01/2021

Legend

St John's College Ownership



St John's College
Cambridge
CB2 1TP
United Kingdom

Tel: 01223 338600
k.lea@joh.cam.ac.uk



Property No.
860

County:
Lincs

Address: **Land at South Holland,
Moulton West Fen, Moulton Chapel
Section 31 (6)**

Scale: 1:4,000 @M D.S. Ref: TF2915 BID Plan No. B.12,608a Date 08/01/2021

Legend

-  Public Bridleway
-  St John's College Ownership

**PART A: Information relating to the applicant and land to which the application relates
(all applicants must complete this Part)**

1. Name of appropriate authority to which the application is addressed:
Lincolnshire County Council

2. Name and full address (including postcode) of applicant:
**The Master Fellows and Scholars of the College of St John the Evangelist in the
University of Cambridge
c/c Kate Barlow
Savills (UK) Ltd
Unex House
132-134 Hills Road
Cambridge
CB2 8PA**

3. Status of applicant (tick relevant box or boxes):

I am

(a) the owner of the land(s) described in paragraph 4.

(b) making this application and the statements/declarations it contains on

behalf of **The Master Fellows and Scholars of the College of St John the Evangelist in
the University of Cambridge**

who is the owner of the land(s) described in paragraph 4 and in my capacity as
managing agent.

4. Insert description of the land(s) to which the application relates (including full
address and postcode):

- Avenue Farm, Dowsdale, Crowland, Peterborough, PE6 0NF
- Willoughby Farm, Swineshead Road, Frampton Fen, Lincs, PE20 1SF
- Land at Holbeach (Poplars Farm) Gould, Cowfold, Spalding, Lincs, PE12 8DP
- Whaplode Lodge Farm, Washway Road, Moulton Seas End, Spalding, PE12 6LP
- Woodbine Lodge, Hulls Drove, Postland, Crowland, Peterborough, PE6 0JX
- Land at Moulton, Eaugate Road, Spalding, PE12 0TA

5. Ordnance Survey six-figure grid reference(s) of a point within the area of land(s) to
which the application relates (if known):

Avenue Farm TF 296 099

Willoughby Farm TF 287 427

Land at Holbeach TF 371 281

Whaplode Lodge Farm TF 329 300

Woodbine Lodge Farm TF 284 121

Land at Moulton TF 297 155

6. This deposit comprises the following statement(s) and/or declarations (*delete
Parts B, C, or D where not applicable*):

PART C: Declaration under section 31(6) of the Highways Act 1980

PART C: Declaration under section 31(6) of the Highways Act 1980

1. The Master Fellows and Scholars of the College of St John the Evangelist in the University of Cambridge is the owner of the land described in paragraph 4 of Part A of this form and shown edged red on the map lodged with Lincolnshire County Council on 19th January 2021.

2. On the 19th January 2021, The Master Fellows and Scholars of the College of St John the Evangelist in the University of Cambridge deposited with Lincolnshire County Council, being the appropriate council, a statement accompanied by a map showing The Master Fellows and Scholars of the College of St John the Evangelist in the University of Cambridge's property edged red which stated that:

Ways shown purple on the accompanying maps are public footpaths

No other ways had been dedicated as highways over *The Master Fellows and Scholars of the College of St John the Evangelist in the University of Cambridge's property.*

3. N/A

4. No additional ways have been dedicated over the land edged red on the map accompanying this declaration/referenced in paragraph 1 above since the statement dated 11th January 2021 referred to in paragraph 2 above and at the present time *The Master Fellows and Scholars of the College of St John the Evangelist in the University of Cambridge* have no intention of dedicating any more public rights of way over the property.

PART E: Additional information relevant to the application

(insert any additional information relevant to the application)

N/A

PART F: Statement of Truth
(all applicants must complete this Part)

WARNING: If you dishonestly enter information or make a statement that you know is, or might be, untrue or misleading, and intend by doing so to make a gain for yourself or another person, or to cause loss or the risk of loss to another person, you may commit the offence of fraud under section 1 of the Fraud Act 2006, the maximum penalty for which is 10 years' imprisonment or an unlimited fine, or both.

I BELIEVE THAT THE FACTS AND MATTERS CONTAINED IN THIS FORM ARE TRUE

Signature (of the person making the statement of truth):



Print full name: Kate Barlow for and on behalf of Savills (UK) Ltd as Agent to The Master Fellows and Scholars of the College of St John the Evangelist in the University of Cambridge

Date: 11 February 2021.

You should keep a copy of the completed form

