

**DEPOSIT OF STATEMENT AND PLAN**

**SECTION 31 (6) OF THE HIGHWAYS ACT 1980**

**To: Director of Highways and Planning  
Lincolnshire County Council  
Council Offices  
Newland  
Lincoln LN1 1YL**

- 1 I am a Chartered Surveyor and a Fellow of the Royal Institution of Chartered Surveyors. I am a partner in the firm Jas. Martin & Co., and I am a Trustee of G H Battle 1992 Settlement which owns land.
- 2 The aforementioned land lies in the Parish of Potterhanworth as shown edged red on the plan ("the plan") attached hereto and has been in the Trusts ownership since 1992.
- 3 The ways coloured brown on the said map have been dedicated as highways with vehicular status.
- 4 The ways coloured purple on the said map have been dedicated as footpaths.
- 5 No other ways over the land have been dedicated as highways.
- 6 The deposit shall comprise this statement, schedule attached and accompanying map.

SIGNED as a DEED by )  
**ROBIN MAXWELL BATTLE** )  
in the presence of:- )



Signature of witness: .....  .....

Name of witness: ..... T. J. ANDERSON .....

Address: ..... 8 Bank St .....

..... Lincoln .....

Occupation: ..... Chartered Surveyor .....

Dated this ..... 5<sup>th</sup> ..... day of August ..... 2008

**SCHEDULE OF HIGHWAYS (WITH TERMINI)**

**Parish of Potterhanworth**

PF8 runs across part of the farmyard in a north westerly direction from TF0541 6632 to TF0534 6632 where it meets the public highway.

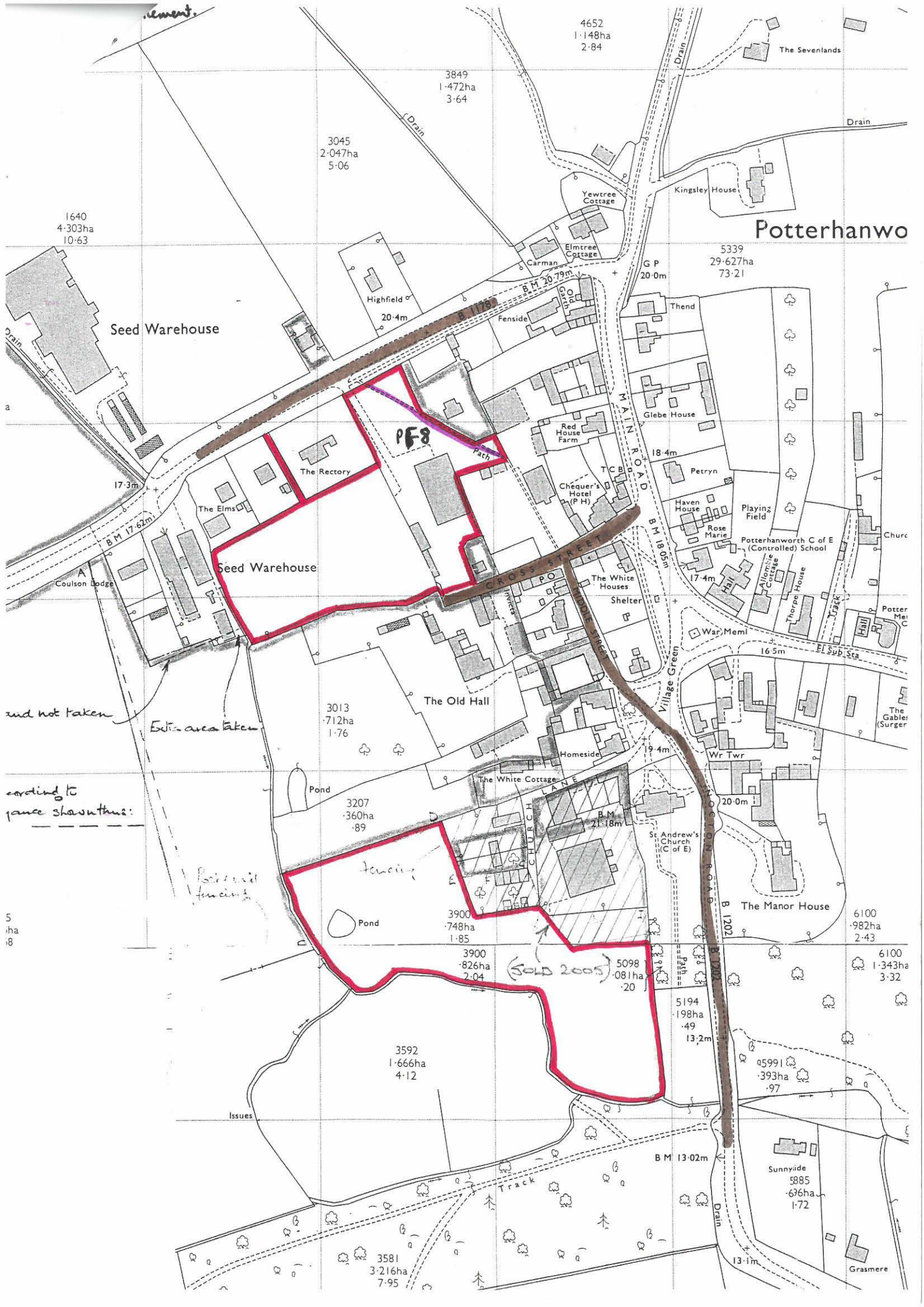

Potterhanwo

Seed Warehouse

Seed Warehouse

The Old Hall

The Manor House

PF8

SOLD 2005

and not taken

Extra area taken

according to fence shown thus:

fencing

1640  
4-303ha  
10-63

3045  
2-047ha  
5-06

3849  
1-472ha  
3-64

4652  
1-148ha  
2-84

5339  
29-627ha  
73-21

3013  
712ha  
1-76

3207  
360ha  
89

3900  
748ha  
1-85

3900  
826ha  
2-04

3592  
1-666ha  
4-12

3581  
3-216ha  
7-95

5194  
198ha  
49

5991  
393ha  
97

5885  
676ha  
1-72

6100  
982ha  
2-43

6100  
1-343ha  
3-32

5  
1ha  
18

Issues

Track

B M 13-02m

B M 13-1m

Grasmere

a

A

and

according

5

1ha

18

Issues

Track

B M 13-02m

B M 13-1m

Grasmere

a

A

and

according

5

1ha

18



**STATUTORY DECLARATION**

**SECTION 31(6) OF THE HIGHWAYS ACT 1980  
(as amended by the Countryside and Rights of Way Act 2000)**

I **ROBIN MAXWELL BATTLE** DO SOLEMNLY AND SINCERELY DECLARE as follows:

- 1 I am and have been since **1992 a Trustee of the G H Battle 1992 Settlement**. The Trustees are the owners of the land known as **The Battle Family Land** more particularly delineated on the map accompanying this declaration and thereon edged red as is now produced and shown to me and marked "RMB1".
- 2 On the **8th** day of **August 2008** I deposited with **Lincolnshire County Council**, being the appropriate Council, a statement accompanied by a map delineating the **Trustees' property** by red edging which stated that **the ways coloured brown on the said map and on the map accompanying this declaration had been dedicated as highways with vehicular status the ways coloured purple on the said map and on the map accompanying this declaration had been dedicated as footpaths and no other ways had been dedicated as highways over the Trustees' property.**
- 3 No additional ways have been dedicated over the land edged red on the map accompanying this declaration since the statement dated **8th August 2008** referred to in 2 above and at the present time **The Trustees** have no intention of dedicating any more public rights of way over **their** property.

AND I MAKE this solemn declaration on the 31st day of October 2008, conscientiously believing it to be true and by virtue of the Statutory Declarations Act 1835.

Declared at [address] ..... Bank Street  
..... Lincoln

Signature of landowner .....   
.....  
ROBIN MAXWELL BATTLE

Before me ...   
.....  
[Commissioner for Oaths or a Justice of the Peace or Solicitor]  
LATHERINE ELIZABETH HARRIS

This is the plan marked "RMB1" referred to in the annexed declaration of  
[... Robin Maxwell Battle .....] declared this  
day of 31st October 2008.

Before me .....  .....



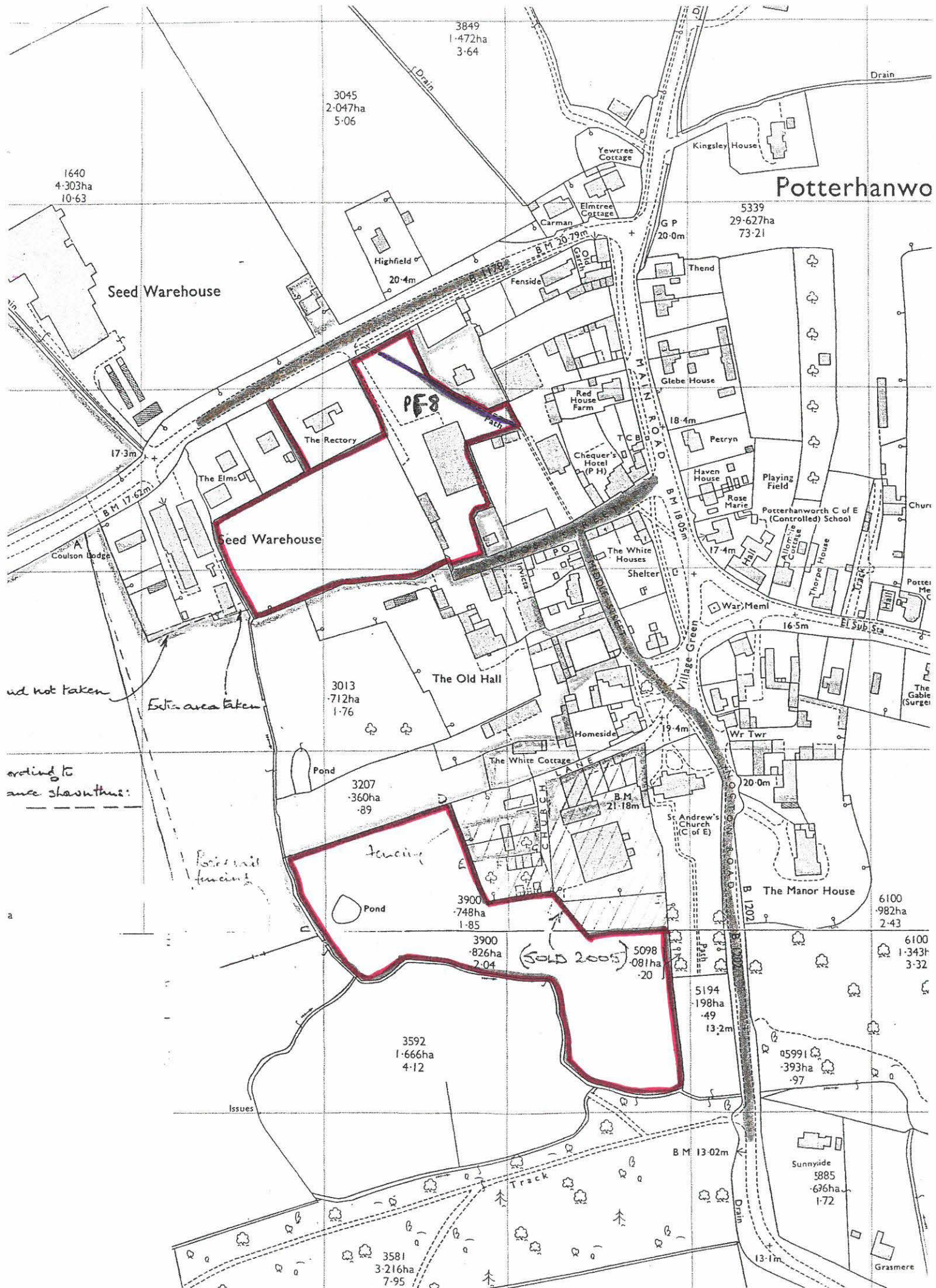

ud not taken

Belt area taken

noting to area shown thus:

Side with fencing

(SOLD 2005)

# Potterhanwoth

Seed Warehouse

Seed Warehouse

The Old Hall

The Manor House

Sunnyide

3849  
1.472ha  
3.64

3045  
2.047ha  
5.06

1640  
4.303ha  
10.63

5339  
29.627ha  
73.21

3013  
7.12ha  
1.76

3207  
3.360ha  
.89

3900  
7.748ha  
1.85

3900  
8.826ha  
2.04

3592  
1.666ha  
4.12

3581  
3.216ha  
7.95

5098  
.081ha  
.20

5194  
1.198ha  
.49

55991  
3.393ha  
.97

6100  
1.982ha  
2.43

6100  
1.343ha  
3.32

5885  
1.666ha  
1.72

17.3m

B.M. 17.62m

17.3m

17.3m

17.3m

17.3m

17.3m

17.3m

17.3m

17.3m

17.3m

20.4m

20.4m

20.4m

20.4m

20.4m

20.4m

20.4m

20.4m

B.M. 20.79m

B.M. 20.79m

B.M. 20.79m

B.M. 20.79m

B.M. 20.79m

B.M. 20.79m

B.M. 20.79m

B.M. 20.79m

G.P. 20.0m

G.P. 20.0m

G.P. 20.0m

G.P. 20.0m

G.P. 20.0m

G.P. 20.0m

G.P. 20.0m

G.P. 20.0m

18.4m

17.4m

19.4m

20.0m

13.2m

B.M. 13.02m

13.1m

16.5m

16.5m

16.5m

16.5m

16.5m

Drain

Drain

Drain

Drain

Drain

Drain

Drain

Drain

Drain

Drain

Drain

Drain

Drain

Drain

Drain

Drain

Drain

Drain

Drain

Drain

Drain

Drain

Drain

Drain

Drain

Drain

Drain

Drain

Drain

Drain

Drain

Drain

Drain

Drain

Drain

Drain

Drain

Drain

Drain

Drain

Drain

Drain

Drain

Drain

Drain

Drain

Drain

Drain

Drain

Drain

Drain

Drain

Drain

Drain

Drain

Drain

Drain

Drain

Drain

Drain

Drain

Drain

Drain

Drain

Drain

Drain

Drain

Drain

Drain

Drain

Drain

Drain

Drain

Drain

Drain

Drain

Drain

Drain

Drain

Drain

Drain

Drain

Drain

Drain

Drain

Drain

Drain

Drain

Drain

Drain

Drain

Drain

Drain

Drain

Drain

Drain

Drain

Drain

Drain

Drain

Drain

Drain

Drain

Drain

Drain

Drain

Drain

Drain

Drain

Drain

Drain

Drain

Drain

Drain

Drain

Drain

Drain

Drain

Drain

Drain

Drain

Drain

Drain

Drain

Drain

Drain

Drain

Drain

Drain

Drain

Drain

Drain

Drain

Drain

Drain

Drain

Drain

Drain

Drain

Drain

Drain

Drain

Drain

Drain

Drain

Drain

Drain

Drain

Drain

Drain

Drain

Drain

Drain

Drain

Drain

Drain

Drain

Drain

Drain

Drain

Drain

Drain

Drain

Drain

Drain

Drain

Drain

Drain

Drain

Drain

Drain

Drain

Drain

Drain

Drain

Drain

Drain

Drain

Drain

Drain

Drain

Drain

Drain

Drain

Drain

Drain

Drain

Drain

Drain

Drain

Drain

Drain

Drain

Drain

Drain

Drain

Drain

Drain

Drain

Drain

Drain

Drain

Drain

Drain

Drain

Drain

Drain

Drain

Drain

Drain

Drain

Drain

Drain

Drain

Drain

Drain

Drain

Drain

Drain

Drain

Drain

Drain

Drain

Drain

Drain

Drain

Drain