

# **PUBLIC NOTICE**

## **LINCOLNSHIRE COUNTY COUNCIL (LINCOLN, BOSTON, GRANTHAM & SLEAFORD – VARIOUS ROADS) (PROHIBITION OF WAITING) EXPERIMENTAL AMENDMENT ORDER 2018**

NOTICE IS HEREBY GIVEN that the Lincolnshire County Council has made an Order under their powers contained in the Road Traffic Regulation Act 1984, the effect of which will be to impose an Experimental Order as set out in the Schedule below.

The Order will come into operation on **10 September 2018** and a copy of the proposed Order and a plan showing the lengths of road concerned with a Statement of Reasons may be inspected at the address given below and the offices of the relevant District Council, during normal office hours.

Representations or objections to the proposals, together with the grounds on which they are made, must be sent in writing to R A Wills - Executive Director (Environment & Economy), Lincolnshire County Council, Lancaster House, 36 Orchard Street, Lincoln, LN1 1XX, (For the attention of: Mrs T Featherstone, Traffic Orders Section) by **10 March 2019**. Details are also available on our website: [www.lincolnshire.gov.uk/transport-and-roads/parking](http://www.lincolnshire.gov.uk/transport-and-roads/parking)

Lincolnshire County Council will be considering in due course whether the provisions of the Order should continue in force indefinitely together with any representations or objections received.

Any person who desires to question the validity of the Order or of any provision contained therein on the grounds that it is not within the powers conferred by the Road Traffic Regulation Act 1984, or on the grounds that any requirement of the Act or of any instrument made under it has not been complied with in relation to the Order may within 6 weeks after 7 September 2018 make application to the High Court for this purpose.

### **Schedule 1 – Mandatory School Keep Clear Monday to Friday**

#### **Lincoln**

Shannon Avenue in the vicinity of The Priory Witham Academy between 8.15am & 3.45pm

Bristol Drive – in the vicinity of Sir Francis Hill School between 8.30am & 4pm

Kingsdown Road in the vicinity of Lesley Manser School and Kingsdown Nursery between 8am & 4pm

#### **Grantham**

Castlegate – in the vicinity of National School between 8am & 9am and 3pm & 4pm

#### **Boston**

Wyberton Low Road

In the vicinity of St Thomas's School between 8am & 4pm. Please note: additional No Waiting 8am to 4pm restrictions will apply to the north and south of the school markings

### **Schedule 2**

#### **Mandatory School Keep Clear & Bus Stands 8am & 4pm Monday to Friday**

#### **Boston**

Sussex Avenue in the vicinity of Boston West School

#### **Sleaford**

Eastgate in the vicinity of William Alvey School



<p>© Crown copyright. All rights reserved.          Lincolnshire County Council          License No. 100025279 2017</p>		<p>SCALE 1 : 800</p>
<p>Lincolnshire COUNTY COUNCIL</p>		<p>DATE 2/8/2018</p>
<p>Lincoln - Bristol Drive</p>		<p>DRAWING NO. D / 142020</p>
<p>Page 1 of 1</p>		<p>DRAWN BY TF</p>

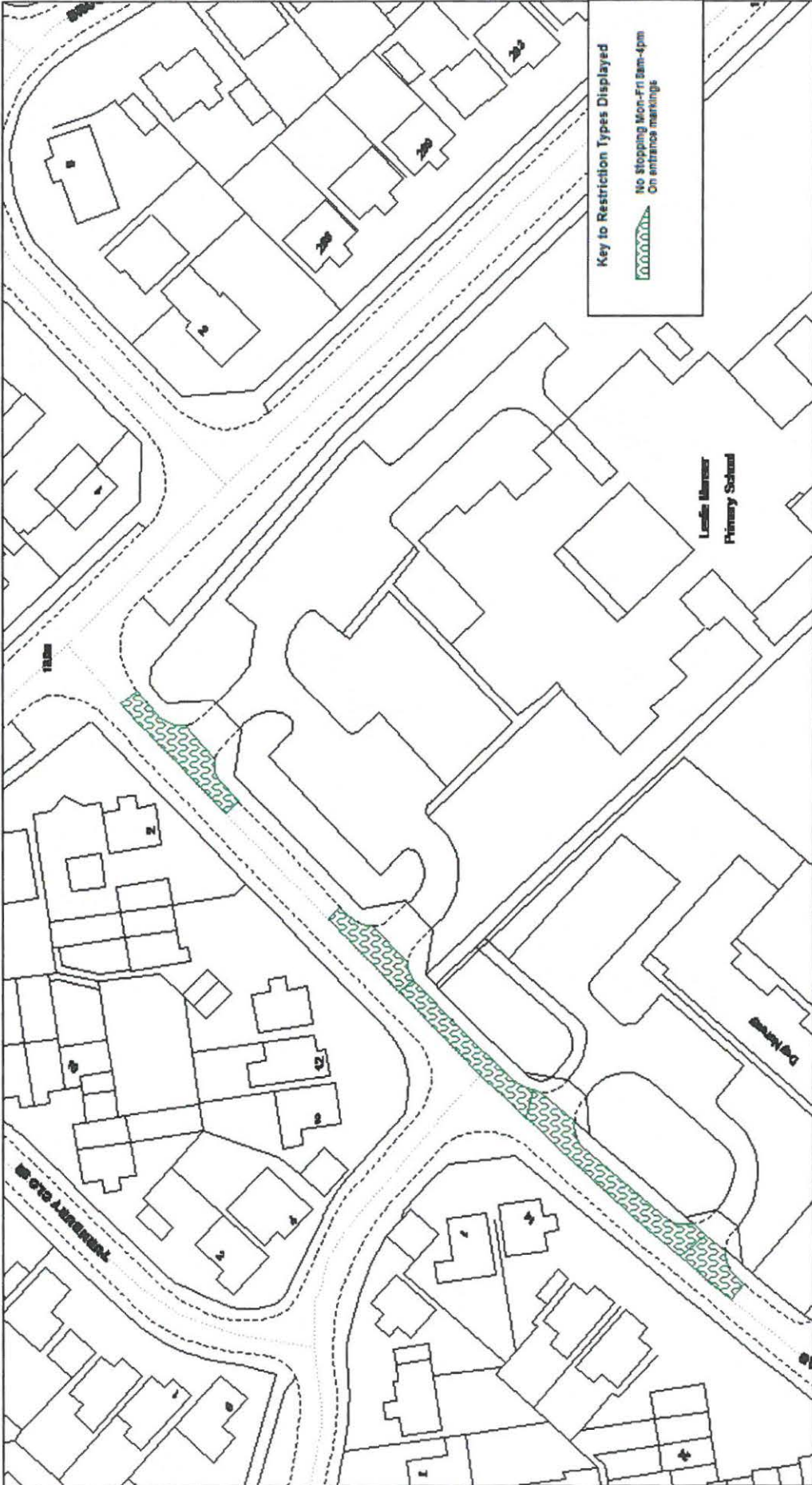

<p>© Crown copyright. All rights reserved          Lincolnshire County Council          License No. 100025010 2017</p>		<p>SCALE 1 : 800</p>
<p>Lincoln - Kingsdown Road</p>		<p>DATE 2/8/2018</p>
<p>Page 1 of 1</p>		<p>DRAWING No. D / 142021</p>
		<p>DRAWN BY TF</p>



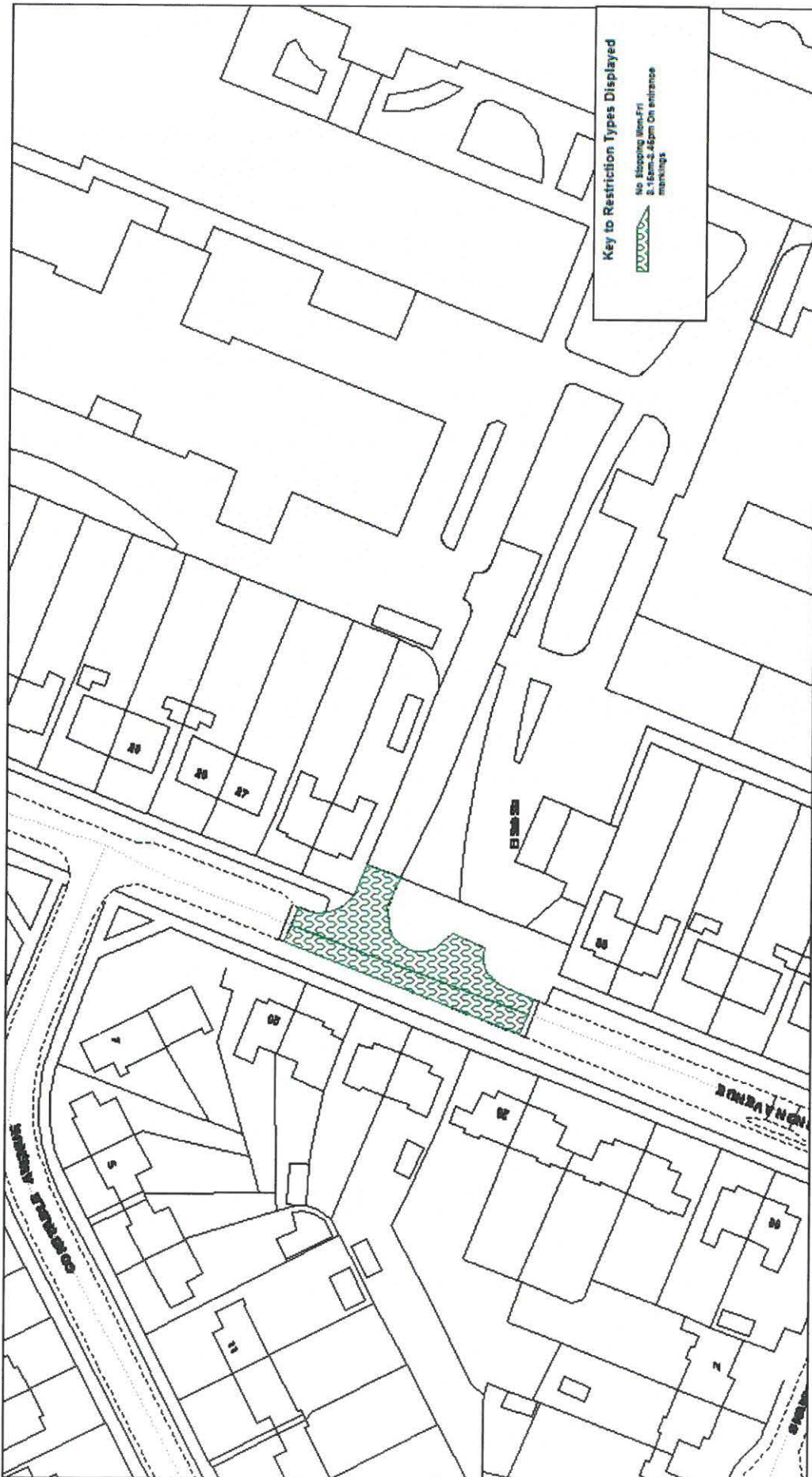

<p>© Crown Copyright. All rights reserved          Lincolnshire County Council          License No. 100005170 2017</p>		<p>SCALE  <b>1 : 800</b></p>
<p>Lincoln - Shannon Avenue</p>		<p>DATE  <b>2/8/2018</b></p>
<p>Page  <b>1 of 1</b></p>		<p>DRAWING No.  <b>D / 142022</b></p>
		<p>DRAWN BY  <b>TF</b></p>

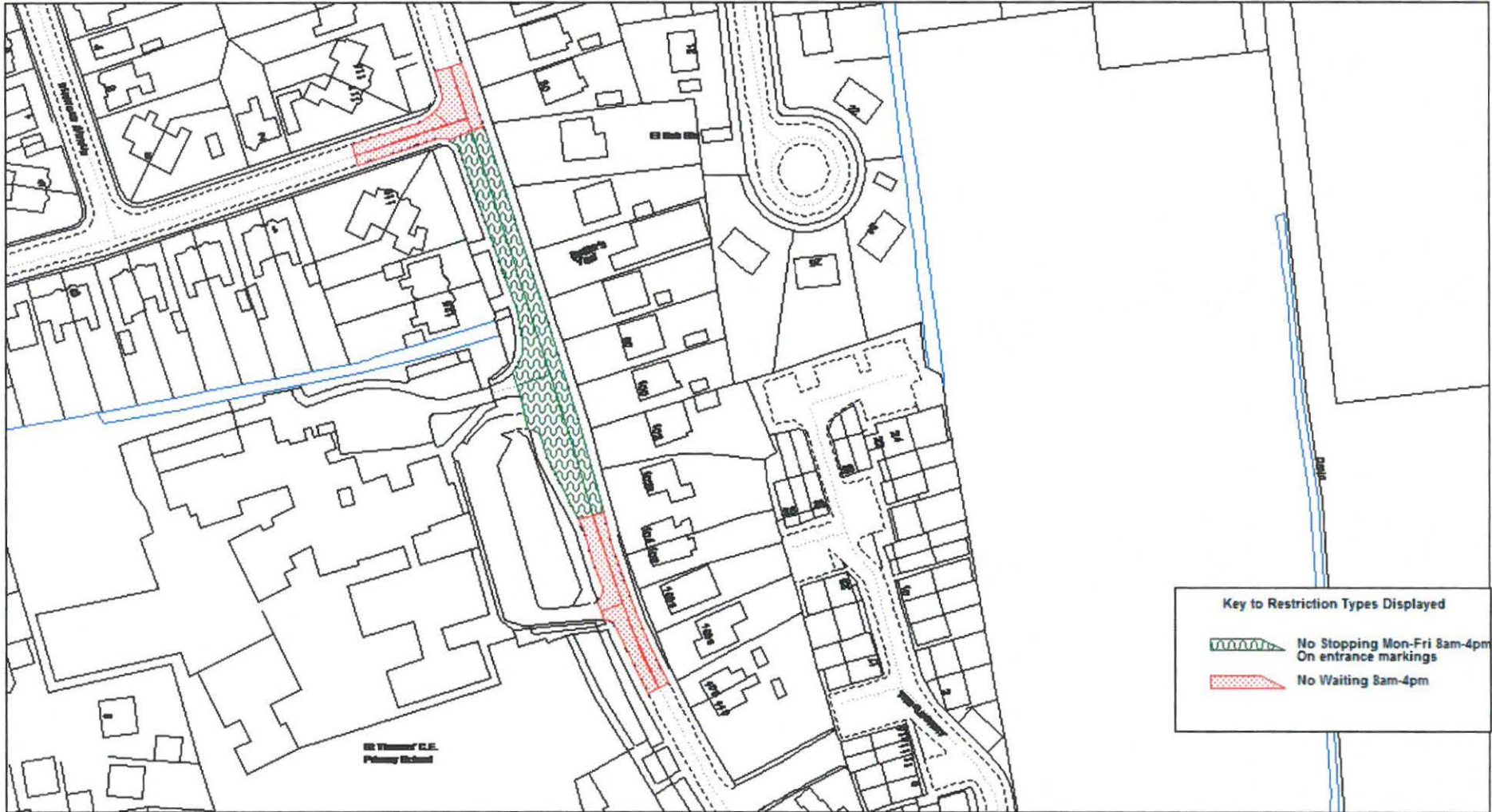

St Vincent's C.E.  
Primary School



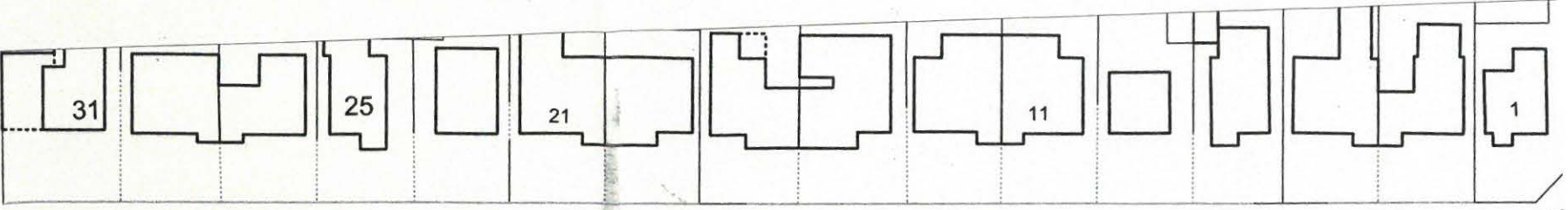

SCALE	1 : 1250
DATE	2/8/2018
DRAWING No.	D /142018
DRAWN BY	TF

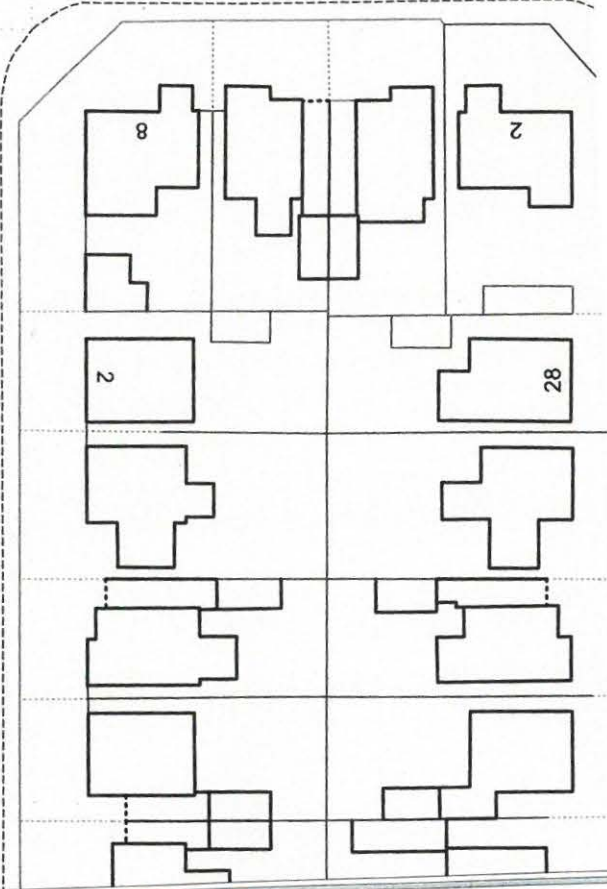
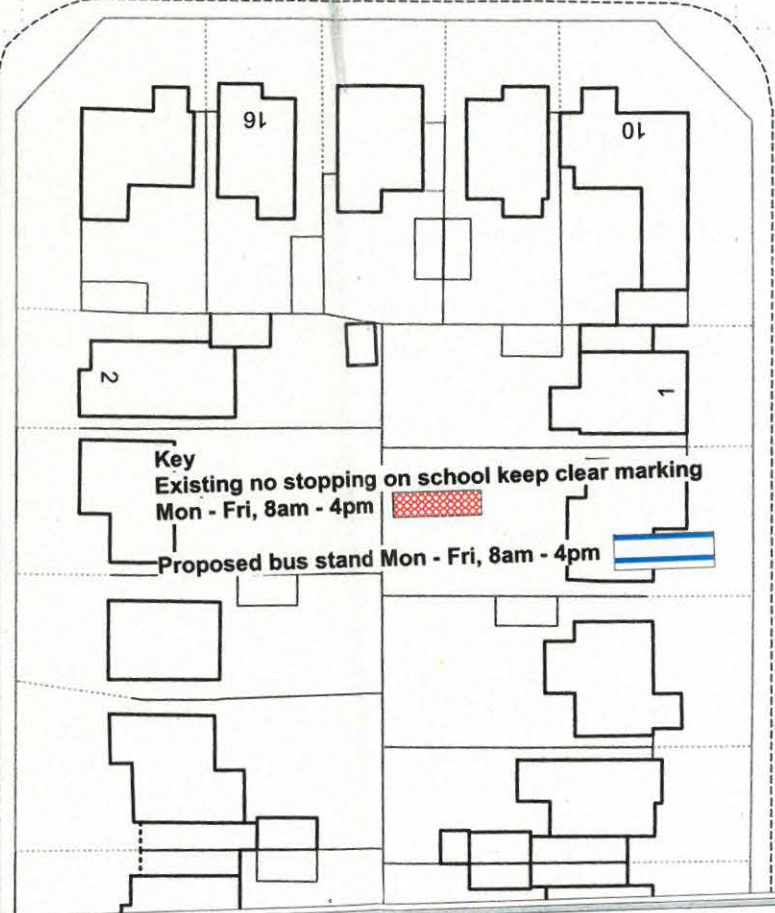
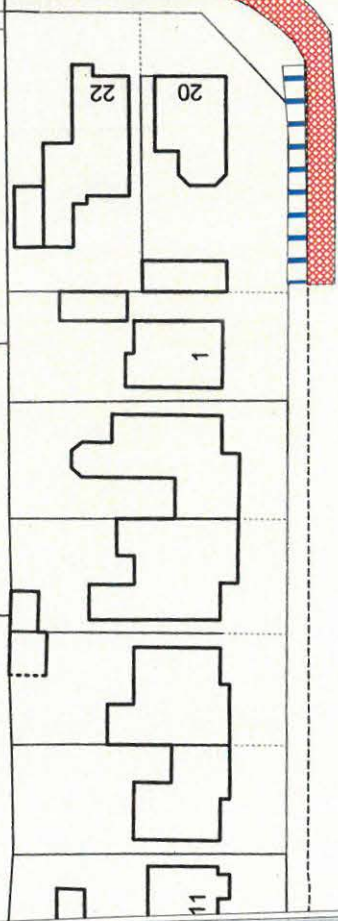
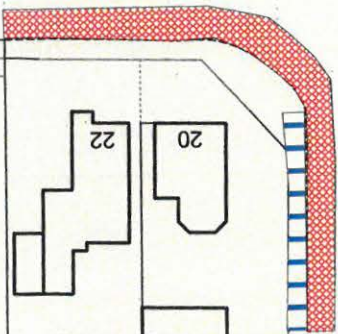

SUSSEX AVENUE



**Key**  
 Existing no stopping on school keep clear marking  
 Mon - Fri, 8am - 4pm   
 Proposed bus stand Mon - Fri, 8am - 4pm 

**Lincolnshire**  
 COUNTY COUNCIL  
*Working for a better future*

**Environment & Economy**  
**Lincolnshire County Council**  
 Director: Richard Wills

LINCOLNSHIRE COUNTY COUNCIL  
 Reproduced from the OS Mapping with the permission  
 of the Controller of Her Majesty's Stationery Office (C) Crown  
 Copyright. Unauthorised reproduction infringes Crown  
 Copyright and may lead to civil proceedings.  
 OS LICENCE 100025370

**Sussex Avenue, Boston**  
**Amendments to school keep clear marking**  
**Proposed Bus Stand Mon - Fri, 8am - 4pm**  
 Drg. No. D/142016

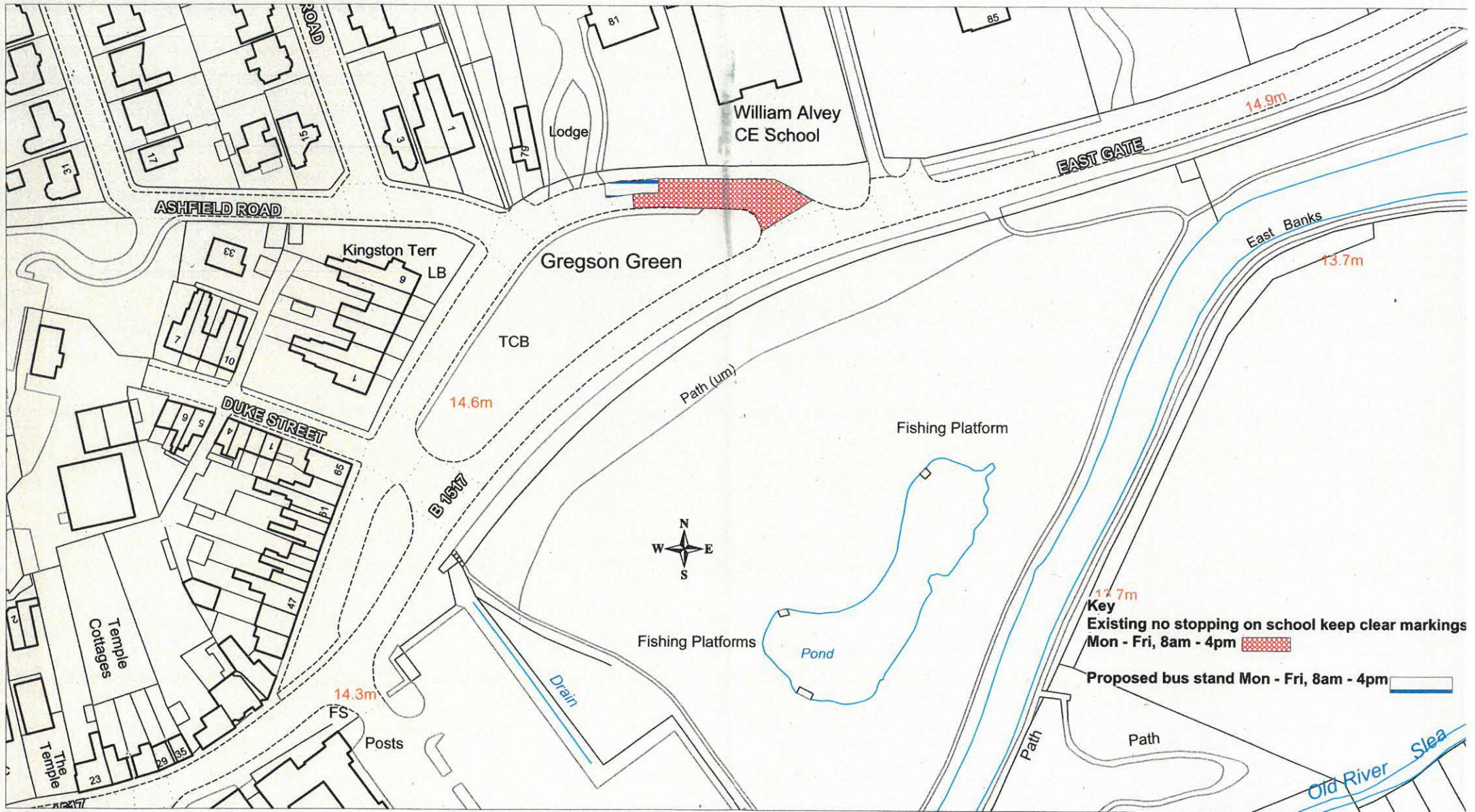

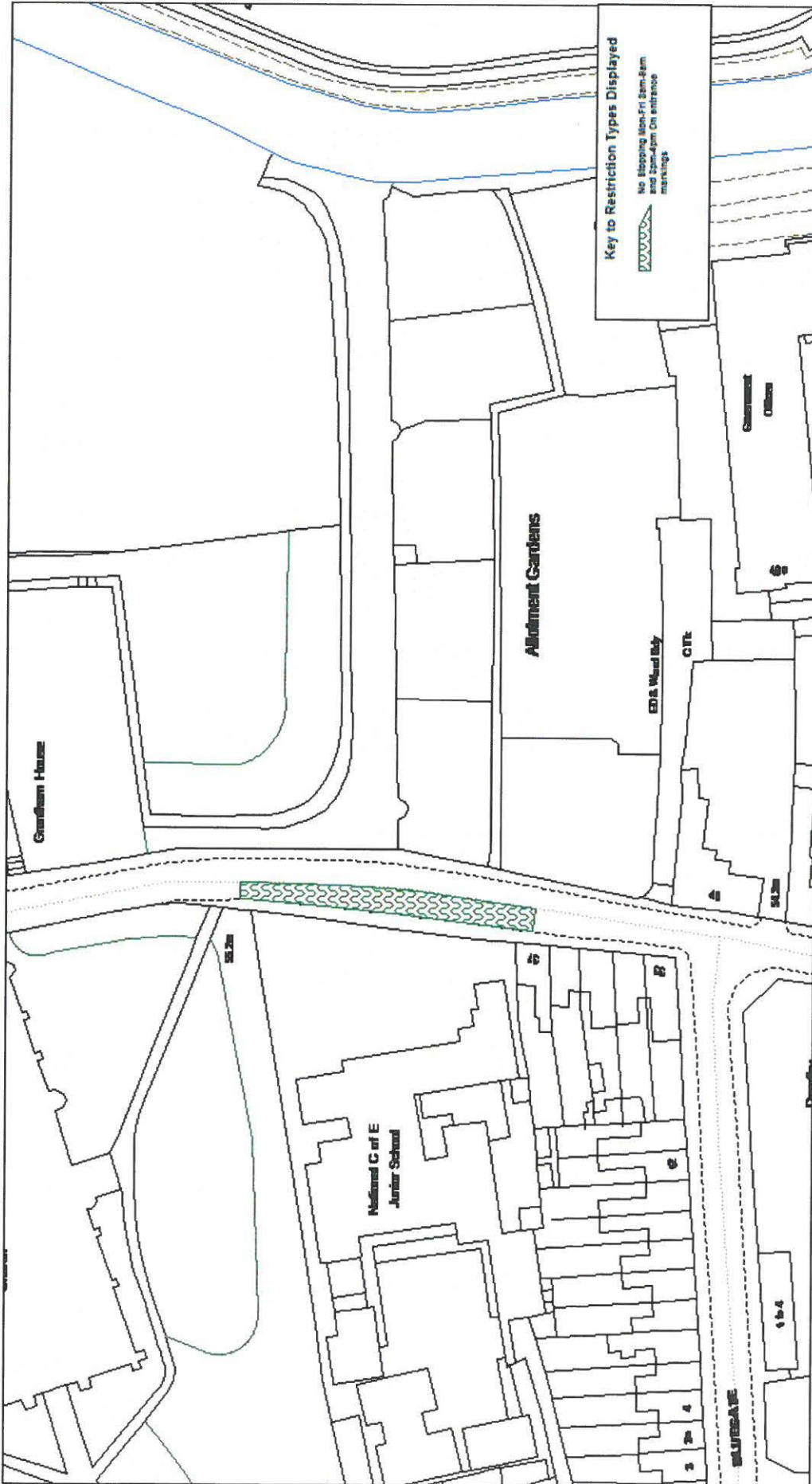

SCALE	1 : 500
DATE	2/8/2018
DRAWING No.	D / 142019
DRAWN BY	TF

© Crown copyright. All rights reserved.  
 Lincolnshire County Council  
 License No. 100023079 2017

Grandham - Castlegate

Page  
1 of 1

**Lincolnshire**  
COUNTY COUNCIL



**LINCOLNSHIRE COUNTY COUNCIL**  
**(LINCOLN, BOSTON, GRANTHAM & SLEAFORD – VARIOUS ROADS)**  
**(PROHIBITION OF WAITING) EXPERIMENTAL AMENDMENT ORDER 20**

**STATEMENT OF REASONS**

- Following investigations at the above mentioned locations it was found that during peak school drop off/pick up times vehicles are parked/waiting on the advisory 'School Keep Clear' markings.
- The introduction of a formal Traffic Regulation Order will hopefully discourage parking/waiting on the school keep clear markings and enable civil parking enforcement officers to issue Penalty Charge Notices where appropriate.
- The revised experimental order has made provisions for bus stands at two of the locations.
- The proposals will facilitate traffic flow, ensure all accesses are kept clear and improve visibility and road safety for all users.
- Therefore, in accordance with the County Council's Policy, it is proposed to prohibit waiting as set out on the Plans to the Order.
- The Chief Constable, Parish Councils and District Councils have been consulted, along with other local groups/companies.