

Parish: Waddingham
Title: Land known as part Holmes Farm, Waddingham
Reference number: CA/7/1/398

**DEPOSIT OF MAP AND STATEMENT AND STATUTORY DECLARATION(S) UNDER
HIGHWAYS ACT 1980, SECTION 31(6) AND COMMONS ACT 2006, SECTION 15A(1)**

Geographic Location

Grid Reference: TF006978

**Address and postcode
of buildings on the
deposited land**

District West Lindsey

Nearest city or town Scunthorpe

Highways Act 1980, Section 31(6) deposits

**Date of deposit of map
and statement** 22.04.2014

**Depositor's name and
address** Mr R Day: The Manor, Redbourne, Gainsborough, DN21 4QT; Mr C Day, The
Manor House, Manton, Kirton Lindsey, Gainsborough, DN21 4JT; J. Owen Day
Ltd. Southfield Office, Redbourne, Gainsborough, DN21 4QR

**Date of deposit of
declaration, name and
address of depositor** (1) 20.05.2014: Mr R Day: The Manor, Redbourne, Gainsborough, DN21 4QT;
Mr C Day, The Manor House, Manton, Kirton Lindsey, Gainsborough, DN21
4JT; J. Owen Day Ltd. Southfield Office, Redbourne, Gainsborough, DN21
4QR

Date deposit expires: 19.05.2034

Commons Act 2006, Section 15A(1)

**Date of deposit of map
and statement, name
and address of
depositor** (1) 22.04.2014: Mr R Day: The Manor, Redbourne, Gainsborough, DN21 4QT;
Mr C Day, The Manor House, Manton, Kirton Lindsey, Gainsborough, DN21
4JT; J. Owen Day Ltd. Southfield Office, Redbourne, Gainsborough, DN21
4QR
[combined deposit]

COUNTY COUNCIL'S CONTACT DETAILS

Officer and Section: Definitive Map Officer, Public Rights of Way and Countryside Access

Address: Lincolnshire County Council, Communities, 4th Floor, City Hall, Lincoln, LN1
1DN

Telephone: 01522 782070

Email: countryside_access@lincolnshire.gov.uk

REGISTER OF DEPOSITS

The County Council is required by law to keep a register of maps and statements and declarations deposited under Section 31(6) of the Highways Act 1980 and Section 15A(1) of the Commons Act 2006 available for public inspection on its website and in a paper copy format together with the deposited documents. Details including names, addresses and the location of land relating to a deposit which may be considered to be personal information are therefore in the public domain. This requirement overrides any entitlement a depositor may otherwise have under the Data Protection Act 1998 to prevent publication of such information. The paper copy of the register together with the deposited documents can be viewed by appointment during normal office hours (9:00am to 4:30pm, Monday to Friday) at the County Council's Public Rights of Way and Countryside Section at the above address.

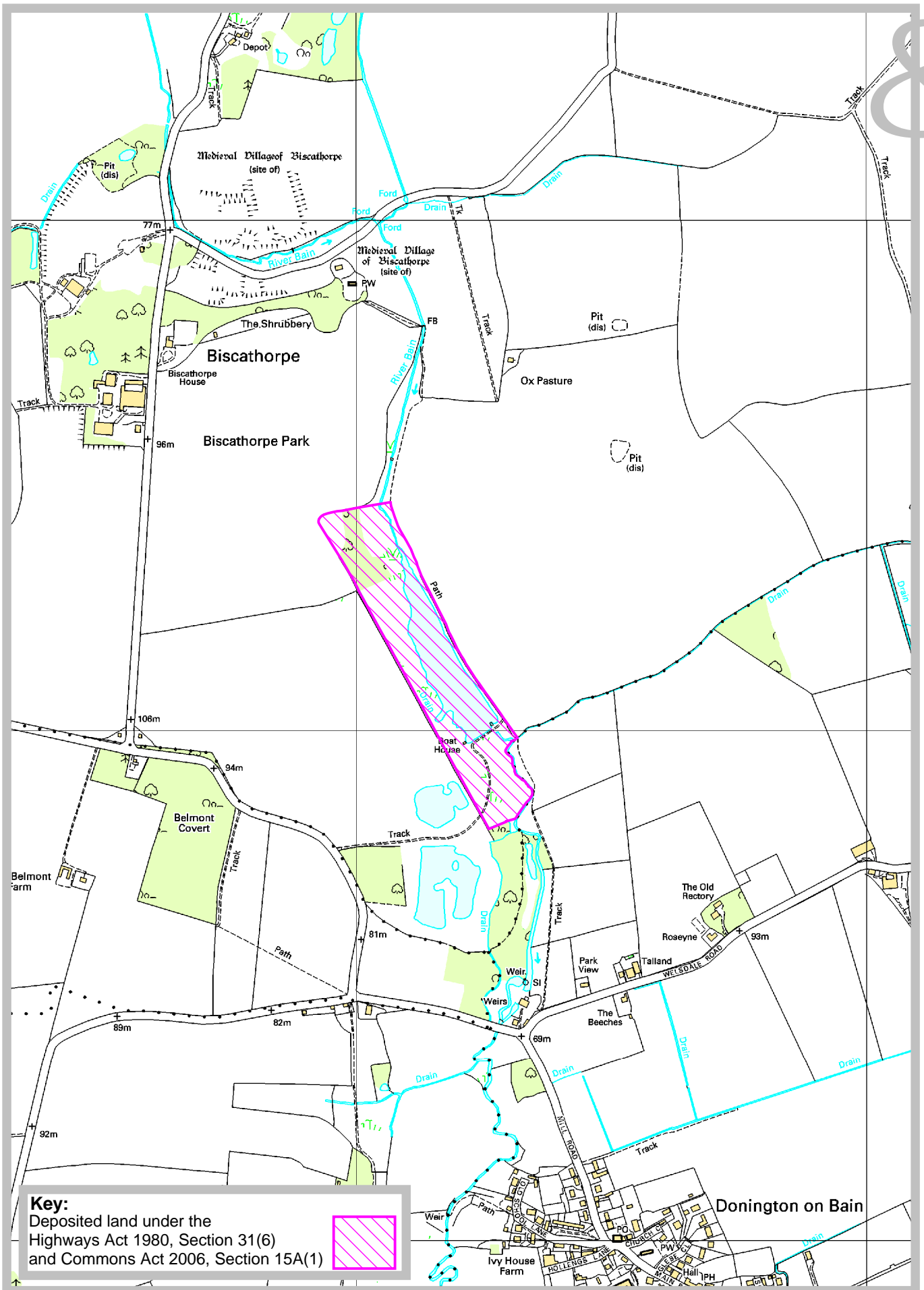

Key:
 Deposited land under the
 Highways Act 1980, Section 31(6)
 and Commons Act 2006, Section 15A(1)

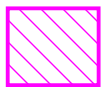

BISCATHORPE

This form has been reproduced from Schedule 1 of 'Statutory Instrument 2013 No. 1774 The Commons (Registration of Town or Village Greens) and Dedicated Highways (Landowner Statements and Declarations) (England) Regulations 2013' .

Application Forms for deposits under section 31(6) of the Highways Act 1980 and section 15A(1) of the Commons Act 2006

PART A: Information relating to the applicant and land to which the application relates
(all applicants must complete this Part)

- 1. Name of appropriate authority to which the application is addressed:
Lincolnshire County Council
- 2. Name and full address (including postcode) of applicant:
Ralph Owen Day, at The Manor, Redbourne, Gainsborough Lincs. DN21 4QT
Christopher John Day at The Manor House, Manton, Kirton Lindsey, Gainsborough, Lincs. DN21 4JT
- 3. Status of applicant (tick relevant box or boxes):
 - (a) Ralph Owen Day and Christopher John Day are the the owners of the land described in paragraph 4.
 -
- 4. Insert description of the land(s) to which the application relates (including full address and postcode):
Land known as Biscathorpe Lake , near Donington on Bain
- 5. Ordnance Survey six-figure grid reference(s) of a point within the area of land(s) to which the application relates (if known):
TF2384SW
- 6. This deposit comprises the following statements

PART B: Statement under section 31(6) of the Highways Act 1980

Ralph Owen Day, at The Manor, Redbourne, Gainsborough Lincs. DN21 4QT
Christopher John Day at The Manor House, Manton, Kirton Lindsey, Gainsborough, Lincs. DN21 4JT

are the owners of the land described in paragraph 4 of Part A of this form and shown edged red on the map accompanying this statement.

Ways shown in blue dotted lines on the accompanying map are public footpaths.

No other ways over the land shown edged red on the accompanying maps have been dedicated as highways.

PART D: Statement under section 15A(1) of the Commons Act 2006

Ralph Owen Day, at The Manor, Redbourne, Gainsborough Lincs. DN21 4QT
Christopher John Day at The Manor House, Manton, Kirton Lindsey, Gainsborough,
Lincs. DN21 4JT

are the owners of the land described in paragraph 4 of Part A of this form and shown edged red on the maps accompanying this statement and

We wish to bring to an end any period during which persons may have indulged as of right in lawful sports and pastimes on the whole or any part of the land shown edged red on the accompanying map

PART E: Additional information relevant to the application
(insert any additional information relevant to the application)

PART F: Statement of Truth
(all applicants must complete this Part)

WARNING: If you dishonestly enter information or make a statement that you know is, or might be, untrue or misleading, and intend by doing so to make a gain for yourself or another person, or to cause loss or the risk of loss to another person, you may commit the offence of fraud under section 1 of the Fraud Act 2006, the maximum penalty for which is 10 years' imprisonment or an unlimited fine, or both.

I BELIEVE THAT THE FACTS AND MATTERS CONTAINED IN THIS FORM ARE TRUE

Signature
(of the person making the statement of truth):

Print full name:

Date: 22/4/2014

Signature
(of the person making the statement of truth):

Print full name:

Date: 22/4/14

You should keep a copy of the completed form



TITLE NUMBER
LL247292

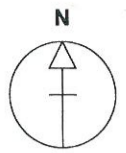

LINCOLNSHIRE : EAST LINDSEY

ORDNANCE SURVEY MAP REFERENCE:

TF2384SW

SCALE 1:2500 Reduced from 1/1250

©CROWN COPYRIGHT. Produced by HMLR. Further reproduction in whole or in part is prohibited without the prior written permission of Ordnance Survey. Licence Number GD 272728.

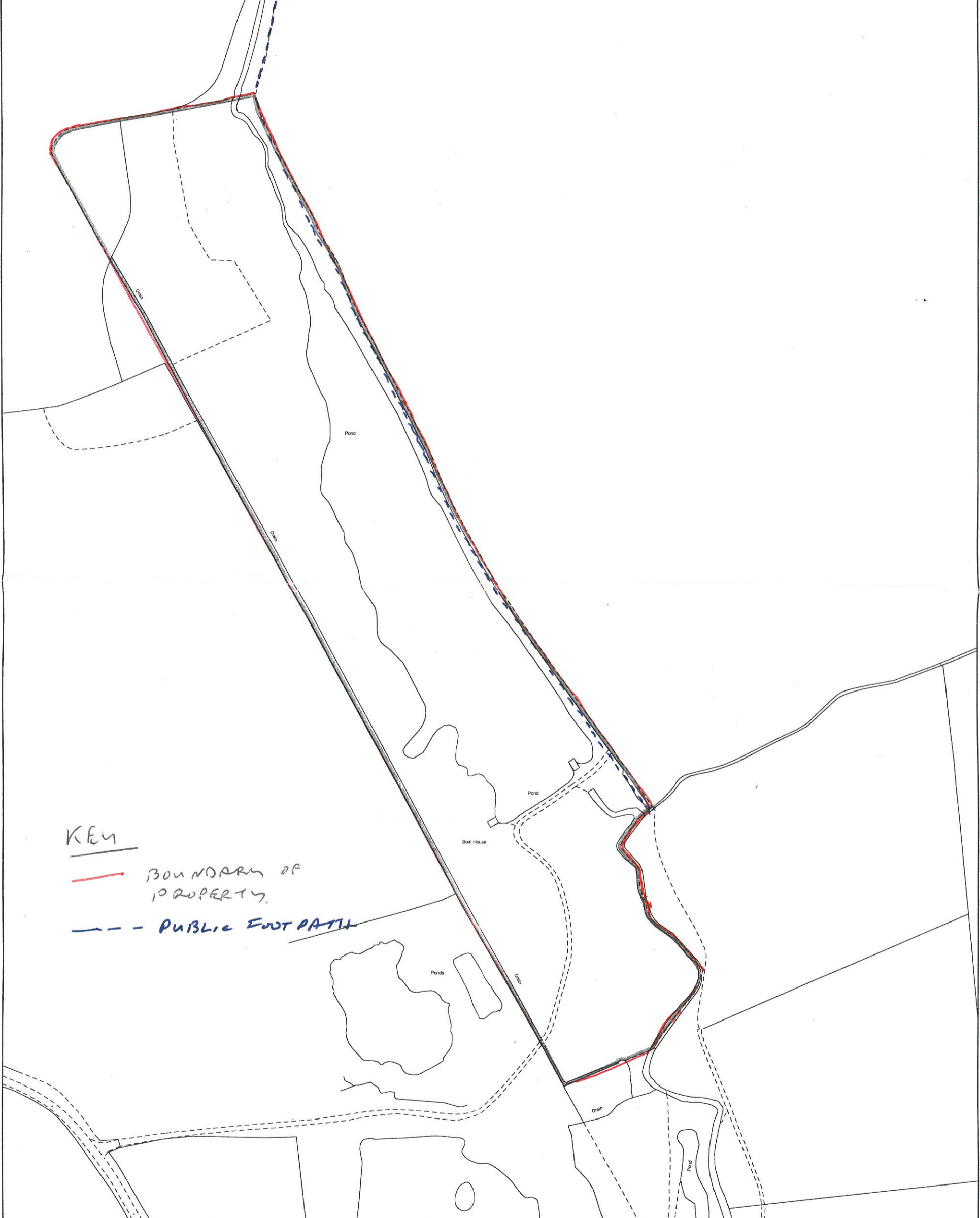

KEY

- BOUNDARY OF PROPERTY.
- PUBLIC FOOTPATH

This title plan shows the general position of the boundaries: it does not show the exact line of the boundaries. Measurements scaled from this plan may not match measurements between the same points on the ground. For more information see Land Registry Public Guide 7 - Title Plans.

This official copy shows the state of the title plan on 18 November 2004 at 11:35:57. It may be subject to distortions in scale.

Under s.67 of the Land Registration Act 2002, this copy is admissible in evidence to the same extent as the original.

Issued on 18 November 2004.

This title is dealt with by the Kingston-Upon-Hull District Land Registry.



BOUNDARY OVERLAP

Declaration Biscathorpe Lake RD CJD

This form has been reproduced from Schedule 1 of 'Statutory Instrument 2013 No. 1774 The Commons (Registration of Town or Village Greens) and Dedicated Highways (Landowner Statements and Declarations) (England) Regulations 2013'.

Application Forms for deposits under section 31(6) of the Highways Act 1980 and section 15A(1) of the Commons Act 2006

Declaration

PART A: Information relating to the applicant and land to which the application relates (all applicants must complete this Part)

1. Name of appropriate authority to which the application is addressed: Lincolnshire County Council

2. Name and full address (including postcode) of applicant: Ralph Owen Day, at The Manor, Redbourne, Gainsborough Lincs. DN21 4QT Christopher John Day at The Manor House, Manton, Kirton Lindsey, Gainsborough, Lincs. DN21 4JT

3. Status of applicant (tick relevant box or boxes):

(a) [checked] Ralph Owen Day and Christopher John Day are the the owners of the land described in paragraph 4.

[] 4. Insert description of the land(s) to which the application relates (including full address and postcode): Land known as Biscathorpe Lake , near Donington on Bain

5. Ordnance Survey six-figure grid reference(s) of a point within the area of land(s) to which the application relates (if known): TF2384SW

6. This deposit comprises the following declation

[Empty box for declaration details]

PART C: Declaration under section 31(6) of the Highways Act 1980

1. We are the owners of the land described in paragraph 4 of Part A of this form and shown edged red on the maps lodged with Lincolnshire County Council on 22nd April 2014

2. On the 22nd April 2014 we deposited with Lincolnshire County Council, being the appropriate council, a statement accompanied by a map showing our property edged red which stated that:

the ways shown in dotted blue on that map had been dedicated as footpaths

no other ways had been dedicated as highways over our property

4. No additional ways have been dedicated over the land edged red on the map referenced in paragraph 1 above since the statement dated 22nd April 2014 referred to in paragraph 2 above and at the present time we have no intention of dedicating any more public rights of way over our property.

PART E: Additional information relevant to the application
(insert any additional information relevant to the application)

PART F: Statement of Truth
(all applicants must complete this Part)

WARNING: If you dishonestly enter information or make a statement that you know is, or might be, untrue or misleading, and intend by doing so to make a gain for yourself or another person, or to cause loss or the risk of loss to another person, you may commit the offence of fraud under section 1 of the Fraud Act 2006, the maximum penalty for which is 10 years' imprisonment or an unlimited fine, or both.

I BELIEVE THAT THE FACTS AND MATTERS CONTAINED IN THIS FORM ARE TRUE

Signature
(of the person making the statement of truth):

Print full name:

Date: 30/4/2014

Signature
(of the person making the statement of truth):

Print full name:

Date: 30.4.14

You should keep a copy of the completed form