

**Parish:** Deeping St. Nicholas  
**Title:** Land to the north of Deeping St. Nicholas  
**Reference number:** CA/7/1/430

**HIGHWAYS ACT 1980, SECTION 31 (6) – DEPOSITED MAPS, HIGHWAYS STATEMENT AND HIGHWAYS DECLARATIONS**

**Date of deposit of map and highways statement** 23.11.2016  
**Depositor's name and address** Mr J Morgan-Smith, Savills, Enfield Chambers, 18 Low Pavement, Nottingham, NG2 6AN  
**Dates of deposit of highways declarations and names and addresses of depositors** (1) 01.12.2016: Mr J Morgan-Smith, Savills, Enfield Chambers, 18 Low Pavement, Nottingham, NG2 6AN  
**Date deposit expires:** 30.11.2036

**COMMONS ACT 2006, SECTION 15A (1) – DEPOSITED MAPS AND LANDOWNER STATEMENTS**

**Dates of deposit of maps and landowner statements, and names and addresses of depositors** (1) 23.11.2016: Mr J Morgan-Smith, Savills, Enfield Chambers, 18 Low Pavement, Nottingham, NG2 6AN *[combined deposit]*  
(2) 01.12.2016: Mr J Morgan-Smith, Savills, Enfield Chambers, 18 Low Pavement, Nottingham, NG2 6AN *[combined deposit]*

**GEOGRAPHIC LOCATION**

**Grid Reference:** TF214 187  
**Address and postcode of buildings on the deposited land** Park Farm, Banks Drove, Deeping St. Nicholas, PE11 3BJ; 5 & 6 Banks Drove, Deeping St. Nicholas, PE11 3BJ  
**District** South Holland  
**Nearest city or town** Spalding

**ENQUIRIES ABOUT THE REGISTER OR DEPOSITS**

Enquiries concerning the register or the deposits lodged with the County Council should be made to the Definitive Map Officer at Lincolnshire County Council's Countryside Services Section by email to [countryside\\_access@lincolnshire.gov.uk](mailto:countryside_access@lincolnshire.gov.uk) or by telephone on 01522 782070.

**INFORMATION ABOUT THE REGISTER OF DEPOSITS**

The County Council is required by law to keep and maintain a register of highways statements and highways declarations deposited under section 31 (6) of the Highways Act 1980 and landowner statements deposited under section 15A (1) of the Commons Act 2006. The register is available for public inspection on its website and in a paper copy format, together with copies of the deposited documents. Details, including names, addresses and the location of land relating to an application, which may be considered to be personal information, will therefore be in the public domain. This requirement overrides any entitlement a depositor and landowner may otherwise have under the Data Protection Act 1998 to prevent the publication of such information.

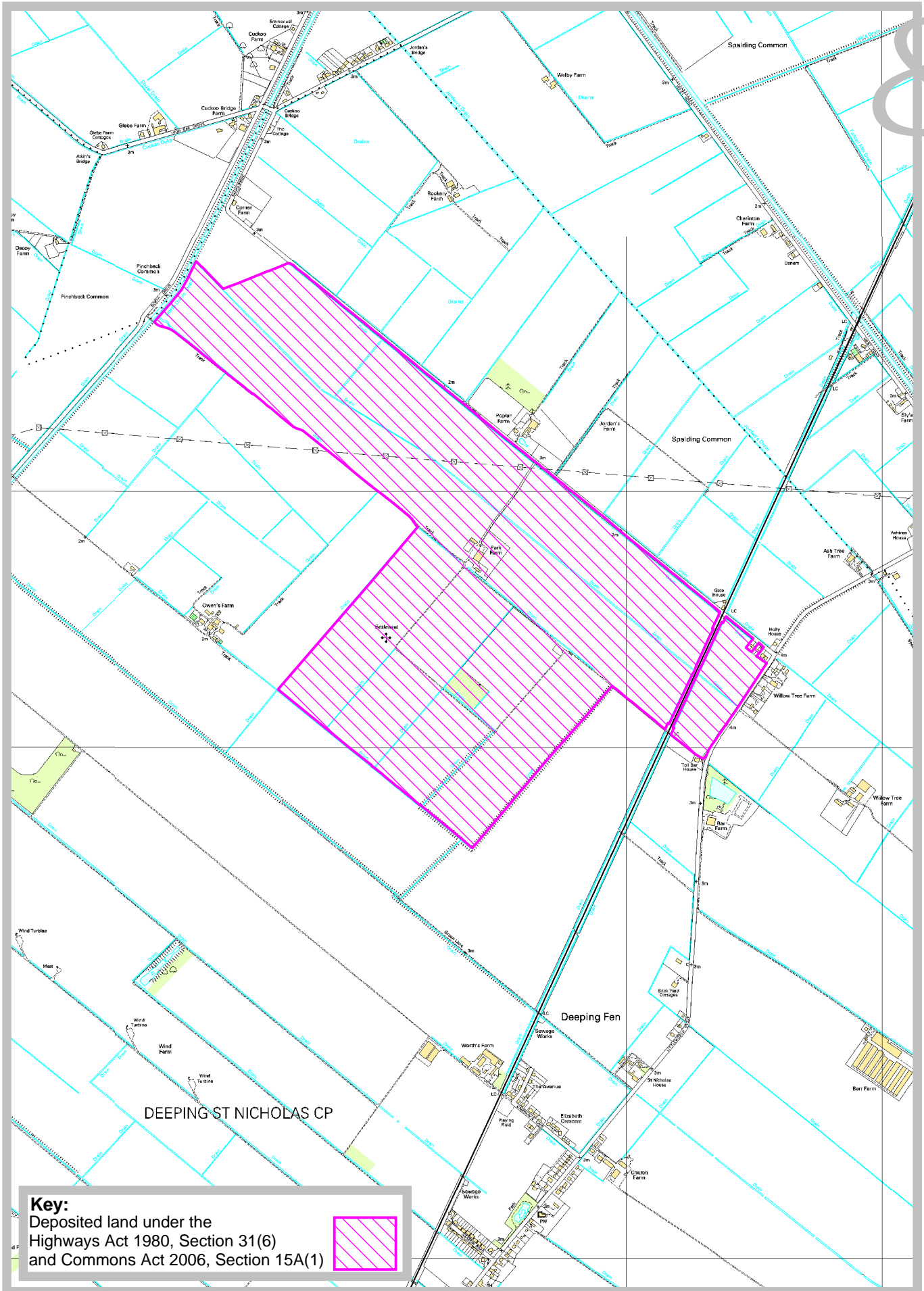
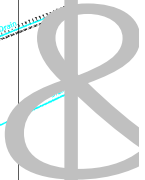

**Key:**  
 Deposited land under the  
 Highways Act 1980, Section 31(6)  
 and Commons Act 2006, Section 15A(1)



Countryside Services  
 RA Wills, Executive Director for Environment &  
 Economy, County Offices, Newland, Lincoln,  
 LN1 1YL.

**Land to the north of Deeping St.  
 Nicholas**  
 Ref: CA/7/1/430  
 Grid Ref: TF214 187  
 Scale: Approx. 1:20,000

10. 'Appropriate authority' means (a) in relation to a map or statement deposited or declaration lodged under section 31(6) of that Act, an appropriate council (as defined in section 31(7) of the Highways Act 1980); and (b) in relation to a statement and map deposited under section 15A(1) of the 2006 Act, a commons registration authority (defined in section 4 of the Commons Act 2006 and section 2 of the Commons Registration Act 1965). In practice, the appropriate council and commons registration authority will usually be the same body.

**PART A: Information relating to the applicant and land to which the application relates  
(all applicants must complete this Part)**

1. Name of appropriate authority to which the application is addressed:

**Lincolnshire County Council**

2. Name and full address (including postcode) of applicant:

Jonathan Morgan-Smith  
Enfield Chambers  
18 Low Pavement  
Nottingham  
NG2 6AN

3. Status of applicant (tick relevant box or boxes):

I am

- (a)  the owner of the land(s) described in paragraph 4.  
(b)  making this application and the statements/declarations it contains on behalf of **The Master, Fellows and Scholars of Trinity College Cambridge** who are the owners of the land (s) described in paragraph 4 and in my capacity as Managing Agent to The Master, Fellows and Scholars of Trinity College Cambridge.

4. Insert description of the land(s) to which the application relates (including full address and postcode):

**Land to the north of the village of Deeping St Nicholas, Spalding, Lincolnshire, PE11 3BJ.**

**Toll Bar and Park Farm  
Deeping St Nicholas  
Spalding  
Lincolnshire  
PE11 3BJ**

5. Ordnance Survey six-figure grid reference(s) of a point within the area of land(s) to which the application relates (if known): **TF 217191**

6. This deposit comprises the following statement(s) and/or declarations (*delete Parts B, C, or D where not applicable*):

Part B (Highways Statement)

Part D (Landowner Statement)

**PART B: Statement under section 31(6) of the Highways Act 1980**

The Master, Fellow and Scholars of Trinity College Cambridge are the owners of the land described in paragraph 4 of Part A of this form and shown **outlined in red** on the map accompanying this statement.

No other ways over the land shown **outlined in red** on the accompanying map have been dedicated as highways.

**PART D: Statement under section 15A(1) of the Commons Act 2006**

The Master, Fellow and Scholars of Trinity College Cambridge are the owners of the land described in paragraph 4 of Part A of this form and shown **outlined in red** on the map accompanying this statement.

The Master, Fellow and Scholars of Trinity College Cambridge wish to bring to an end any period during which persons may have indulged as of right in lawful sports and pastimes on the whole or any part of the land shown **outlined in red** on the accompanying map.

**PART E: Additional information relevant to the application**  
*(insert any additional information relevant to the application)*

**PART F: Statement of Truth**  
*(all applicants must complete this Part)*

**WARNING:** If you dishonestly enter information or make a statement that you know is, or might be, untrue or misleading, and intend by doing so to make a gain for yourself or another person, or to cause loss or the risk of loss to another person, you may commit the offence of fraud under section 1 of the Fraud Act 2006, the maximum penalty for which is 10 years' imprisonment or an unlimited fine, or both.

I BELIEVE THAT THE FACTS AND MATTERS CONCERNING

Signature (of the person making the statement of truth):

Print full name: JONATHAN MORGAN-SMITH MRIC

Date:

22<sup>nd</sup> November 2016

You should keep a copy of the completed form

**Data Protection Act 1998 - Fair Processing Notice**

The purpose of this Fair Processing Notice is to inform you of the use that will be made of your personal data, as required by the Data Protection Act 1998.

The appropriate authority (see explanation of definition in above guidance notes) in England is the data controller in respect of any personal data that you provide when you complete this form.

The information that you provide will be used by the appropriate authority in its duties to process applications to deposit statements, maps and declarations under section 31(6) the Highways Act 1980 and statements under section 15A(1) of the Commons Act 2006. The information you provide will also be used by the appropriate authority in its duty to update the registers in which details of such deposits are recorded under the Dedicated Highways (Registers under Section 31A of the Highways Act 1980) (England) Regulations 2007 and the Commons (Registration of Town or Village Greens) and Dedicated Highways (Landowner Statements and Declarations) (England) Regulations 2013.

The appropriate authority is required by the legislation above to maintain a register which holds information provided in this form, which can be inspected online or in person by members of the public on request. It may also be required to release information, including personal data and commercial information, on request under the Environmental Information Regulations 2004 or the Freedom of Information Act 2000. However, the appropriate authority will not permit any unwarranted breach of confidentiality nor will they act in contravention of their obligations under the Data Protection Act 1998.



Deeping St Nicholas

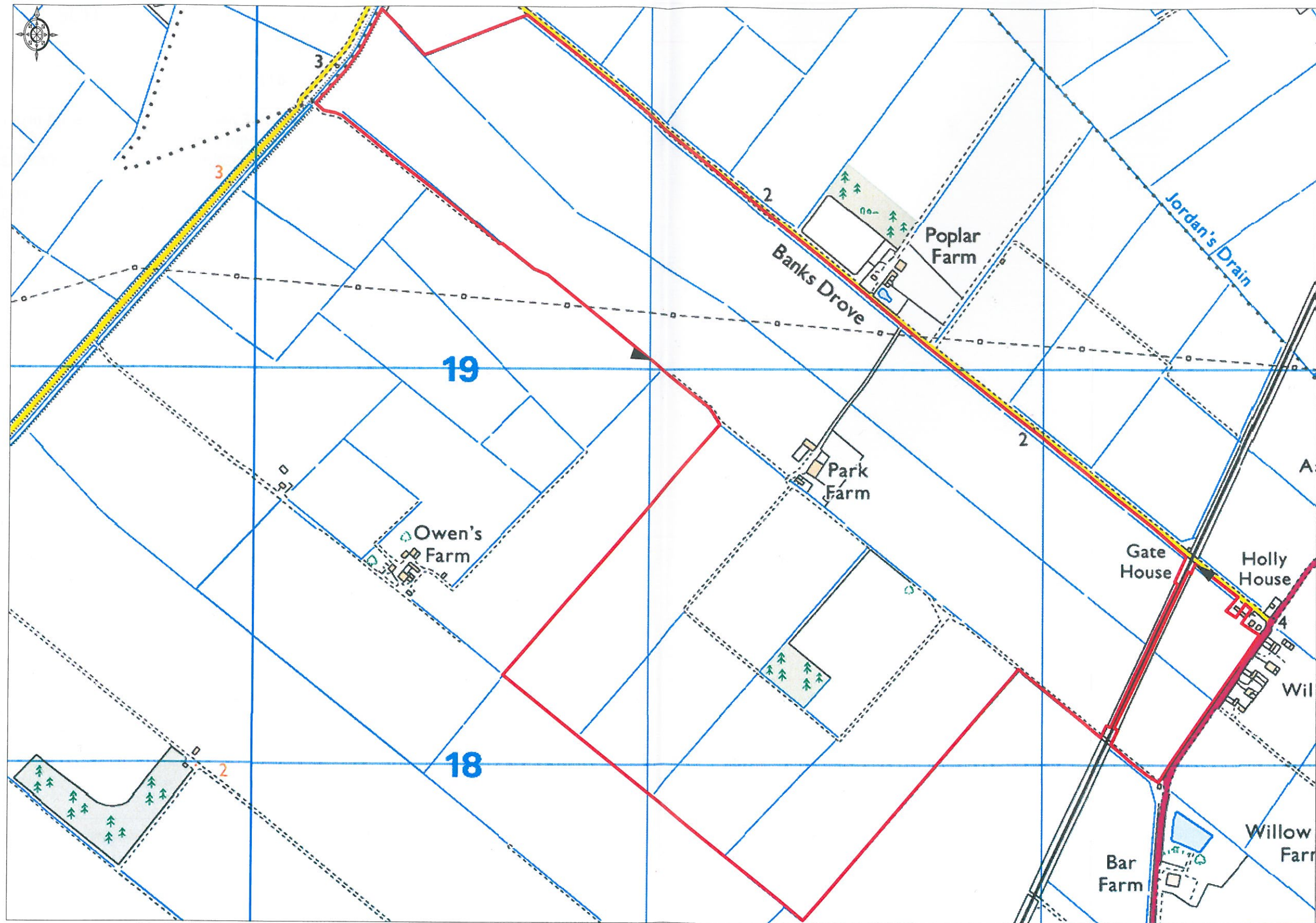

10. 'Appropriate authority' means (a) in relation to a map or statement deposited or declaration lodged under section 31(6) of that Act, an appropriate council (as defined in section 31(7) of the Highways Act 1980); and (b) in relation to a statement and map deposited under section 15A(1) of the 2006 Act, a commons registration authority (defined in section 4 of the Commons Act 2006 and section 2 of the Commons Registration Act 1965). In practice, the appropriate council and commons registration authority will usually be the same body.

**PART A: Information relating to the applicant and land to which the application relates  
(all applicants must complete this Part)**

1. Name of appropriate authority to which the application is addressed:

**Lincolnshire County Council**

2. Name and full address (including postcode) of applicant:

Jonathan Morgan-Smith  
Enfield Chambers  
18 Low Pavement  
Nottingham  
NG2 6AN

3. Status of applicant (tick relevant box or boxes):

I am

(a)  the owner of the land(s) described in paragraph 4.

(b)  making this application and the statements/declarations it contains on behalf of **The Master, Fellows and Scholars of Trinity College Cambridge** who is the owner of the land (s) described in paragraph 4 and in my capacity as Managing Agent to The Master, Fellows and Scholars of Trinity College Cambridge.

4. Insert description of the land(s) to which the application relates (including full address and postcode):

**Land to the north of the village, Deeping St Nicholas, Spalding, Lincolnshire, PE11 3BJ.**

**Toll Bar and Park Farm  
Deeping St Nicholas  
Spalding  
Lincolnshire  
PE11 3BJ**

5. Ordnance Survey six-figure grid reference(s) of a point within the area of land(s) to which the application relates (if known): **TF 217191**

6. This deposit comprises the following statement(s) and/or declarations (*delete Parts B, C, or D where not applicable*):

Part C (Highways Declaration)

Part D (Landowner Statement)



**PART C: Declaration under section 31(6) of the Highways Act 1980**

1. **The Master, Fellows and Scholars of Trinity College Cambridge** are the owners of the land described in paragraph 4 of Part A of this form and shown **outlined in red** on the map accompanying this declaration/lodged with Lincolnshire County Council on 23<sup>rd</sup> November 2016.

2. On the 23<sup>rd</sup> of November 2016 **The Master, Fellows and Scholars of Trinity College Cambridge** deposited with Lincolnshire County Council, being the appropriate council, a statement accompanied by a map showing **The Master, Fellows and Scholars of Trinity College Cambridge's** property **outlined in red** which stated that:

no other ways had been dedicated as highways over **The Master, Fellows and Scholars of Trinity College Cambridge** property.

4. No additional ways have been dedicated over the land **outlined in red** on the map accompanying this declaration/referenced in paragraph 1 above since the statement dated 22<sup>nd</sup> November 2016 other than those byways open to all traffic, restricted byways, bridleways, footpaths marked in the appropriate colour on the map accompanying this declaration and at the present time **The Master, Fellows and Scholars of Trinity College Cambridge** have no intention of dedicating any more public rights of way over the property.

**PART D: Statement under section 15A(1) of the Commons Act 2006**

The Master, Fellow and Scholars of Trinity College Cambridge are the owners of the land described in paragraph 4 of Part A of this form and shown **outlined in red** on the map accompanying this statement deposited with Lincolnshire County Council on 23<sup>rd</sup> November 2016.

The Master, Fellow and Scholars of Trinity College Cambridge wish to bring to an end any period during which persons may have indulged as of right in lawful sports and pastimes on the whole or any part of the land shown **outlined in red** on the accompanying map.

**PART E: Additional information relevant to the application**  
*(insert any additional information relevant to the application)*

**PART F: Statement of Truth**  
*(all applicants must complete this Part)*

**WARNING:** If you dishonestly enter information or make a statement that you know is, or might be, untrue or misleading, and intend by doing so to make a gain for yourself or another person, or to cause loss or the risk of loss to another person, you may commit the offence of fraud under section 1 of the Fraud Act 2006, the maximum penalty for which is 10 years' imprisonment or an unlimited fine, or both.

I BELIEVE THAT THE FACTS AND MATTERS CONTAINED IN THIS FORM ARE TRUE

Signature (of the person making the statement of truth):

Print full name: JONATHAN MORGAN-SMITH MRIC

Date: 30th November 2016

You should keep a copy of the completed form

**Data Protection Act 1998 - Fair Processing Notice**

The purpose of this Fair Processing Notice is to inform you of the use that will be made of your personal data, as required by the Data Protection Act 1998.

The appropriate authority (see explanation of definition in above guidance notes) in England is the data controller in respect of any personal data that you provide when you complete this form.

The information that you provide will be used by the appropriate authority in its duties to process applications to deposit statements, maps and declarations under section 31(6) the Highways Act 1980 and statements under section 15A(1) of the Commons Act 2006. The information you provide will also be used by the appropriate authority in its duty to update the registers in which details of such deposits are recorded under the Dedicated Highways (Registers under Section 31A of the Highways Act 1980) (England) Regulations 2007 and the Commons (Registration of Town or Village Greens) and Dedicated Highways (Landowner Statements and Declarations) (England) Regulations 2013.

The appropriate authority is required by the legislation above to maintain a register which holds information provided in this form, which can be inspected online or in person by members of the public on request. It may also be required to release information, including personal data and commercial information, on request under the Environmental Information Regulations 2004 or the Freedom of Information Act 2000. However, the appropriate authority will not permit any unwarranted breach of confidentiality nor will they act in contravention of their obligations under the Data Protection Act 1998.

Deeping St Nicholas

