

**Parish:** Waddingham  
**Title:** Land known as Mount Pleasant Farm, Field known as Little Carr & Land known as part of Holmes Farm  
**Reference number:** CA/7/1/401

**DEPOSIT OF MAP AND STATEMENT AND STATUTORY DECLARATION(S) UNDER HIGHWAYS ACT 1980, SECTION 31(6) AND COMMONS ACT 2006, SECTION 15A(1)**

**Geographic Location**

**Grid Reference:** SK981971, SK999976  
**Address and postcode of buildings on the deposited land** Mount Pleasant, Redbourne Road, Waddingham, DN21 4TE  
**District** West Lindsey  
**Nearest city or town** Scunthorpe

**Highways Act 1980, Section 31(6) deposits**

**Date of deposit of map and statement** 22.04.2014  
**Depositor's name and address** Mr R Day: The Manor, Redbourne, Gainsborough, DN21 4QT; Ralph Day Ltd. Southfield Office, Redbourne, Gainsborough, DN21 4QR  
**Date of deposit of declaration, name and address of depositor** (1) 20.05.2014: Mr R Day: The Manor, Redbourne, Gainsborough, DN21 4QT; Ralph Day Ltd. Southfield Office, Redbourne, Gainsborough, DN21 4QR  
**Date deposit expires:** 19.05.2034

**Commons Act 2006, Section 15A(1)**

**Date of deposit of map and statement, name and address of depositor** (1) 22.04.2014: Mr R Day: The Manor, Redbourne, Gainsborough, DN21 4QT; Ralph Day Ltd. Southfield Office, Redbourne, Gainsborough, DN21 4QR  
*[combined deposit]*

**COUNTY COUNCIL'S CONTACT DETAILS**

**Officer and Section:** Definitive Map Officer, Public Rights of Way and Countryside Access  
**Address:** Lincolnshire County Council, Communities, 4<sup>th</sup> Floor, City Hall, Lincoln, LN1 1DN  
**Telephone:** 01522 782070  
**Email:** countryside\_access@lincolnshire.gov.uk

## **REGISTER OF DEPOSITS**

The County Council is required by law to keep a register of maps and statements and declarations deposited under Section 31(6) of the Highways Act 1980 and Section 15A(1) of the Commons Act 2006 available for public inspection on its website and in a paper copy format together with the deposited documents. Details including names, addresses and the location of land relating to a deposit which may be considered to be personal information are therefore in the public domain. This requirement overrides any entitlement a depositor may otherwise have under the Data Protection Act 1998 to prevent publication of such information. The paper copy of the register together with the deposited documents can be viewed by appointment during normal office hours (9:00am to 4:30pm, Monday to Friday) at the County Council's Public Rights of Way and Countryside Section at the above address.

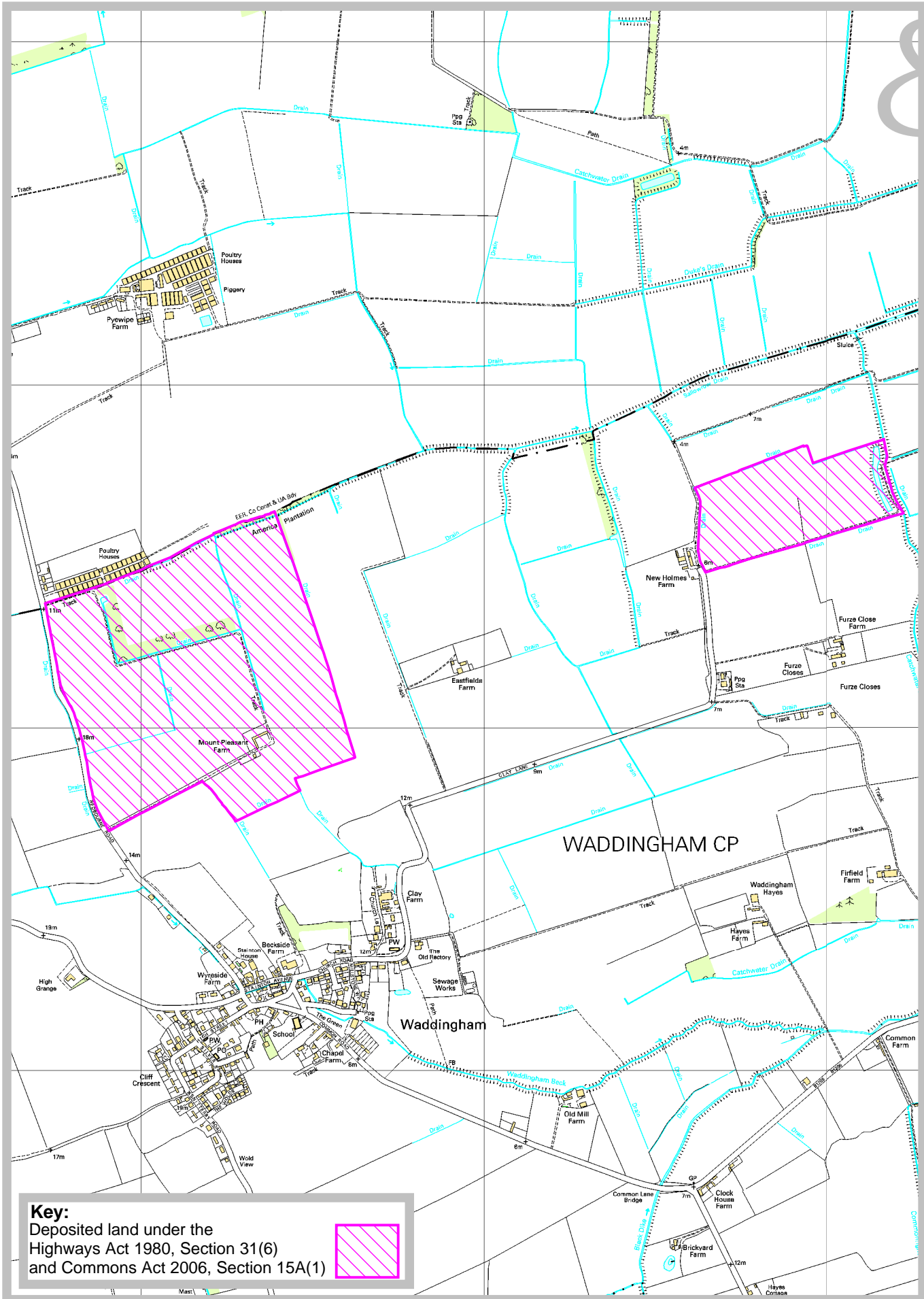

**Key:**  
 Deposited land under the  
 Highways Act 1980, Section 31(6)  
 and Commons Act 2006, Section 15A(1)



Rights of Way & Countryside Access  
 RA Wills, Executive Director for Environment & Economy  
 City Hall, Orchard Street,  
 Lincoln LN1 1DN

**Land known as Mount Pleasant Farm, Field known as Little Carr & Land known as part of Holmes Farm**  
 Ref: CA/71/401  
 Scale: approx. 1:15,000

NB This plan only shows the extent of the land covered by the deposit. Reproduced from Ordnance Survey with the permission of the Controller of HMSO © Crown Copyright. Licence number 100025370.

**This form has been reproduced from Schedule 1 of 'Statutory Instrument 2013 No. 1774 The Commons (Registration of Town or Village Greens) and Dedicated Highways (Landowner Statements and Declarations) (England) Regulations 2013'.**

**Application Forms for deposits under section 31(6) of the Highways Act 1980 and section 15A(1) of the Commons Act 2006**

**PART A: Information relating to the applicant and land to which the application relates**  
**(all applicants must complete this Part)**

1. Name of appropriate authority to which the application is addressed:  
Lincolnshire County Council

2. Name and full address (including postcode) of applicant:  
Ralph Owen Day, at The Manor, Redbourne, Gainsborough Lincs. DN21 4QT  
and  
Ralph Day Ltd at Southfield Office , Redbourne, Gainsborough, Lincs. DN21 4QR

3. Status of applicant (tick relevant box or boxes):

(a)  Ralph Owen Day and Ralph Day Ltd are the the owners of the land(s) described in paragraph 4.

~~(b)  making this application and the statements/declarations it contains on behalf of [insert name of owner] who is the owner of the land(s) described in paragraph 4 and in my capacity as [insert details].~~

4. Insert description of the land(s) to which the application relates (including full address and postcode):  
Land known as Mount Pleasant Farm, Waddingham DN21 4TE and  
Field know as Little Carr, Waddingham and  
Land known as part of Holmes Farm Waddingham

5. Ordnance Survey six-figure grid reference(s) of a point within the area of land(s) to which the application relates (if known):

6. This deposit comprises the following statements and declarations

**PART B: Statement under section 31(6) of the Highways Act 1980**

I, Ralph Owen Day, The Manor, Redbourne, Gainsborough, Lincs. DN21 4QT as an individual and majority shareholder of Ralph Day Ltd

am the owner of the land described in paragraph 4 of Part A of this form and shown edged red or yellow on the maps accompanying this statement.

~~[Ways shown [insert colouring] on the accompanying map are byways open to all traffic.]~~

~~[Ways shown [insert colouring] on the accompanying map are restricted byways.]~~

~~[Ways shown [insert colouring] green on the accompanying map are public bridleways.]~~

Ways shown in blue dotted lines on the accompanying map are public footpaths.

No other ways over the land shown edged red or yellow on the accompanying maps have been dedicated as highways.

**PART D: Statement under section 15A(1) of the Commons Act 2006**

I, Ralph Owen Day, The Manor, Redbourne, Gainsborough, Lincs. DN21 4QT as an individual and majority shareholder of Ralph Day Ltd  
am the owner of the land described in paragraph 4 of Part A of this form and shown edged red on the maps accompanying this statement and

I, Ralph Owen Day, The Manor, Redbourne, Gainsborough, Lincs. DN21 4QT  
Wish to bring to an end any period during which persons may have indulged as of right in lawful sports and pastimes on the whole or any part of the land shown edged red on the accompanying map

**PART E: Additional information relevant to the application**  
*(insert any additional information relevant to the application)*

**PART F: Statement of Truth**  
**(all applicants must complete this Part)**

**WARNING: If you dishonestly enter information or make a statement that you know is, or might be, untrue or misleading, and intend by doing so to make a gain for yourself or another person, or to cause loss or the risk of loss to another person, you may commit the offence of fraud under section 1 of the Fraud Act 2006, the maximum penalty for which is 10 years' imprisonment or an unlimited fine, or both.**

**I BELIEVE THAT THE FACTS AND MATTERS CONTAINED IN THIS FORM ARE TRUE**

**Signature**  
**(of the person making the statement of truth):**

**Print full name:**

**Date:** 13/4/2014

**Signature**  
**(of the person making the statement of truth):**

**Print full name:**

Ralph Owen Day as Director of Ralph Day Ltd

**Date:** 13/4/2014

**You should keep a copy of the completed form**



--- PUBLIC FOOT PATH.

LAND OWNED BY  
RALPH DAY, ESQ  
AND RALPH DAY LTD

LAND OWNED BY  
RALPH DAY ESQ

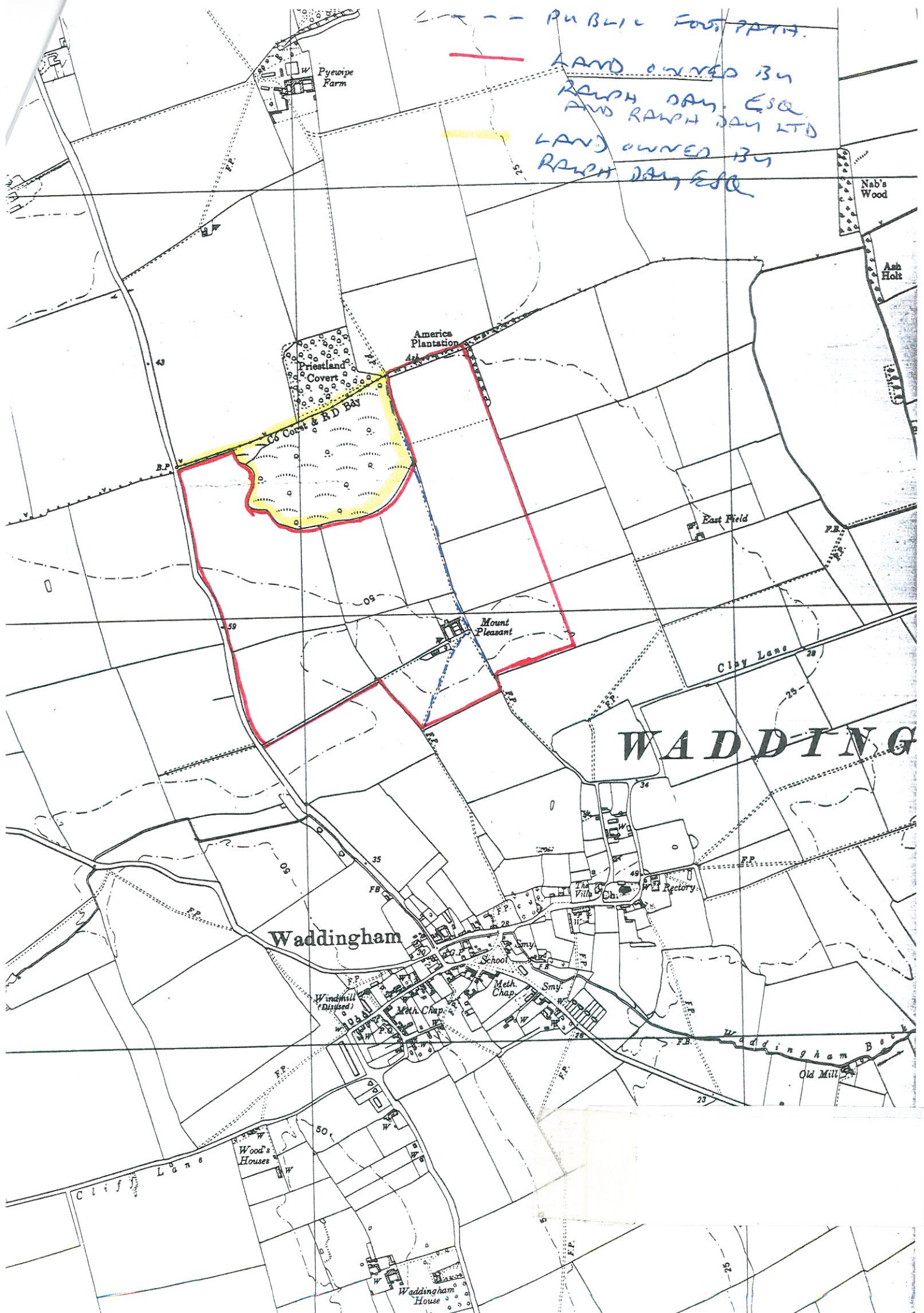

WADDINGTON

Waddingham

Clay Lane

Waddingham Lane

Cliff Lane

Wood's Houses

Waddingham House

Windmill (Disused)

School

Meth. Chap.

Meth. Chap.

The Villa

Rectory

Americas Plantation

Priestland Covert

Co Court & RD BAY

Pyewipe Farm

Nab's Wood

Ash Holt

Mount Pleasant

East Field

Old Mill

99998

TF0098

Holmes Farm Waddingham

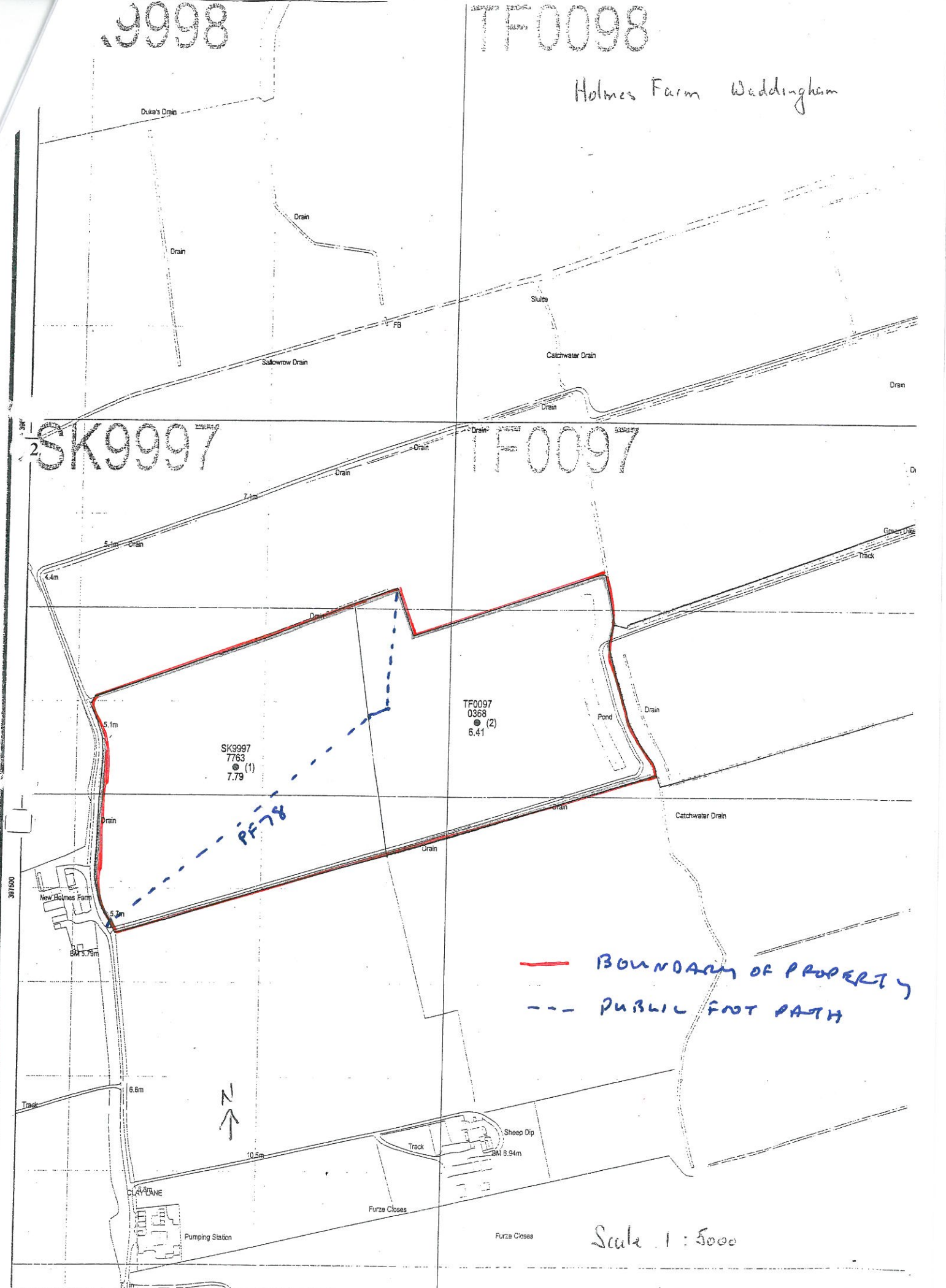

SK9997

TF0097

SK9997  
7763  
● (1)  
7.79

TF0097  
0368  
● (2)  
6.41

PF 78

— BOUNDARY OF PROPERTY  
 --- PUBLIC FOOT PATH



Scale 1 : 5000



This form has been reproduced from Schedule 1 of 'Statutory Instrument 2013 No. 1774 The Commons (Registration of Town or Village Greens) and Dedicated Highways (Landowner Statements and Declarations) (England) Regulations 2013'.

Application Forms for deposits under section 31(6) of the Highways Act 1980 and section 15A(1) of the Commons Act 2006

Declaration

**PART A: Information relating to the applicant and land to which the application relates**  
*(all applicants must complete this Part)*

1. Name of appropriate authority to which the application is addressed:  
Lincolnshire County Council
2. Name and full address (including postcode) of applicant:  
Ralph Owen Day, at The Manor, Redbourne, Gainsborough Lincs. DN21 4QT  
and  
Ralph Day Ltd at Southfield Office, Redbourne, Gainsborough, Lincs. DN21 4QR
3. Status of applicant (tick relevant box or boxes):  
  
(a)  Ralph Owen Day and Ralph Day Ltd are the the owners of the land(s) described in paragraph 4.
4. Insert description of the land(s) to which the application relates (including full address and postcode):  
Land known as Mount Pleasant Farm, Waddingham DN21 4TE and  
Field know as Little Carr, Waddingham and  
Land known as part of Holmes Farm Waddingham
5. Ordnance Survey six-figure grid reference(s) of a point within the area of land(s) to which the application relates (if known):
6. This deposit comprises the following declaration

**PART C: Declaration under section 31(6) of the Highways Act 1980**

1. We are the owners of the land described in paragraph 4 of Part A of this form and shown edged red on the maps lodged with Lincolnshire County Council on 22<sup>nd</sup> April 2014
2. On the 22<sup>nd</sup> April 2014 we deposited with Lincolnshire County Council, being the appropriate council, a statement accompanied by a map showing our property edged red which stated that:  
  
the ways shown in dotted blue on that map had been dedicated as footpaths  
  
no other ways had been dedicated as highways over our property
4. No additional ways have been dedicated over the land edged red on the map referenced in paragraph 1 above since the statement dated 13<sup>th</sup> April 2014 referred to in paragraph 2 above and at the present time we have no intention of dedicating any more public rights of way over our property.



**PART E: Additional information relevant to the application**  
*(insert any additional information relevant to the application)*

**PART F: Statement of Truth**  
**(all applicants must complete this Part)**

**WARNING:** If you dishonestly enter information or make a statement that you know is, or might be, untrue or misleading, and intend by doing so to make a gain for yourself or another person, or to cause loss or the risk of loss to another person, you may commit the offence of fraud under section 1 of the Fraud Act 2006, the maximum penalty for which is 10 years' imprisonment or an unlimited fine, or both.

**I BELIEVE THAT THE FACTS AND MATTERS CONTAINED IN THIS FORM ARE TRUE**

Signature  
(of the person making the statement of truth):

Print full name:

Date: 30/4/2014

Signature  
(of the person making the statement of truth):

Print full name: Ralph Owen Day as Director of Ralph Day Ltd

Date: 30/4/2014

**You should keep a copy of the completed form**