

Parish: Lusby with Winceby
Title: Land at Asgarby
Reference number: CA/7/1/448

HIGHWAYS ACT 1980, SECTION 31 (6) – DEPOSITED MAPS, HIGHWAYS STATEMENT AND HIGHWAYS DECLARATIONS

Date of deposit of map and highways statement 06.12.2017

Depositor's name and address Savills UK Ltd. on behalf of Church Commissioners for England, Stuart House, City Road, Peterborough, PE1 1QF

Dates of deposit of highways declarations and names and addresses of depositors (1) 22.01.2018: Savills UK Ltd. on behalf of Church Commissioners for England, Stuart House, City Road, Peterborough, PE1 1QF

Date deposit expires: 21.01.2038

GEOGRAPHIC LOCATION

Grid Reference: TF333 668

Address and postcode of buildings on the deposited land

District East Lindsey

Nearest city or town Horncastle

ENQUIRIES ABOUT THE REGISTER OR DEPOSITS

Enquiries concerning the register or the deposits lodged with the County Council should be made to the Definitive Map Officer at Lincolnshire County Council's Countryside Services Section by email to countryside_access@lincolnshire.gov.uk or by telephone on 01522 782070.

INFORMATION ABOUT THE REGISTER OF DEPOSITS

The County Council is required by law to keep and maintain a register of highways statements and highways declarations deposited under section 31 (6) of the Highways Act 1980 and landowner statements deposited under section 15A (1) of the Commons Act 2006. The register is available for public inspection on its website and in a paper copy format, together with copies of the deposited documents. Details, including names, addresses and the location of land relating to an application, which may be considered to be personal information, will therefore be in the public domain. This requirement overrides any entitlement a depositor and landowner may otherwise have under the Data Protection Act 1998 to prevent the publication of such information.

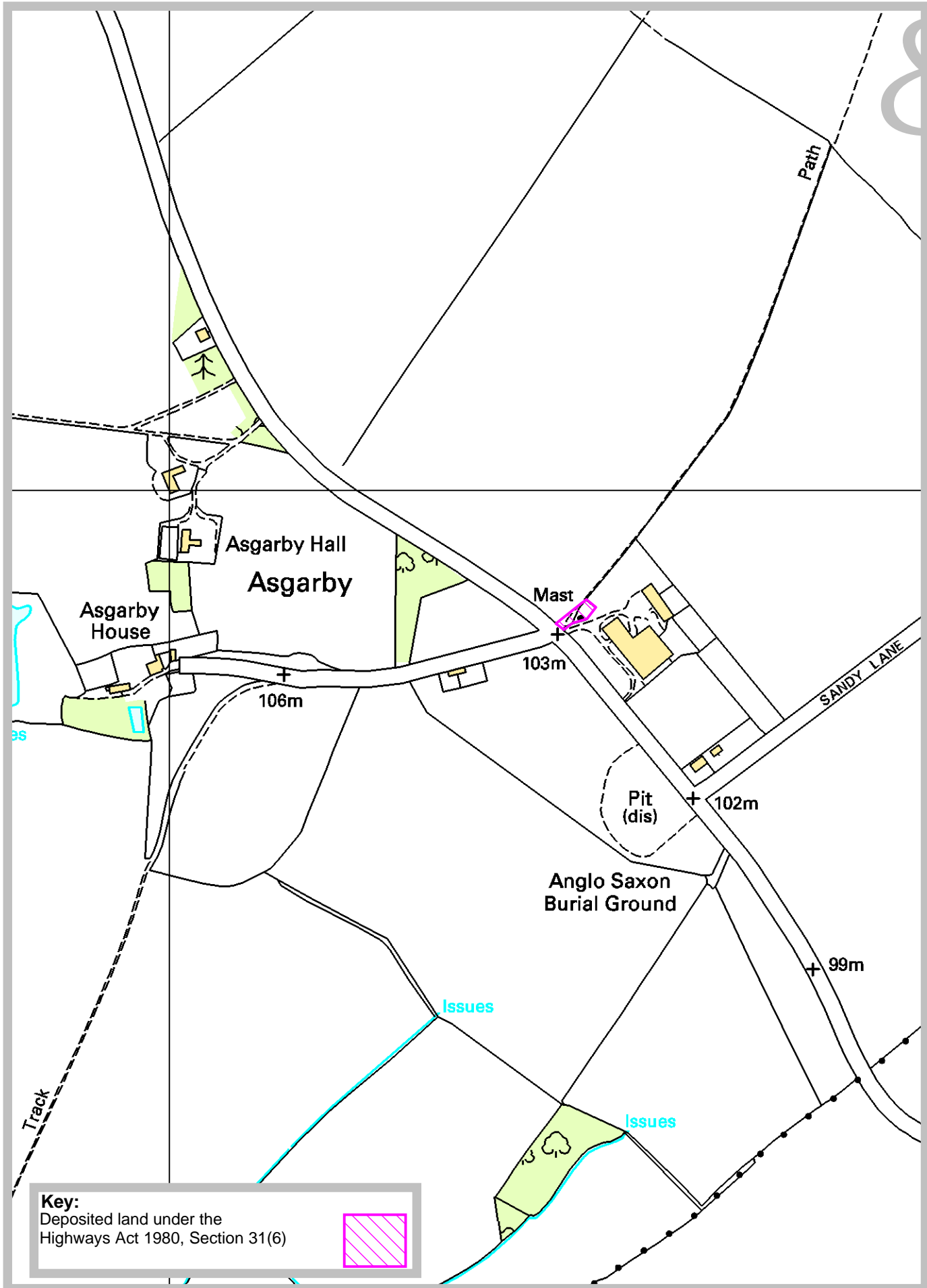

Key:
Deposited land under the
Highways Act 1980, Section 31(6)



Application Forms for deposits under section 31(6) of the Highways Act 1980 and section 15A(1) of the Commons Act 2006

PART A: Information relating to the applicant and land to which the application relates
(all applicants must complete this Part)

1. Name of appropriate authority to which the application is addressed:
Lincolnshire County Council

2. Name and full address (including postcode) of applicant:
Church Commissioners for England
c/o Ian Wilkinson
Savills (UK) Ltd
Stuart House
City Road
Peterborough
PE1 1QF

3. Status of applicant (tick relevant box or boxes):

I am

(a) the owner of the land(s) described in paragraph 4.

(b) X making this application and the statements/declarations it contains on behalf of Church Commissioners for England who is the owner of the land(s) described in paragraph 4 and in my capacity as authorised managing agent.

4. Insert description of the land(s) to which the application relates (including full address and postcode):
Land at Asgardby
Spilsby
Lincolnshire
PE23 4HY

5. Ordnance Survey six-figure grid reference(s) of a point within the area of land(s) to which the application relates (if known):
533400; 366880

6. This deposit comprises the following statement(s) and/or declarations

PART B: Statement under section 31(6) of the Highways Act 1980

I David Ian Goodson am managing agent for the owner of the land described in paragraph 4 of Part A of this form and shown outlined in red on the map accompanying this statement.

No other ways over the land shown outlined in red on the accompanying map have been dedicated as highways.

PART F: Statement of Truth
(all applicants must complete this Part)

WARNING: If you dishonestly enter information or make a statement that you know is, or might be, untrue or misleading, and intend by doing so to make a gain for yourself or another person, or to cause loss or the risk of loss to another person, you may commit the offence of fraud under section 1 of the Fraud Act 2006, the maximum penalty for which is 10 years' imprisonment or an unlimited fine, or both.

I BELIEVE THAT THE FACTS AND MATTERS CONTAINED IN THIS FORM ARE TRUE

Signature (of the person making the statement of truth):

Print full name: * DAVID IAN RODDSON

Date: * 4/12/17

You should keep a copy of the completed form

Data Protection Act 1998 – Fair Processing Notice

The purpose of this Fair Processing Notice is to inform you of the use that will be made of your personal data, as required by the Data Protection Act 1998.

The appropriate authority (see explanation of definition in above guidance notes) in England is the data controller in respect of any personal data that you provide when you complete this form.

The information that you provide will be used by the appropriate authority in its duties to process applications to deposit statements, maps and declarations under section 31(6) the Highways Act 1980 and statements under section 15A(1) of the Commons Act 2006. The information you provide will also be used by the appropriate authority in its duty to update the registers in which details of such deposits are recorded under the Dedicated Highways (Registers under Section 31A of the Highways Act 1980) (England) Regulations 2007 and the Commons (Registration of Town or Village Greens) and Dedicated Highways (Landowner Statements and Declarations) (England) Regulations 2013.

The appropriate authority is required by the legislation above to maintain a register which holds information provided in this form, which can be inspected online or in person by members of the public on request. It may also be required to release information, including personal data and commercial information, on request under the Environmental Information Regulations 2004 or the Freedom of Information Act 2000. However, the appropriate authority will not permit any unwarranted breach of confidentiality nor will they act in contravention of their obligations under the Data Protection Act 1998.

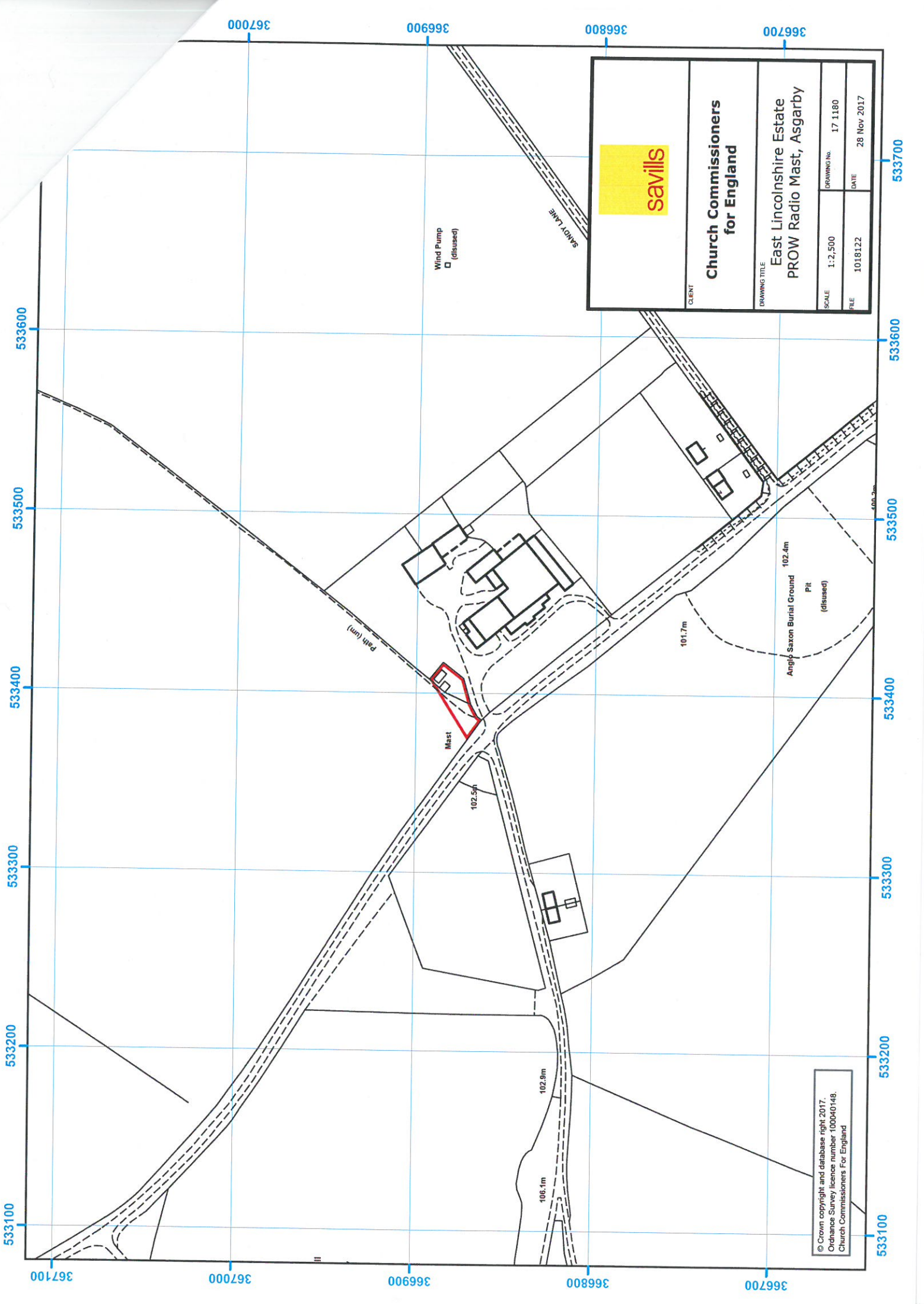

		Church Commissioners for England	
		East Lincolnshire Estate PROW Radio Mast, Asgarby	
CLIENT	DRAWING TITLE		
SCALE 1:2,500	DRAWING No. 17 1180	DATE 28 Nov 2017	
FILE 1018122			

© Crown copyright and database right 2017.
 Ordnance Survey licence number 100040148.
 Church Commissioners For England

Application Forms for deposits under section 31(6) of the Highways Act 1980 and section 15A(1) of the Commons Act 2006

PART A: Information relating to the applicant and land to which the application relates

(all applicants must complete this Part)

1. Name of appropriate authority to which the application is addressed:
Lincolnshire County Council

2. Name and full address (including postcode) of applicant:
Church Commissioners for England
c/o Ian Wilkinson
Savills (UK) Ltd
Stuart House
City Road
Peterborough
PE1 1QF

3. Status of applicant (tick relevant box or boxes):

I am

(a) the owner of the land(s) described in paragraph 4.

(b) X making this application and the statements/declarations it contains on behalf of Church Commissioners for England who is the owner of the land(s) described in paragraph 4 and in my capacity as authorised managing agent.

4. Insert description of the land(s) to which the application relates (including full address and postcode):

Land at Asgarby
Splisby
Lincolnshire
PE23 4HY

5. Ordnance Survey six-figure grid reference(s) of a point within the area of land(s) to which the application relates (if known):
533400; 366880

6. This deposit comprises the following statement(s) and/or declarations

PART C: Declaration under section 31(6) of the Highways Act 1980

1. The Church Commissioners for England are the owner of the land described in paragraph 4 of Part A of this form and shown outlined in red on the map accompanying this declaration lodged with Lincolnshire County Council on 6th December 2017.

2. On the 6th day of December 2017 Church Commissioners for England deposited with Lincolnshire County Council, being the appropriate council, a statement accompanied by a map showing Church Commissioners for England property outlined in red which stated that:

No ways had been dedicated as highways over Church Commissioners for England property.

3. Not Applicable.

4. No additional ways have been dedicated over the land outlined in red on the map accompanying this declaration/referenced in paragraph 1 above since the statement dated

3rd December 2017 referred to in paragraph 2 and at the present time Church Commissioners for England have no intention of dedicating any more public rights of way over the property.

**PART F: Statement of Truth
(all applicants must complete this Part)**

WARNING: If you dishonestly enter information or make a statement that you know is, or might be, untrue or misleading, and intend by doing so to make a gain for yourself or another person, or to cause loss or the risk of loss to another person, you may commit the offence of fraud under section 1 of the Fraud Act 2006, the maximum penalty for which is 10 years' imprisonment or an unlimited fine, or both.

I BELIEVE THAT THE FACTS AND MATTERS CONTAINED ON THIS FORM ARE TRUE

Signature (of the person making the statement of truth)

Print full name:

DAVID IAN GOODSON

Date:

17th January 2018.

You should keep a copy of the completed form

Data Protection Act 1998 – Fair Processing Notice

The purpose of this Fair Processing Notice is to inform you of the use that will be made of your personal data, as required by the Data Protection Act 1998.

The appropriate authority (see explanation of definition in above guidance notes) in England is the data controller in respect of any personal data that you provide when you complete this form.

The information that you provide will be used by the appropriate authority in its duties to process applications to deposit statements, maps and declarations under section 31(6) the Highways Act 1980 and statements under section 15A(1) of the Commons Act 2006. The information you provide will also be used by the appropriate authority in its duty to update the registers in which details of such deposits are recorded under the Dedicated Highways (Registers under Section 31A of the Highways Act 1980) (England) Regulations 2007 and the Commons (Registration of Town or Village Greens) and Dedicated Highways (Landowner Statements and Declarations) (England) Regulations 2013.

The appropriate authority is required by the legislation above to maintain a register which holds information provided in this form, which can be inspected online or in person by members of the public on request. It may also be required to release information, including personal data and commercial information, on request under the Environmental Information Regulations 2004 or the Freedom of Information Act 2000. However, the appropriate authority will not permit any unwarranted breach of confidentiality nor will they act in contravention of their obligations under the Data Protection Act 1998.

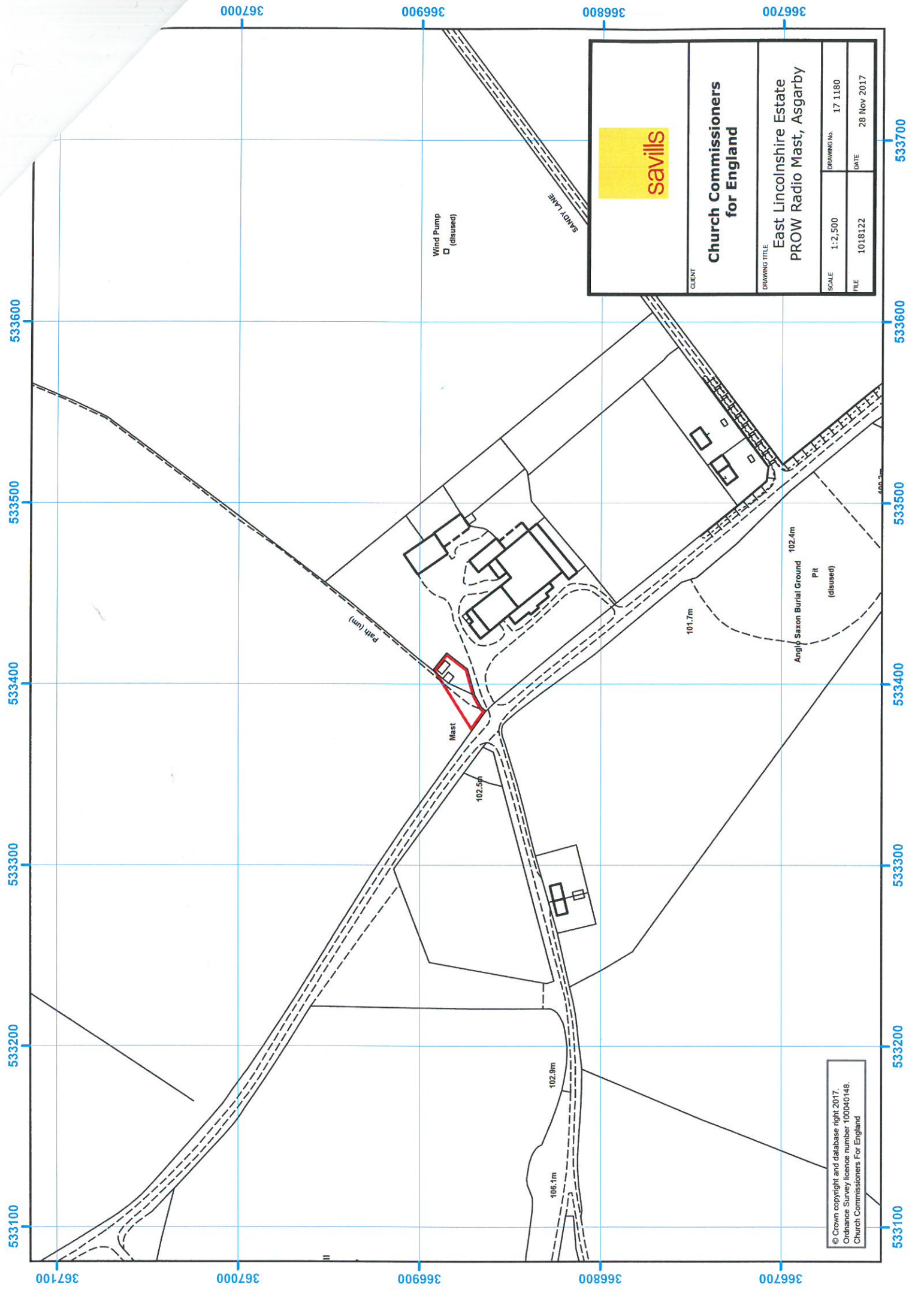

		CLIENT	
		Church Commissioners for England	
DRAWING TITLE		DRAWING No.	DATE
East Lincolnshire Estate PROW Radio Mast, Asgarby		17 1180	28 Nov 2017
SCALE	FILE		
1:2,500	1018122		

© Crown copyright and database right 2017.
 Ordnance Survey licence number 100040148.
 Church Commissioners For England