

Parish: Barlings, Scothern, Stainton by Langworth
Title: Land at Barlings, Scothern, Stainton by Langworth
Reference number: CA/7/1/13

**DEPOSIT OF MAP AND STATEMENT AND STATUTORY DECLARATION(S) UNDER
HIGHWAYS ACT 1980, SECTION 31(6) AND COMMONS ACT 2006, SECTION 15A(1)**

Geographic Location

Grid Reference: TF061770, TF057765, TF057760, TF063787

**Address and postcode
of buildings on the
deposited land**

District West Lindsey

Nearest city or town Lincoln

Highways Act 1980, Section 31(6) deposits

**Date of deposit of map
and statement** 19.01.2004

**Depositor's name and
address** Ms J A Wilkinson: Home Farm, Ashby de la Launde, Lincoln, LN4 3JG & Ms K
N Hutchinson: 8 Lime Tree Gardens, Boston Spa, Leeds, LS23 6DY

**Date of deposit of
declaration, name and
address of depositor** (1) 11.11.2013: Ms J A Wilkinson: Home Farm, Ashby de la Launde, Lincoln,
LN4 3JG & Ms K N Hutchinson: 8 Lime Tree Gardens, Boston Spa, Leeds,
LS23 6DY

Date deposit expires: 10.11.2033

Commons Act 2006, Section 15A(1)

**Date of deposit of map
and statement, name
and address of
depositor** (1) 11.11.2013: Ms J A Wilkinson: Home Farm, Ashby de la Launde, Lincoln,
LN4 3JG & Ms K N Hutchinson: 8 Lime Tree Gardens, Boston Spa, Leeds,
LS23 6DY [*combined deposit*]

COUNTY COUNCIL'S CONTACT DETAILS

Officer and Section: Definitive Map Officer, Public Rights of Way and Countryside Access

Address: Lincolnshire County Council, Communities, 4th Floor, City Hall, Lincoln, LN1
1DN

Telephone: 01522 782070

Email: countryside_access@lincolnshire.gov.uk

REGISTER OF DEPOSITS

The County Council is required by law to keep a register of maps and statements and declarations deposited under Section 31(6) of the Highways Act 1980 and Section 15A(1) of the Commons Act 2006 available for public inspection on its website and in a paper copy format together with the deposited documents. Details including names, addresses and the location of land relating to a deposit which may be considered to be personal information are therefore in the public domain. This requirement overrides any entitlement a depositor may otherwise have under the Data Protection Act 1998 to prevent publication of such information. The paper copy of the register together with the deposited documents can be viewed by appointment during normal office hours (9:00am to 4:30pm, Monday to Friday) at the County Council's Public Rights of Way and Countryside Section at the above address.

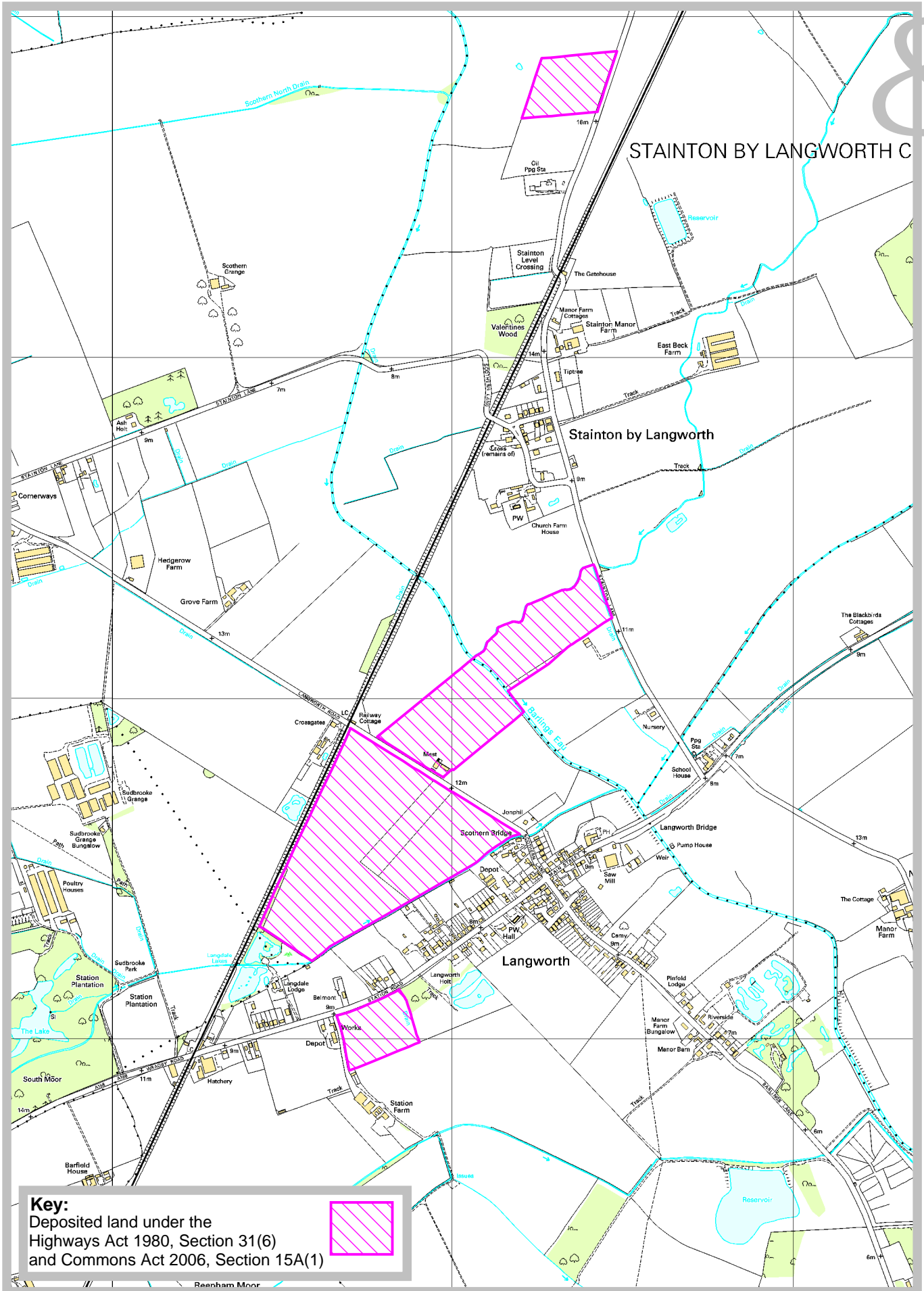

Key:
 Deposited land under the
 Highways Act 1980, Section 31(6)
 and Commons Act 2006, Section 15A(1)

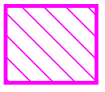

Rights of Way & Countryside Access
 RA Wills, Executive Director for Communities
 City Hall, Orchard Street,
 Lincoln LN1 1DN

**Land at Barlings, Sothorn,
 Stainton by Langworth**

Ref: CA/7/1/13
 Scale: approx. 1:15,000

STATEMENT TO ACCOMPANY A DEPOSIT OF MAP UNDER
SECTION 31(6) HIGHWAYS ACT 1980

PROCEDURE

TO: Lincolnshire County Council
Highways and Planning Directorate
4th Floor
City Hall
Beaumont Fee
LINCOLN
LN1 1DN

RE: land in the parishes of Langworth,
Scothem and Stainton, Lincolnshire
(Description of land affected, including Parish)

* ~~I admit that the undermentioned ways, also shown on the accompanying Map deposited by me with the Lincolnshire County Council on the day of 20 and coloured , have been dedicated as highways.~~

* There are no ways which have been dedicated as highways crossing the land shown on the accompanying map deposited by me with the Lincolnshire County Council.

*Delete as appropriate

Description of Highways (with termini)

.....
.....
.....
.....
.....

Signature of Landowner

Dated the 19th. day of January 2004

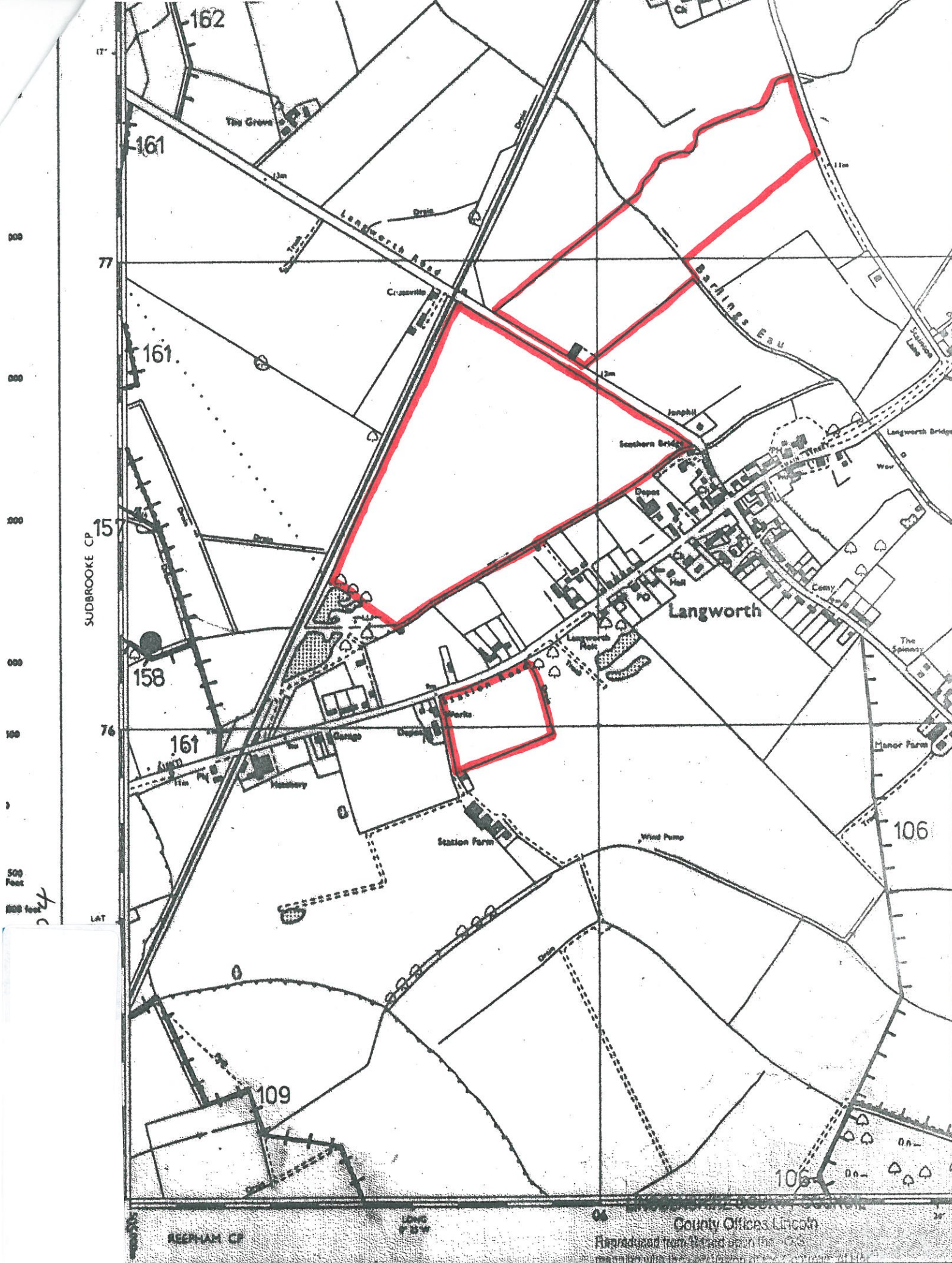

500 Feet
200 feet

SUDBROOKE CP
157
161
162

REEPHAM CP
106
109

LAT
76
77

County Offices Lincoln
Plan adopted from 1874 and open the 1923

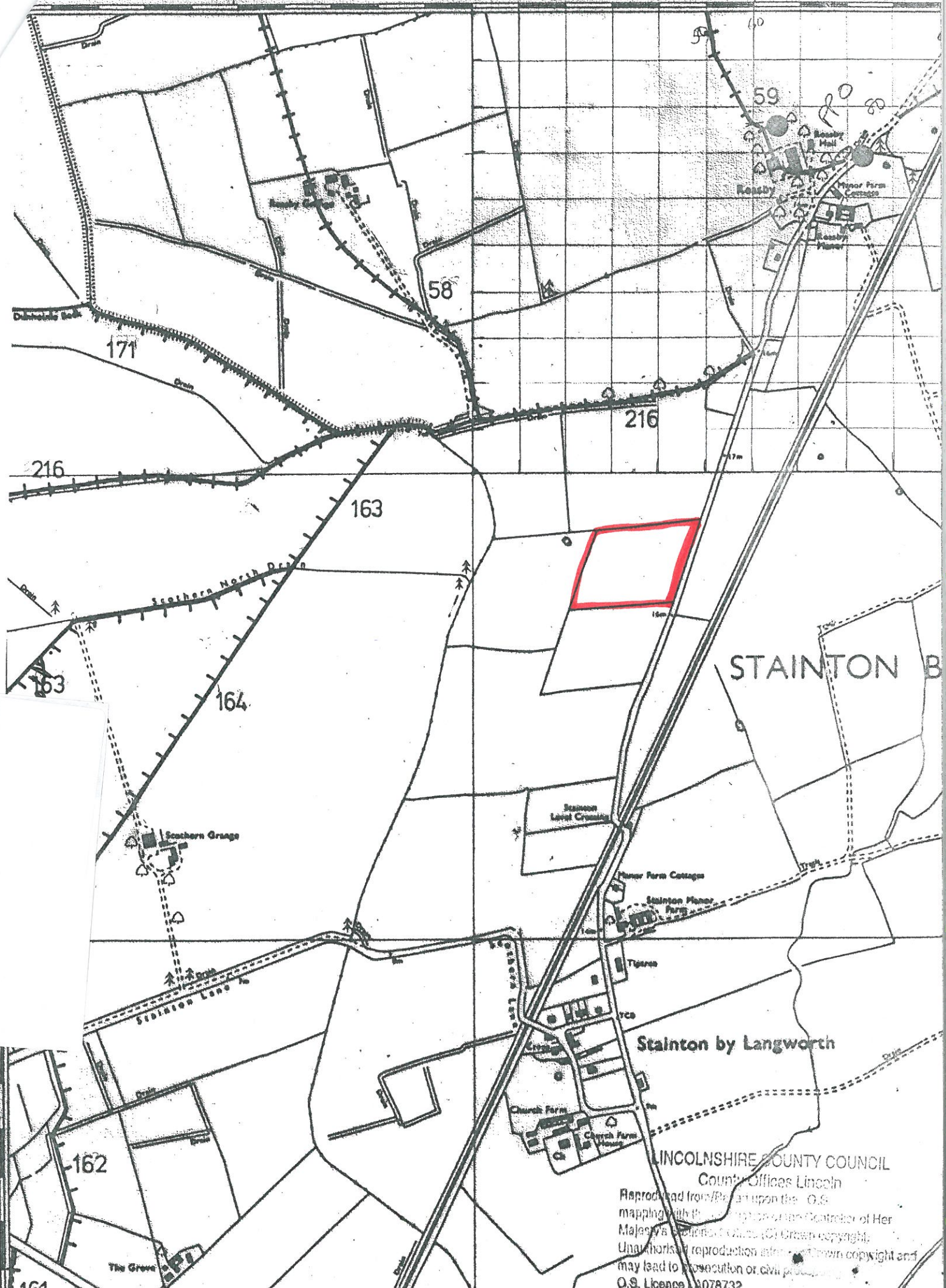

STAINTON B

Stainton by Langworth

LINCOLNSHIRE COUNTY COUNCIL
County Offices Lincoln

Reproduced from/Rebased upon the O.S. mapping with the permission of the Controller of Her Majesty's Stationery Office (© Crown copyright).
Unauthorized reproduction infringes Crown copyright and may lead to prosecution or civil proceedings.
O.S. Licence 1078732

9. An application must be accompanied by the requisite fee – please ask the appropriate authority for details.

10. 'Appropriate authority' means (a) in relation to a map or statement deposited or declaration lodged under section 31(6) of that Act, an appropriate council (as defined in section 31(7) of the Highways Act 1980); and (b) in relation to a statement and map deposited under section 15A(1) of the 2006 Act, a commons registration authority (defined in section 4 of the Commons Act 2006 and section 2 of the Commons Registration Act 1965). In practice, the appropriate council and commons registration authority will usually be the same body.

PART A: Information relating to the applicant and land to which the application relates

(all applicants must complete this Part)

1. Name of appropriate authority to which the application is addressed:

Lincolnshire County Council

2. Name and full address (including postcode) of applicant(s):

Jennifer Anne Wilkinson
Home Farm
Ashby de la Launde
Lincoln
LN4 3JG

and

Katherine Nora Hutchinson
8 Lime Tree Gardens
Boston Spa
Leeds
LS23 6DY

3. Status of applicant(s) (tick relevant box or boxes):

We are

(a) the owner(s) of the land(s) described in paragraph 4.

(b) making this application and the statements/declarations it contains on behalf of [insert name of owner] who is the owner of the land(s) described in paragraph 4 and in my capacity as [insert details].

4. Insert description of the land(s) to which the application relates (including full address and postcode):

Land at Barlings, Scothern and Stainton by Langworth, in the Parishes of Barlings, Scothern and Stainton by Langworth, Lincolnshire, LN3

5. Ordnance Survey six-figure grid reference(s) of a point within the area of land(s) to which the application relates (if known):

Not known

6. This deposit comprises the following statement(s) and/or declarations (*delete Parts B, C,*

or D where not applicable):

Parts C and D (Part B deleted)

PART C: Declaration under section 31(6) of the Highways Act 1980

1. We are the owners of the land described in paragraph 4 of Part A of this form and shown on the map lodged with Lincolnshire County Council on the 19th day of January 2004.
2. On the 19th day of January 2004 Mrs. Jennifer Anne Wilkinson deposited with Lincolnshire County Council, being the appropriate Council, a statement accompanied by a map showing our property which indicated any highways then dedicated to the public (if any).
3. No additional ways have been dedicated over the land on the map referenced in paragraph 1 above since the deposit of the map and statement referred to in paragraph 2 above and at the present time we have no intention of dedicating any more public rights of way over our property.

PART D: Statement under section 15A(1) of the Commons Act 2006

We are the owners of the land described in paragraph 4 of Part A of this form and shown on the map deposited with Lincolnshire County Council on the 19th day of January 2004.

We wish to bring to an end any period during which persons may have indulged as of right in lawful sports and pastimes on the whole or any part of the land shown on the map referenced above.

PART E: Additional information relevant to the application
(insert any additional information relevant to the application)

At the time this application was prepared the Lincolnshire County Council deposit reference number for the land described in paragraph 4 of Part A of this form was CA/7/1/13.

PART F: Statement of Truth
(all applicants must complete this Part)

WARNING: If you dishonestly enter information or make a statement that you know is, or might be, untrue or misleading, and intend by doing so to make a gain for yourself or another person, or to cause loss or the risk of loss to another person, you may commit the offence of fraud under section 1 of the Fraud Act 2006, the maximum penalty for which is 10 years' imprisonment or an unlimited fine, or both.

I BELIEVE THAT THE FACTS AND MATTERS CONTAINED IN THIS FORM ARE TRUE

S _____ **ment of truth):**

Print full name: Jennifer Anne Wilkinson

Date: *5th November 2013.*

Sigr _____ **nt of truth):**

Print full name: Katherine Nora Hutchinson

Date: *6th November 2013*

You should keep a copy of the completed form