

Parish: Crowland
Title: Land in the parish of Crowland
Reference number: CA/7/1/459

HIGHWAYS ACT 1980, SECTION 31 (6) – DEPOSITED MAPS, HIGHWAYS STATEMENT AND HIGHWAYS DECLARATIONS

Date of deposit of map and highways statement 20.07.2018

Depositor's name and address Mr R J Brown, Portland Estate Office, Cavendish House, Welbeck, Worksop, Nottinghamshire, S80 3LL

Dates of deposit of highways declarations and names and addresses of depositors (1) 26.07.2018: Mr R J Brown, Portland Estate Office, Cavendish House, Welbeck, Worksop, Nottinghamshire, S80 3LL

Date deposit expires: 19.07.2038

GEOGRAPHIC LOCATION

Grid Reference: TF291 123

Address and postcode of buildings on the deposited land Cedar Lodge & 1 & 2 Cedar Cottages, Postland, Crowland, PE6 0JX; 1 & 2 Postland Cottages, Postland, Crowland, PE6 0JU; 1 & 2 Cox's Cottages, Postland, Crowland, PE6 0NE, Bank House, Dowsdale Bank, Crowland, PE6 0NF

District South Holland

Nearest city or town Peterborough

ENQUIRIES ABOUT THE REGISTER OR DEPOSITS

Enquiries concerning the register or the deposits lodged with the County Council should be made to the Definitive Map Officer at Lincolnshire County Council's Countryside Services Section by email to countryside_access@lincolnshire.gov.uk or by telephone on 01522 782070.

INFORMATION ABOUT THE REGISTER OF DEPOSITS

The County Council is required by law to keep and maintain a register of highways statements and highways declarations deposited under section 31 (6) of the Highways Act 1980 and landowner statements deposited under section 15A (1) of the Commons Act 2006. The register is available for public inspection on its website and in a paper copy format, together with copies of the deposited documents. Details, including names, addresses and the location of land relating to an application, which may be considered to be personal information, will therefore be in the public domain. This requirement overrides any entitlement a depositor and landowner may otherwise have under the Data Protection Act 1998 to prevent the publication of such information.

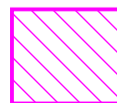
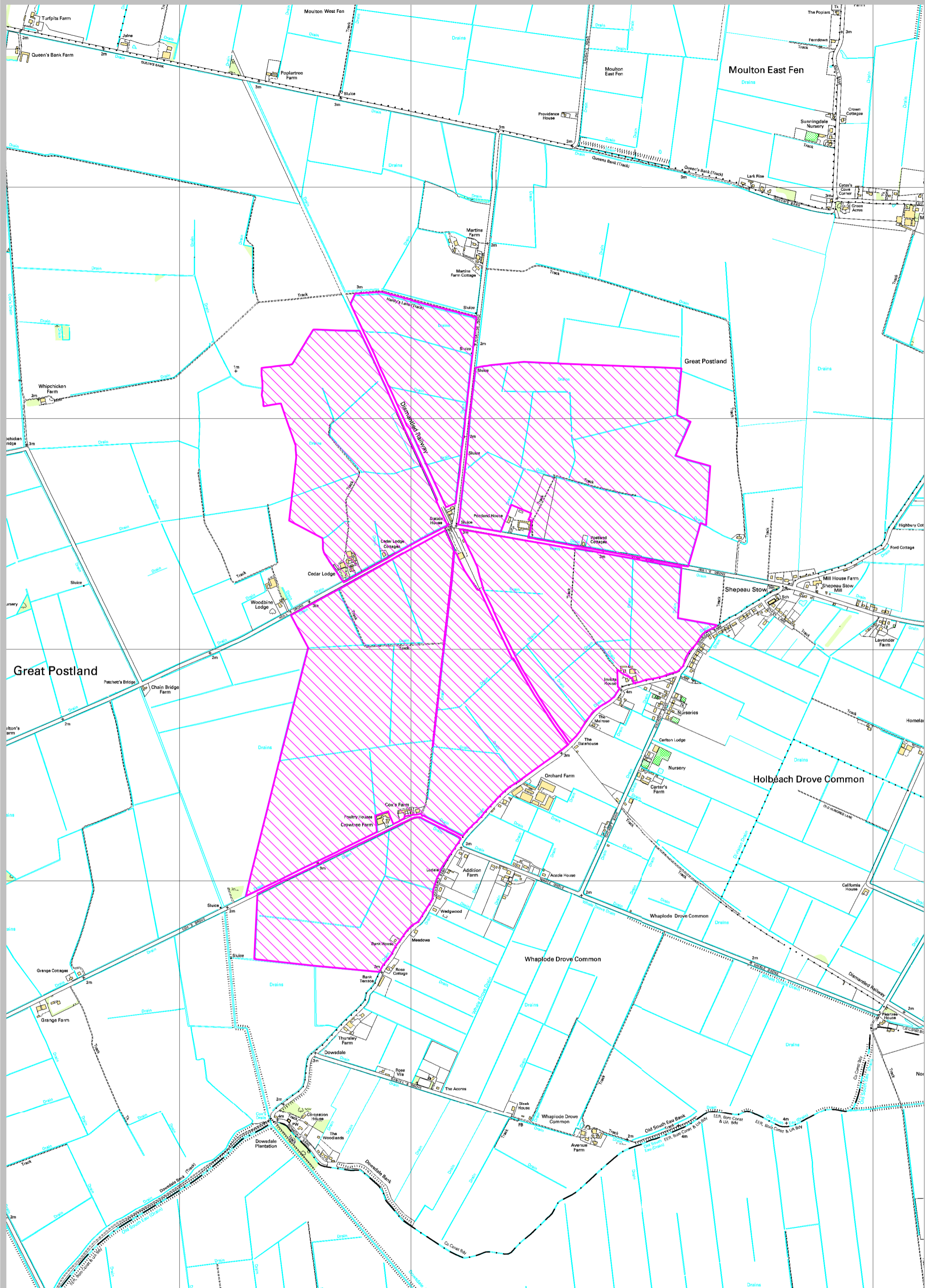

10. 'Appropriate authority' means (a) in relation to a map or statement deposited or declaration lodged under section 31(6) of that Act, an appropriate council (as defined in section 31(7) of the Highways Act 1980); and (b) in relation to a statement and map deposited under section 15A(1) of the 2006 Act, a commons registration authority (defined in section 4 of the Commons Act 2006 and section 2 of the Commons Registration Act 1965). In practice, the appropriate council and commons registration authority will usually be the same body.

**PART A: Information relating to the applicant and land to which the application relates
(all applicants must complete this Part)**

1. Name of appropriate authority to which the application is addressed: Lincolnshire County Council

2. Name and full address (including postcode) of applicant: Robin James Brown
Portland Estate Office
Cavendish House
Welbeck
Worksop
Nottinghamshire
S80 3LL

3. Status of applicant (tick relevant box or boxes):

I am

(a) the owner of the land(s) described in paragraph 4.

(b) making this application and the statement it contains on behalf of The Trustees of the Parente 1983 Children's Settlement who are the owners of the land(s) described in paragraph 4 and in my capacity as Managing Agent.

4. Insert description of the land(s) to which the application relates (including full address and postcode):
Land in the parish of Crowland.

5. Ordnance Survey six-figure grid reference(s) of a point within the area of land(s) to which the application relates (if known): NGR 528849, 311919.

6. This deposit comprises the following highways statement Part B:

PART B: Statement under section 31(6) of the Highways Act 1980

The Trustees of the Parente 1983 Children's Settlement are the owners of the land described in paragraph 4 of Part A of this form and shown edged red on the map accompanying this statement.

No ways over the land shown edged red on the accompanying map have been dedicated as highways.

PART E: Additional information relevant to the application
(insert any additional information relevant to the application)

PART F: Statement of Truth
(all applicants must complete this Part)

WARNING: If you dishonestly enter information or make a statement that you know is, or might be, untrue or misleading, and intend by doing so to make a gain for yourself or another person, or to cause loss or the risk of loss to another person, you may commit the offence of fraud under section 1 of the Fraud Act 2006, the maximum penalty for which is 10 years' imprisonment or an unlimited fine, or both.

I BELIEVE THAT THE FACTS AND MATTERS CONTAINED IN THIS FORM ARE TRUE

Signature (of the person making the statement of truth):

Print full name: Robin James Brown

Date: 19 / 07 / 2018

You should keep a copy of the completed form



Data Protection Act 1998 - Fair Processing Notice

The purpose of this Fair Processing Notice is to inform you of the use that will be made of your personal data, as required by the Data Protection Act 1998.

The appropriate authority (see explanation of definition in above guidance notes) in England is the data controller in respect of any personal data that you provide when you complete this form.

The information that you provide will be used by the appropriate authority in its duties to process applications to deposit statements, maps and declarations under section 31(6) the Highways Act 1980 and statements under section 15A(1) of the Commons Act 2006. The information you provide will also be used by the appropriate authority in its duty to update the registers in which details of such deposits are recorded under the Dedicated Highways (Registers under Section 31A of the Highways Act 1980) (England) Regulations 2007 and the Commons (Registration of Town or Village Greens) and Dedicated Highways (Landowner Statements and Declarations) (England) Regulations 2013.

The appropriate authority is required by the legislation above to maintain a register which holds information provided in this form, which can be inspected online or in person by members of the public on request. It may also be required to release information, including personal data and commercial information, on request under the Environmental Information Regulations 2004 or the Freedom of Information Act 2000. However, the appropriate authority will not permit any unwarranted breach of confidentiality nor will they act in contravention of their obligations under the Data Protection Act 1998.

Key

 Trustees of the Parente 1983 Children's Settlement Ownership



The western edge of the map is 1° 30' 23.27" due east of true north

The grid at the eastern edge of the map is 1° 32' 36.85" due east of true north

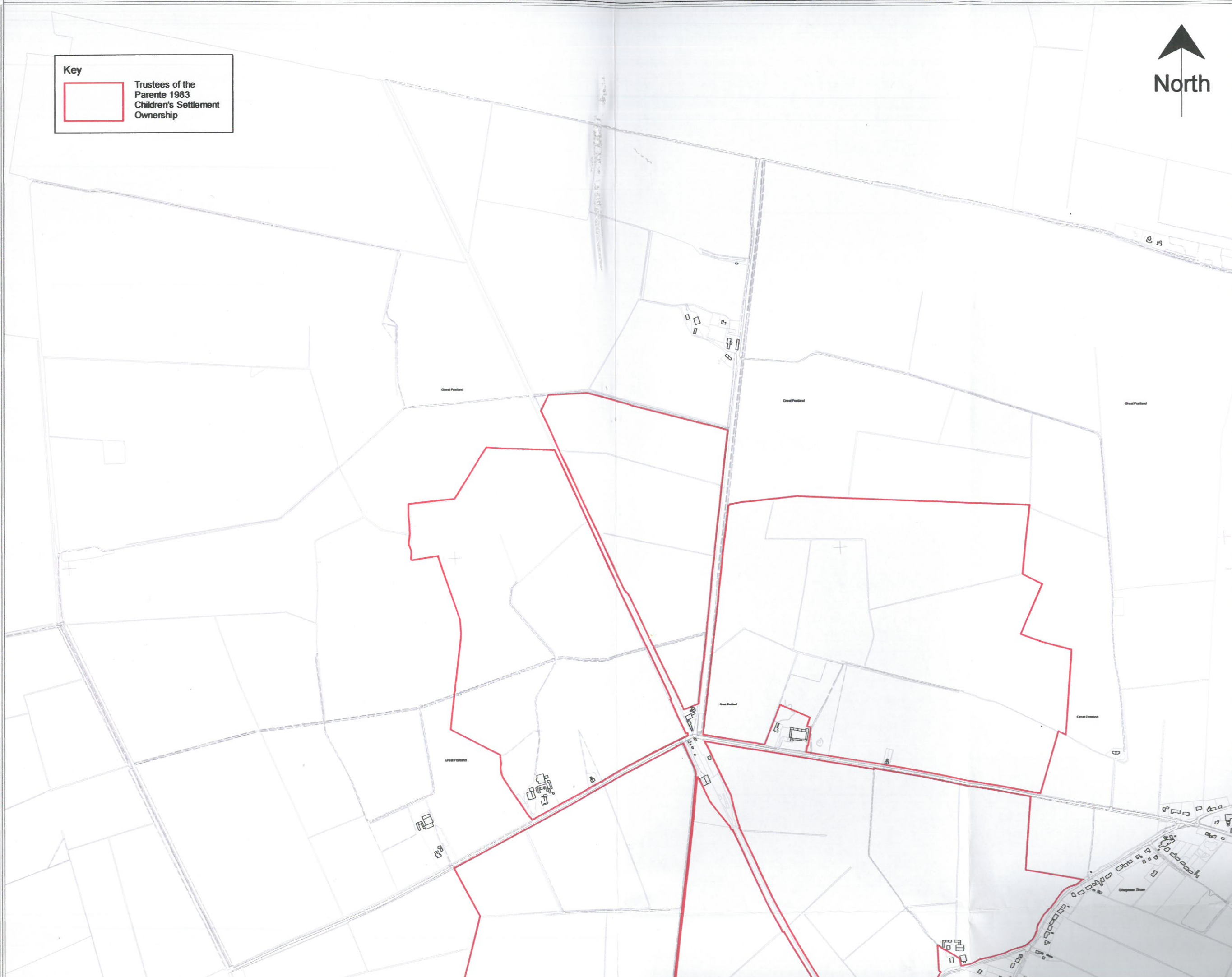

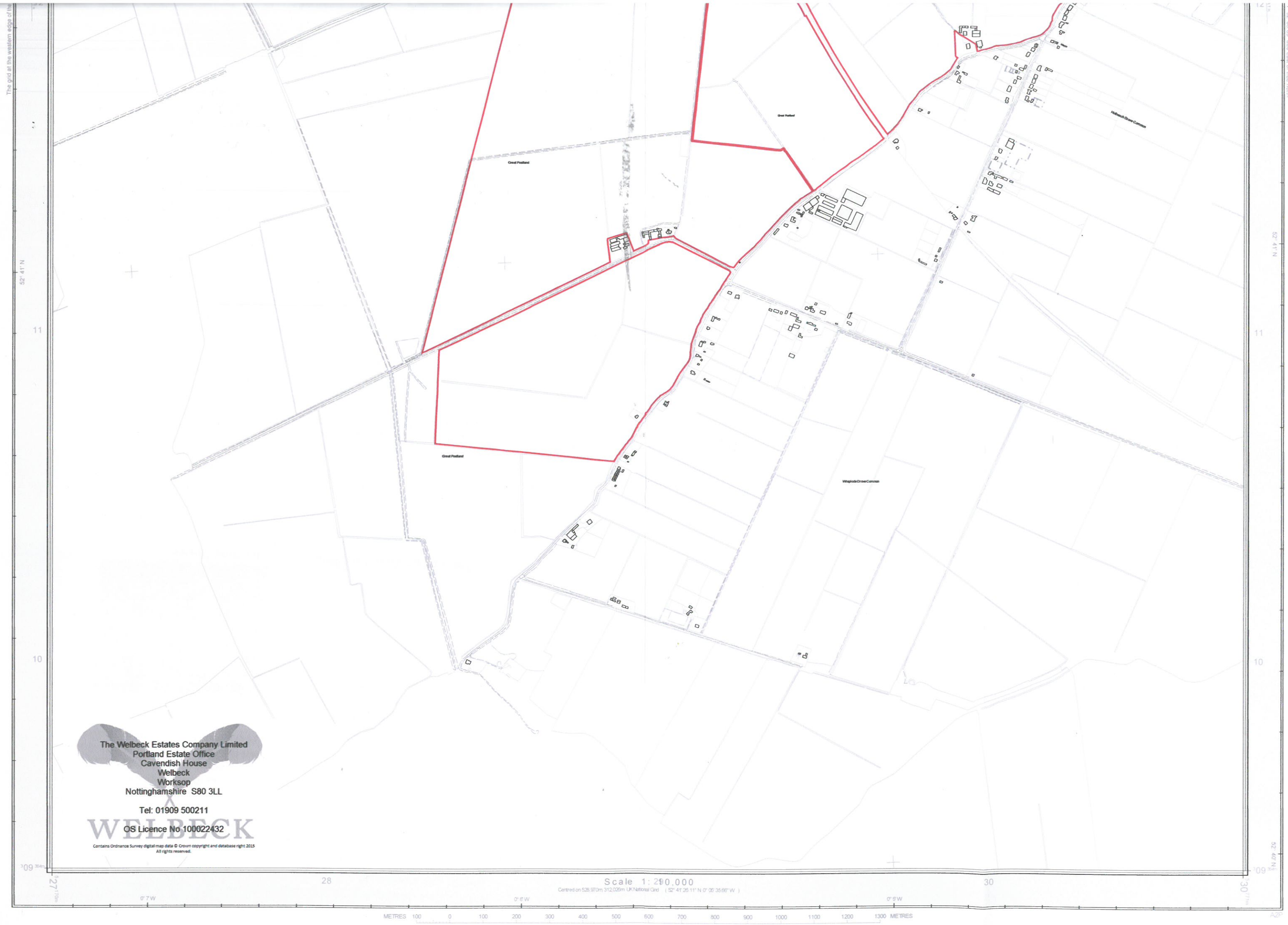

The grid at the western edge of the

1° 27' 56.85" due east of true north

52° 41' N

52° 41' N

11

11

10

10

The Welbeck Estates Company Limited
Portland Estate Office
Cavendish House
Welbeck
Worksop
Nottinghamshire S80 3LL

Tel: 01909 500211

WELBECK

OS Licence No 100022432

Contains Ordnance Survey digital map data © Crown copyright and database right 2015
All rights reserved.

09

09

0° 7' W

0° 6' W

0° 5' W

28

30

Scale 1:200,000

Centred on 528 970m 312,020m UK National Grid (52° 41' 26.11" N 0° 26' 35.86" W)

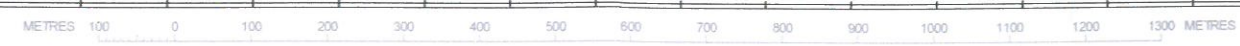

10. 'Appropriate authority' means (a) in relation to a map or statement deposited or declaration lodged under section 31(6) of that Act, an appropriate council (as defined in section 31(7) of the Highways Act 1980); and (b) in relation to a statement and map deposited under section 15A(1) of the 2006 Act, a commons registration authority (defined in section 4 of the Commons Act 2006 and section 2 of the Commons Registration Act 1965). In practice, the appropriate council and commons registration authority will usually be the same body.

**PART A: Information relating to the applicant and land to which the application relates
(all applicants must complete this Part)**

1. Name of appropriate authority to which the application is addressed: Lincolnshire County Council

2. Name and full address (including postcode) of applicant: Robin James Brown
Portland Estate Office
Cavendish House
Welbeck
Worksop
Nottinghamshire
S80 3LL

3. Status of applicant (tick relevant box or boxes):

I am

(a) the owner of the land(s) described in paragraph 4.

(b) making this application and the statements/declarations it contains on behalf of The Trustees of the Parente 1983 Children's Settlement who are the owners of the land(s) described in paragraph 4 and in my capacity as Managing Agent.

4. Insert description of the land(s) to which the application relates (including full address and postcode):
Land in the parish of Crowland.

5. Ordnance Survey six-figure grid reference(s) of a point within the area of land(s) to which the application relates (if known): NGR 528849, 311919.

6. This deposit comprises the following highways declaration Part C:

PART B: Statement under section 31(6) of the Highways Act 1980

[I am/[insert name of owner] is] the owner of the land described in paragraph 4 of Part A of this form and shown [insert colouring] on the map accompanying this statement.
(delete wording in square brackets as appropriate and/or insert information as required)

[Ways shown [insert colouring] on the accompanying map are byways open to all traffic.]

[Ways shown [insert colouring] on the accompanying map are restricted byways.]

[Ways shown [insert colouring] on the accompanying map are public bridleways.]

[Ways shown [insert colouring] on the accompanying map are public footpaths.]

No [other] ways over the land shown [insert colouring] on the accompanying map have been dedicated as highways.

(delete wording in square brackets as appropriate and/or insert information as required)

PART C: Declaration under section 31(6) of the Highways Act 1980

1. The Trustees of the Parente 1983 Children's Settlement are the owners of the land described in paragraph 4 of Part A of this form and shown edged red on the map lodged with Lincolnshire County Council on 20th July 2018.

2. On the 20th day of July 2018 I deposited with Lincolnshire County Council, being the appropriate council, a statement accompanied by a map showing The Trustees of the Parente 1983 Children's Settlement property edged red which stated that:

no ways had been dedicated as highways over The Trustees of the Parente 1983 Children's Settlement property.

*[3. On the [insert day] day of [insert month, year] [I/my/[insert name of owner's] predecessor in title [insert name]] deposited with [insert name] Council, being the appropriate council, a declaration dated [insert day, month, year], stating that no additional ways [other than those marked in the appropriate colour on the map accompanying that declaration] had been dedicated as [byways open to all traffic] [restricted byways] [bridleways] [footpaths] since the deposit of the statement referred to in paragraph 2 above.]
(delete if not applicable and delete wording in square brackets as appropriate and/or insert information as required)*

4. No additional ways have been dedicated over the land edged red on the map referred to in paragraph 1 above since the statement dated 19th July 2018 referred to in paragraph 2 above and at the present time The Trustees of the Parente 1983 Children's Settlement have no intention of dedicating any more public rights of way over the property.

PART D: Statement under section 15A(1) of the Commons Act 2006

[I am/[insert name of owner] is] the owner of the land described in paragraph 4 of Part A of this form and shown [insert colouring] on the map [accompanying this statement/deposited with [insert name] Council on [insert day, month, year]].

*[I/[insert name of owner]] [wish/wishes] to bring to an end any period during which persons may have indulged as of right in lawful sports and pastimes on the whole or any part of the land shown [insert colouring] on the [accompanying map/map referenced above].
(delete wording in square brackets as appropriate and/or insert information as required)*

PART E: Additional information relevant to the application
(insert any additional information relevant to the application)

PART F: Statement of Truth
(all applicants must complete this Part)

WARNING: If you dishonestly enter information or make a statement that you know is, or might be, untrue or misleading, and intend by doing so to make a gain for yourself or another person, or to cause loss or the risk of loss to another person, you may commit the offence of fraud under section 1 of the Fraud Act 2006, the maximum penalty for which is 10 years' imprisonment or an unlimited fine, or both.

I BELIEVE THAT THE FACTS AND MATTERS CONTAINED IN THIS FORM ARE TRUE

Signature (of the person making the statement of truth):

Print full name: Robin James Brown

Date: 23/07/2018

You should keep a copy of the completed form

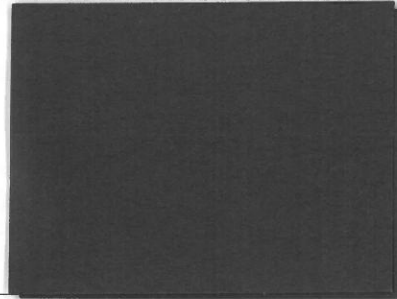

Data Protection Act 1998 - Fair Processing Notice

The purpose of this Fair Processing Notice is to inform you of the use that will be made of your personal data, as required by the Data Protection Act 1998.

The appropriate authority (see explanation of definition in above guidance notes) in England is the data controller in respect of any personal data that you provide when you complete this form.

The information that you provide will be used by the appropriate authority in its duties to process applications to deposit statements, maps and declarations under section 31(6) the Highways Act 1980 and statements under section 15A(1) of the Commons Act 2006. The information you provide will also be used by the appropriate authority in its duty to update the registers in which details of such deposits are recorded under the Dedicated Highways (Registers under Section 31A of the Highways Act 1980) (England) Regulations 2007 and the Commons (Registration of Town or Village Greens) and Dedicated Highways (Landowner Statements and Declarations) (England) Regulations 2013.

The appropriate authority is required by the legislation above to maintain a register which holds information provided in this form, which can be inspected online or in person by members of the public on request. It may also be required to release information, including personal data and commercial information, on request under the Environmental Information Regulations 2004 or the Freedom of Information Act 2000. However, the appropriate authority will not permit any unwarranted breach of confidentiality nor will they act in contravention of their obligations under the Data Protection Act 1998.