

DEPOSIT OF STATEMENT AND MAP

SECTION 31(6) OF THE HIGHWAYS ACT 1980

To: Lincolnshire County Council,
Highways and Planning Directorate,
County Offices,
Newland,
Lincoln,
LN1 1YL

1. Mark Caudwell Limited is the owner within the meaning of the above Section of land in the Parishes of Habertoft, Hogsthorpe, Addlethorpe, Orby and Burgh-le-Marsh in the County of Lincoln more particularly delineated on the map accompanying this statement and thereon edged in black.

2. The ways coloured green on the said map have been dedicated as bridleways.

3. The ways coloured red on the said map have been dedicated as footpaths.

No other ways over the land have been dedicated as highways.

4. The deposit shall comprise this statement and the accompanying map.

Signed



.....
Director for and on behalf of
Mark Caudwell Limited
Howlett House Farm, Slackholme End,
Hogsthorpe, Skegness, Lincs. PE24 5NS

Date 30/12/00

In the presence of:-

Witness' signature



Name

IAN SOMALLEY

Address

BRYERS PATCH
MUMBY RD
HUTCH

Occupation

LANDWORKER.

HOWLETT HOUSE
and Land at
BURGH - LE - MARSH

*= Boundary
of all Land owned
by Mark Caudwell*



SCALE : 1:10,000.

= Public Footpaths
= Highway - FarmTrack



Lane Fox

REVISION

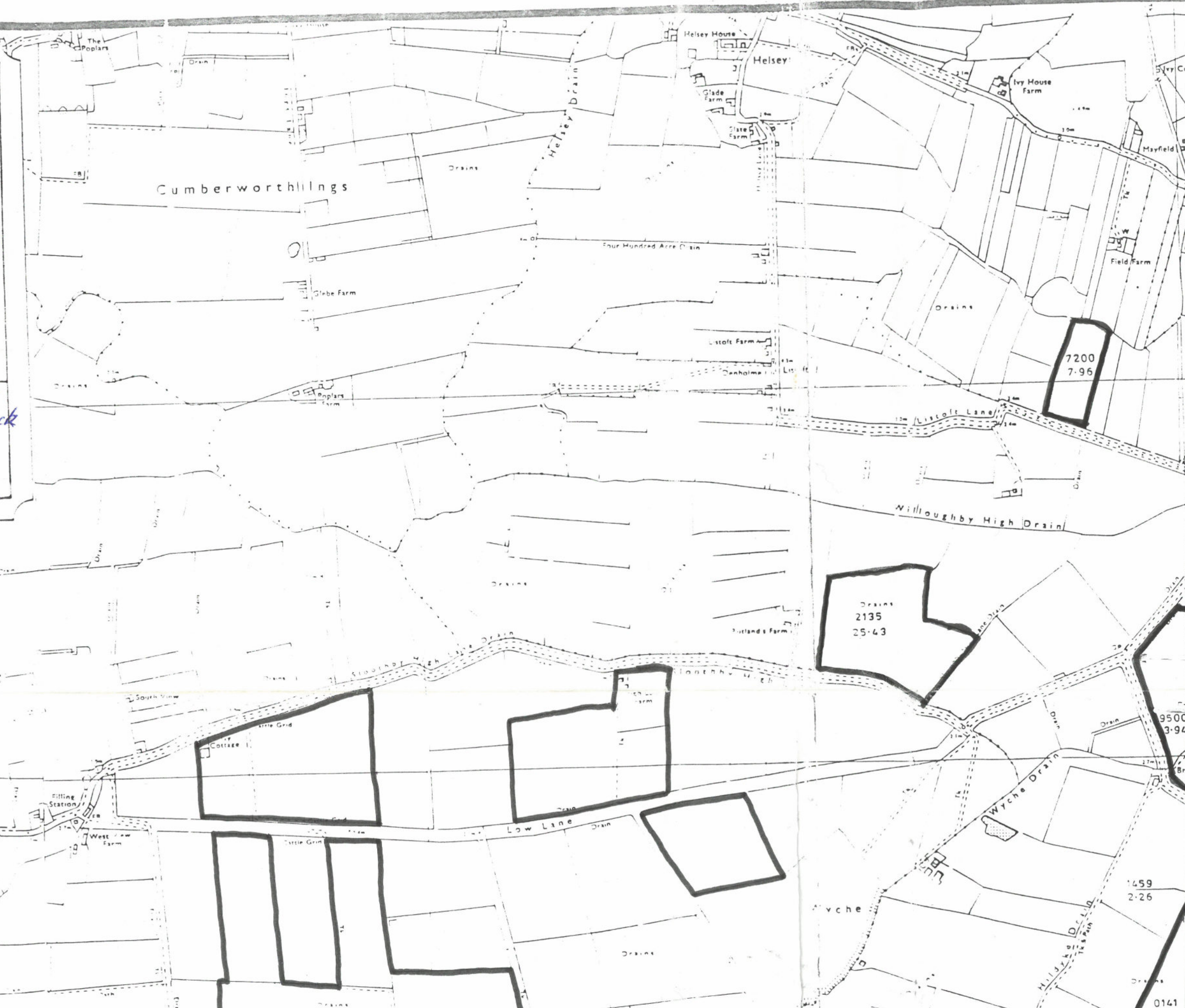

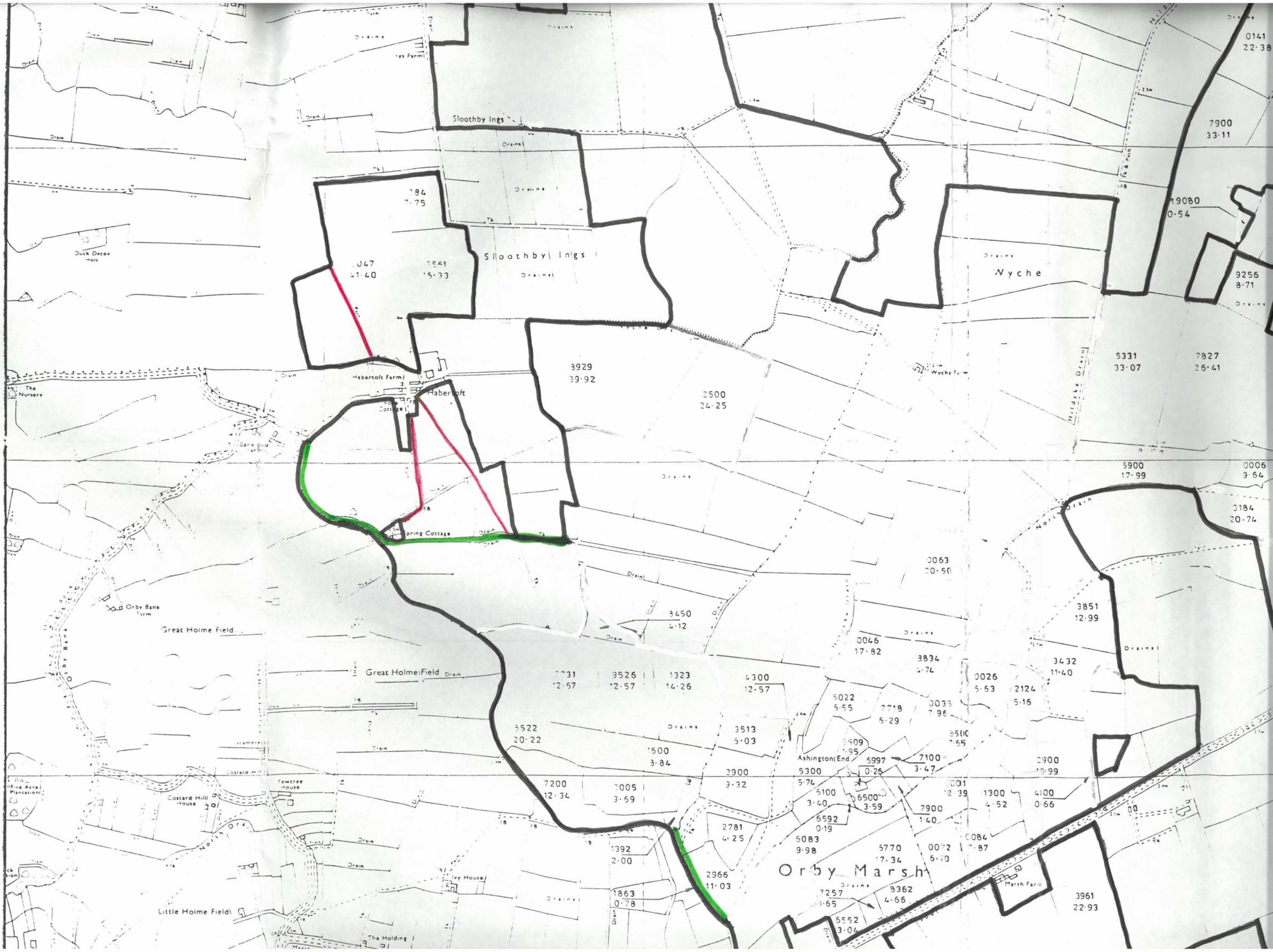

Sloothby Ings

Wyche

Haberloft Farm

Haberloft

Spring Cottage

Great Holme Field

Great Holme Field

Orby Marsh

784
7.75

047
41.40

041
15.33

3929
39.92

2500
24.25

3450
4.12

031
12.67

9526
12.57

1323
14.26

4300
12.57

5522
20.22

1600
3.84

3513
5.03

7200
12.34

0005
3.69

2900
3.32

1392
2.00

2781
4.25

1863
0.78

2966
11.03

5022
5.55

7718
6.29

0035
7.96

509
1.95

5083
9.98

5997
0.26

5770
17.34

6592
0.19

7257
1.65

7100
3.47

7900
1.40

5300
5.74

6552
3.04

0026
5.63

8500
7.65

0001
12.39

0072
6.70

2124
5.16

1300
4.52

4100
0.66

3432
11.40

2900
10.99

0084
1.87

0084
1.87

3961
22.93

5331
33.07

5900
17.99

0063
20.50

0046
17.82

0035
7.96

0001
12.39

0072
6.70

7900
33.11

19080
0.54

7827
26.41

0006
3.64

0184
20.74

3851
12.99

3834
4.74

0026
5.63

2900
10.99

4100
0.66

0084
1.87

3961
22.93

0141
22.38

7900
33.11

9256
8.71

7827
26.41

0006
3.64

0184
20.74

3851
12.99

3834
4.74

0026
5.63

2900
10.99

4100
0.66

0084
1.87

3961
22.93

REPRODUCED FROM THE ORDNANCE SURVEY MAP WITH THE SANCTION OF THE CONTROLLER OF HER MAJESTY'S STATIONERY OFFICE CROWN COPYRIGHT RESERVED.

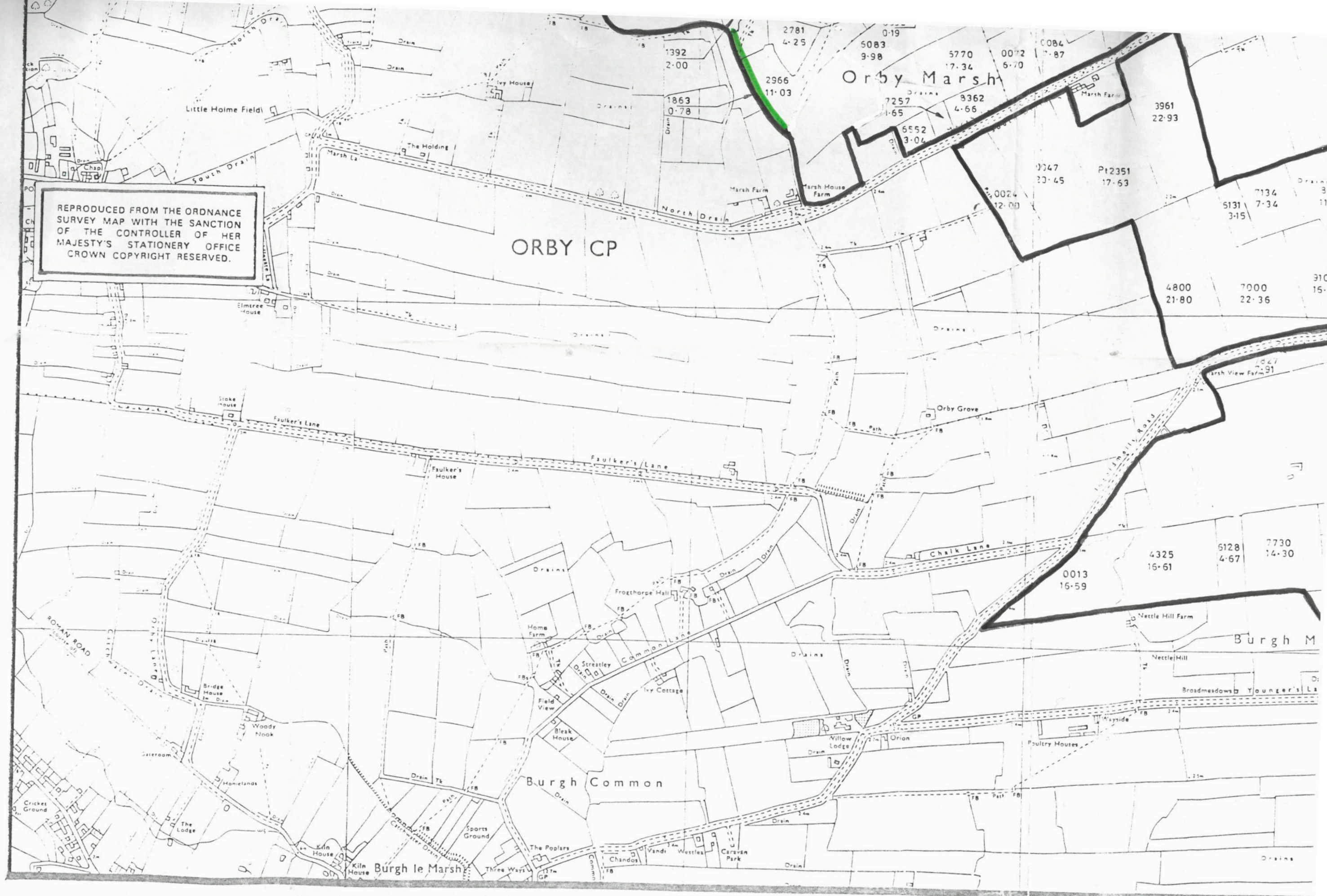

ORBY CP

Orby Marsh

Burgh Common

Burgh le Marsh

Burgh M

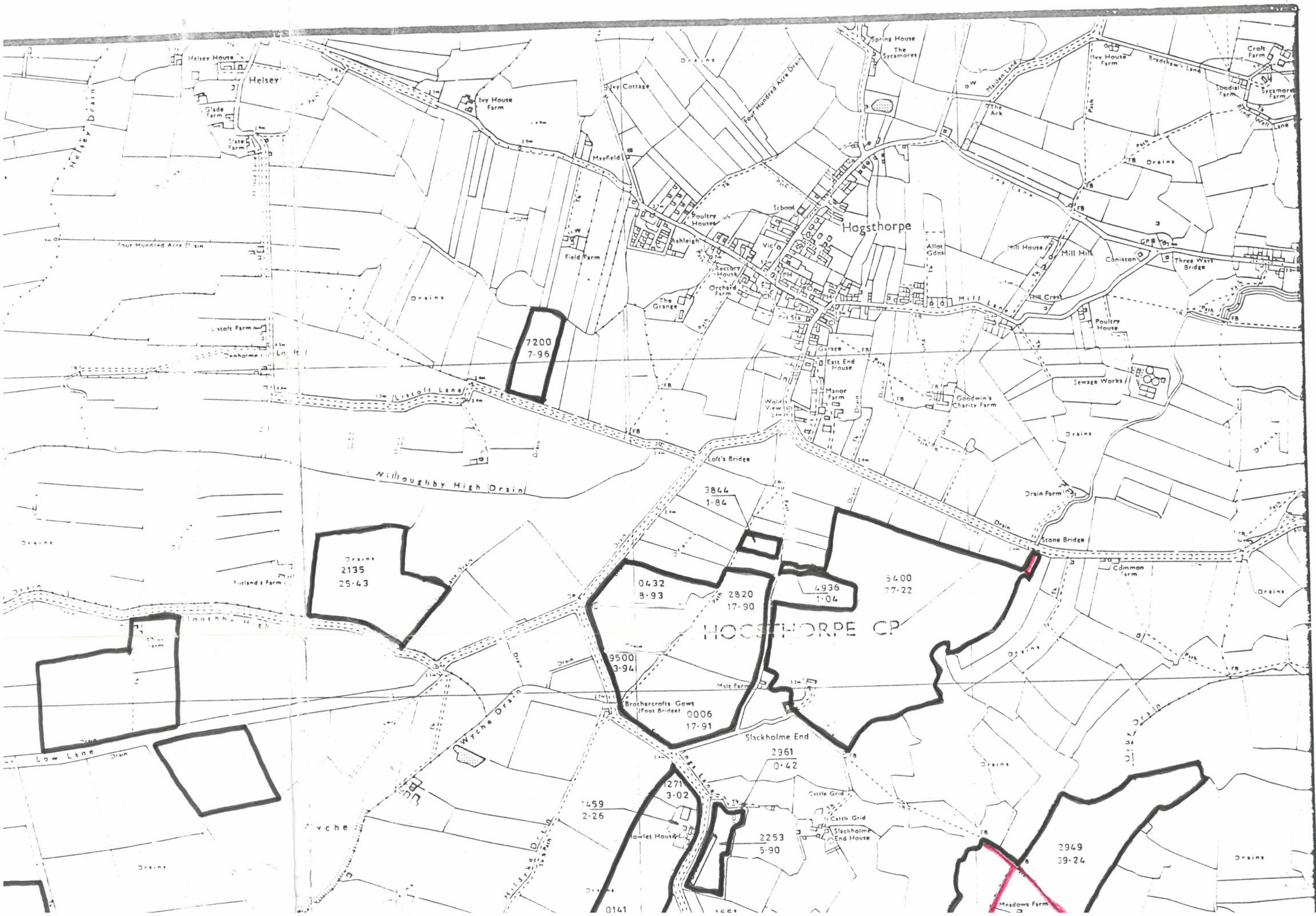

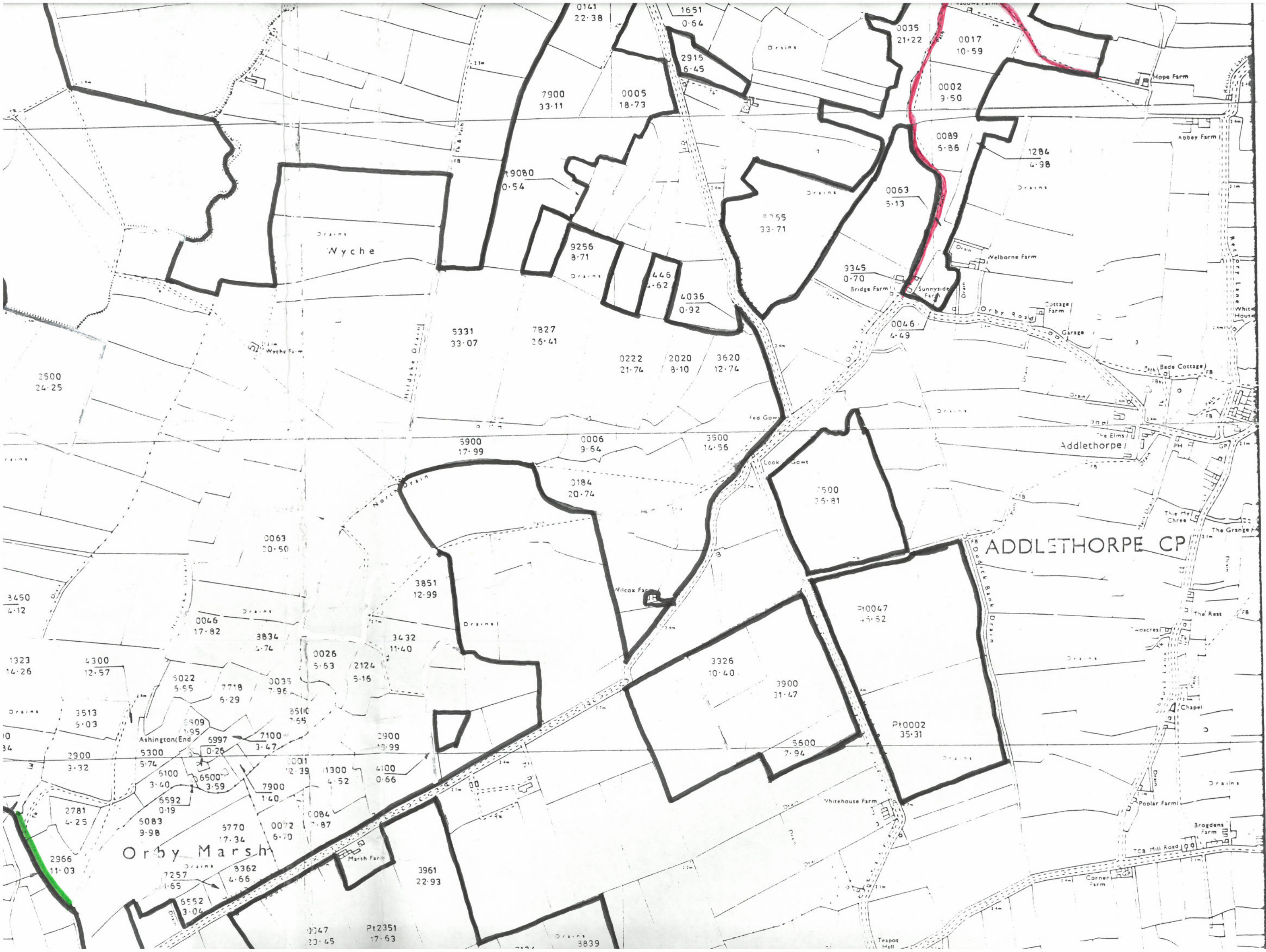

Wyche

ADDLETHORPE CP

Orby Marsh

2500
24.25

7900
33.11

0005
18.73

2915
6.45

0035
21.22

0017
10.59

0002
9.50

0089
5.86

1284
4.98

0063
5.13

9256
8.71

446
1.62

4036
0.92

9345
0.70

0046
4.49

5331
33.07

7827
26.41

0222
21.74

2020
8.10

3620
12.74

5900
17.99

0006
9.64

3500
14.56

0184
20.74

7500
25.81

0063
20.50

3851
12.99

Pt0047
45.52

3450
4.12

0046
17.82

3834
4.74

0026
5.63

3432
11.40

2124
5.16

3326
10.40

3900
31.47

1323
14.26

4300
12.57

5022
5.55

7718
6.29

0033
7.96

3510
7.65

2900
12.99

10
34

3513
5.03

Ashington(End)

5300
5.74

5997
0.26

7100
3.47

0001
12.39

1300
4.52

4100
0.66

2900
3.32

5100
3.40

6500
3.59

7900
1.40

2781
4.25

5083
9.98

5770
17.34

0072
6.70

0084
7.87

0084
7.87

2966
11.03

7257
1.65

8362
4.66

3961
22.93

6552
3.04

0047
20.45

Pt2351
17.63

3839

Orby Marsh

Burgh Marsh

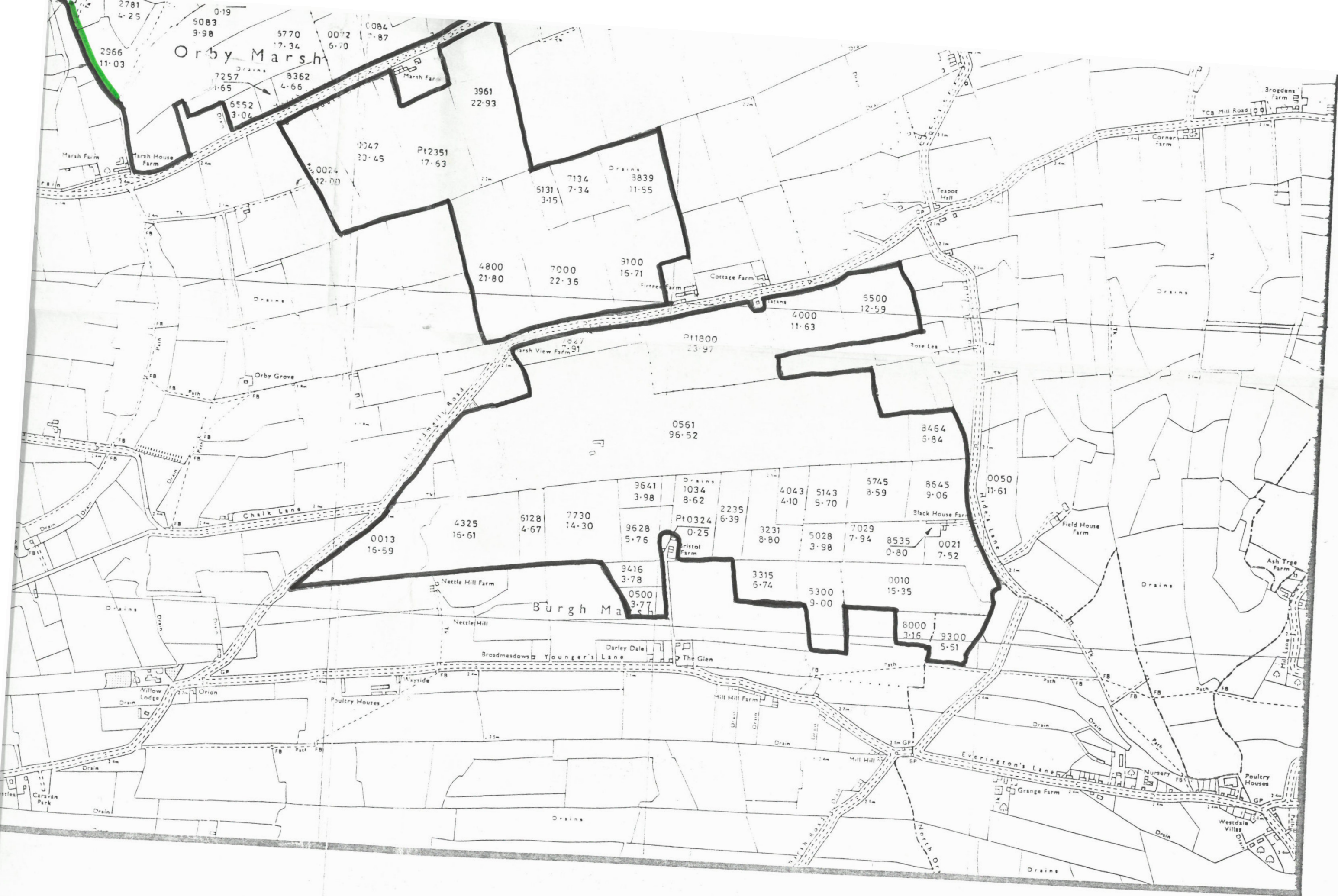

2781 4-25
5083 9-98
0-19
5770 17-34
0072 6-70
0084 7-87

7257 1-65
6552 3-04
8362 4-66

3961 22-93

0047 20-45
Pt2351 17-63

7134 7-34
5131 3-15
3839 11-55

4800 21-80
7000 22-36
3100 15-71

5500 12-59
4000 11-63

0561 96-52

8464 5-84

4325 15-61
6128 4-67
7730 14-30

9641 3-98
1034 8-62
2235 6-39

4043 4-10
5143 5-70
5745 8-59
8645 9-06

0050 11-61

0013 15-59

9416 3-78
0500 3-77

3231 8-80
5028 3-98
7029 7-94
8535 0-80
0021 7-52

3416 3-78
0500 3-77

3315 6-74
5300 9-00
0010 15-35

8000 3-16
9300 5-51

Willow Lodge

Poultry Houses

Mill Hill Farm

Grange Farm

Nursery

Poultry Houses

Westdale Villas