

Parish: Skegness
Title: Land at Woodlands Caravan Park
Reference number: CA/7/1/245

HIGHWAYS ACT 1980, SECTION 31 (6) – DEPOSITED MAPS, HIGHWAYS STATEMENT AND HIGHWAYS DECLARATIONS

Date of deposit of map and highways statement 31.07.2006

Depositor's name and address Mr P Holmes, Blue Anchor Leisure Ltd. Eastgate Holiday Centre, Sea Lane, Ingoldmells, Skegness, Lincolnshire, PE25 1RH

Dates of deposit of highways declarations and names and addresses of depositors (1) 24.10.2006: Mr P Holmes, Blue Anchor Leisure Ltd. Eastgate Holiday Centre, Sea Lane, Ingoldmells, Skegness, Lincolnshire, PE25 1RH
(2) 01.08.2016: Mr P Holmes, Blue Anchor Leisure Ltd. Robin Hood Park, South Road, Chapel St. Leonards, Skegness, Lincolnshire, PE24 5TR

Date deposit expires: 31.07.2036

COMMONS ACT 2006, SECTION 15A (1) – DEPOSITED MAPS AND LANDOWNER STATEMENTS

Dates of deposit of maps and landowner statements, and names and addresses of depositors (1) 01.08.2016: Mr P Holmes, Blue Anchor Leisure Ltd. Robin Hood Park, South Road, Chapel St. Leonards, Skegness, Lincolnshire, PE24 5TR
[combined deposit]

GEOGRAPHIC LOCATION

Grid Reference: TF568 661

Address and postcode of buildings on the deposited land

District East Lindsey

Nearest city or town Skegness

ENQUIRIES ABOUT THE REGISTER OR DEPOSITS

Enquiries concerning the register or the deposits lodged with the County Council should be made to the Definitive Map Officer at Lincolnshire County Council's Countryside Services Section by email to countryside_access@lincolnshire.gov.uk or by telephone on 01522 782070.

INFORMATION ABOUT THE REGISTER OF DEPOSITS

The County Council is required by law to keep and maintain a register of highways statements and highways declarations deposited under section 31 (6) of the Highways Act 1980 and landowner statements deposited under section 15A (1) of the Commons Act 2006. The register is available for public inspection on its website and in a paper copy format, together with copies of the deposited documents. Details, including names, addresses and the location of land relating to an application, which may be considered to be personal information, will therefore be in the public domain. This requirement overrides any entitlement a depositor and landowner may otherwise have under the Data Protection Act 1998 to prevent the publication of such information.

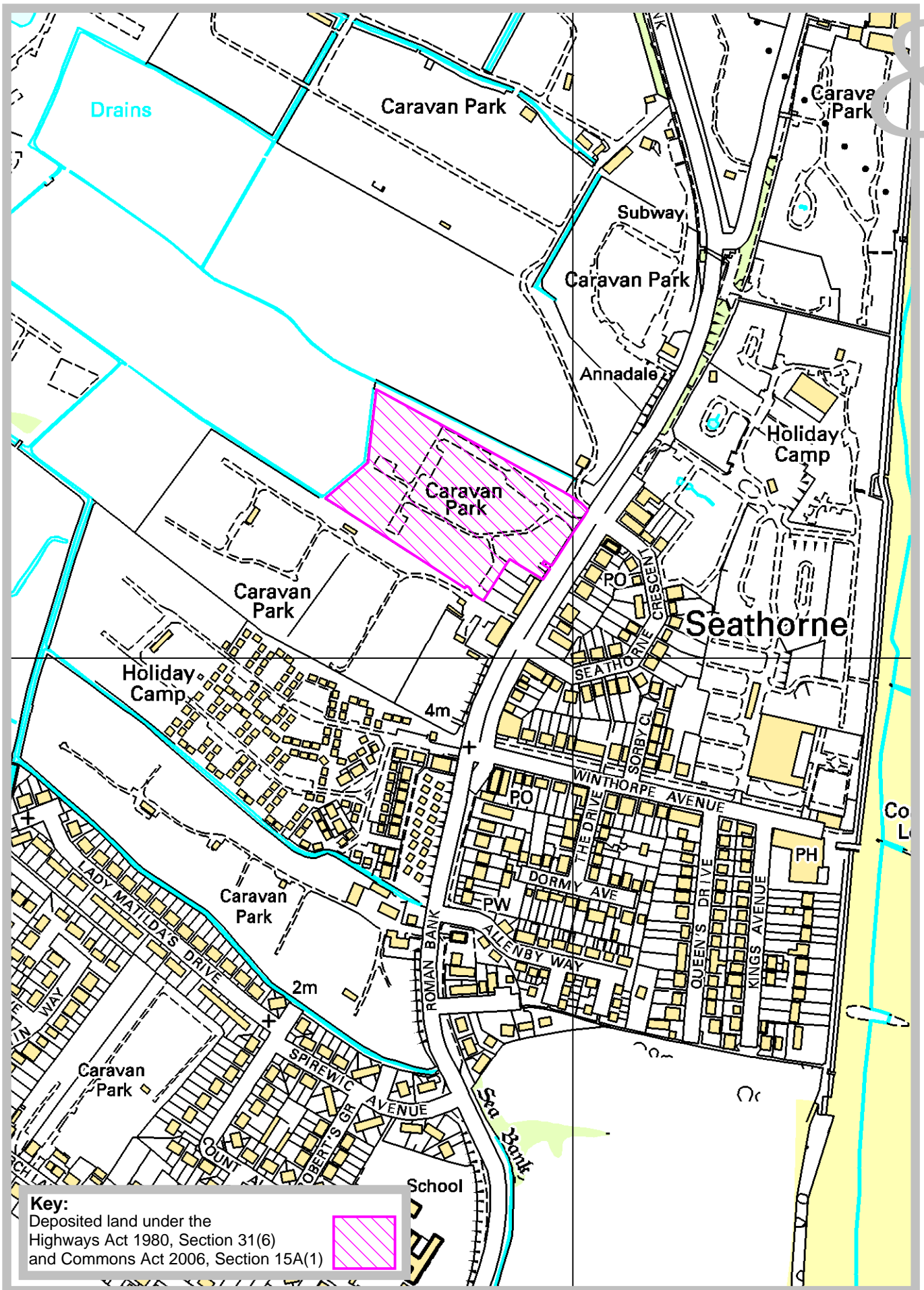

APPENDIX 1

STATEMENT IN RESPECT OF SECTION 31(6)
OF THE HIGHWAYS ACT 1980

To: The Director of Recreational Services
Lincolnshire County Council
County Offices
Newland
Lincoln LN1 1YL

1. I am the director and secretary of Blue Anchor Leisure Ltd (Co Reg No 010916555) whose registered office is situate at Eastgate Holiday Centre, Sea Lane, Ingoldmells, Skegness, Lincolnshire PE25 1RH ("the Company").
2. The Company have been the owners within the meaning of the above section of the land known as Woodlands Caravan Park, Roman Bank, Winthorpe, and more particularly delineated on the plan accompanying this statement and thereon edged red.
2. The aforementioned land lies in the Parish of Skegness.
3. The way coloured yellow on the said plan has been dedicated as a public footpath.
7. The deposit shall comprise this statement and accompanying plan.

Signed:
Holmes

In the presence of
Signature

Name
Address
Occupation

Handwritten signature

Dated:

RF.EC.BLUEA00.....

H.M. LAND REGISTRY

TITLE NUMBER

LL 16 1279

ORDNANCE SURVEY
PLAN REFERENCE

TF 5666 TF 5766

Scale
1/1250

COUNTY LINCOLNSHIRE

DISTRICT EAST LINDSEY

© Crown copyright

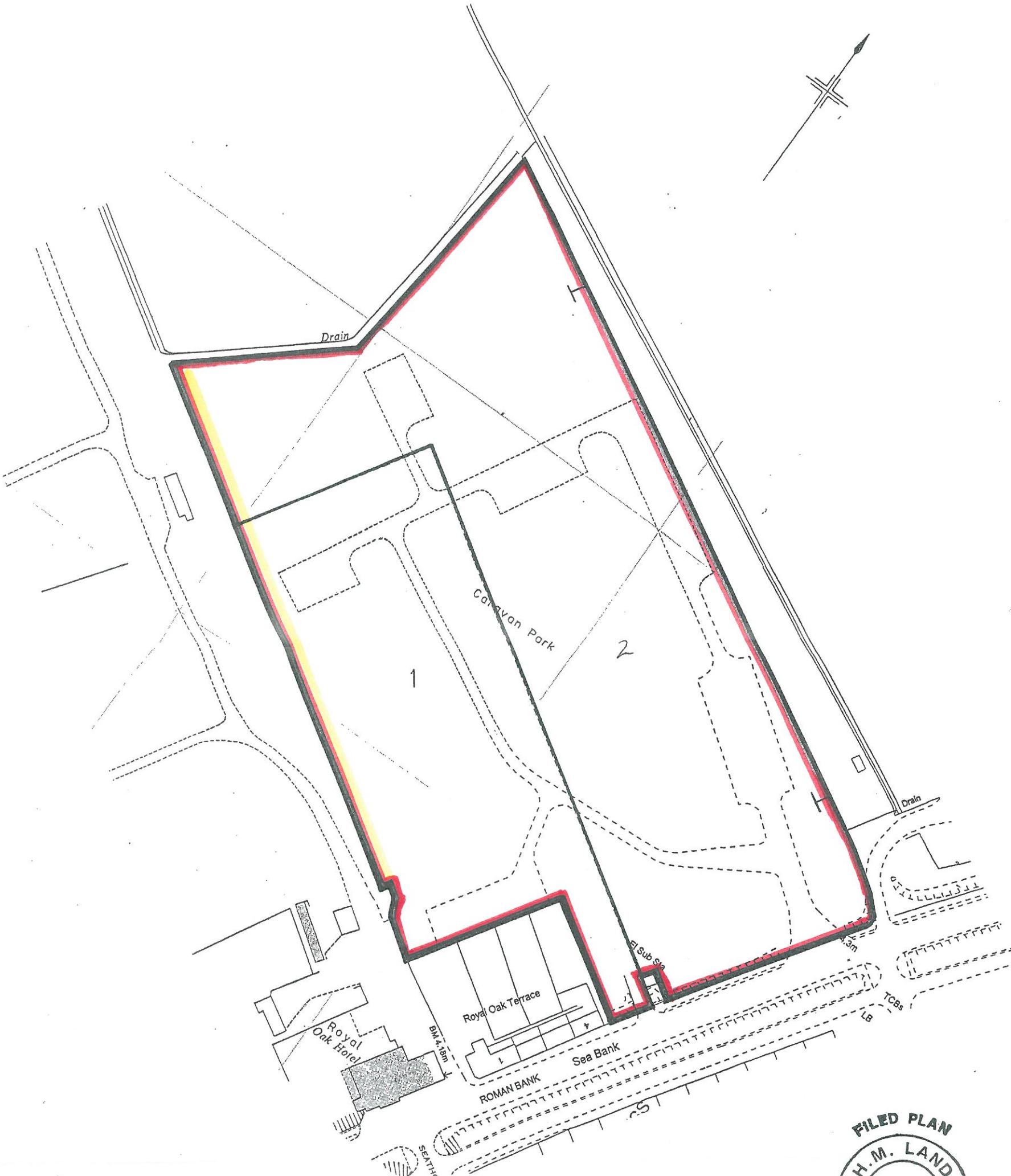

This title plan shows the general position of the boundaries: it does not show the exact line of the boundaries. Measurements scaled from this plan may not match measurements between the same points on the ground. For more information see Land Registry Public Guide 7 - Title Plans.
This official copy shows the state of the title plan on 14/06 at 12:00. It may be subject to distortions in scale.
Under s.67 of the Land Registration Act 2002, this copy is admissible in evidence to the same extent as the original.
Issued on 23 June 2006
This title is dealt with by Hull District Land Registry.
© Crown Copyright. Produced by Land Registry. Further reproduction in whole or in part is prohibited without the prior written permission of Ordnance Survey. Licence Number GD272728.

APPENDIX 2

**STATUTORY DECLARATION
SECTION 31(6) OF THE HIGHWAYS ACT 1980**

I, PETER RAYMOND FRANCISCUS HOLMES, DO SOLEMNLY AND SINCERELY
DECLARE as follows:

1. I am the director and secretary of Blue Anchor Leisure Ltd ('the Company') who have since November 1998 been the owners of the land known as Woodlands Caravan Park, Roman Bank, Winthorpe, more particularly delineated on the plan accompanying this declaration and thereon edged red ("PRFH1").
2. On the 27th day of June 2006 I deposited with Lincolnshire County Council, being the appropriate Council, a statement accompanied by a plan delineating the Company's property by red edging which stated that the ways coloured yellow on the said plan and on the plan accompanying this declaration had been dedicated as a footpath.
3. No additional ways have been dedicated over the land edged red on the plan accompanying this declaration since the statement dated 24th July 2006 referred to in 2.

AND I MAKE this solemn declaration on the [16] day of [OCTOBER] 2006 conscientiously believing it to be true and by virtue of the Statutory Declarations Act 1835.

Declared at

**FREARSONS
SOLICITORS
50, ALGITHA ROAD
SKEGNESS, LINCS.
PE25 2AW**

Before me

Commissioner for Oaths

RF.EC.BLUEA001.304

**50, ALGITHA ROAD
SKEGNESS, LINCS.
PE25 2AW**

10. 'Appropriate authority' means (a) in relation to a map or statement deposited or declaration lodged under section 31(6) of that Act, an appropriate council (as defined in section 31(7) of the Highways Act 1980); and (b) in relation to a statement and map deposited under section 15A(1) of the 2006 Act, a commons registration authority (defined in section 4 of the Commons Act 2006 and section 2 of the Commons Registration Act 1965). In practice, the appropriate council and commons registration authority will usually be the same body.

PART A: Information relating to the applicant and land to which the application relates
(all applicants must complete this Part)

1. Name of appropriate authority to which the application is addressed:

Lincolnshire County Council

2. Name and full address (including postcode) of applicant:

Blue Anchor Leisure Ltd, Robin Hood Park, South Road, Chapel St Leonards, Skegness, Lincolnshire PE24 5TR

3. Status of applicant (tick relevant box or boxes):

I am

(a) the owner of the land(s) described in paragraph 4.

(b) making this application and the statements/declarations it contains on behalf of **Blue Anchor Leisure Ltd** who is the owner of the land(s) described in paragraph 4 and in my capacity as **Director of Blue Anchor Leisure Ltd**.

4. Insert description of the land(s) to which the application relates (including full address and postcode):

Land known ad Woodlands Caravan Park, Roman Bank, Winthorpe, registered at HM Land Registry under title number LL161279.

5. Ordnance Survey six-figure grid reference(s) of a point within the area of land(s) to which the application relates (if known):

6. This deposit comprises the following statement(s) and/or declarations (*delete Parts B, C, or D where not applicable*):

PART B: Statement under section 31(6) of the Highways Act 1980

I am a director of Blue Anchor Leisure Ltd who is the owner of the land described in paragraph 4 of Part A of this form and shown edged red on the map accompanying this statement.

Ways shown coloured yellow on the accompanying map are public footpaths.

No other ways over the land shown edged red on the accompanying map have been dedicated as highways.

PART C: Declaration under section 31(6) of the Highways Act 1980

1. I am a director of Blue Anchor Leisure Ltd who is the owner of the land described in paragraph 4 of Part A of this form and shown edged in red on the map accompanying this declaration/lodged with Lincolnshire County Council on 23rd October 2006.

2. On the 27th day of June 2006 I deposited with Lincolnshire County Council, being the appropriate council, a statement accompanied by a map showing Blue Anchor Leisure Ltd's property edged in red which stated that:

the ways shown coloured yellow on that map and on the map accompanying this declaration had been dedicated as footpaths.

no other ways had been dedicated as highways over Blue Anchor Leisure Ltd's property.

3. On the 23rd day of October 2006 I deposited with Lincolnshire County Council, being the appropriate council, a declaration dated 16th October 2006, stating that no additional ways other than those marked in the appropriate colour on the map accompanying this declaration had been dedicated as footpaths since the deposit of the statement referred to in paragraph 2 above.

4. No additional ways have been dedicated over the land edged red on the map accompanying this declaration/referenced in paragraph 1 above since the statement dated 27th June 2006 referred to in paragraph 2 above since the date of the declaration referred to in paragraph 3 above other than those footpaths marked in the appropriate colour on the map accompanying this declaration and at the present time Blue Anchor Leisure Ltd has no intention of dedicating any more public rights of way over the property.

PART D: Statement under section 15A(1) of the Commons Act 2006

Blue Anchor Leisure Ltd is the owner of the land described in paragraph 4 of Part A of this form and shown edged red on the map accompanying this statement.

PART E: Additional information relevant to the application
(insert any additional information relevant to the application)

PART F: Statement of Truth
(all applicants must complete this Part)

WARNING: If you dishonestly enter information or make a statement that you know is, or might be, untrue or misleading, and intend by doing so to make a gain for yourself or another person, or to cause loss or the risk of loss to another person, you may commit the offence of fraud under section 1 of the Fraud Act 2006, the maximum penalty for which is 10 years' imprisonment or an unlimited fine, or both.

I BELIEVE THAT THE FACTS AND MATTERS CONTAINED IN THIS FORM ARE TRUE

S
F
I
Y

Data Protection Act 1998 – Fair Processing Notice

The purpose of this Fair Processing Notice is to inform you of the use that will be made of your personal data, as required by the Data Protection Act 1998.

The appropriate authority (see explanation of definition in above guidance notes) in England is the data controller in respect of any personal data that you provide when you complete this form.

The information that you provide will be used by the appropriate authority in its duties to process applications to deposit statements, maps and declarations under section 31(6) the Highways Act 1980 and statements under section 15A(1) of the Commons Act 2006. The information you provide will also be used by the appropriate authority in its duty to update the registers in which details of such deposits are recorded under the Dedicated Highways (Registers under Section 31A of the Highways Act 1980) (England) Regulations 2007 and the Commons (Registration of Town or Village Greens) and Dedicated Highways (Landowner Statements and Declarations) (England) Regulations 2013.

The appropriate authority is required by the legislation above to maintain a register which holds information provided in this form, which can be inspected online or in person by members of the public on request. It may also be required to release information, including personal data and commercial information, on request under the Environmental Information Regulations 2004 or the Freedom of Information Act 2000. However, the appropriate authority will not permit any unwarranted breach of confidentiality nor will they act in contravention of their obligations under the Data Protection Act 1998.

H.M. LAND REGISTRY		TITLE NUMBER
		LL 16 1279
ORDNANCE SURVEY PLAN REFERENCE	TF 5666 TF 5766	Scale 1/1250
COUNTY LINCOLNSHIRE	DISTRICT EAST LINDSEY	© Crown copyright

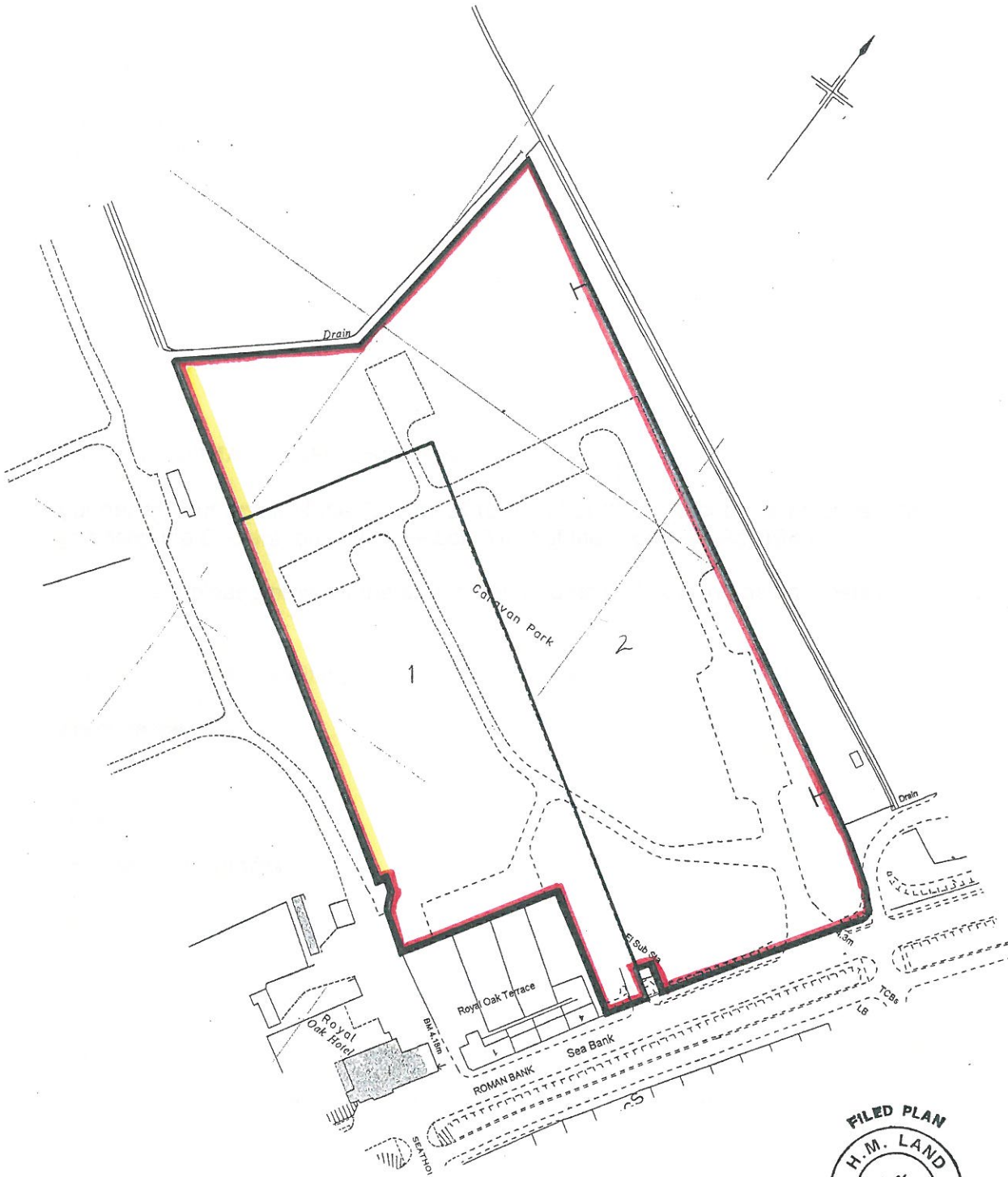

This title plan shows the general position of the boundaries: it does not show the exact line of the boundaries. Measurements scaled from this plan may not match measurements between the same points on the ground. For more information see Land Registry Public Guide 7 - Title Plans.

This official copy shows the state of the title plan on 14/6/06 at 12.00. It may be subject to distortions in scale. Under s.67 of the Land Registration Act 2002, this copy is admissible in evidence to the same extent as the original.

Issued on 23 June 2006
This title is dealt with by Hull District Land Registry.
© Crown Copyright. Produced by Land Registry. Further reproduction in whole or in part is prohibited without the prior written permission of Ordnance Survey. Licence Number GD272728.