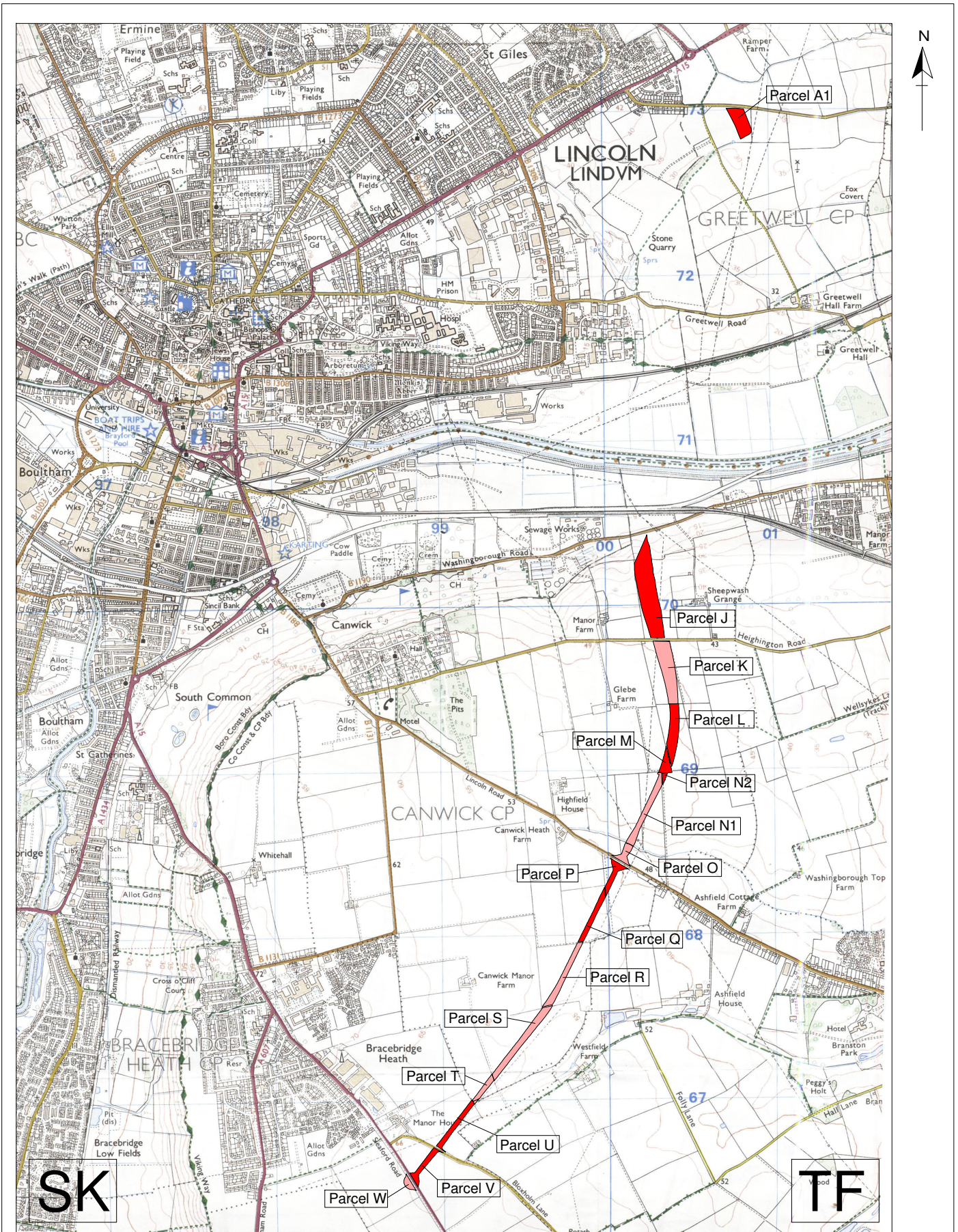



Figure 1 General location map



Key
 conditions unsuitable for fieldwalking and metal detector survey
 Approximate area of parcel - subject of fieldwalking and metal detector survey
 Geophysical survey (all areas)

 Archaeological Project Services	
Project Name: Lincoln Eastern Bypass LNEB08	
Not to Scale	Report No: 128/08

Figure 2 Location of survey areas

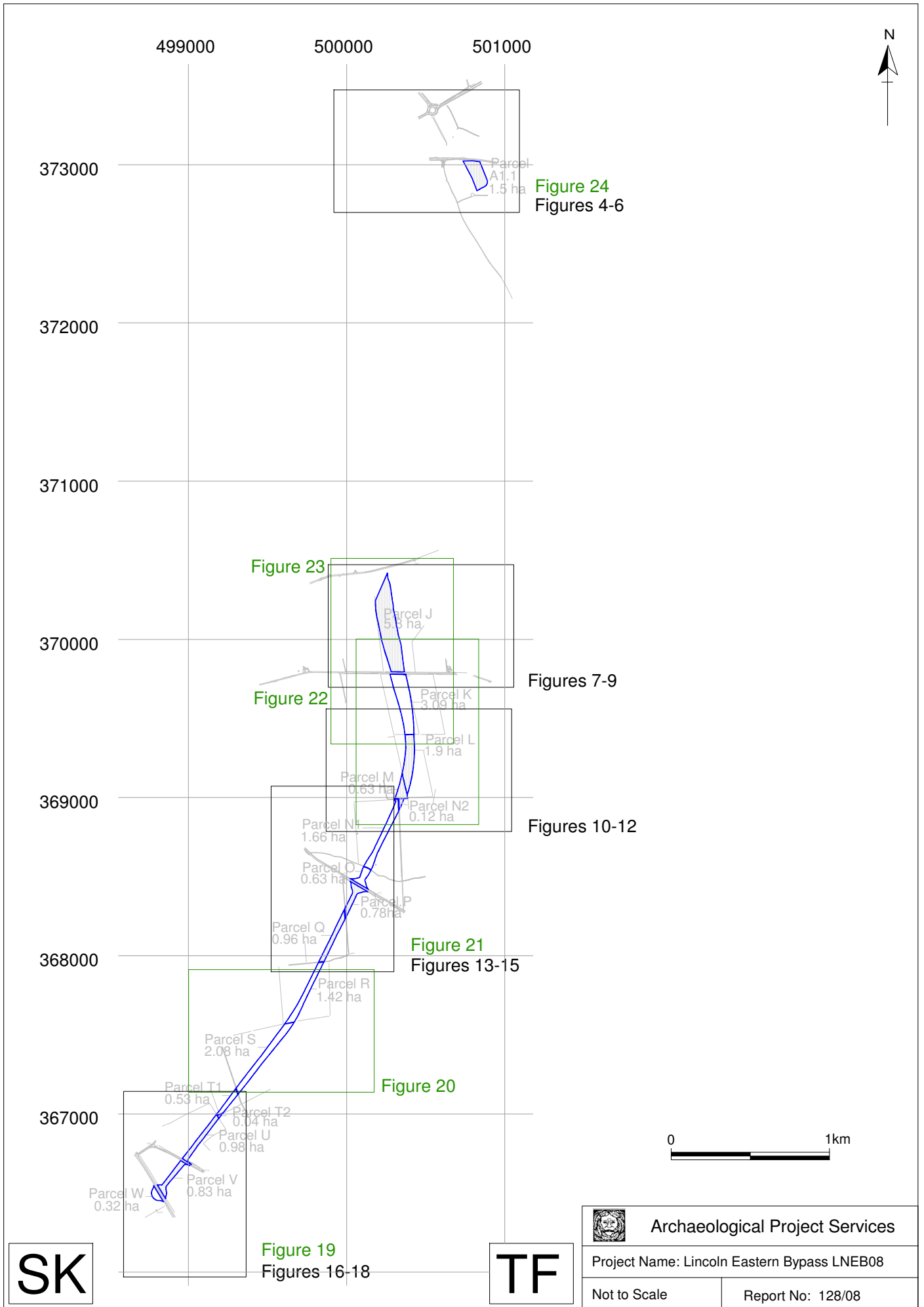

Figure 3 Key to location of figures 4-18 (fieldwalking); 19-24 (geophysics)



Figure 4 Results of fieldwalking and metal detecting (prehistoric-Roman) Parcel A1



Figure 5 Results of fieldwalking and metal detecting (medieval) Parcel A1



Figure 6 Results of fieldwalking and metal detecting (post-medieval and undated) Parcel A1



Figure 7 Results of fieldwalking and metal detecting (prehistoric and Roman) Parcel J



Figure 8 Results of fieldwalking and metal detecting (medieval) Parcel J

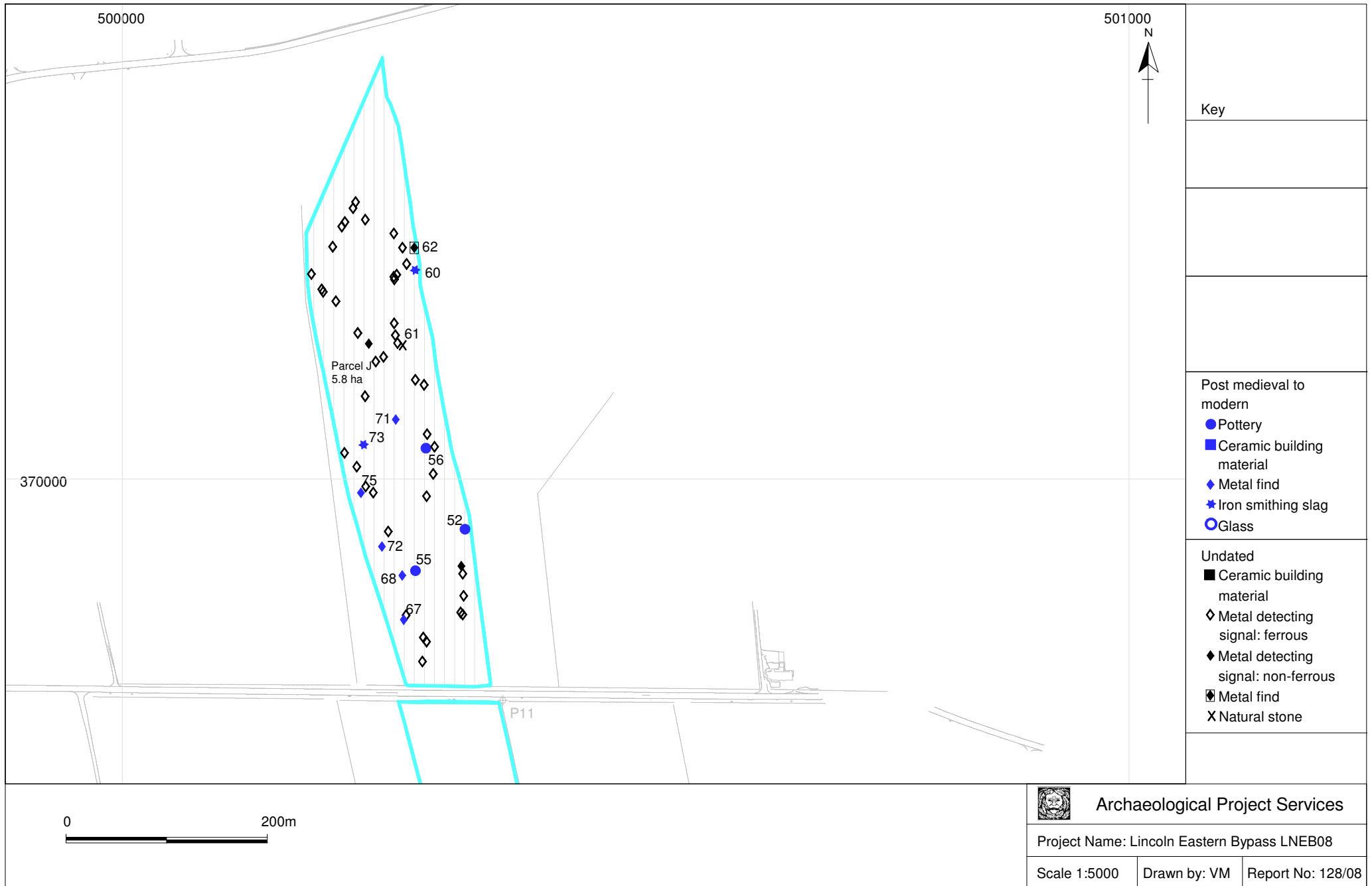

Figure 9 Results of fieldwalking and metal detecting (post-medieval and undated) Parcel J

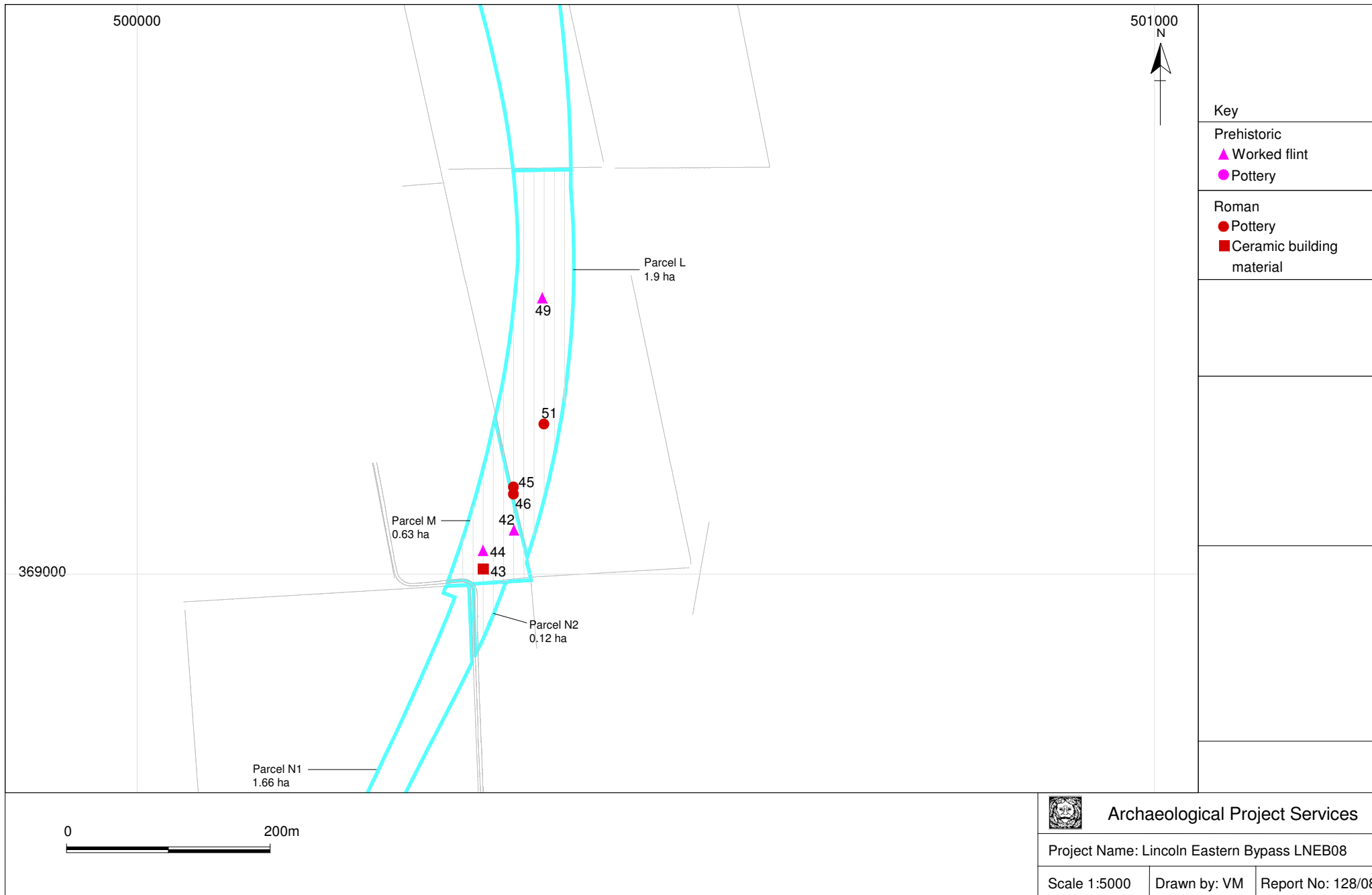

Figure 10 Results of fieldwalking and metal detecting (prehistoric and Roman) Parcels L, M and N2

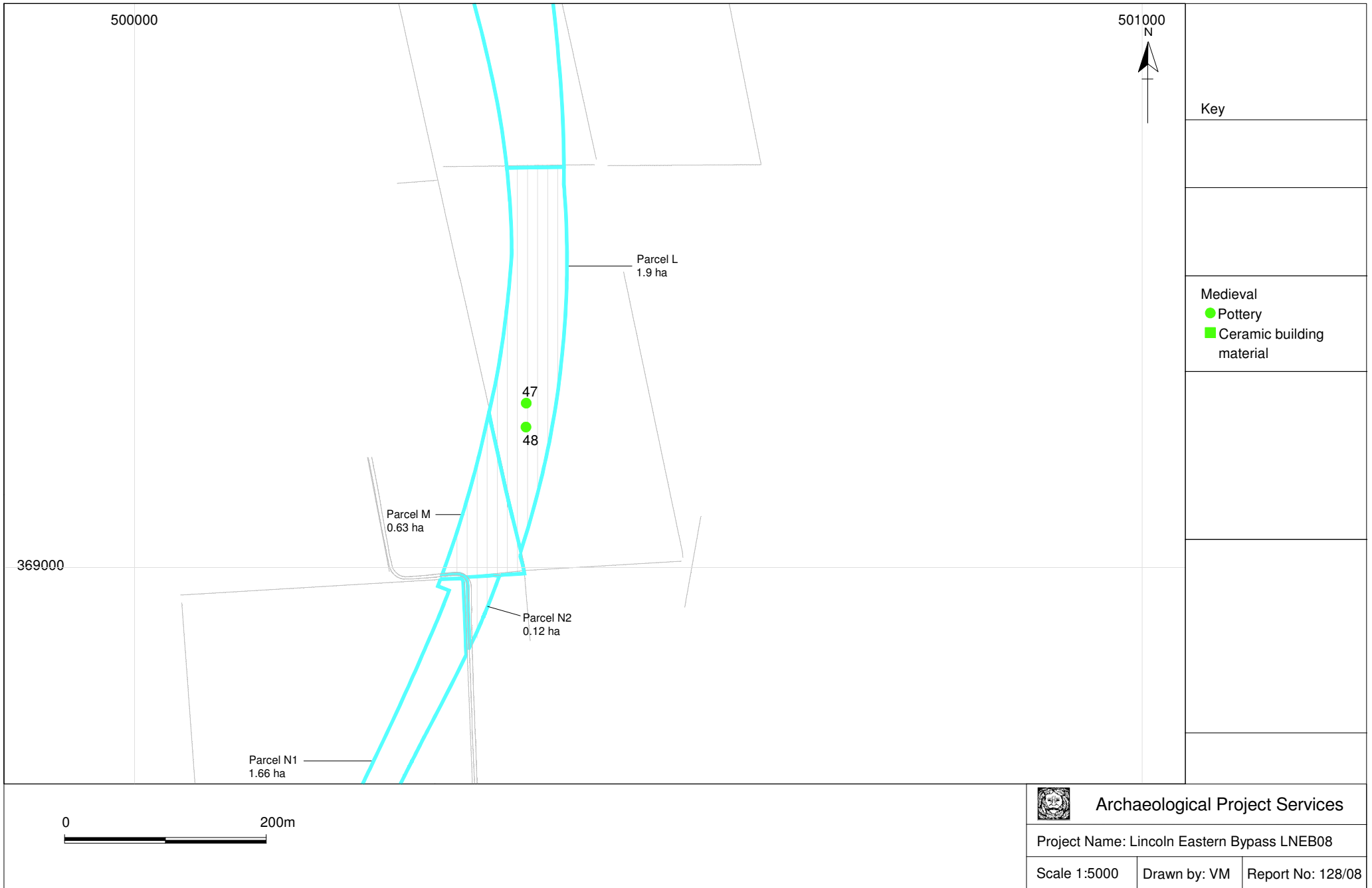

Figure 11 Results of fieldwalking and metal detecting (medieval) Parcels L, M and N2

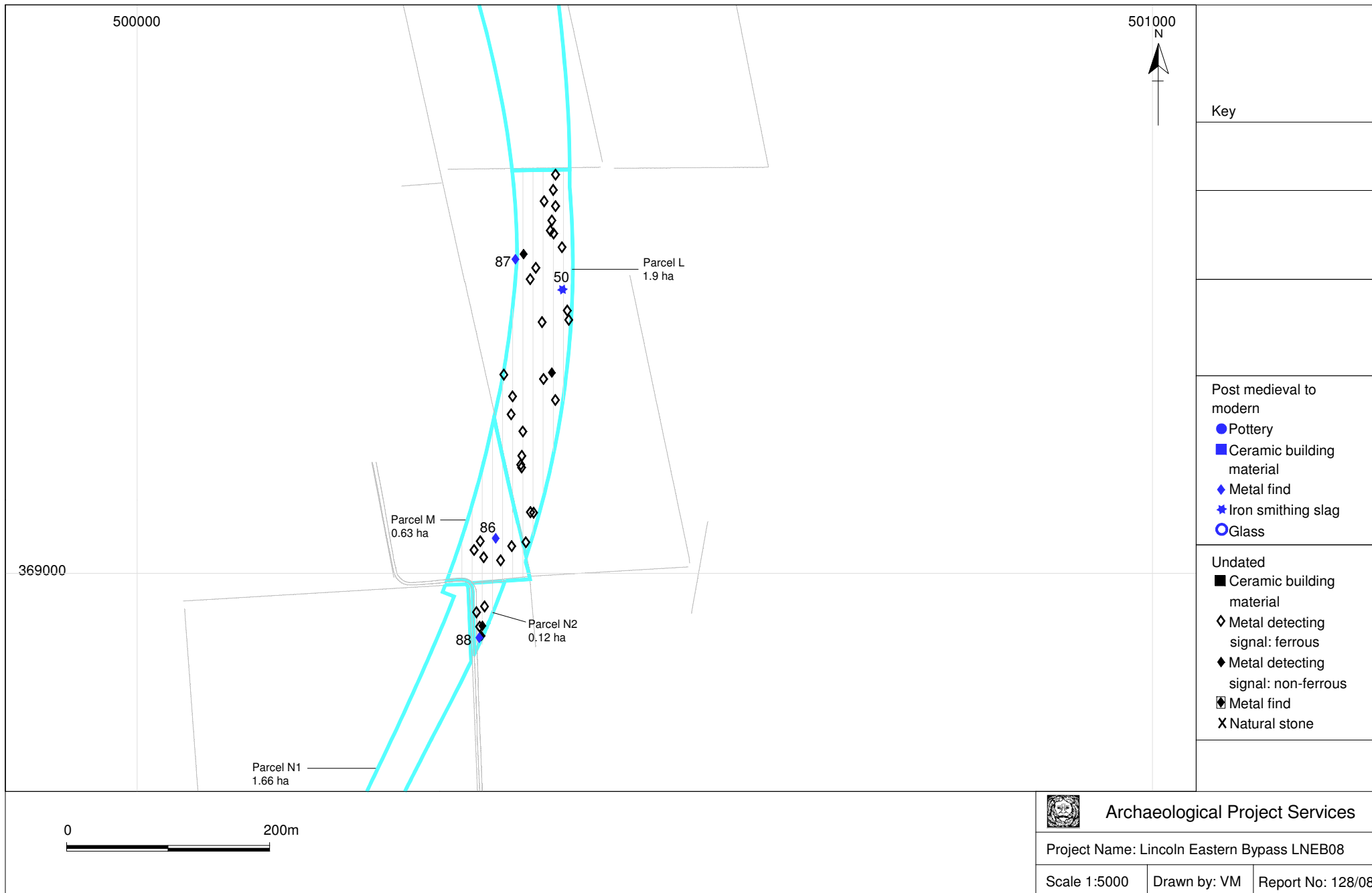

Figure 12 Results of fieldwalking and metal detecting (post-medieval and undated) Parcels L, M and N2

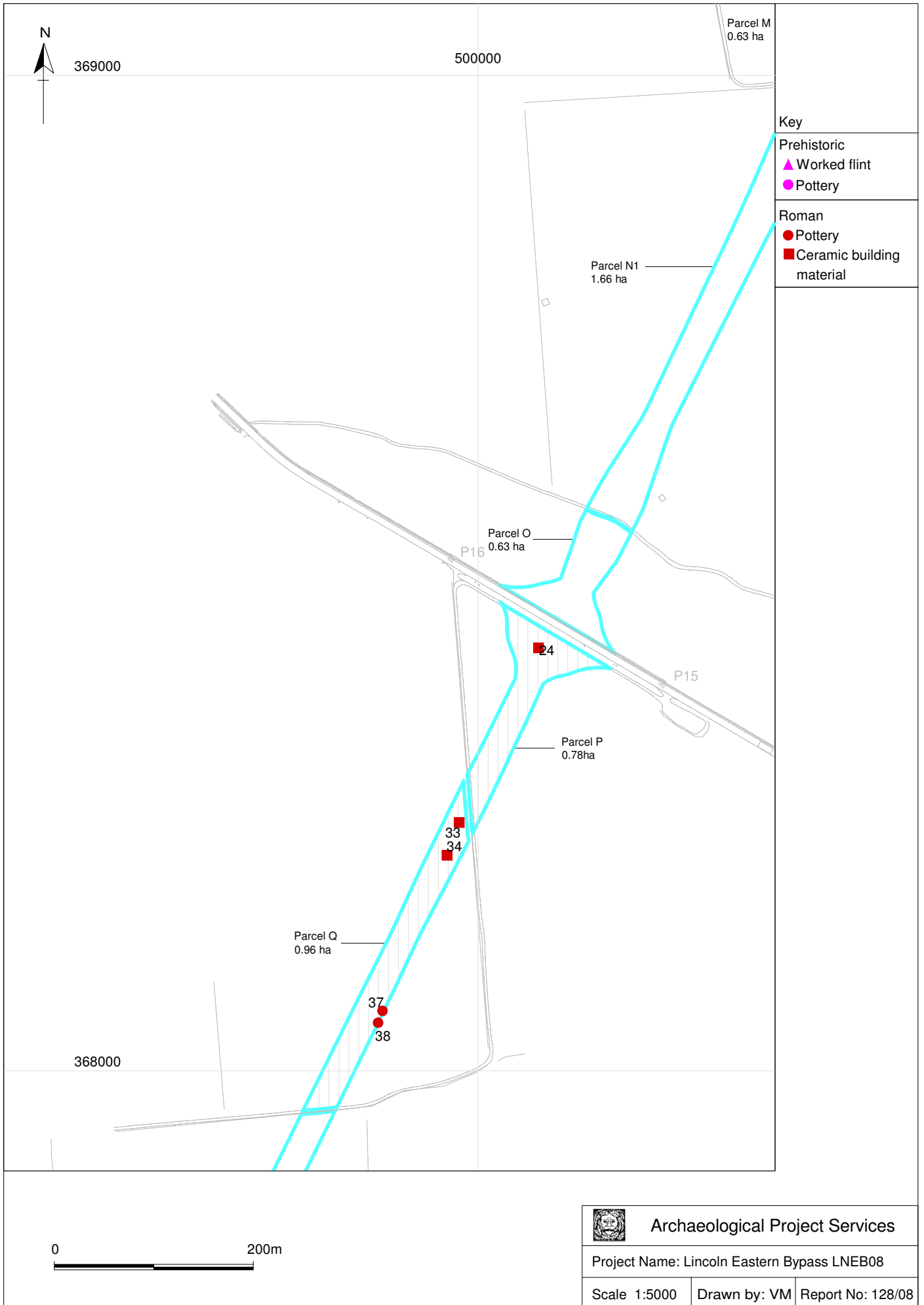

Figure 13 Results of fieldwalking and metal detecting (prehistoric and Roman) Parcels P and Q

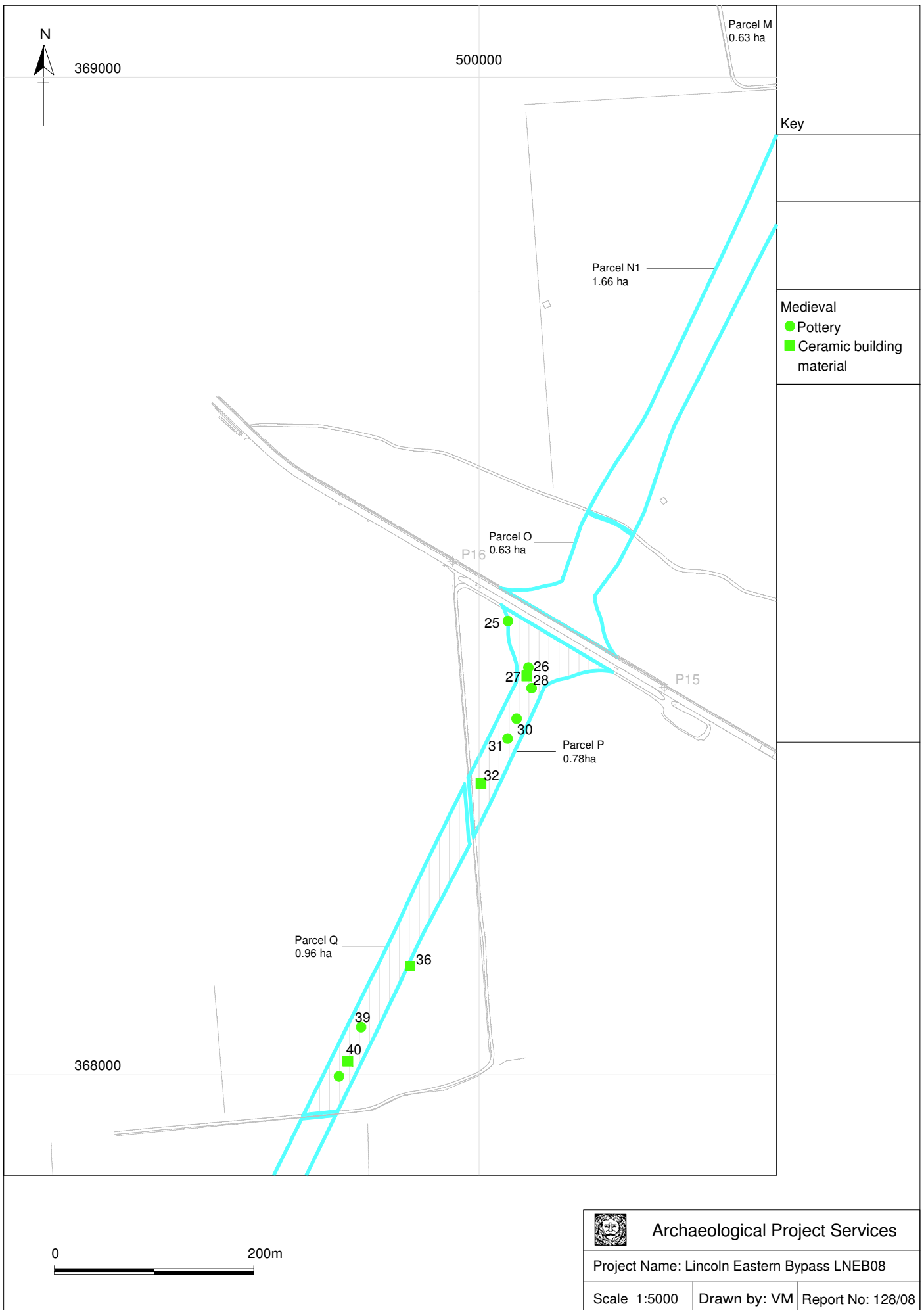

Figure 14 Results of fieldwalking and metal detecting (medieval) Parcels P and Q

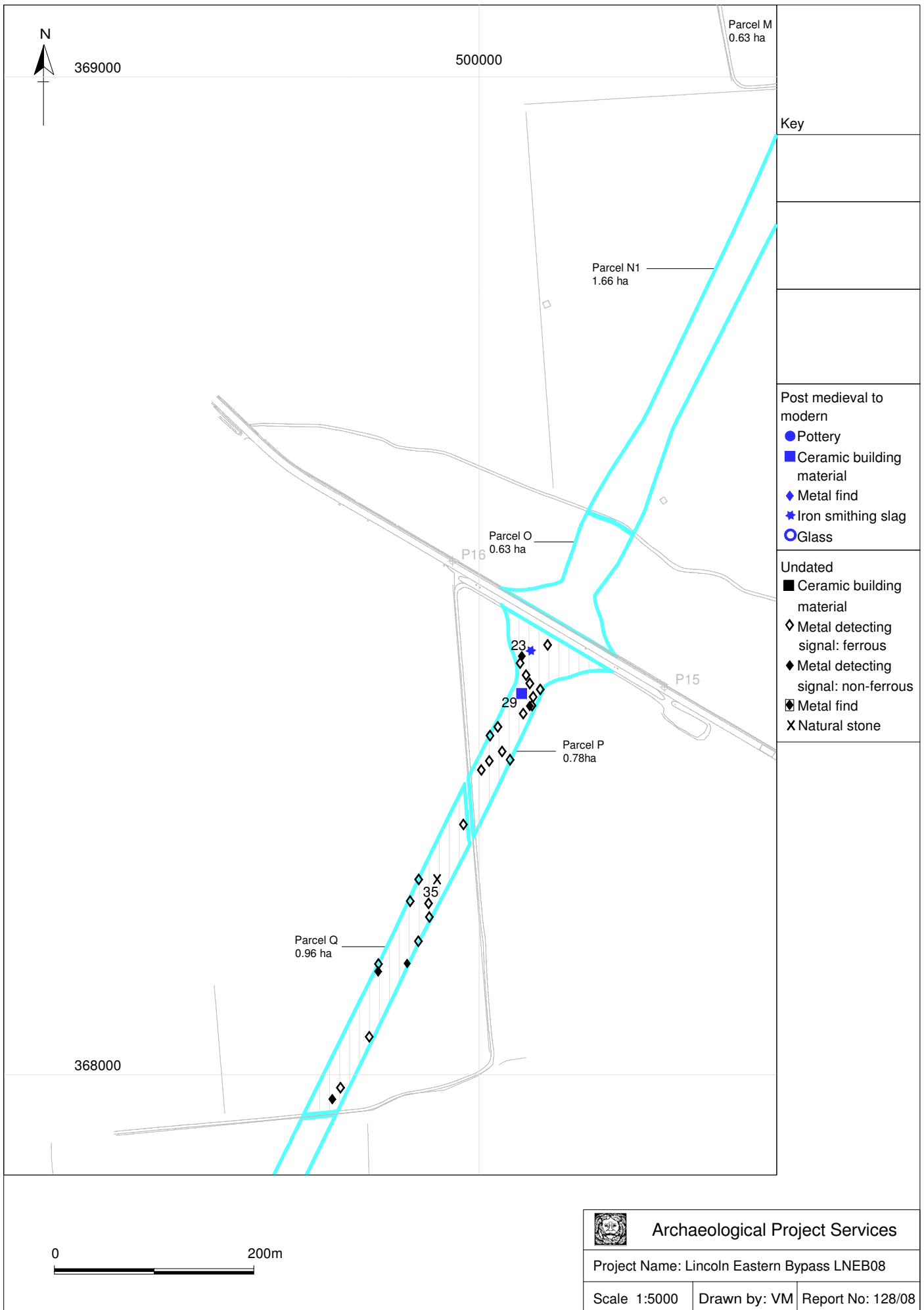

Figure 15 Results of fieldwalking and metal detecting (post-medieval and undated) Parcels P and Q

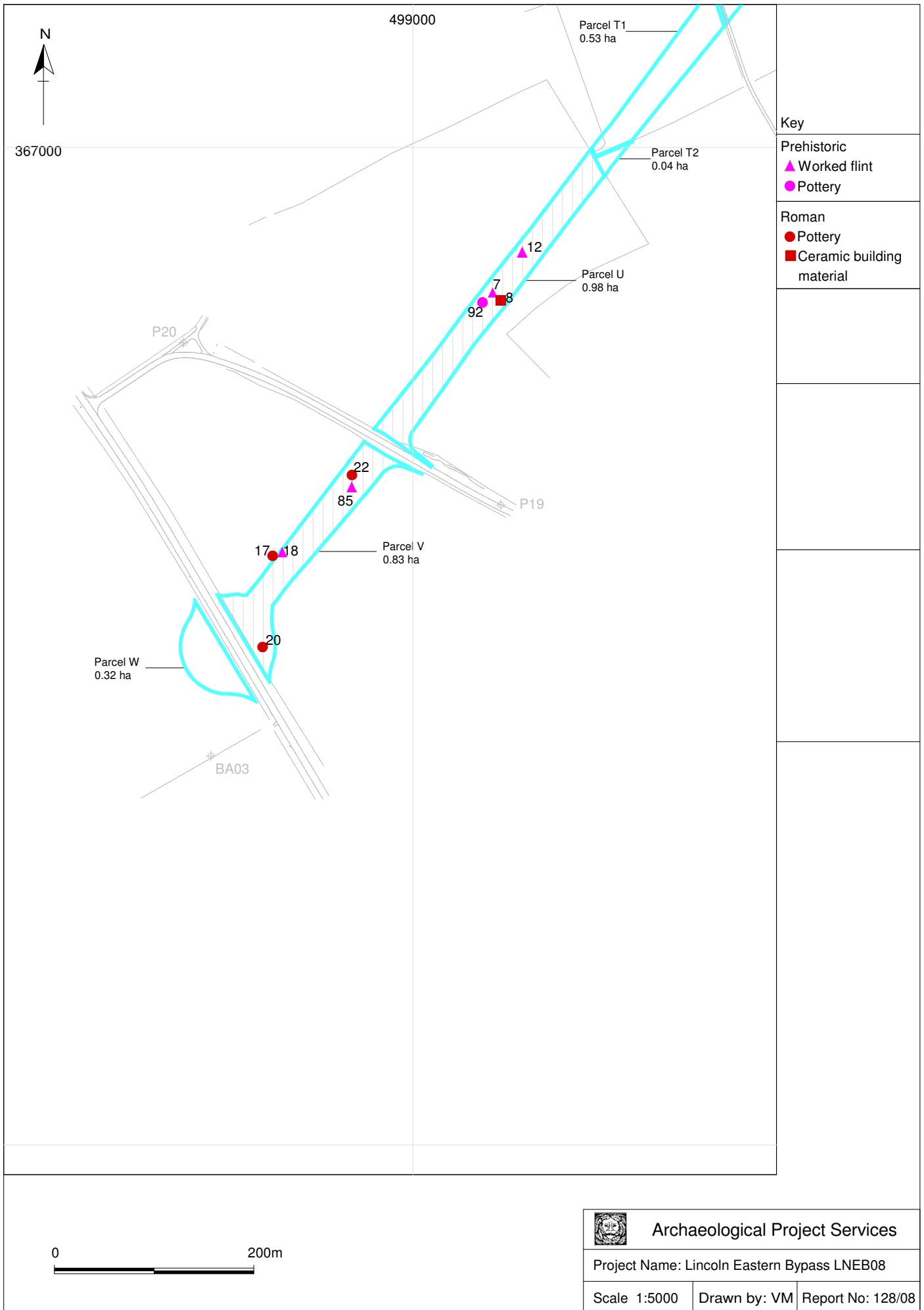
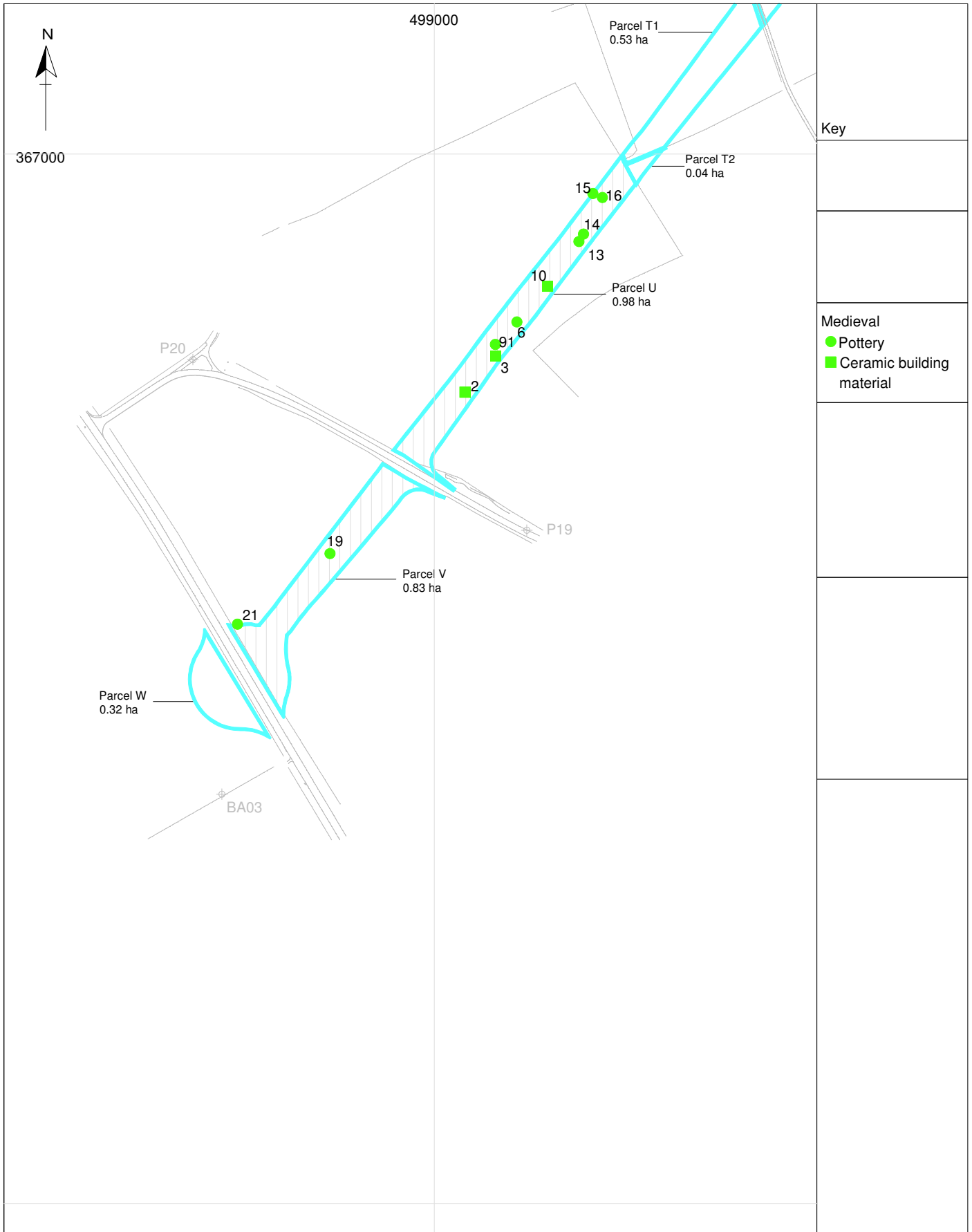

Figure 16 Results of fieldwalking and metal detecting (prehistoric and Roman) Parcels U and V



 Archaeological Project Services		
Project Name: Lincoln Eastern Bypass LNEB08		
Scale 1:5000	Drawn by: VM	Report No: 128/08

Figure 17 Results of fieldwalking and metal detecting (medieval) Parcels U and V

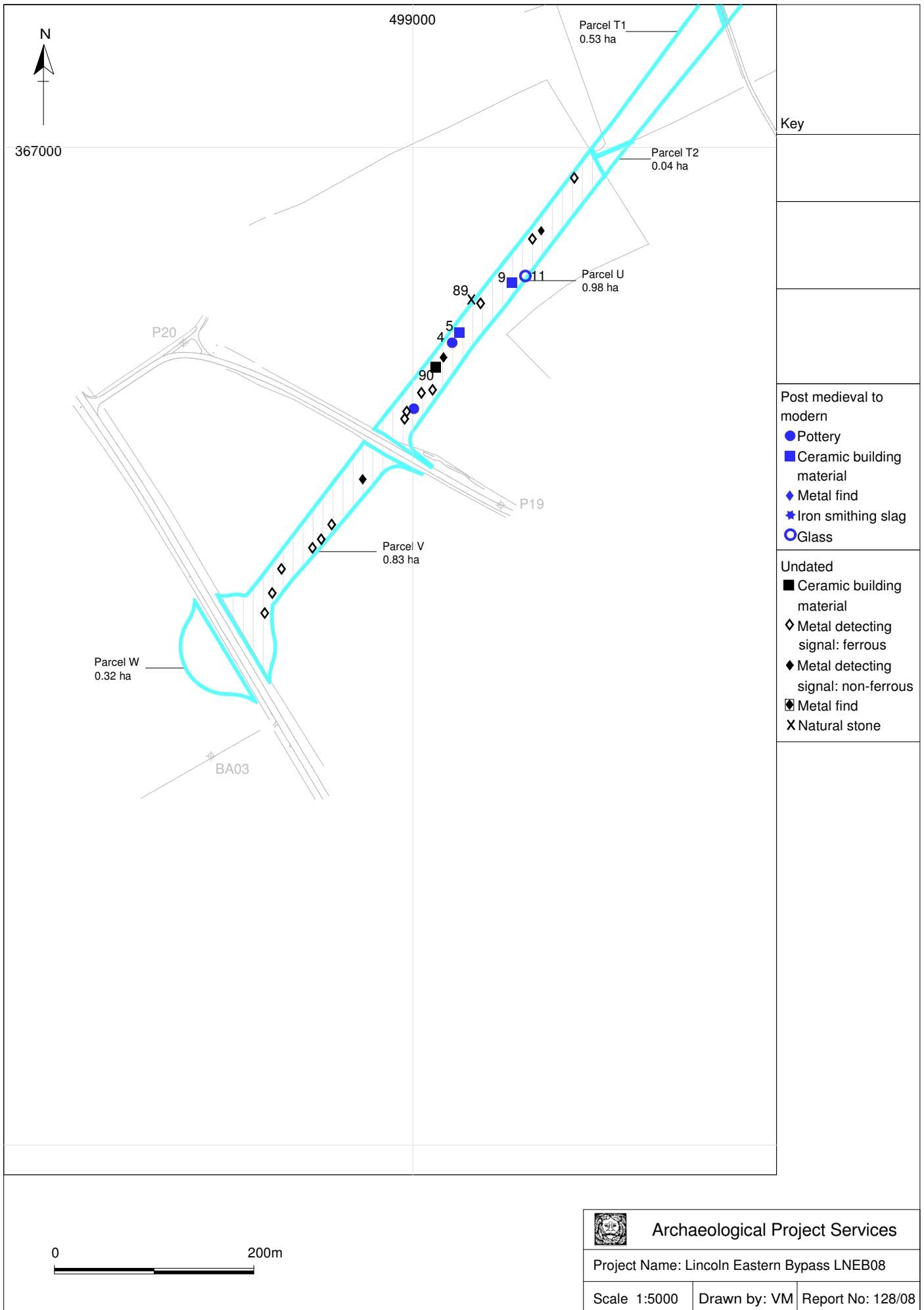
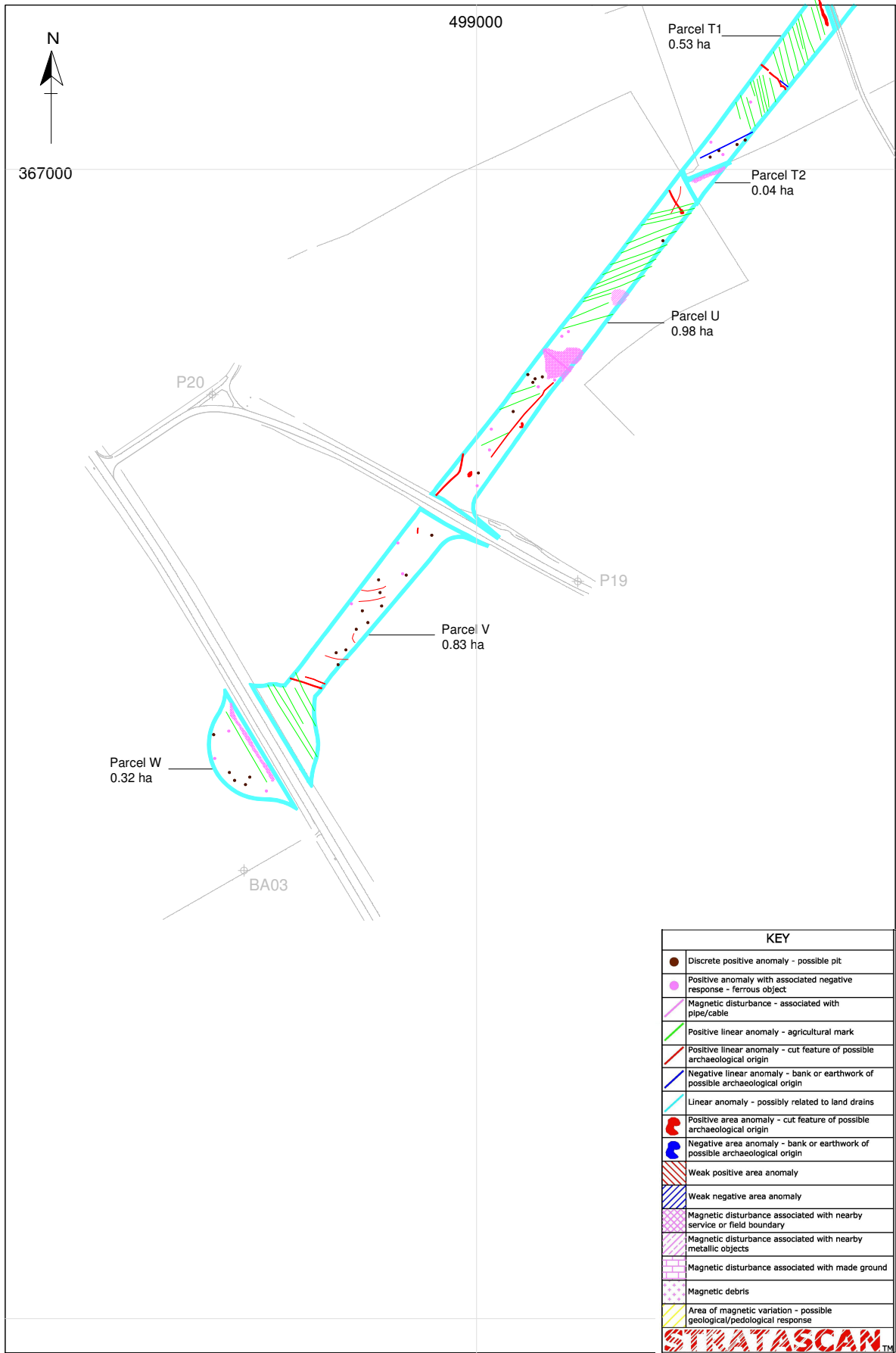

Figure 18 Results of fieldwalking and metal detecting (post-medieval and undated) Parcels U and V



0 200m



Archaeological Project Services

Project Name: Lincoln Eastern Bypass LNEB08

Scale 1:5000

Drawn by: VM

Report No: 128/08

Figure 19 Results of geophysical survey Parcels T, U and V



Figure 20 Results of geophysical survey Parcels R, S

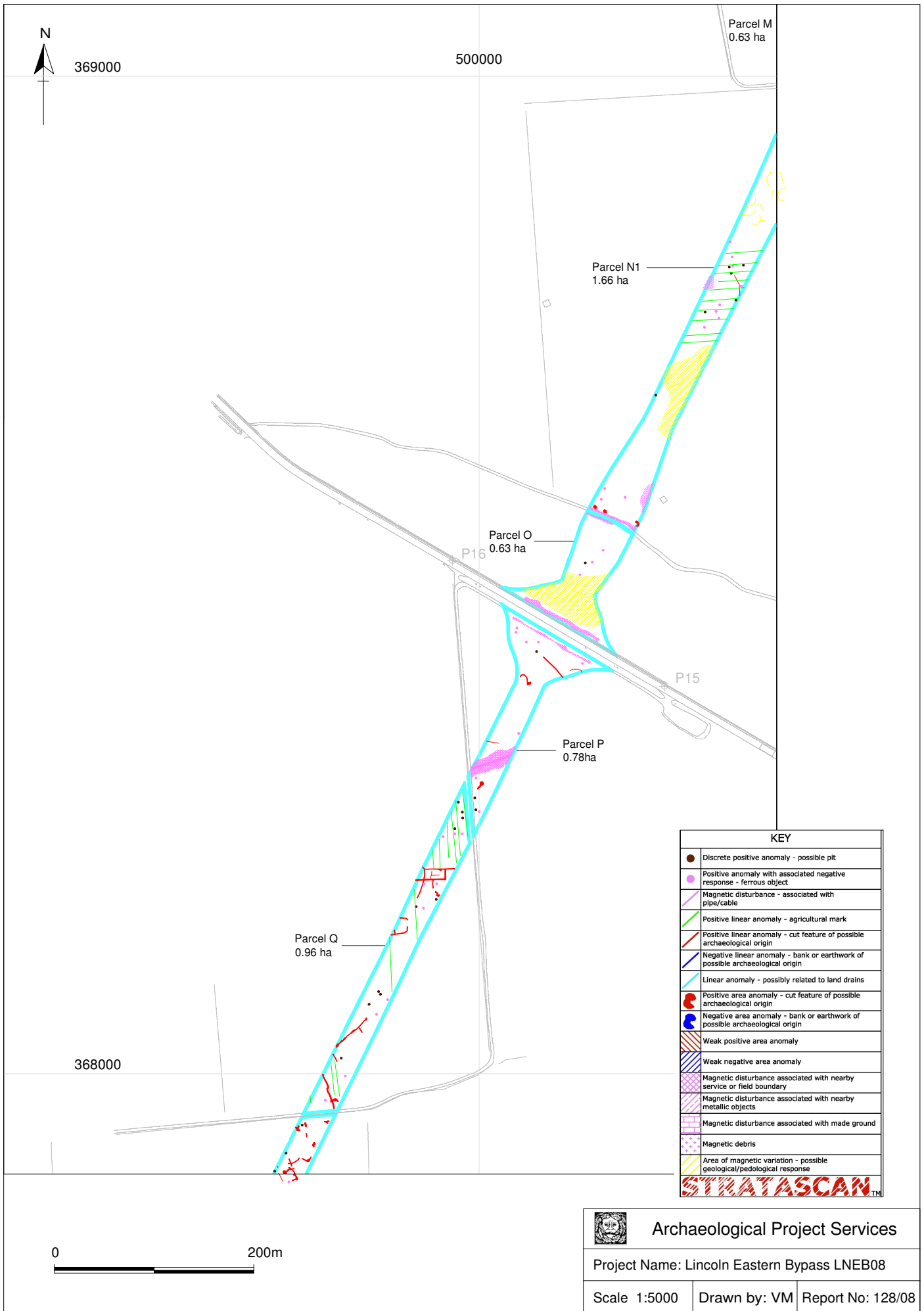

Figure 21 Results of geophysical survey Parcels N1, O, P and Q

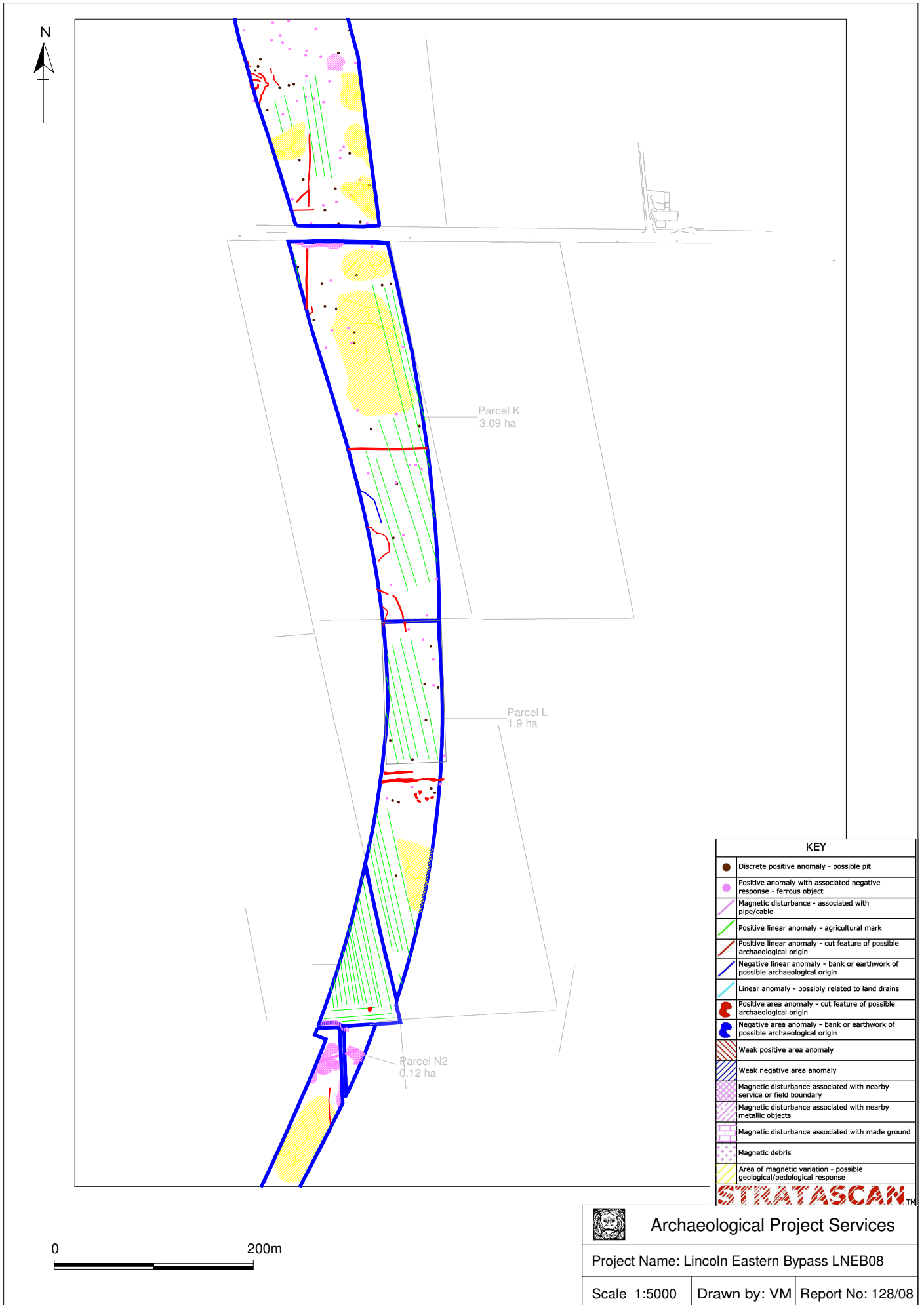
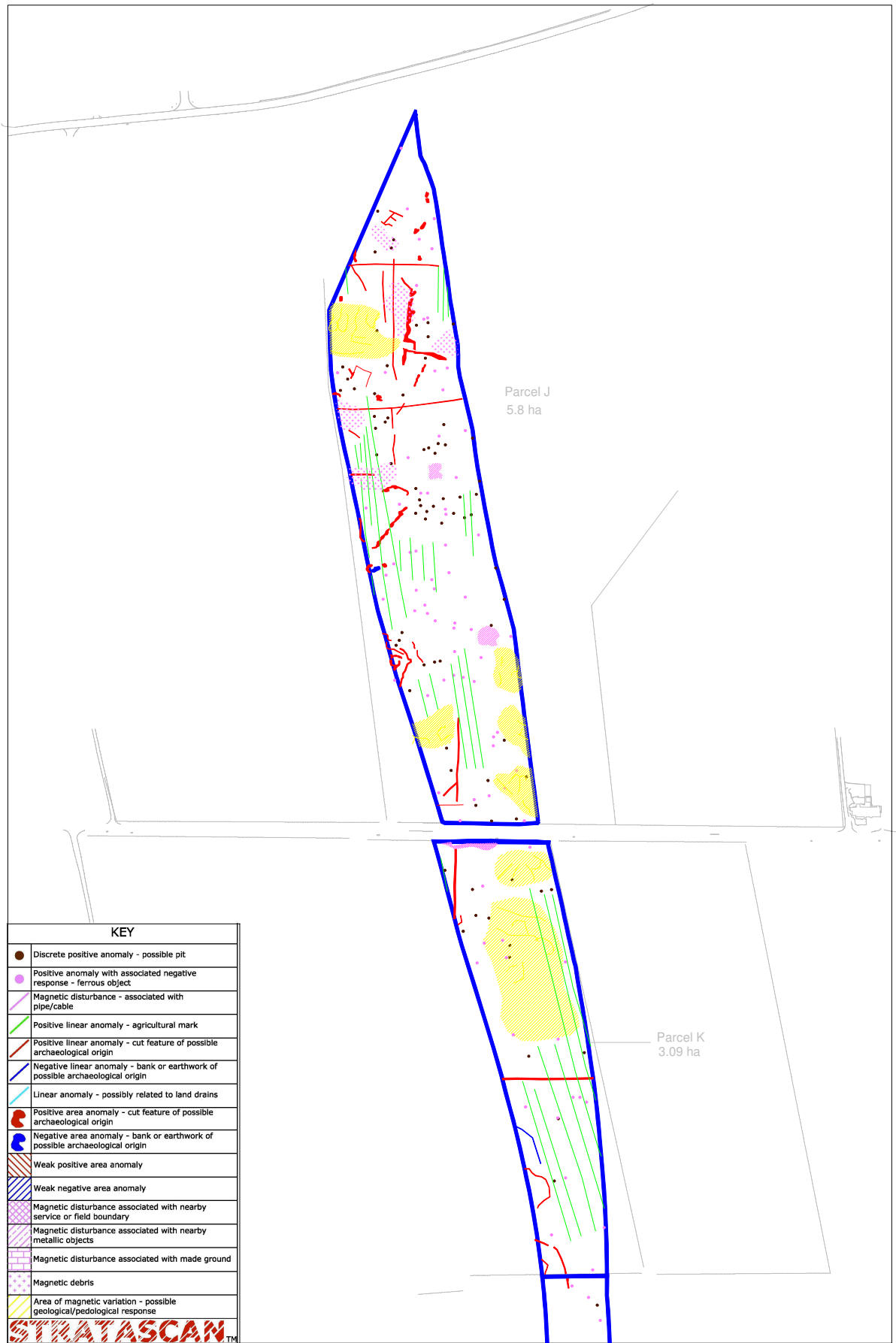

Figure 22 Results of geophysical survey Parcels K, L, M, N2



KEY	
	Discrete positive anomaly - possible pit
	Positive anomaly with associated negative response - ferrous object
	Magnetic disturbance - associated with pipe/cable
	Positive linear anomaly - agricultural mark
	Positive linear anomaly - cut feature of possible archaeological origin
	Negative linear anomaly - bank or earthwork of possible archaeological origin
	Linear anomaly - possibly related to land drains
	Positive area anomaly - cut feature of possible archaeological origin
	Negative area anomaly - bank or earthwork of possible archaeological origin
	Weak positive area anomaly
	Weak negative area anomaly
	Magnetic disturbance associated with nearby service or field boundary
	Magnetic disturbance associated with nearby metallic objects
	Magnetic disturbance associated with made ground
	Magnetic debris
	Area of magnetic variation - possible geological/pedological response



Archaeological Project Services

Project Name: Lincoln Eastern Bypass LNEB08

Scale 1:5000 Drawn by: VM Report No: 128/08

Figure 23 Results of geophysical survey Parcels J and K

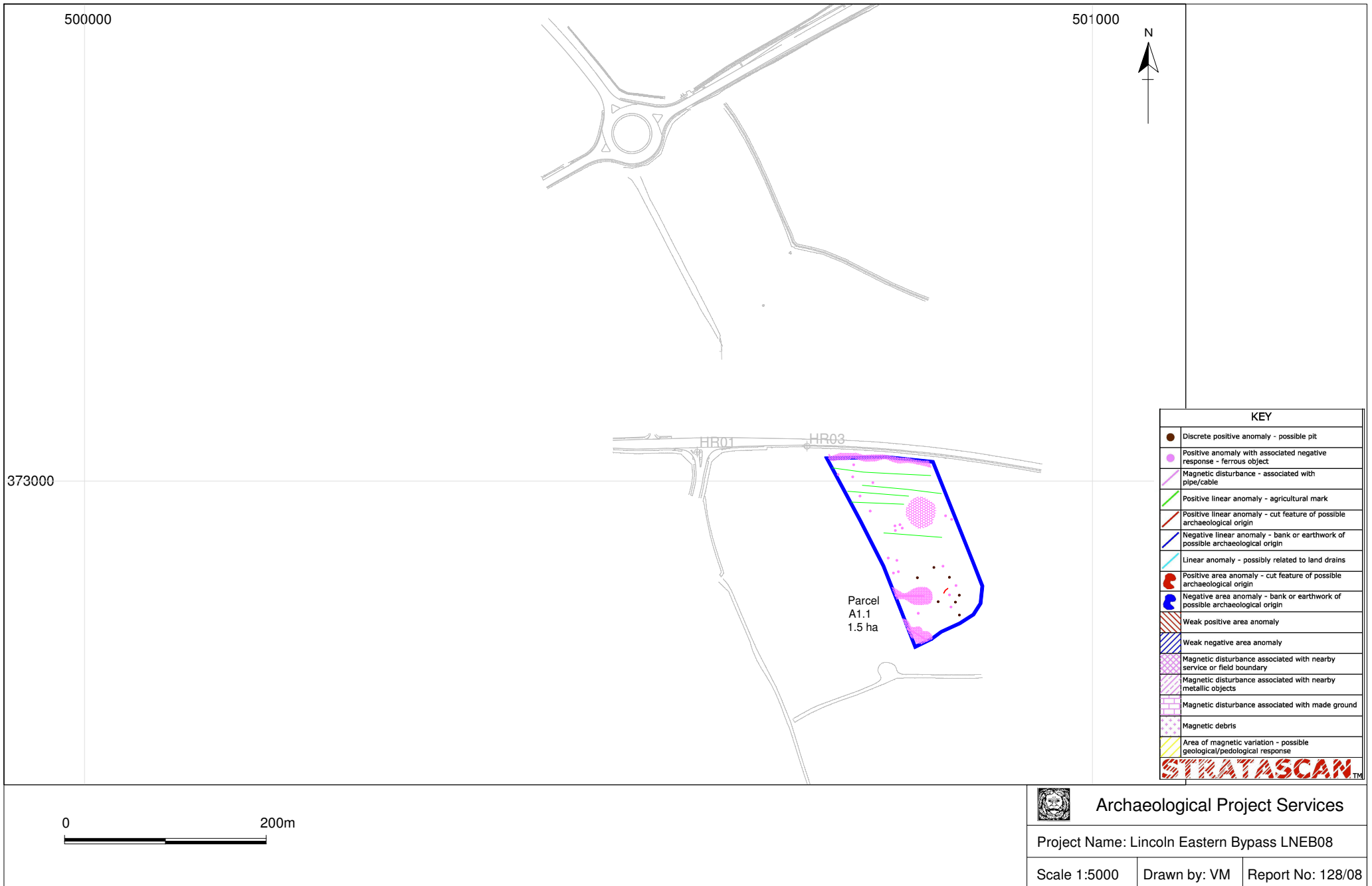

Figure 24 Results of geophysical survey Parcel A1



Plate 1 Fieldwalking methodology, Parcel Q, looking southwest



Plate 2 View of surveyed area along proposed road route, Parcel U, looking southwest



Plate 3 View of Parcel L showing young brassica crop, looking north



Plate 4 View of Parcel J, looking northwest towards city centre and Cathedral



Plate 5 Metal detecting and GPS survey, Parcel J, looking south



Plate 6 Parcel A1, looking east along northern field boundary