

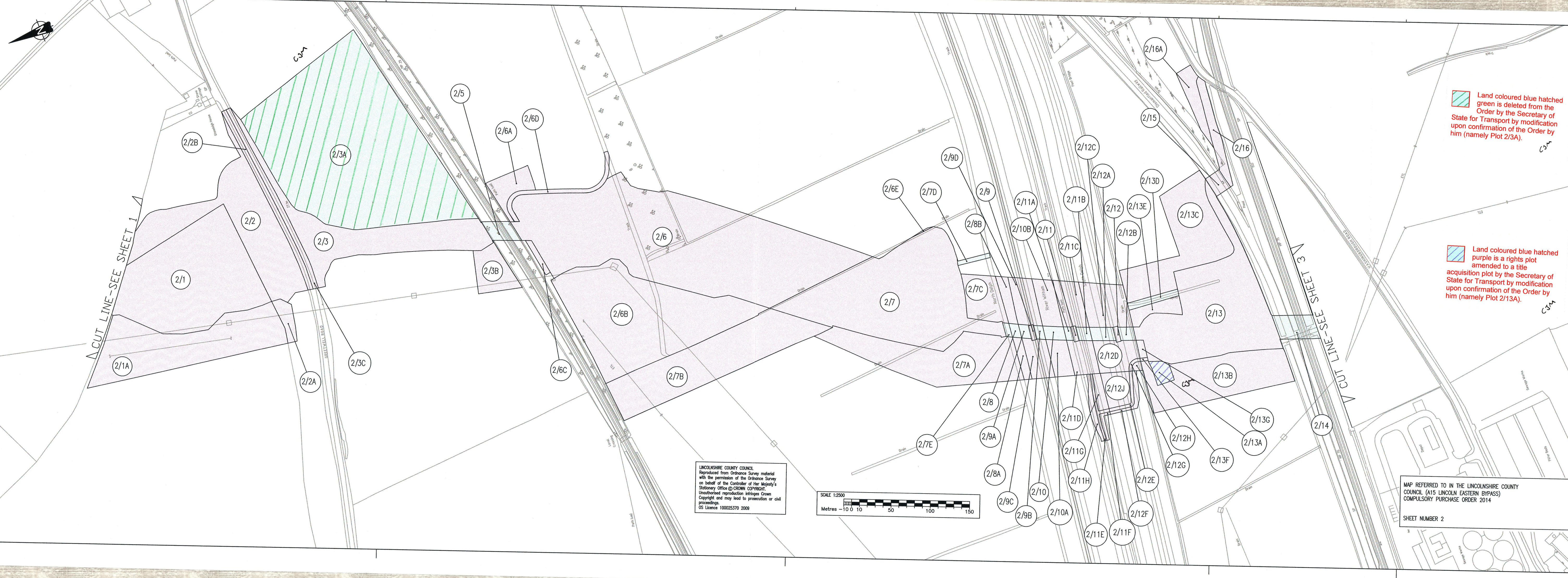

CUT LINE-SEE SHEET 1

CUT LINE-SEE SHEET 3



Land coloured blue hatched green is deleted from the Order by the Secretary of State for Transport by modification upon confirmation of the Order by him (namely Plot 2/3A).

Land coloured blue hatched purple is a rights plot amended to a title acquisition plot by the Secretary of State for Transport by modification upon confirmation of the Order by him (namely Plot 2/13A).

LINCOLNSHIRE COUNTY COUNCIL  
Reproduced from Ordnance Survey material with the permission of the Ordnance Survey on behalf of the Controller of Her Majesty's Stationery Office © CROWN COPYRIGHT.  
Unauthorised reproduction infringes Crown Copyright and may lead to prosecution or civil proceedings.  
OS Licence 100025370 2009

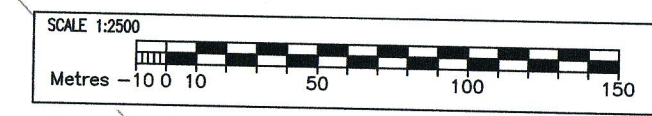

MAP REFERRED TO IN THE LINCOLNSHIRE COUNTY COUNCIL (A15 LINCOLN EASTERN BYPASS) COMPULSORY PURCHASE ORDER 2014

SHEET NUMBER 2